

**SE** JESAJAH NOTES  
FEB 28 '09

WITH MAR 7 '09 REVISIONS

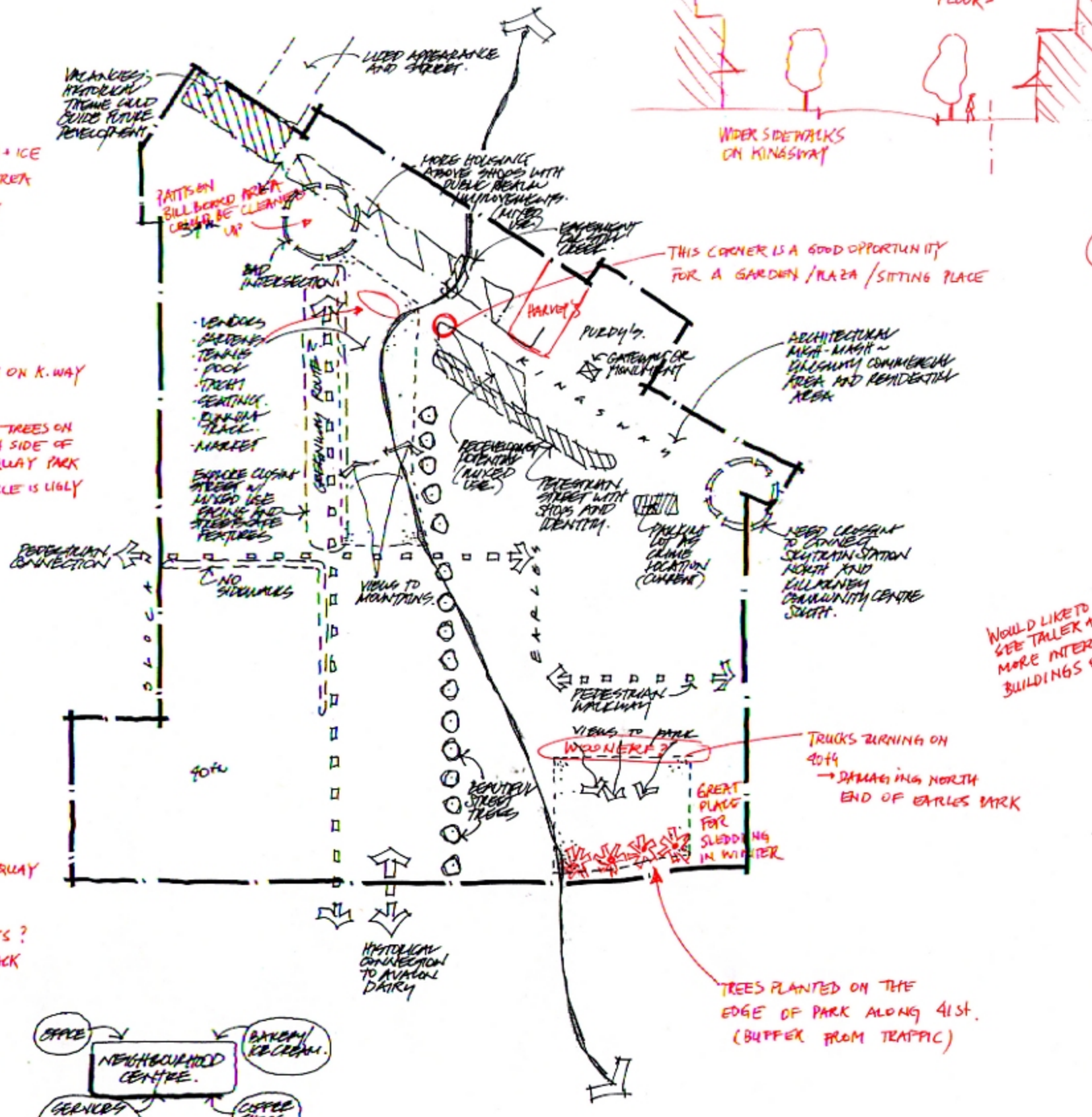
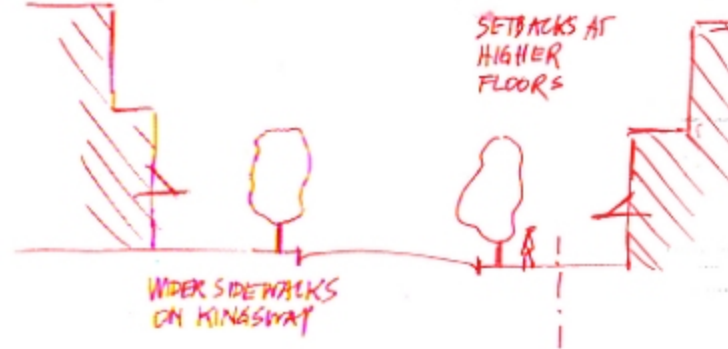

- COMMERCIAL LANES ARE MESSY + UGLY
- SIDEWALKS NEED TO BE CLEANED IN WINTER OF SNOW + ICE
- LET'S HAVE A COMMUNITY POLICING CENTRE IN THIS AREA
- THINK ABOUT MAKING WALES ST. NO ACCESS OFF K. WAY

**PARKING, TRAFFIC + SAFETY:**

- EARLIES ST. SOUTH OF KINGSWAY (TRAFFIC)
- NEED FOR CROSSING @ NORQUAY PARK
- 34th - REGULARIZED INTERSECTION - GOOD IDEA - SHOULD BE RIGHT TURN ONLYS - NO LEFT TURN ON K. WAY

**CHARACTER + 'PLACE':**

- HISTORICAL LINK TO AVIATION DAIRY
- HARVEY'S ~ OLDEST FAMILY STORE
- KARATE BUILDING - OLDEST COMMERCIAL BUILDING ON STREET
- MORE TREES ON NORTH SIDE OF NORQUAY PARK
- FENCE IS UGLY
- CLARENDRON/SLOKAN K'WAY - NORTH SIDE
- NORQUAY IS ONE OF THE OLDEST NEIGHS.
- LET THE WORLD KNOW RE: HISTORY.
- NEON SIGNS (WALLY'S, ZAO, DRAGON INN)
- POLKS + HEART ~ HERITAGE + MATURE TREES.

**TRANSPORTATION:**

- PEDESTRIAN WALKWAYS
- PEDESTRIAN STREET ADJACENT TO PARK.
- KINGSWAY DIFFICULT TO GET ACROSS.
- COMMUNITY SHUTTLE BUS.
- CONNECTIONS AND LINKS TO HUBS.

**COMMUNITY FACILITIES AND AMENITIES:**

- UNDER USED NORQUAY PARK - TENNIS COURTS? - MORE PROGRAMMING AND VARIETY OF USES AND ACTIVITY. JOGGING TRACK
- GREENWAYS.
- COMMUNITY CENTRE, SEATING, SENIORS FACILITY, COMMERCIAL FACILITY SUCH AS COFFEE SHOP AND BANK.

**SUSTAINABILITY:**

- COMMUNITY ORGANIZATION TO START GREENING INITIATIVES.
- EXPLORE GEOTHERMAL ENERGY OPPORTUNITIES IN PARKS
- ORGANIC/COMPOST IN PARKS

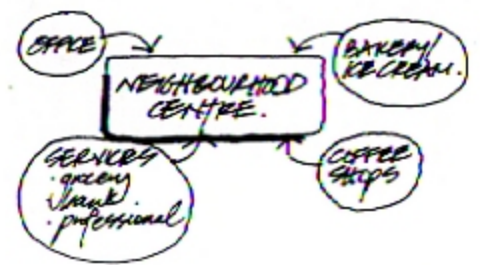

**PUBLIC REALM:**

- GRASS BOULEVARDS CAN BE UNKEMPT - THINK OF OTHER METHODS OF PERMEABLE SURFACES (I.E. PAVERS, ROCKS)
- WIDER SIDEWALKS ALONG KINGSWAY
- SOME AREAS WITHOUT SIDEWALKS
- NORQUAY PARK COULD HAVE MORE PROGRAMMING, SUCH AS TENNIS OR FOOT OR GARDENS.
- CROSSINGS NEEDED ACROSS KINGSWAY AT 34th AND AT KILLARNEY.
- PEDESTRIAN WALKWAYS - NORTH/SOUTH ALONG WALES - EAST/WEST ALONG 34th + LINE BETWEEN
- PEDESTRIAN STREET WITH SHOPPING BEHIND KINGSWAY.
- GENERAL LIGHTING
- TRAFFIC CIRCLES PLANTING IN POOR CONDITION.
- NEIGHBOURHOOD GREENWAY ON CITY R.O.W.
- LANE BEHIND COMMERCIAL AREAS ~ DOUBLE FRONTING COMMERCIAL.

**SHOPS + SERVICES:**

- BANK NEEDED
- HIGH TURNOVER AND POOR MAINTENANCE FOR MANY BUSINESSES ALONG KINGSWAY.
- GROCERY STORE / COFFEE SHOP. - PATTON BILLBOARD SITE OR ROYAL BANK SITE
- AREA NEEDS AN ANCHOR STORE

**HOUSING:**

- DEVELOPMENT TO HAPPEN GRADUALLY, WITH DIVERSITY.
- MULTI USE ON KINGSWAY, NOT SINGLE USE.
- VARIETY OF TYPES - NOW AND TO ACCOMMODATE FUTURE HOUSING REQUIREMENTS.
- PROVIDE INFO FOR CURRENT RESIDENTS ON REDEVELOPMENT/RENOVATION OPTIONS - SO PEOPLE CAN STAY IN THE NEIGHBOURHOOD
- PROVIDE INCENTIVES FOR GREEN BUILDINGS

WOULD LIKE TO SEE TALLER AND MORE INTERESTING BUILDINGS ON K'WAY

TRUCKS TURNING ON 40th -> DAMAGING NORTH END OF EARLES PARK

TREES PLANTED ON THE EDGE OF PARK ALONG 41st. (BUFFER FROM TRAFFIC)