

SW SESSION NOTES
FEB 28 '09
WITH MAR 7 '09 REVISIONS

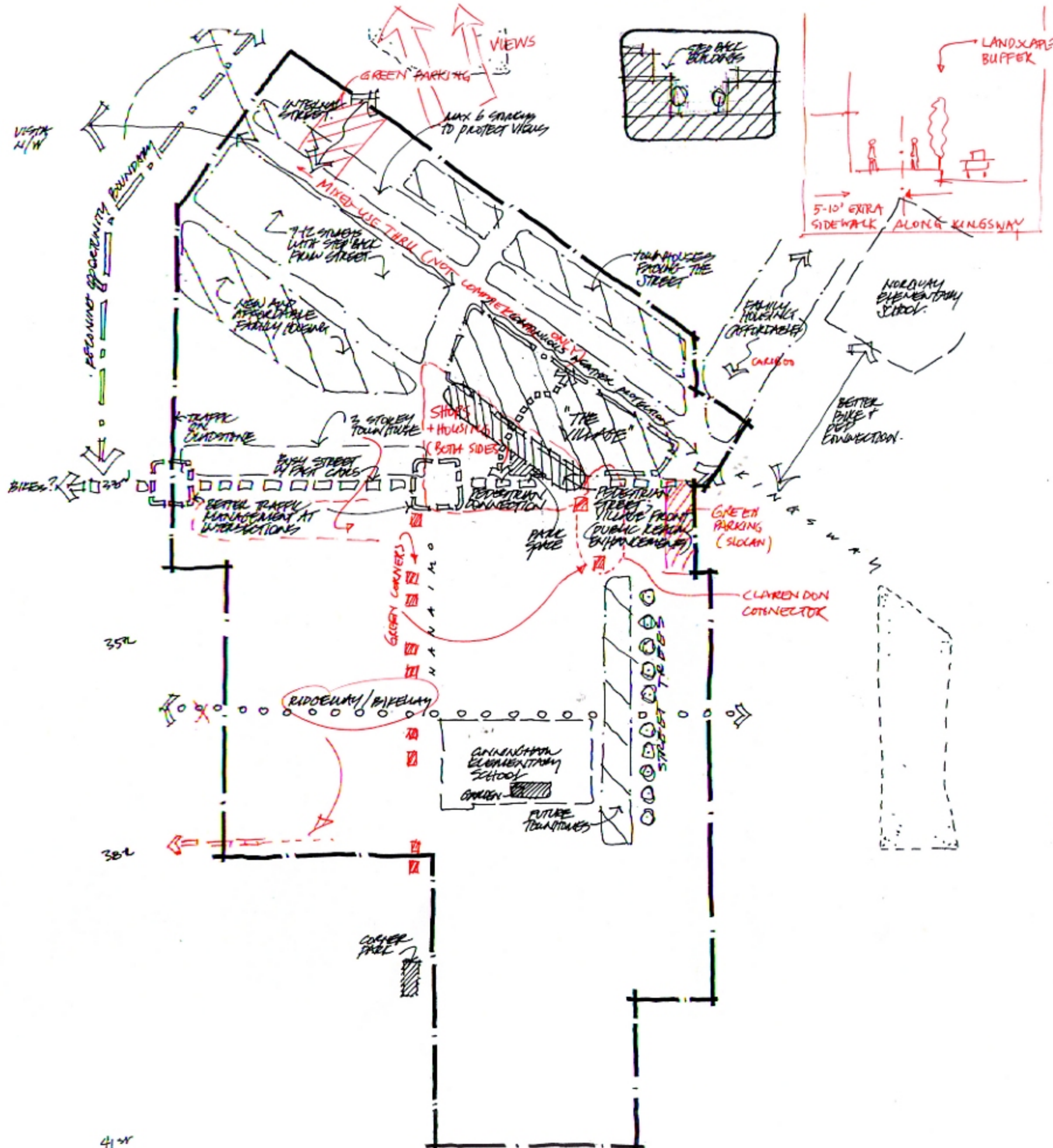

PARKING, TRAFFIC + SAFETY:

- GREEN PARKING LOTS
- ON STREET PERPENDICULAR TO KINGSWAY

CHARACTER + PLACE:

- DEAMONSTRATION
- 2400 HOTEL AS HERITAGE - SOME IMPROVEMENTS WORTH PROTECTING?
- DON'T CREATE WALL OF BUILDINGS ALONG KINGSWAY - STEP BACK

TRANSPORTATION:

- TRAFFIC MANAGEMENT NEEDED ON 35th AT CLARENDON AND AT KINGSWAY
- PEDESTRIAN STREET FOR VILLAGE FEEL
- PUT CYCLING FACILITY ON 35th TO CONNECT NEW VILLAGE WEST - CYCLING FROM KINGSWAY TO NORQUAY SCHOOL (CONNECTION)

COMMUNITY FACILITIES AND AMENITIES:

- WORK WITH SCHOOL BOARD TO MAKE GREENINGHAM SCHOOL A BETTER GREENSPACE
- MAKE BETTER USE OF EXISTING CITY RESOURCES + PROGRAMS

JUSTAINABILITY:

- GREENING THE PARKING LOTS

PUBLIC REALM:

- GENERAL STREET IMPROVEMENTS NEEDED THROUGHOUT THE WHOLE AREA
- OPPORTUNITY FOR PEDESTRIAN STREET AT THE 'VILLAGE' LOCATION - BUSES, ETC.
- STREET TREES ALONG CLARENDON ST.
- CONTINUOUS WEATHER PROTECTION ALONG KINGSWAY
- WAYS TO BREAK UP LONG BLOCKS ALONG KINGSWAY
- MORE SMALL GREEN SPACES THROUGHOUT THE NEIGHBOURHOOD

SHOPS + SERVICES:

- SUPERMARKET JUST OFF ARTERIAL (BUT WITH NEIGHBOURHOOD FEEL)
- WALKABLE 'MARKET' AREA IN VILLAGE - (BACKSIDE OF KINGSWAY) - ESPECIALLY WITH INCREASED DENSITY
- CLEAN UP BIN AREAS, HYDRO WIRES THROUGHOUT

HOUSING:

- SOCIAL HOUSING AND SENIORS HOUSING ALONG KINGSWAY
- FAMILY HOUSING IN THE BACKSIDE OF KINGSWAY OR BEHIND IT
- AFFORDABLE HOUSING ALONG SLOAN BETWEEN KINGSWAY + NORQUAY SCHOOL
- TOWNHOUSES SURROUND THE HIGHER DENSITY VILLAGE ZONE
- STEP BACK DEVELOPMENT ON KINGSWAY
- VILLAGE - 7-12 OR 14 STOREYS (WOOD VS. CONCRETE)
- TOWNHOUSES SOUTH OF 34th
- LANDMARK HOUSING
- RELATED AREAS NEED GUIDELINES