

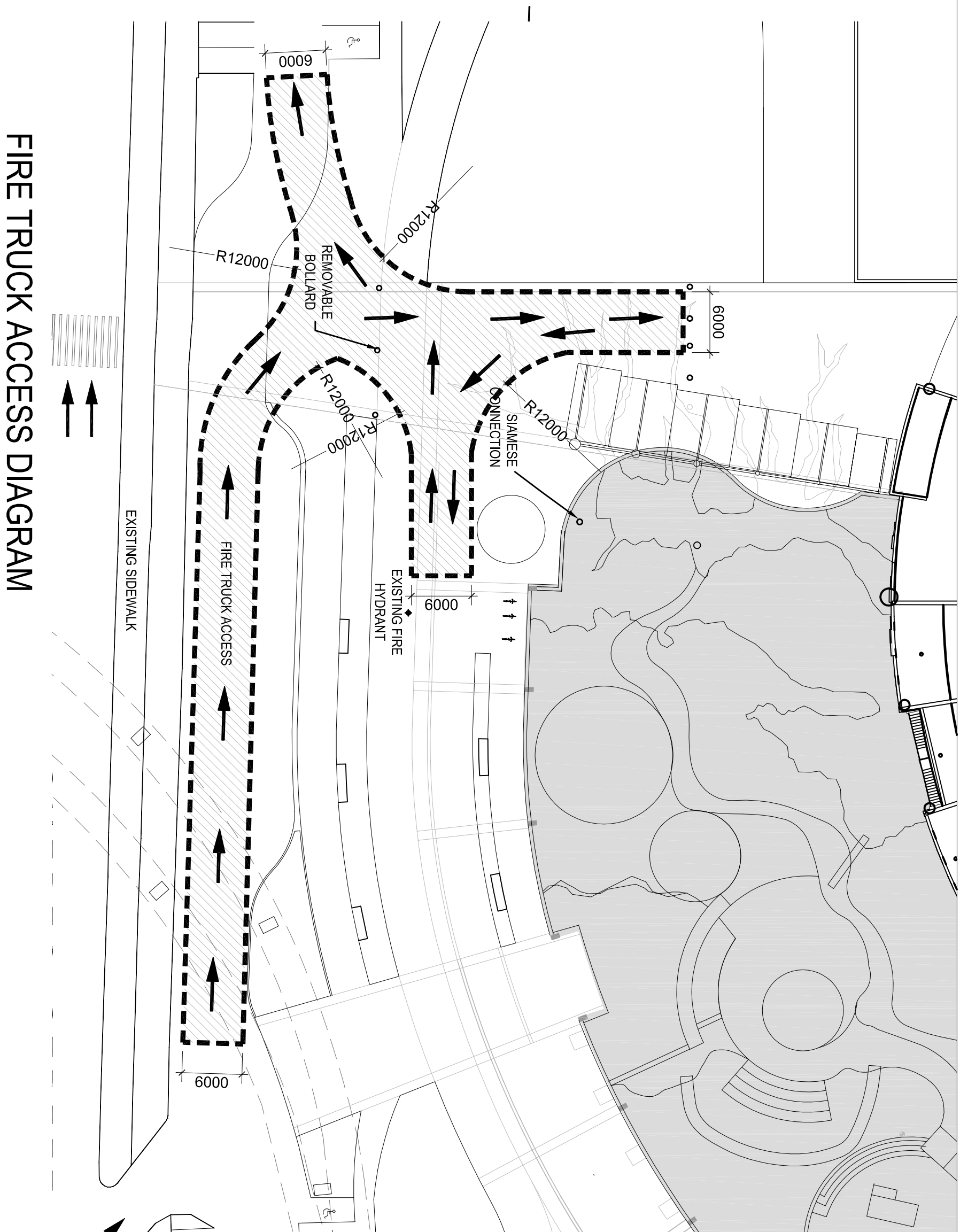

City of Vancouver may be doing another program similar to Commercial Drive Bike Parking this year and we would like to know what kind of design refinements the BAC would suggest.

Staff looking for information feedback on current design.

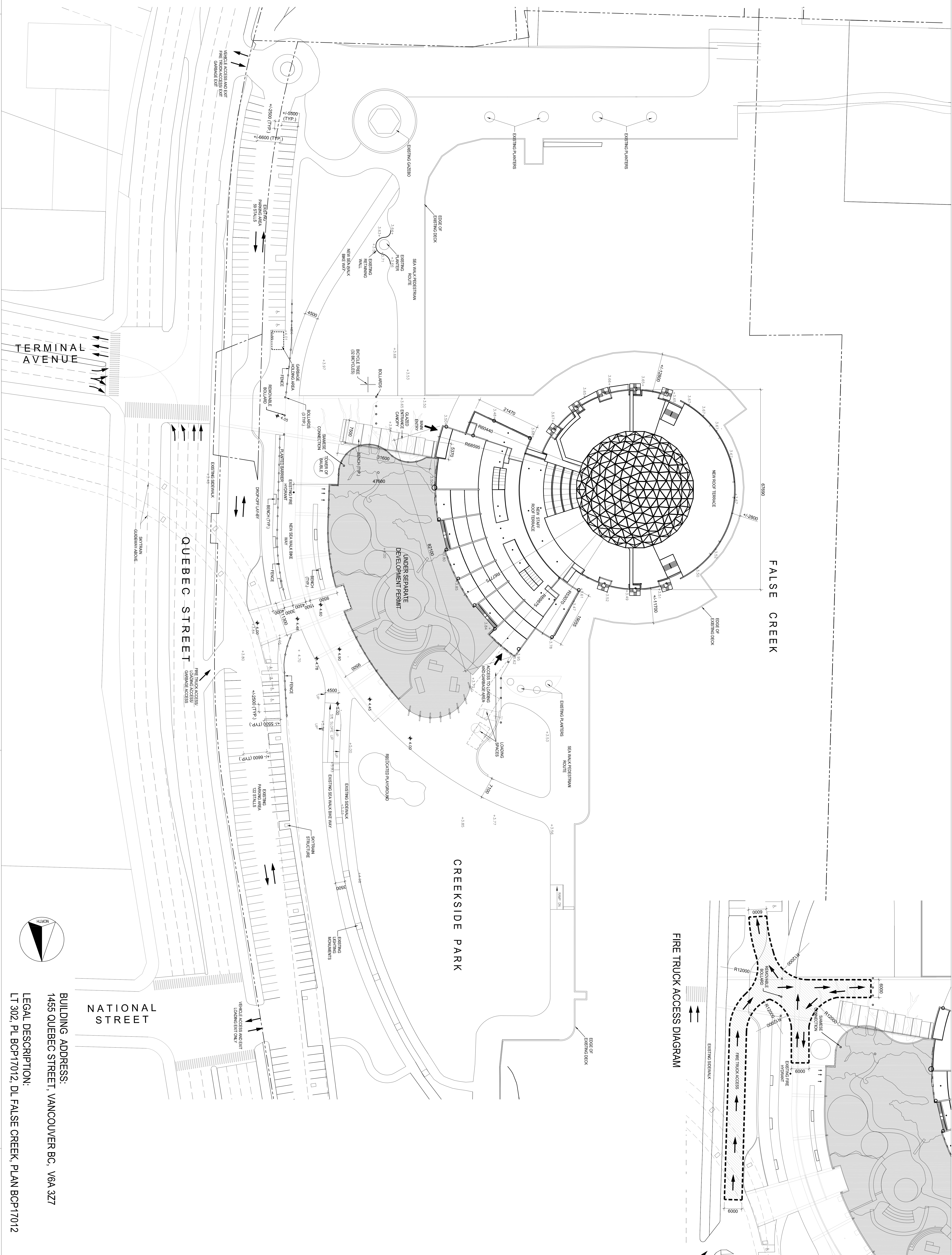

BUILDING ADDRESS:
1455 QUEBEC STREET, VANCOUVER BC, V6A 3Z7

LEGAL DESCRIPTION:
LT 302, PL BCP17012, DL FALSE CREEK, PLAN BCP17012

NATIONAL STREET

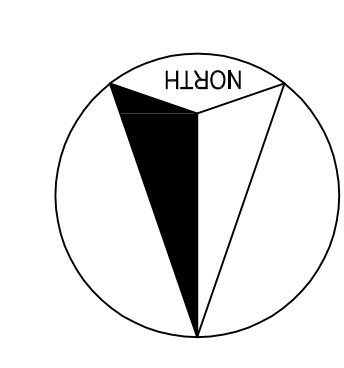

© COPYRIGHT RESERVED. THIS DRAWING IS AN INSTRUMENT OF SERVICE AND IS THE PROPERTY OF CANNON DESIGN ARCHITECTURE INC. THIS DRAWING MAY NOT BE REPRODUCED WITHOUT THEIR PERMISSION. AND UNLESS THE REPRODUCTION CARRIES THEIR NAME, ALL INFORMATION SHOWN ON THIS DRAWING, GRAPHIC OR OTHERWISE, ARE FOR USE ON THE SPECIFIED PROJECT ONLY, AND SHALL NOT BE USED FOR ANY OTHER PROJECT WITHOUT THE WRITTEN PERMISSION FROM CANNON DESIGN ARCHITECTURE INC.

