

# FALSE CREEK SOUTH

TOPIC WORKSHOP 6: Character and Urban Design

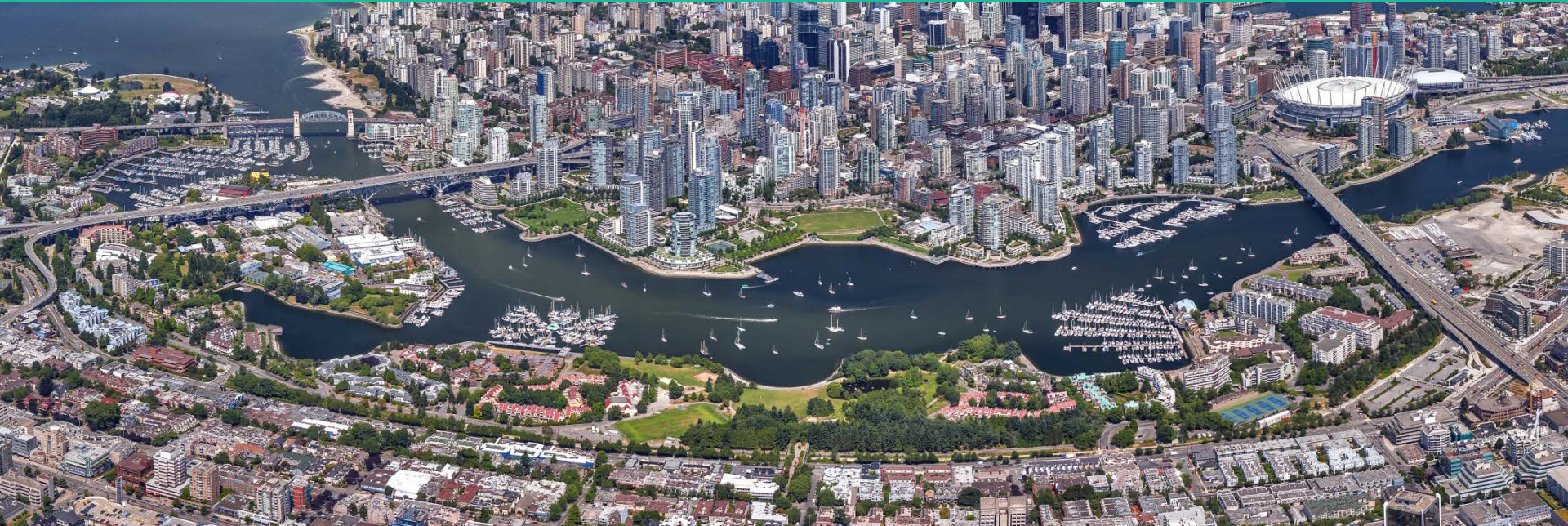

Saturday, February 3, 2018 | False Creek Community Centre 3:30 – 7 PM

1



**Welcome**







# FALSE CREEK SOUTH

## Workshop series:

- Explore community values, identify issues, share ideas
- Develop community-wide planning and urban design principles

## Next Steps:

- Plan for Phase 1 “community edge”





# FALSE CREEK SOUTH

## Workshop Series

We Are Here!



①

HISTORY

Nov 25

②

SUSTAIN-  
ABILITY

Dec 2

③

PUBLIC  
REALM +  
OPEN  
SPACE

Jan 10

④

HOUSING

Jan 13

⑤

TRANS-  
PORTATION

Jan 24

⑥

CHARACTER  
+ URBAN  
DESIGN

Feb 3

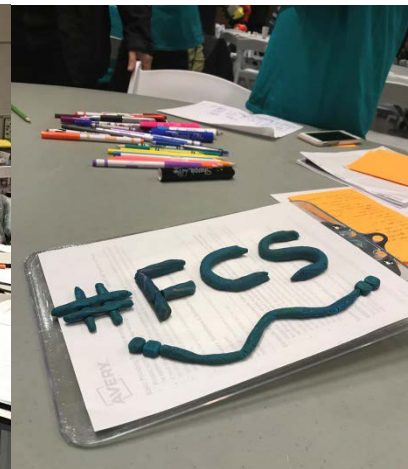
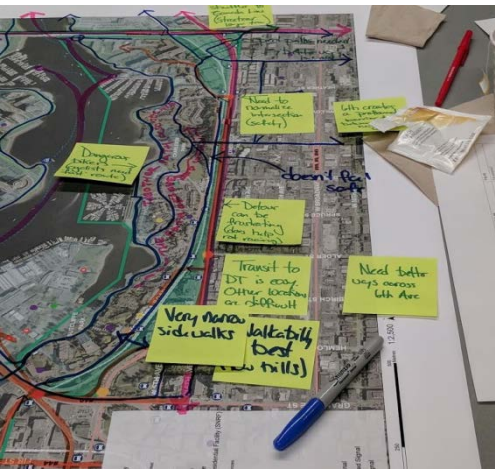



# FALSE CREEK SOUTH

- Upcoming end-of-lease issues
- Changing community demographics
- Long-term community sustainability and resiliency issues
- Affordable housing crisis
- Need to improve connections





# FALSE CREEK SOUTH

## Introductions:

### \*RePlan, committee of False Creek South Neighbourhood Association

- Mission is to create a dialogue with the City of Vancouver to establish a process to preserve and enhance the False Creek South community beyond lease end, enabling the community to evolve and diversify in a way that is sustainable for existing residents and the City of Vancouver.

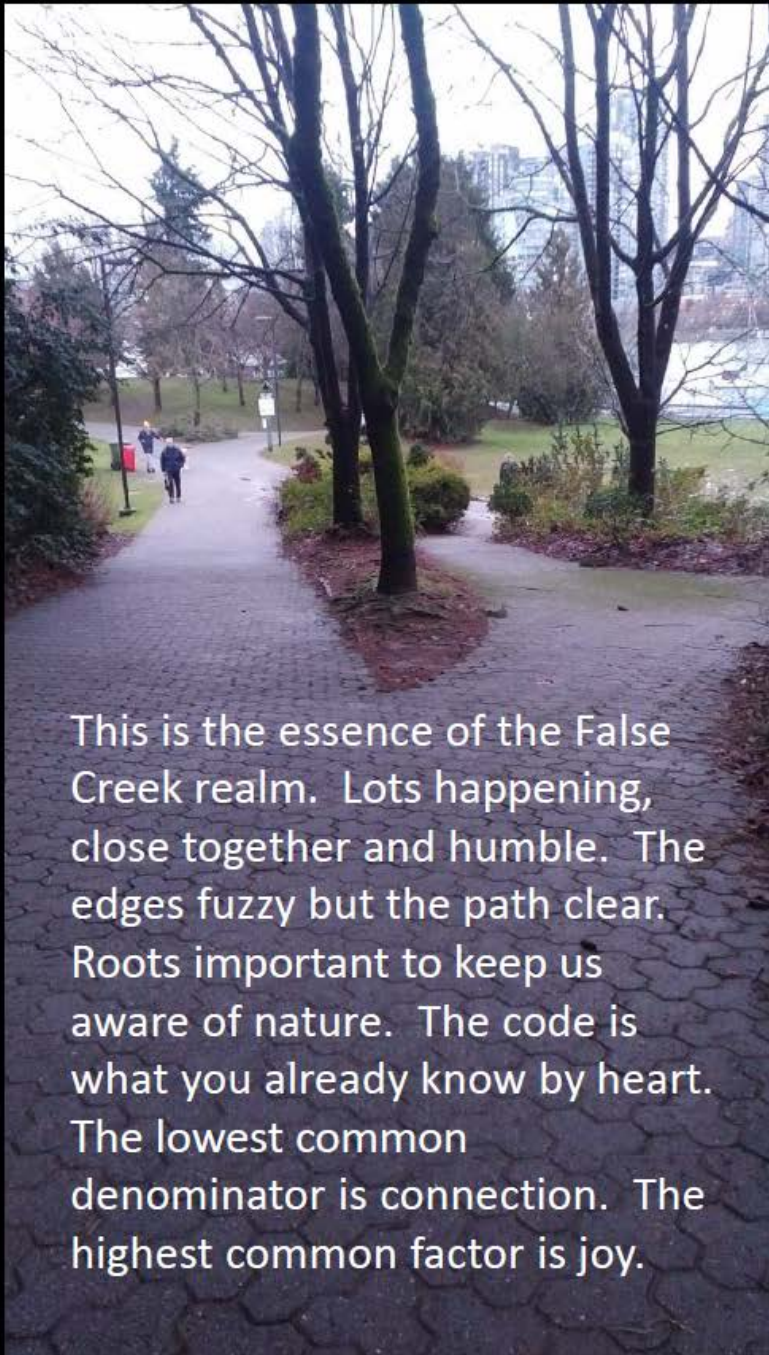

A photograph of a paved path in a park. The path is made of dark, irregular stones and leads into the distance. On the left, there are several trees with bare branches, and a few people are walking. On the right, there are more trees and a body of water. In the background, a city skyline with tall buildings is visible under a cloudy sky.

This is the essence of the False Creek realm. Lots happening, close together and humble. The edges fuzzy but the path clear. Roots important to keep us aware of nature. The code is what you already know by heart. The lowest common denominator is connection. The highest common factor is joy.

**2**

---

**Workshop  
Overview**



# FALSE CREEK SOUTH

## Workshop Participants

- 65% False Creek South residents
- 35% Non-False Creek South residents



# FALSE CREEK SOUTH

## Study Area Boundary

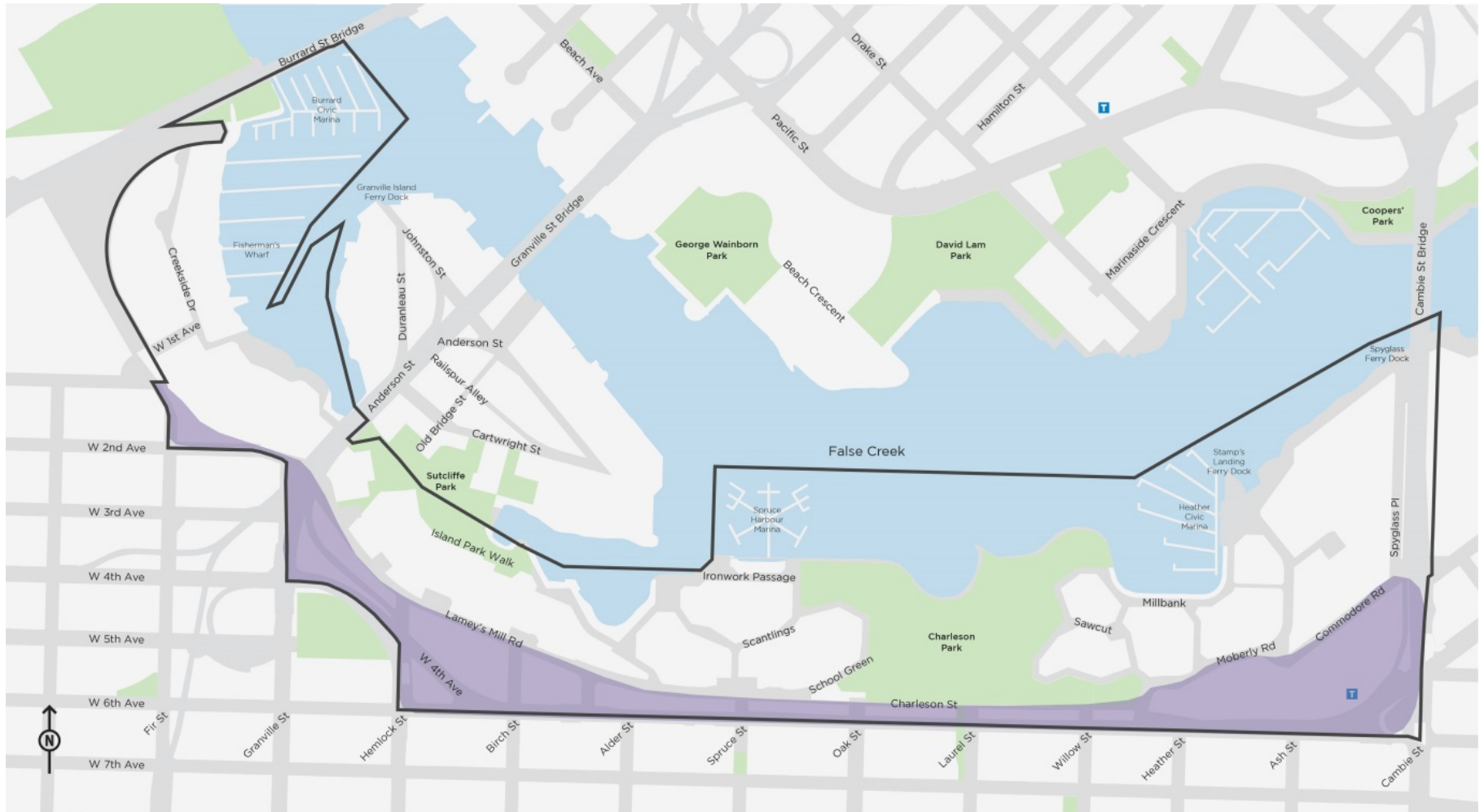

- LEGEND**
- Area boundary
  - Street
  - Park
  - T Transit station
  - Phase 1 Focus Area



# FALSE CREEK SOUTH

## Workshop Objective

- Acknowledge **what is important** about the urban design of FCS today
- Introduce **emerging urban design principles** and seek your input

# TODAY'S OUTLINE

1. Introductions + Background
2. Presentation: History of the Design of FCS
3. Discussion: SWOT
- \* \* \* **BREAK** \* \* \*
4. Presentation: Emerging Urban Design Principles
5. Discussion + Mapping
6. Report Back + Closing



**3**

**Presentation**









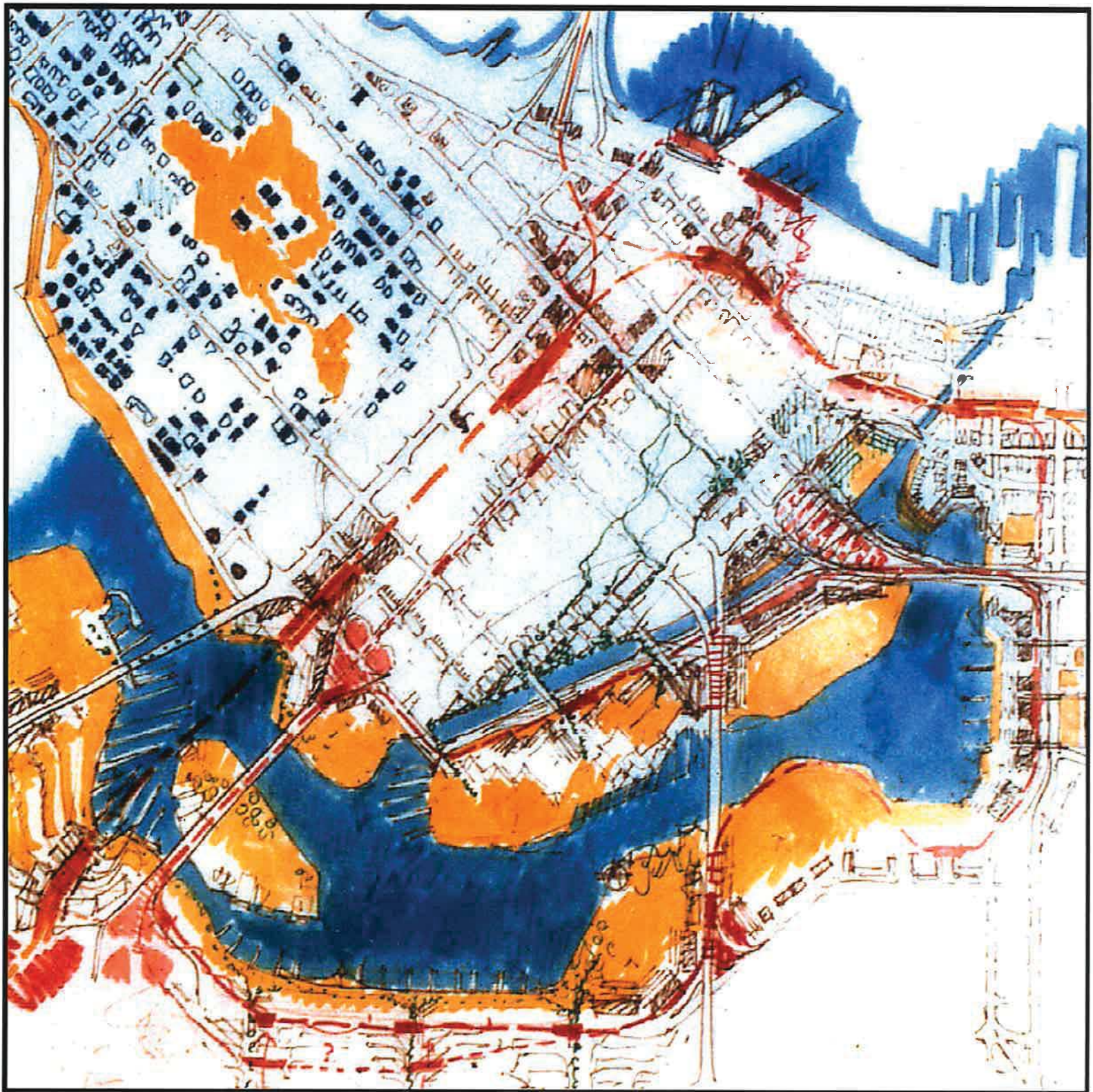







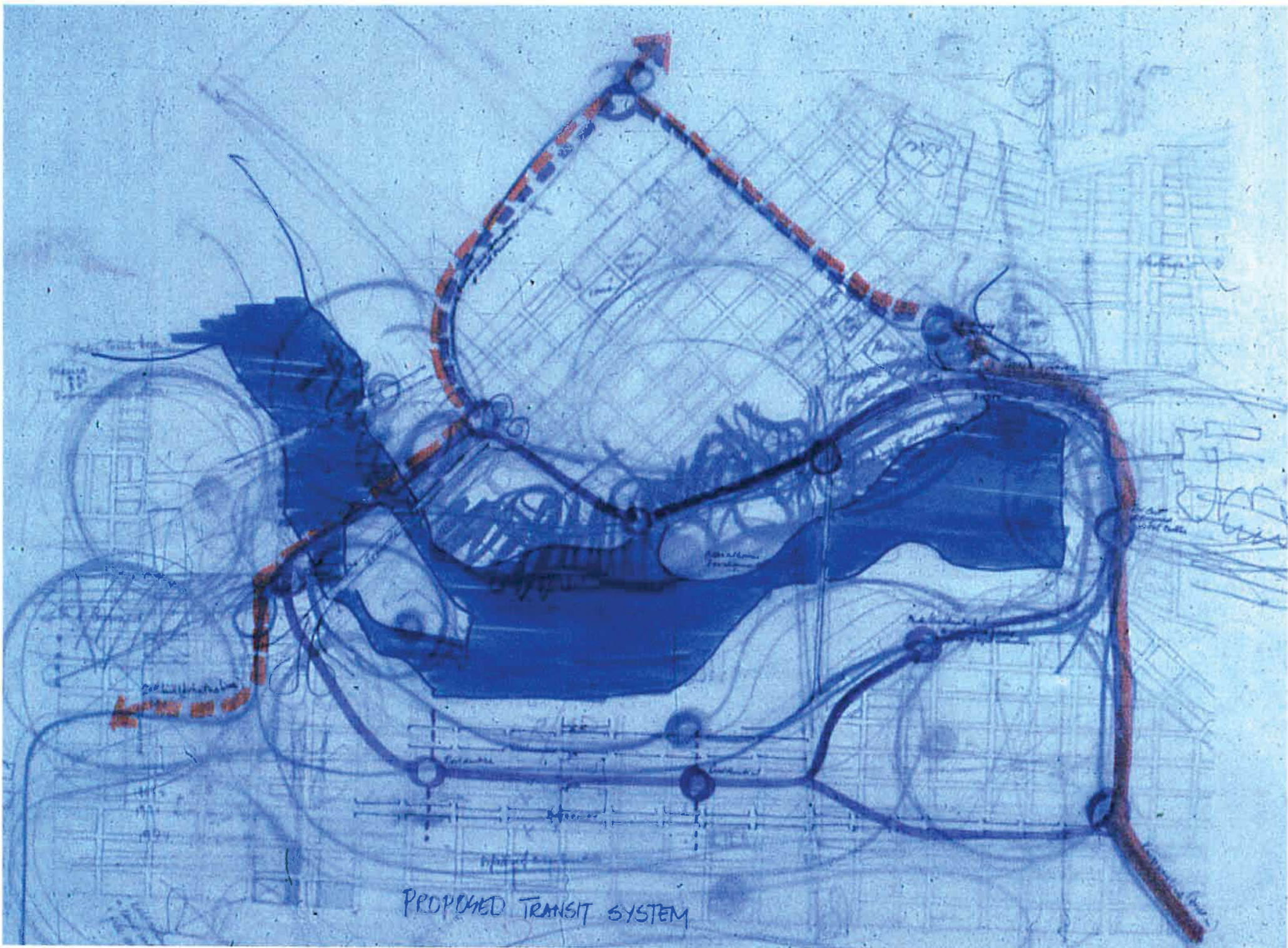

PROPOSED TRANSIT SYSTEM



ENCOURAGE CONSIDERABLE PARKLAND.

but - allow building up to edge where  
considered acceptable.

REASON.

- False creek must serve city - not just  
immediate vicinity
- some building at waters edge  
provides diversity of activity.

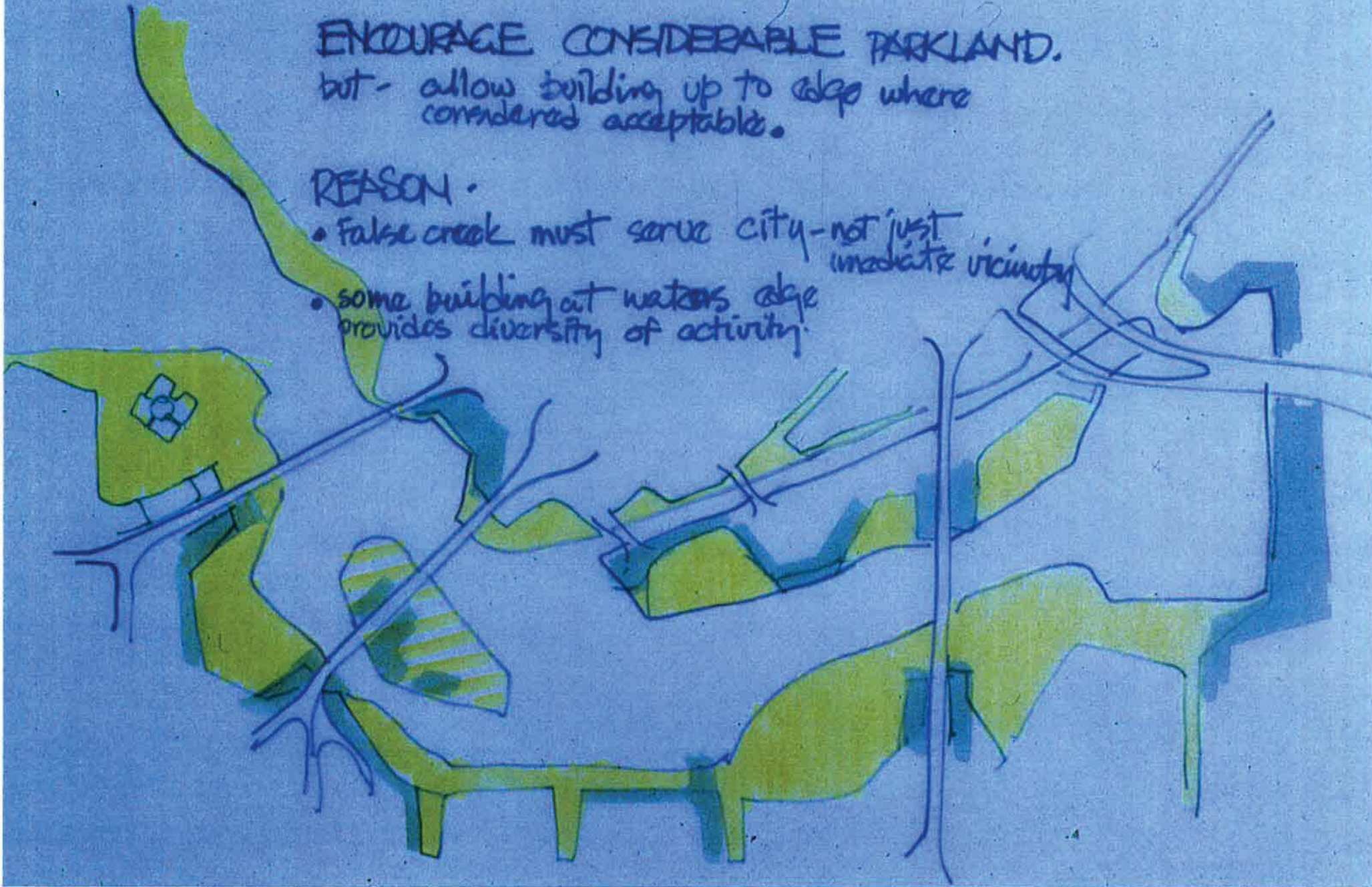



## Historical Context

# Waterfront Access

THE PUBLIC SHOULD HAVE ACCESS  
— TO THE ENTIRE WATERS EDGE ...

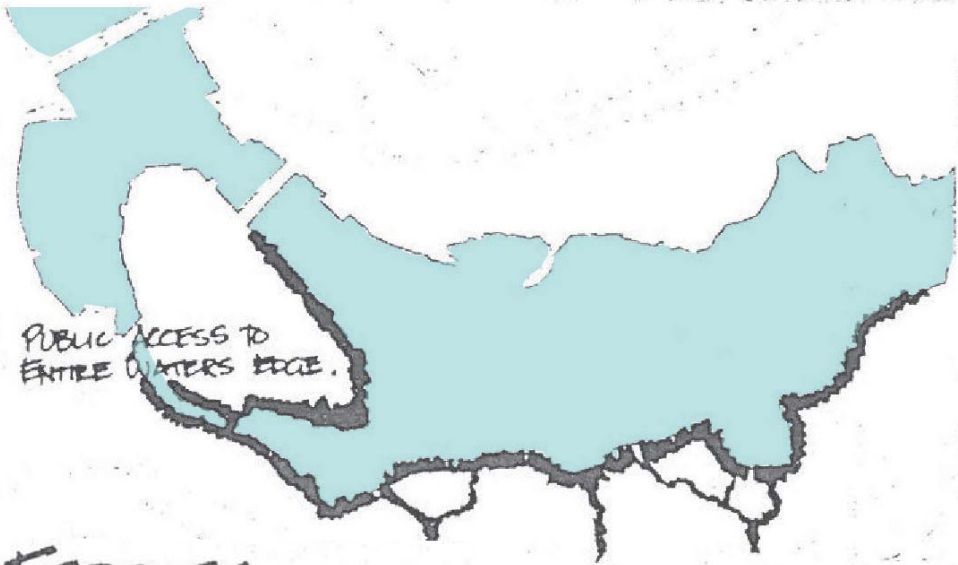

FERRIES ...  
FOR CROSSING  
THE CREEK.



# Pathways + Trails

## CIRCULATION NETWORKS

### PEDESTRIANS

SHOULD FIND A VARIETY OF PATHS OFFERING A VARIETY OF EXPERIENCE

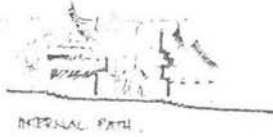

a squarier  
quantity of  
the building

OVER-PATH

### PEDESTRIAN PATHS IN EXPANDING LOOPS

A PEDESTRIAN SHOULD BE ABLE TO ENJOY ON A STREET IN A VARIETY OF DIRECTIONS AND BE ENSURED OF BEING ABLE TO CONTINUE ON A PATH THAT WILL RETURN HIM TO HIS DESTINATION WHERE HE BEGAN. THESE PATHS SHOULD CONNECT WITH OTHER LOOPS SO THAT A VARIETY OF DISTANCES MAY BE TRAVELLED AND STILL RETURN.



### PEDESTRIAN PATHS - LINED WITH ACTIVITIES

SHOULD CONNECT FOCUSES OF ACTIVITY - BOTH INSIDE AND OUTSIDE THE DEVELOPMENT AREA. ACTIVITIES HAPPEN BETWEEN RESIDENTIAL ENCLAVES

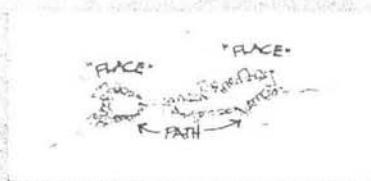



Historical Context

# Variety of Experiences

**PARKS**  
OPEN SPACE

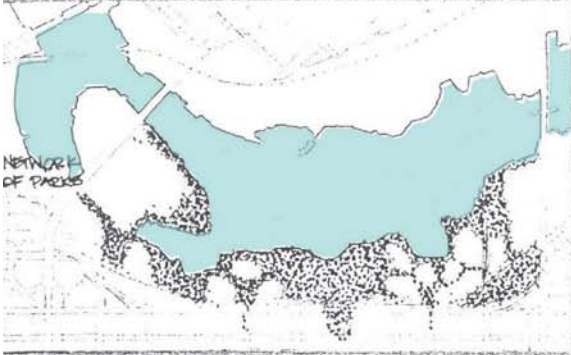

**NEIGHBOURHOOD**  
KIDDES PLAY-IN ENCLAVE ENCLAVE  
PEDESTRIAN PATHS- ETC

**PRIVATE**  
COURTYARDS BALCONIES GARDENS ETC

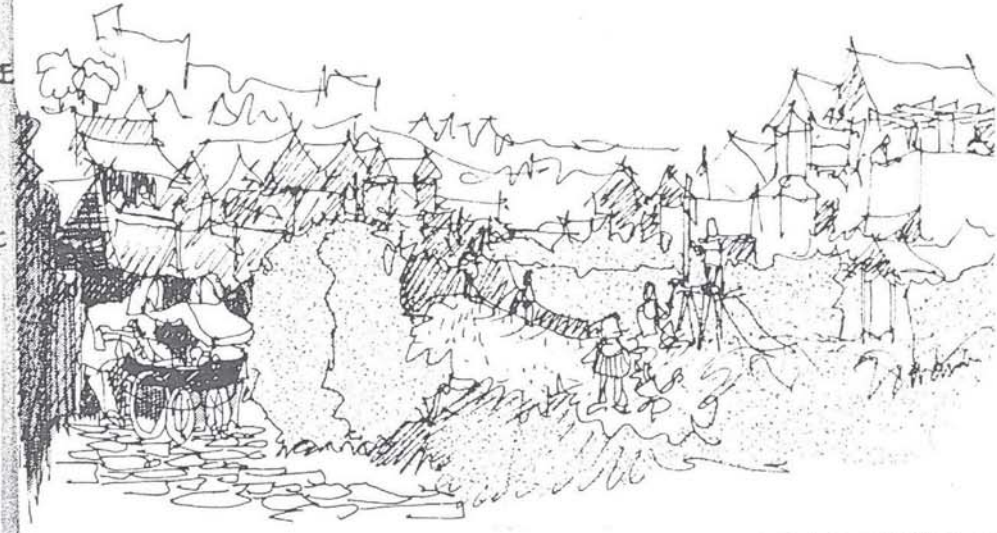

**PUBLIC**  
STREETS SQUARES  
PIERS URBAN FOREST  
BEACHES BRIDGES

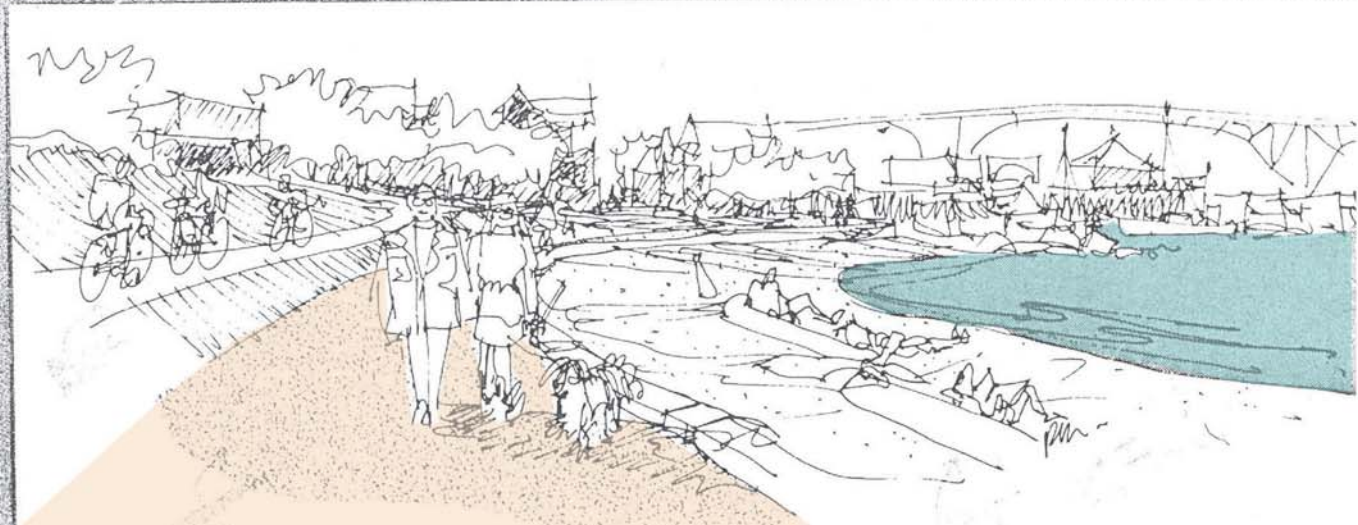
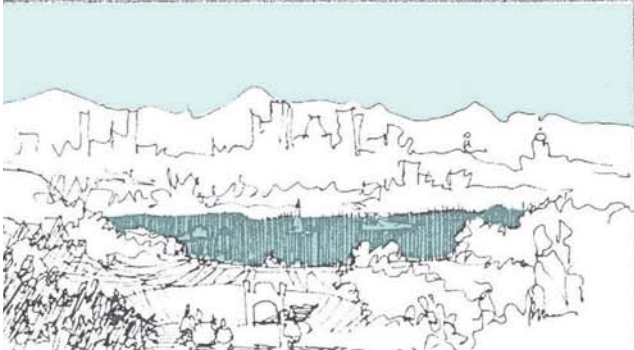
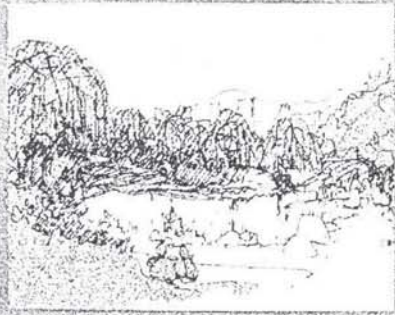



# Historical Context

## Connecting to Transit

### TRANSIT

EXISTING RAIL RIGHT-OF-WAY  
RESERVED FOR  
FUTURE TRANSIT.

quotes from City of Vancouver  
report on area to...

"ALL POSSIBLE EFFORTS SHOULD BE  
MADE TO ENSURE THE ADEQUATE  
PROVISION FROM THE TRANSIT  
AND POSSIBLE TO TRANSIT."

"TRANSIT SERVICES SHOULD BE  
INTRODUCED WITH THE  
FIRST DEVELOPMENT"

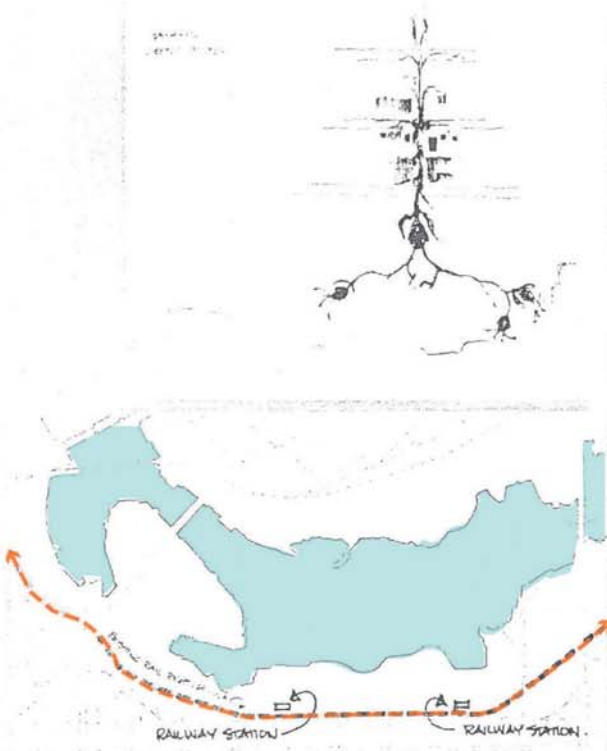

### SLOW/FAST GRADIENT

MEANS SIMPLY THAT THE INTENSITY  
AND NOISE OF ACTIVITY GRADUALLY  
DECREASES FROM SOUTH AVENUE TO  
THE RESIDENTIAL,  
SO YOU MAY FIND PEACE  
WHEN YOU GET THERE.

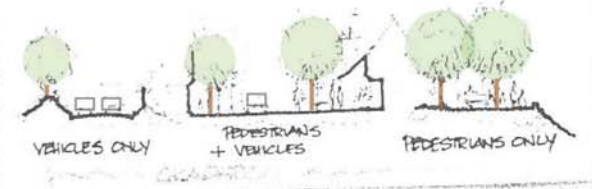

MINIMIZE CONFLICTS BETWEEN  
PEDESTRIANS & VEHICLES

FACILITATE OTHER FORMS  
OF MOVEMENT.

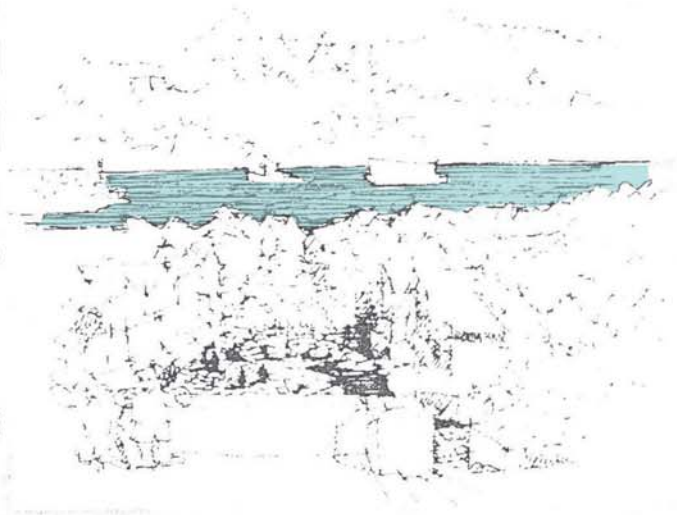
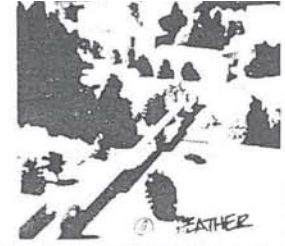

PEDESTRIANS  
CALKS  
(Transition from  
the existing  
streets and  
intermediate facilities)

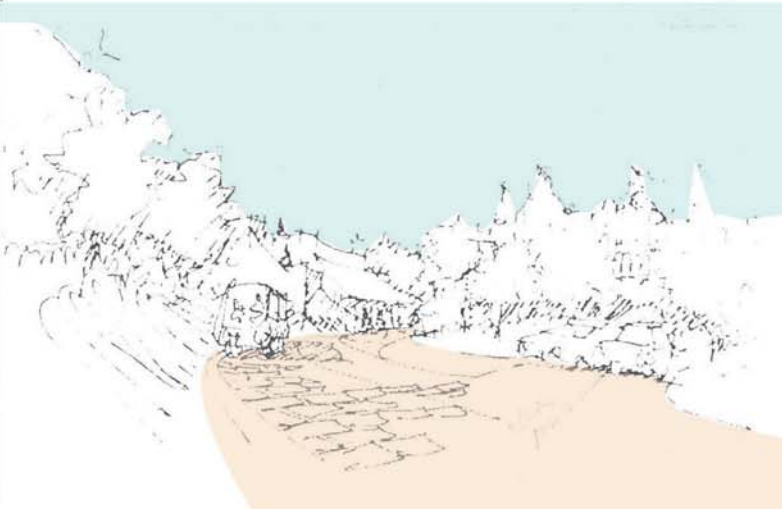



# Focus of Activity

## ACTIVITY FOCII

WHERE PATHS MEET - THE FOCUSING OF ACTIVITIES ABOUT A SQUARE, PLAZA, PLAZZA ETC.

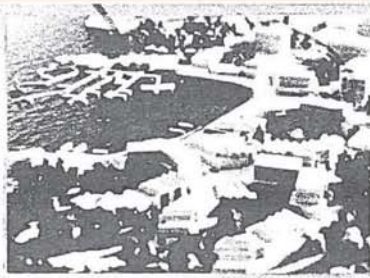
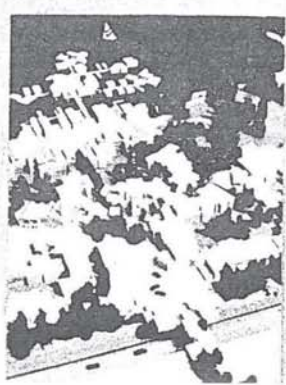
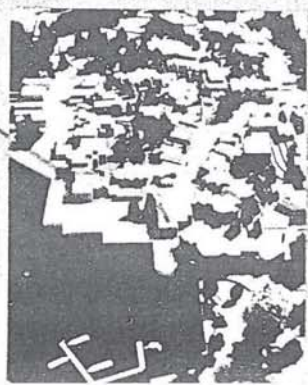
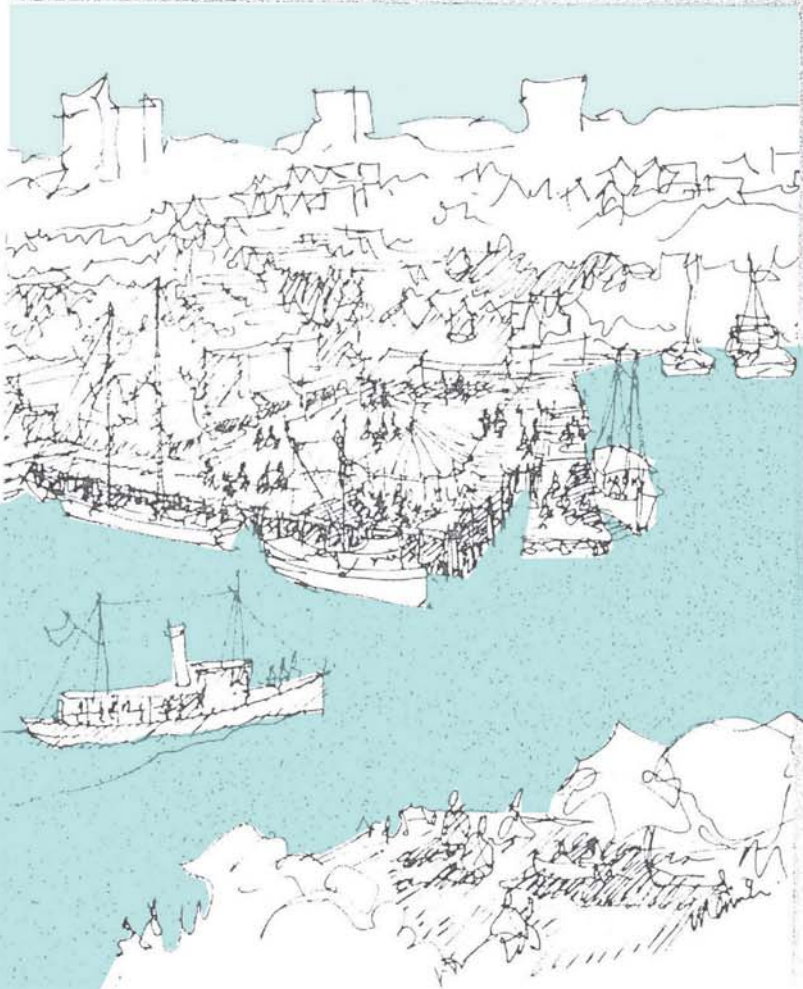



# Historical Context

## Community Uses

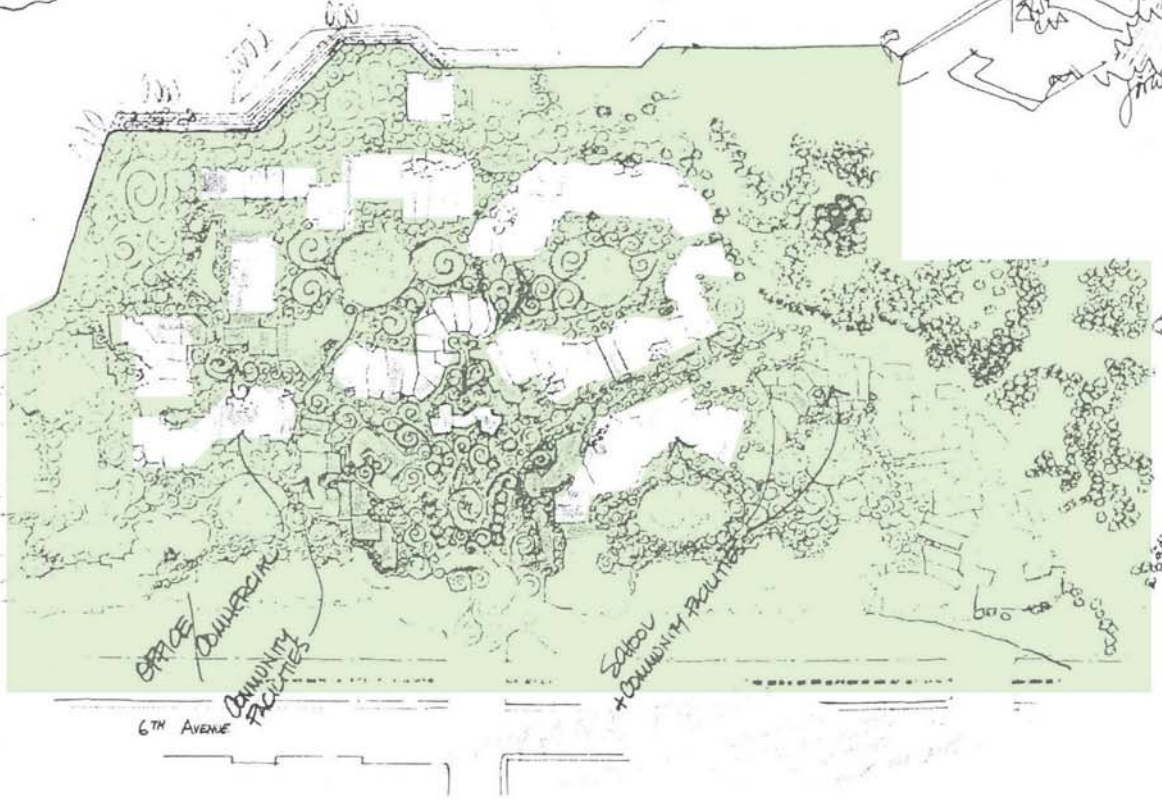
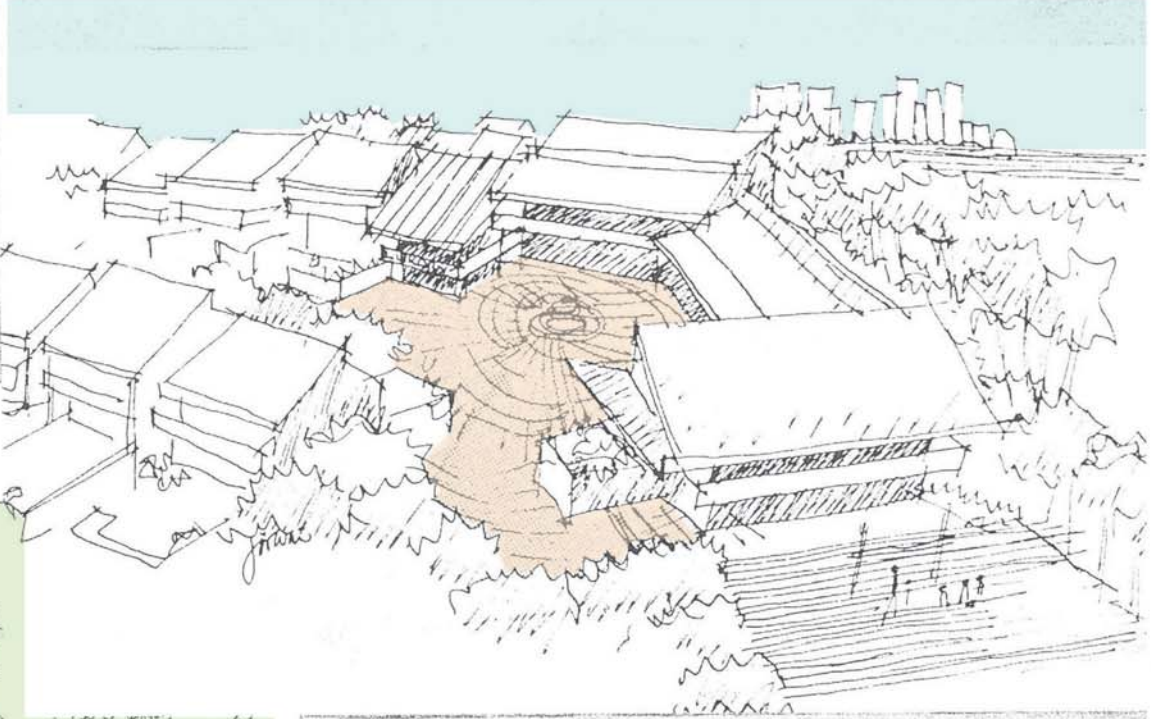



# HISTORICAL CONTEXT

False Creek Area 6 proposal  
T.B.P. +

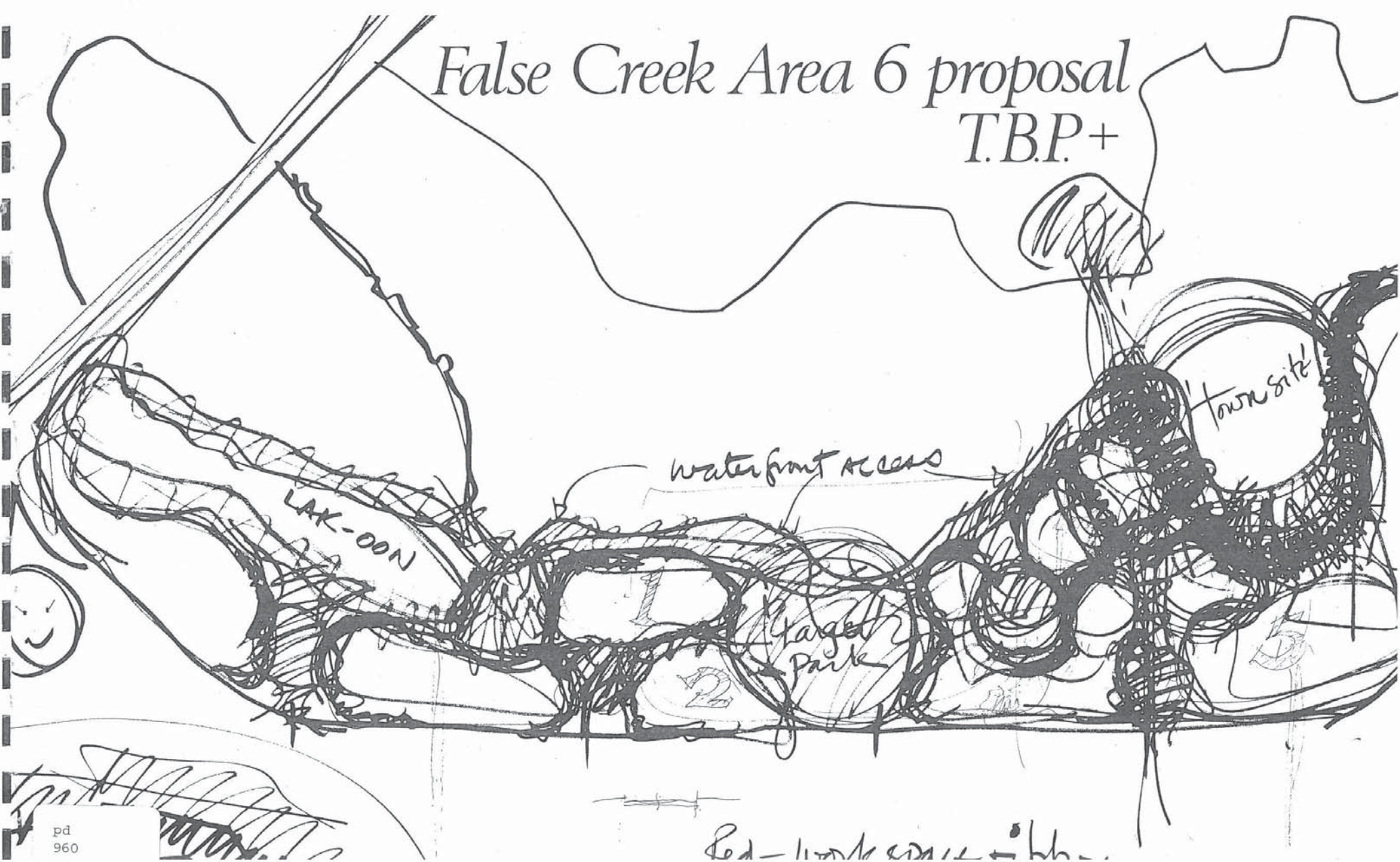











*"There are people from  
all walks of life - and it's a  
very stable community  
for my children."*

Mike Plunkett  
False Creek Co-operative  
Housing Association

This model of Phase I is on display at the  
Information Centre and identifies the various  
neighbourhoods, sponsors, and special features.

- A False Creek Information Centre  
& Marina Commercial Building  
with Future Restaurant
- 1 Kiwanis Club Senior Citizen Apartments
- 2 Bertha O'Clarke Society Rental Apartments
- 3 Rental Apartments, Frank Stanzl Construction Ltd.
- B Condominium Townhouses and Apartments,  
Frank Stanzl Construction Ltd.
- C Leg-in-Boat Square, Shops, Restaurants and Offices
- D Parking structure, 5 Rooftop tennis courts
- 4 False Creek Building Society, Townhouses
- 5 Creek Village Building Co-operative Homes
- 6 False Creek Housing Association Apartments

- E Heather Townhouse Condominiums, Frank Stanzl  
Construction Ltd.
- F Seawall
- G Rocky Pools
- H Grass Bowl
- I Waterfall
- J Playfield
- K Elementary School and Gymnasium
- L Adventure Playground
- 7 University Non-Profit Building Society, Co-op Units
- M Spruce Townhouse Condominiums, Frank Stanzl  
Construction Ltd.
- N Live-aboard Marina Co-operative
- 8 Society for the Physically Handicapped, Rental Apartments
- 9 The Netherlands Association, Rental Units
- 10 Co-operative Housing Association

*"I thoroughly enjoy  
walking along the seawall.  
I feel like I own a piece of the  
waterfront when I do that."*

Dorothy Romalis  
Writer  
Bertha O'Clarke Society

















*"False Creek South Shore is proving to be a highly successful inner city community for residents who live here and the public who enjoy the parks, marinas, waterfront walkways and the plazas. I am proud of the contribution so many people are making."*

Doug Sutcliffe  
Development Consultant, Project Manager  
False Creek Development Group



### **AREA 10-B**

Immediately west of Granville Bridge, plans call for a unique mix of private residential, public and commercial amenities.

Modelled on a highly successful development in Port Grimaud, France, some 270 homes are planned in three tiers around a waterfront piazza and promenade. All are designed to command a spectacular view of the water, city and mountains.

Adding a new and exciting dimension, three man made harbours are proposed inside the contour of the existing seawall complete with pedestrian walkways and bridges as well as two novel island housing enclaves.

Existing and new streets, promenades and paths are designed to converge on the piazza in series of stepped and converging spirals.

Thus the piazza will form a logical focus for social and community facilities, local shopping, dining and entertainment.

### **GRANVILLE ISLAND**

Strategically located in the middle of False Creek, the \$20 million Granville Island redevelopment program promises to add yet another exciting dimension to life on the south shore.

Once a quaint backwater of old warehouses, factories, and offices, the 37 acre island is destined to become a place for people. Soon the sounds of industry will be muted by the laughter of children, the chatter of sightseers, shoppers and students as they explore a colourful world of open waterfront, theatres, restaurants, museums and work areas for arts and crafts. A college of arts is also planned as well as maritime and farmers' markets and other facilities.

In short, a delightfully different oasis in the heart of the city.





# PROPOSED REDEVELOPMENT STRATEGIES FOR GRANVILLE ISLAND

an extension to the FALSE CREEK STUDIES

October

1972

PLANNING TEAM:

Reginald J. Cave, Richard C. Mann, Paul M. Merrick  
Robert B. Furukawa, Michael V. Geary, R. Rabnett (consultant)

before

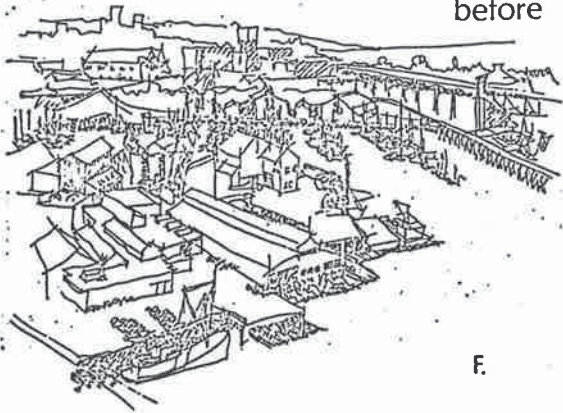

F.

after

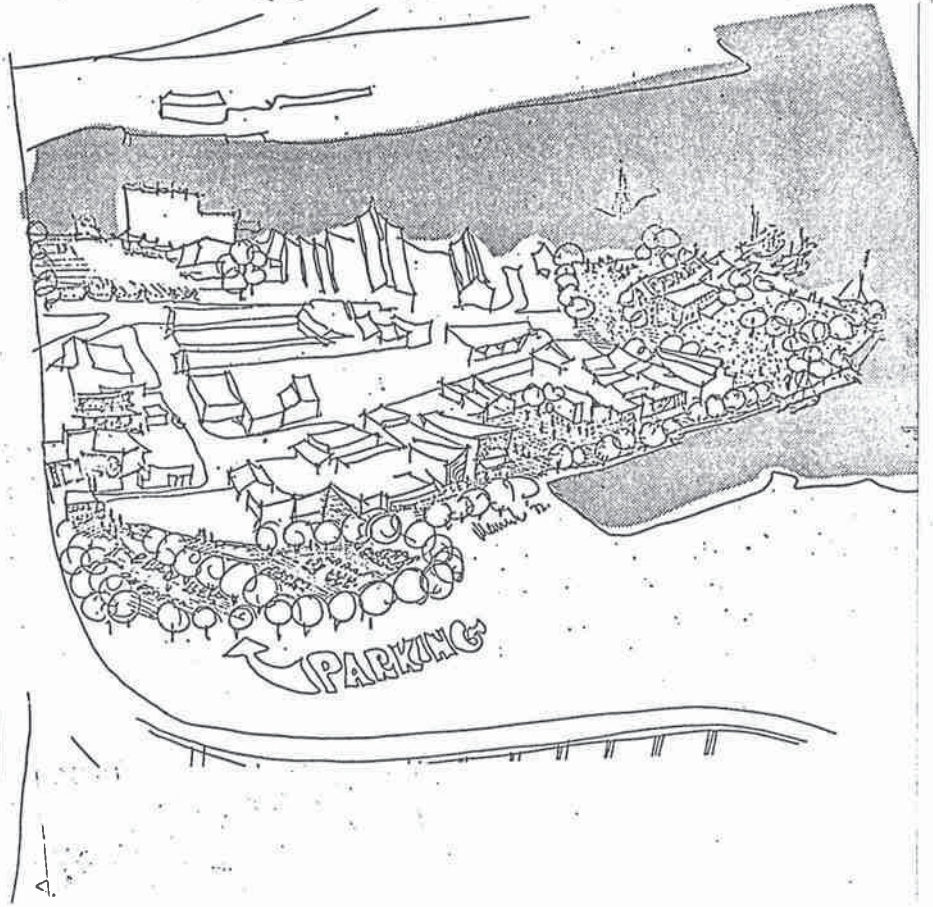
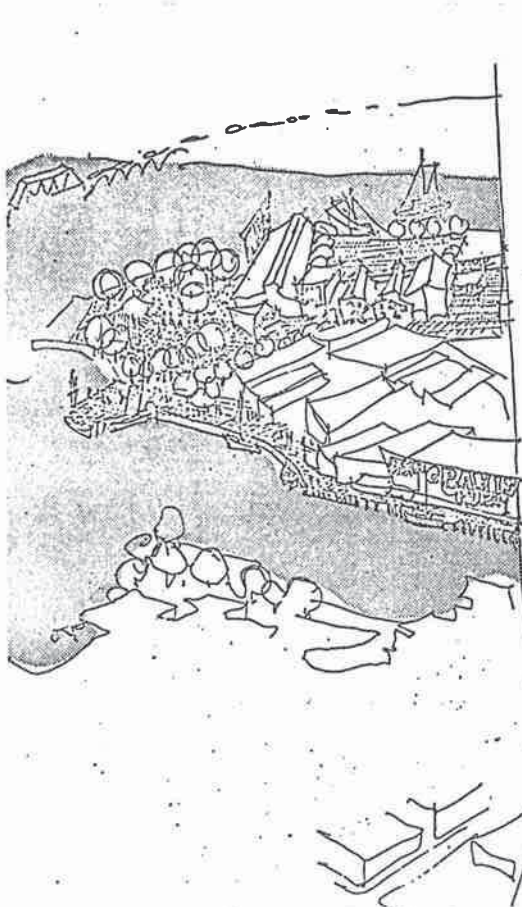
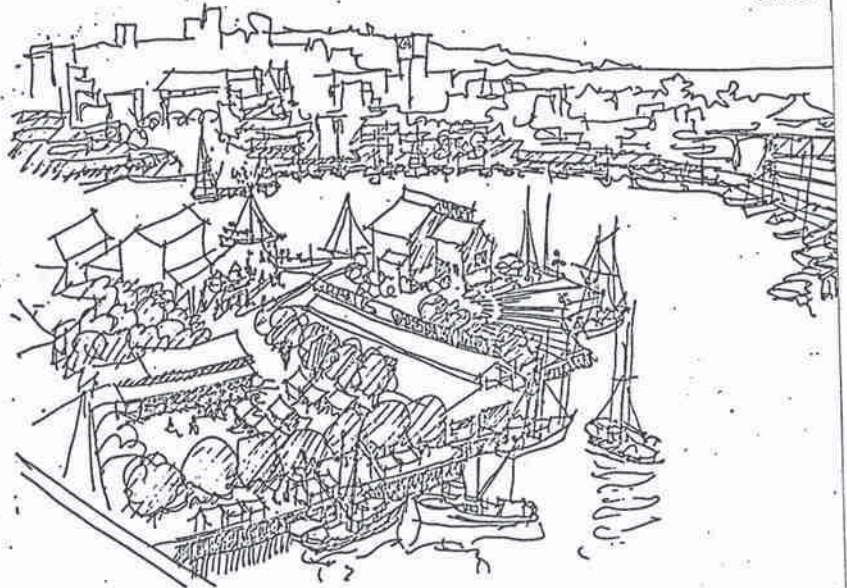

A view of Granville Island, looking north, showing the result of the strategy until 1982, recommended in this report.



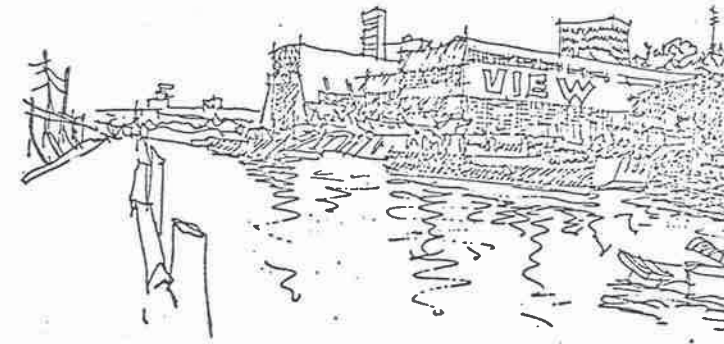

B. The sketch above shows the view which exists in the potential lagoon area.

The possibilities for improvement are at hand - this area can be transformed as shown at the left!



C. The sketch above was made standing in the middle of the eastern tip of the Island - looking northwest - opening this area would allow a view as shown at the left.





GO FORTH  
FIDELITY



Produced for the False Creek Development Group,  
City of Vancouver.

Majority of photographs are by Gary Otte, reprints  
of the False Creek Story courtesy of Western  
Living Magazine.

Art and Assembly by West Graphika Ltd.

Design and design by Project Marketing Ltd.

Marketing and Sales Co-ordination by J. Dahlberg  
Associates Ltd.



# False Creek

## South Shore

The Story of Vancouver's  
exciting new  
urban development program

Additional photographs by:  
Gar Lamney  
Tim Porter  
John Sherlock  
Gordon Saylor

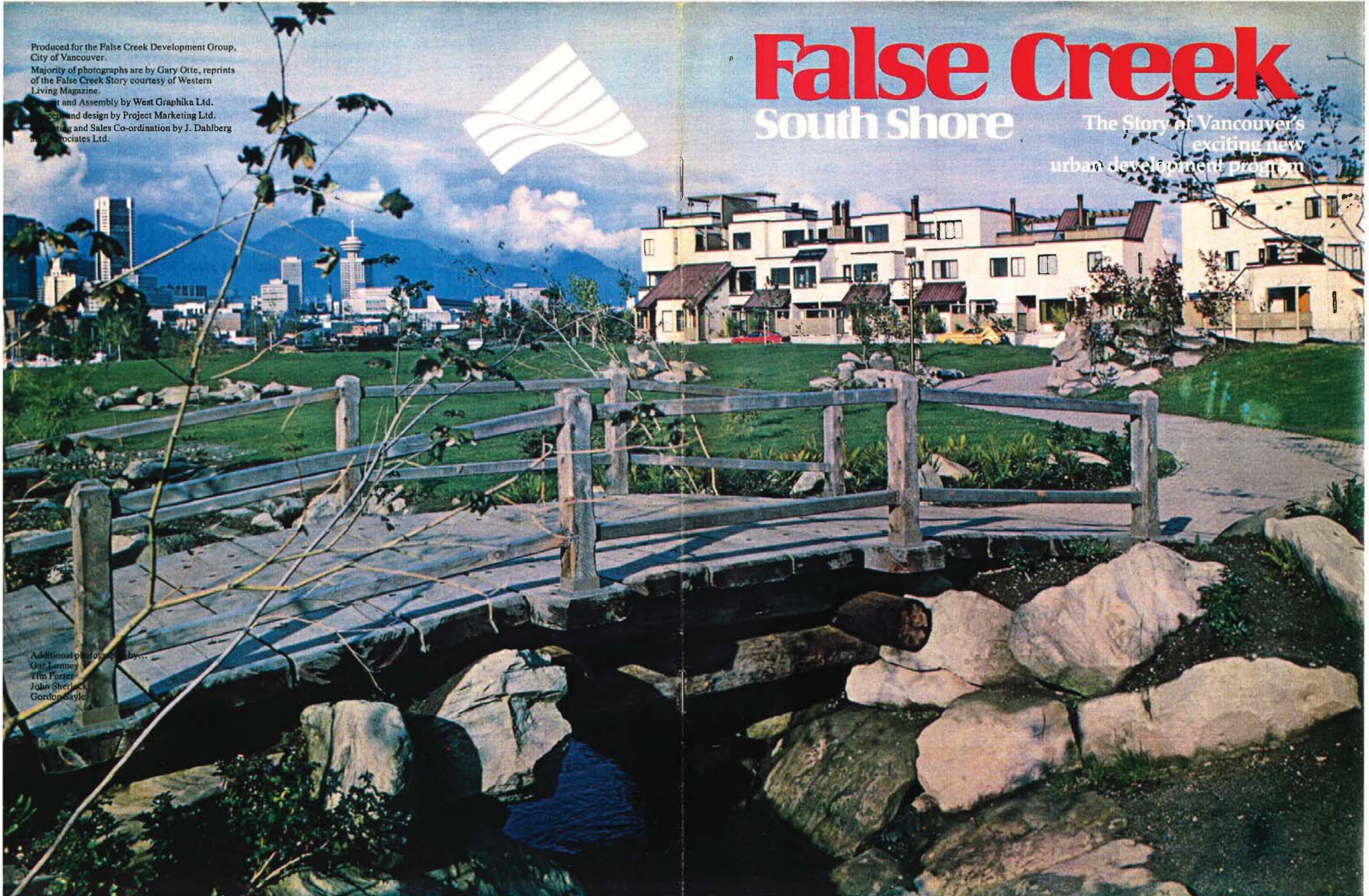



4

**SWOT**



# STRENGTHS, WEAKNESSES, OPPORTUNITIES, THREATS

- What is important about the urban design of FCS, and WHY?

TODAY	STRENGTHS	WEAKNESSES
FUTURE	OPPORTUNITIES	THREATS



**FCS**



**Break**



**5**



**Presentation**



# URBAN DESIGN BACKGROUND / CITY OF VANCOUVER





# URBAN DESIGN BACKGROUND / FALSE CREEK SOUTH

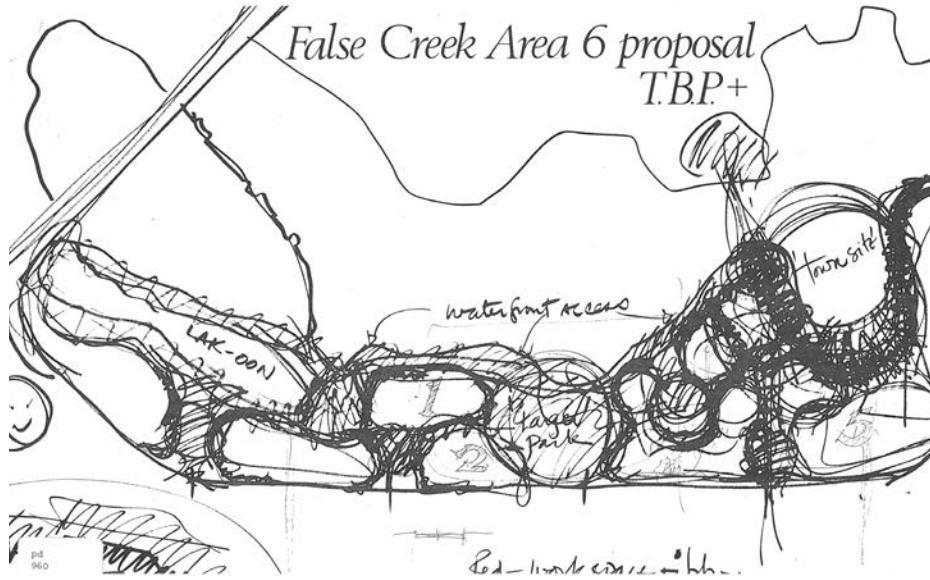

PEDESTRIAN PATHS IN  
**EXPANDING LOOPS**  
 A PEDESTRIAN SHOULD BE ABLE TO  
 EMBARK ON A STROLL IN A VARIETY OF  
 DIRECTIONS AND BE ENSURED OF BEING  
 ABLE TO CONTINUE ON A PATH THAT  
 WILL RETURN HIM TO HIS DESTINATION  
 WHERE HE BEGAN.  
 THESE PATHS SHOULD CONNECT WITH OTHER  
 LOOPS SO THAT A VARIETY OF  
 DISTANCES MAY BE TRAVELLED AND  
 STILL RETURN.

THE PUBLIC SHOULD HAVE ACCESS  
 TO THE ENTIRE WATERS EDGE...

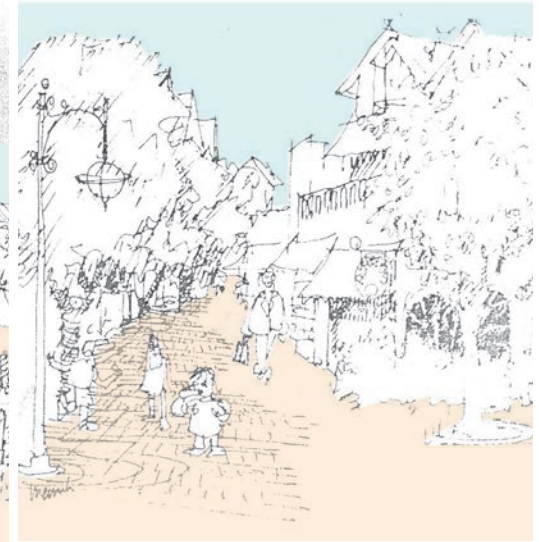
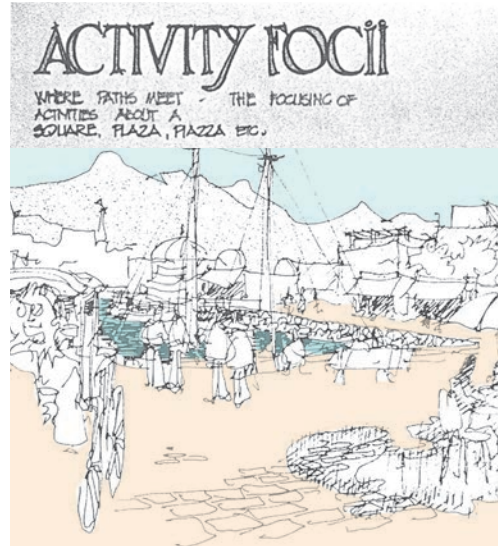



# WHAT WE HEARD / HISTORY + DEMOGRAPHICS

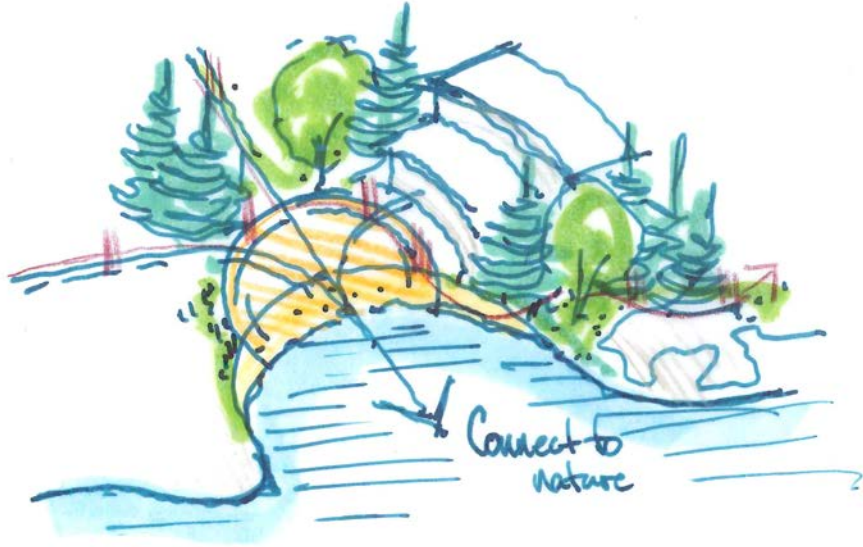

## 01 REFLECT THE FIRST NATIONS' LEGACY

Reflect a deep understanding of First Nations culture and historical connection to the land through the planning, design and programming of community spaces and buildings.



Haida Gwaii Museum / David Nairne + Associates



Oodena Circle at the Forks, Winnipeg



Mohawk College Hoop Dance / Brook McIroy



# WHAT WE HEARD / HISTORY + DEMOGRAPHICS

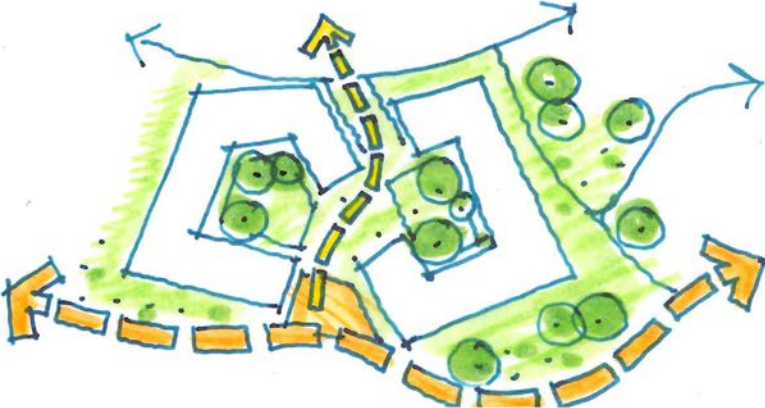

## 02 RESPECT THE UNIQUE CHARACTER + PATTERN

Capture and protect the unique character and urban design pattern of residential enclaves, intimate buildings and open spaces, naturalistic landscapes and looping pathways.

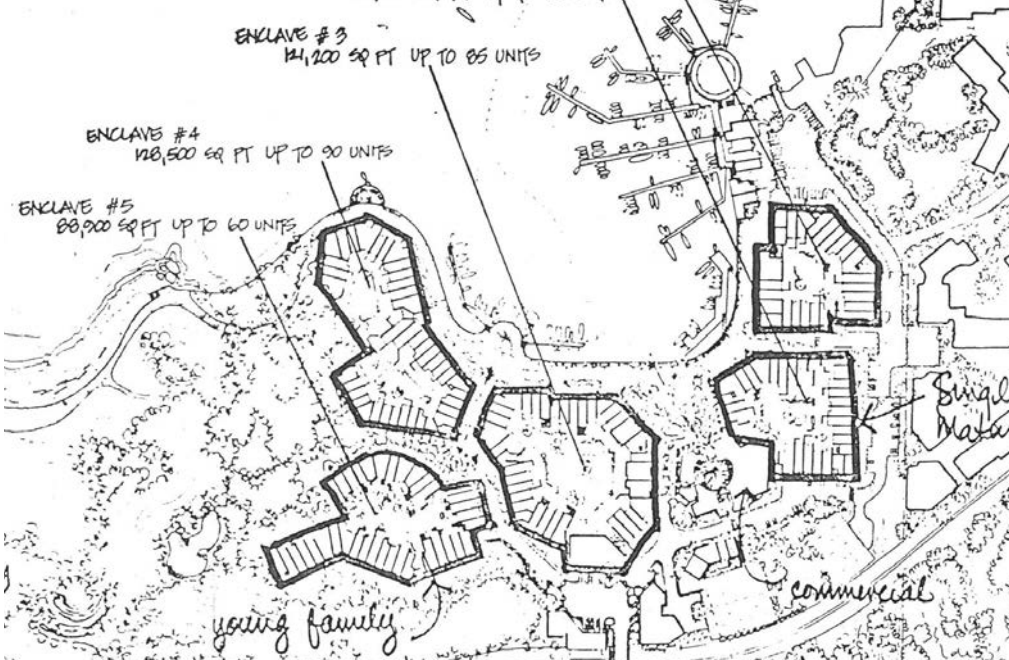



# WHAT WE HEARD / HISTORY + DEMOGRAPHICS

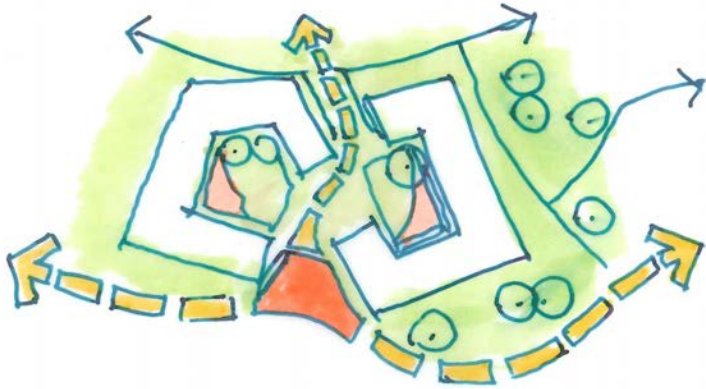

## 03 SUPPORT STRONG SOCIAL CONNECTIONS THROUGH DESIGN

Build on the legacy of False Creek South by designing buildings and landscapes that promote social connections, diversity and equality



Social Courtyard Spaces, Munich, Germany



Co-op housing, Berlin, Germany



Active Public Realm, Buenos Aires



# WHAT WE HEARD / SUSTAINABILITY

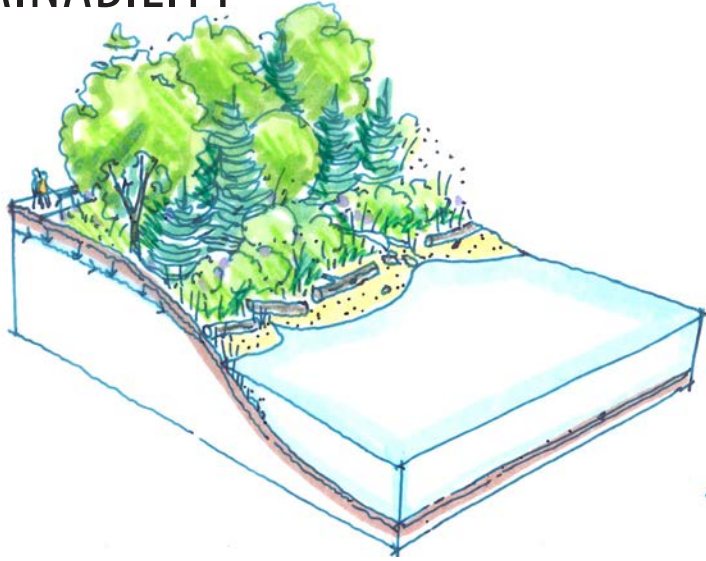

## 04 ECOLOGY + GREEN DESIGN

Improve the ecological function of the new neighbourhood through shoreline restoration, habitat enhancement, natural stormwater management + green buildings



Vauban, Freiburg, Germany

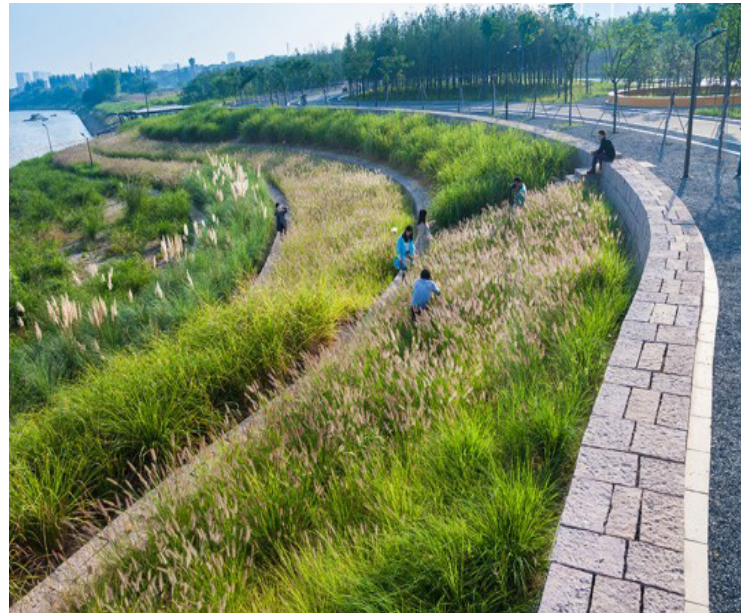

Yanweizhou Park, Jinhua, Zhejiang Province, China



Vastra Hamnen, Malmo, Sweden



# WHAT WE HEARD / SUSTAINABILITY

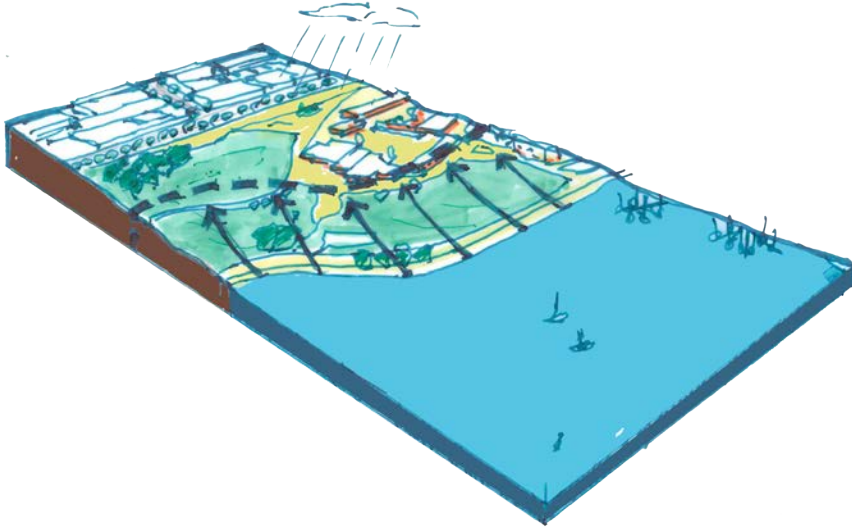

## 05 RESILIENCE

Ensure new development is designed to be resilient to sea level rise, climate change and earthquakes while fostering the social connections and cohesion necessary for holistic community resilience



BigU, New York

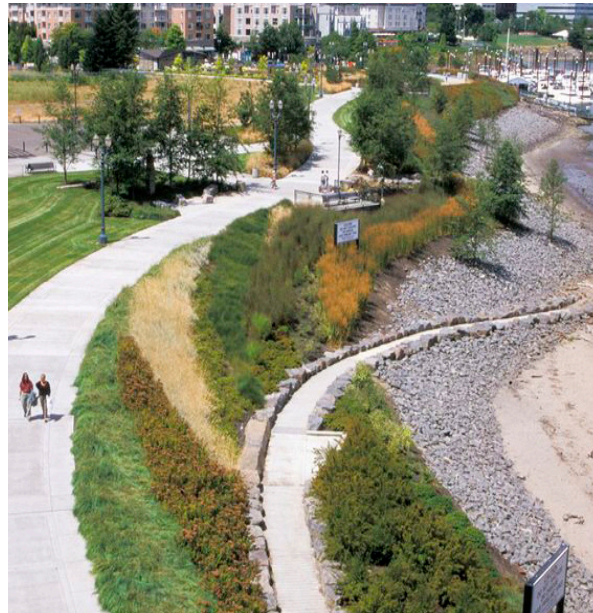

South Waterfront Park, Portland, Oregon



Community Gathering, Vancouver, BC



# SUSTAINABILITY / A HOLISTIC APPROACH

## 01 PROTECT + ENHANCE ECOLOGICAL SYSTEMS



PREFERRED SITES



HABITAT PRESERVATION



EFFECTIVE PERVIOUS AREA

## 02 BUILD GREEN BUILDINGS + INFRASTRUCTURE



GREEN BUILDINGS



RENEWABLE ENERGY



WASTE WATER TREATMENT

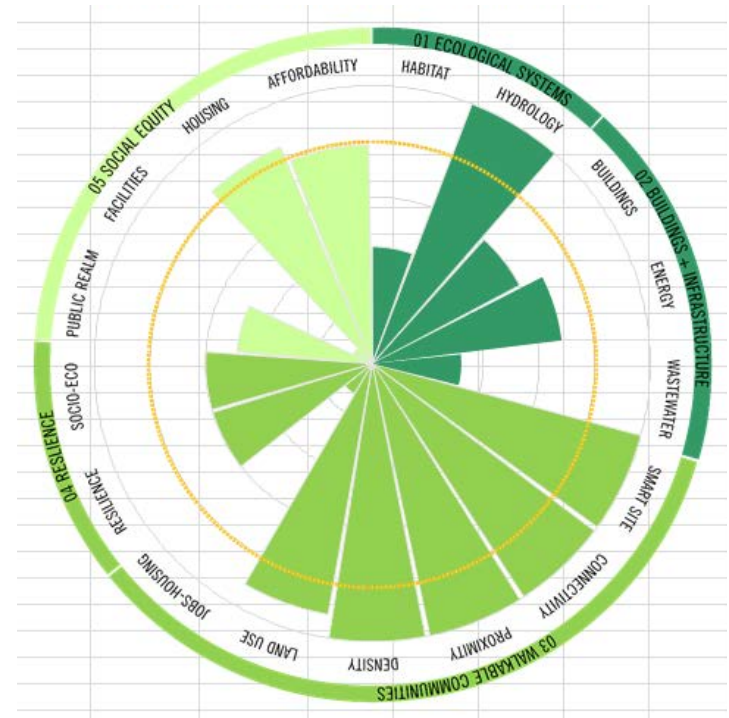

## 03 CREATE WALKABLE COMMUNITIES

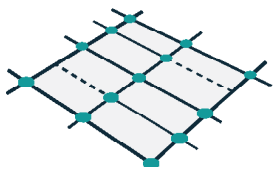

INTERSECTION DENSITY

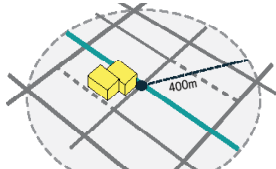

TRANSIT RETAIL PROXIMITY

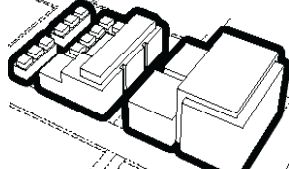

RESIDENTIAL DENSITY



JOBS-HOUSING BALANCE



LAND USE DIVERSITY

## 04 PLAN FOR RESILIENCE



SHOCKS + STRESSES



SOCIAL RESILIENCE



HOUSING DIVERSITY



AFFORDABLE HOUSING



ACCESS TO GREEN SPACE



ACCESS TO AMENITIES

## 05 PROMOTE SOCIAL EQUITY



# WHAT WE HEARD / PUBLIC REALM



## 06 CELEBRATE THE WATER'S EDGE

Connect people and activity with the water's edge and offer a variety of experiences from urban plazas to contemplative green spaces. Ensure equitable access to the water and park space.



Oslo, Norway



Zhangjiagang Town River, China



Habitat Island, Vancouver, BC



# WHAT WE HEARD / PUBLIC REALM



## 07 FOCUS ACTIVITY TO CREATE LIVELY, WELCOMING PLACES

Look for public places where neighbourhood shops, services and amenities could enhance the public realm, walkability and convenience for South False Creek residents and adjacent neighbourhoods

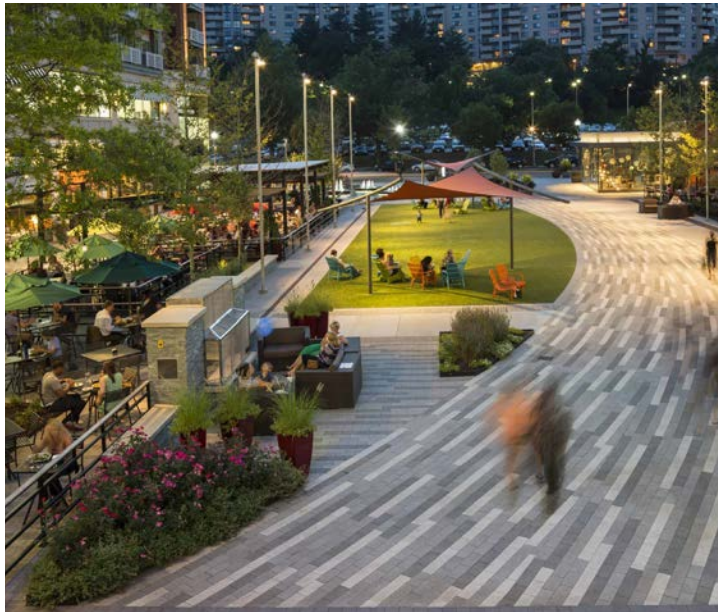

Arlington, USA



Rouse Hill's Town Square, Australia

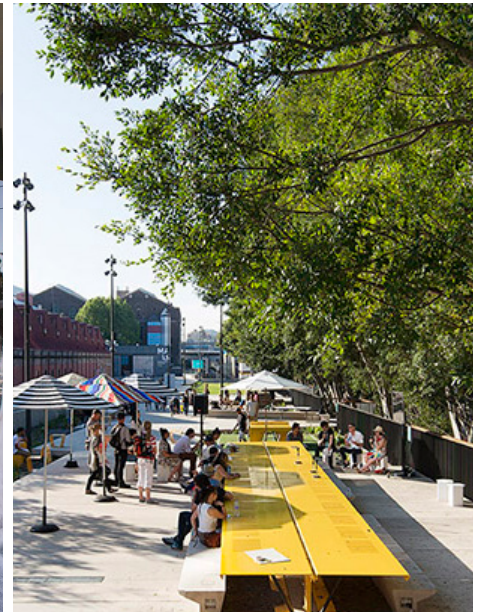

The Goods Line, Sydney, Australia



# WHAT WE HEARD / HOUSING

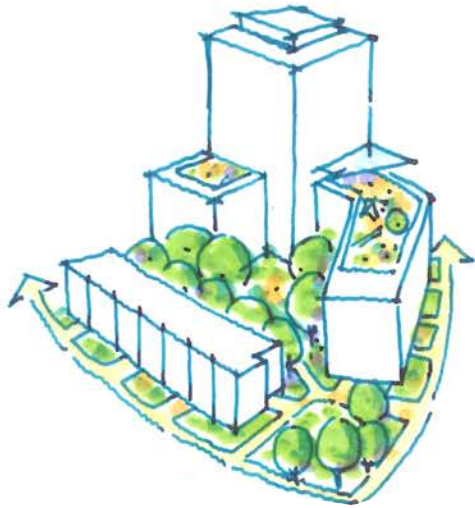

## **08 INCREASE HOUSING CAPACITY + CHOICE WHILE RETAINING CHARACTER**

Look for opportunities to introduce additional housing capacity and new building typologies while retaining the essential qualities of character and dignity that are the hallmark of the False Creek South community



Ground-oriented townhouses



Co-op housing at River Spreefeld, Berlin, Germany



Wesbrook Village, UBC



# WHAT WE HEARD / TRANSPORTATION

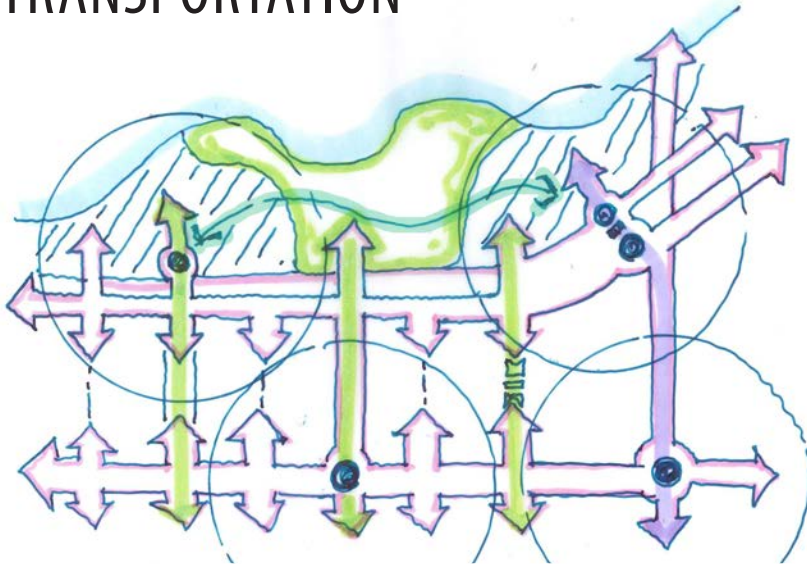

## 09 CONNECT COMMUNITIES, CONNECT TO TRANSIT

Repair poor connections to adjacent communities and take advantage of new transit infrastructure by focusing people and activity close to transit and providing direct, high quality pathway connections



Bilbao, Spain



Green connections, Seattle, Washington



Lonsdale Street, Dandenong



# FALSE CREEK SOUTH / IN CONTEXT





# DRAFT URBAN DESIGN PRINCIPLES



01 FIRST NATIONS

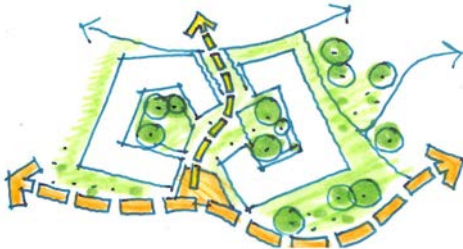

02 CHARACTER + PATTERN

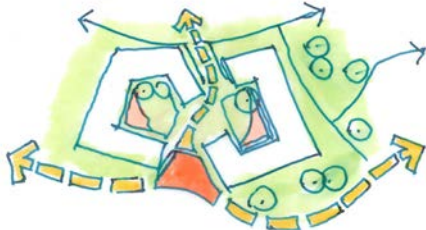

03 SOCIAL CONNECTIONS

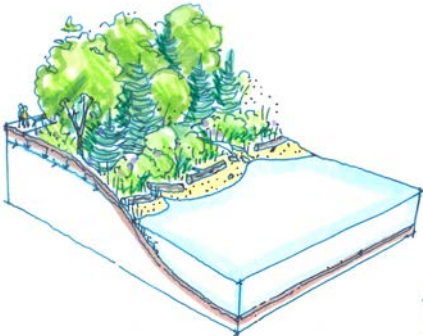

04 SUSTAINABILITY



05 RESILIENCE



07 FOCUSED ACTIVITY



08 HOUSING



06 WATERFRONT

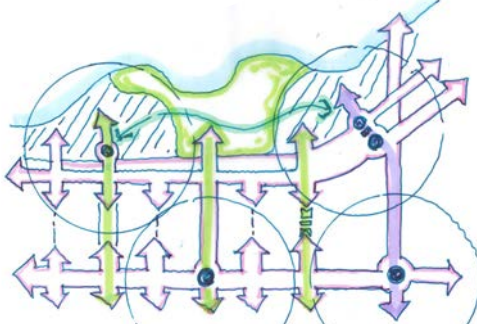

09 CONNECTIVITY



**6**

---

**Discussion +  
Mapping**



# DISCUSSION

- Did we get it right?
- Is anything missing?
- How can the principle(s) be applied in FCS?



# FALSE CREEK SOUTH

## Planning Process Timeline





**Thank you!**

Web : [vancouver.ca/FCS](http://vancouver.ca/FCS)

Email : [falsecreeksouth@vancouver.ca](mailto:falsecreeksouth@vancouver.ca)

Twitter : [#FCSPlan](https://twitter.com/#FCSPlan)