

NORTH ARM TRAIL - GREENWAY PLAN

June 2010



Existing condition.



Proposals.

Improved bike crossing at Granville.
 No turning onto eastbound 59th Ave. from Park Dr.
 No turning onto westbound 59th Ave. from Granville.
 New sidewalk on the north side of 59th Avenue between Granville Street and Cartier Street.
 New Greenstreets garden at Park Drive and 59th Avenue.
 Space for public art, seating and a drinking fountain at the junction of Park Dr. and 59th Ave.
 Separated bikeway on Park Dr. from 59th Ave. to Granville St, potential for 8 on-street parking spaces to be lost.

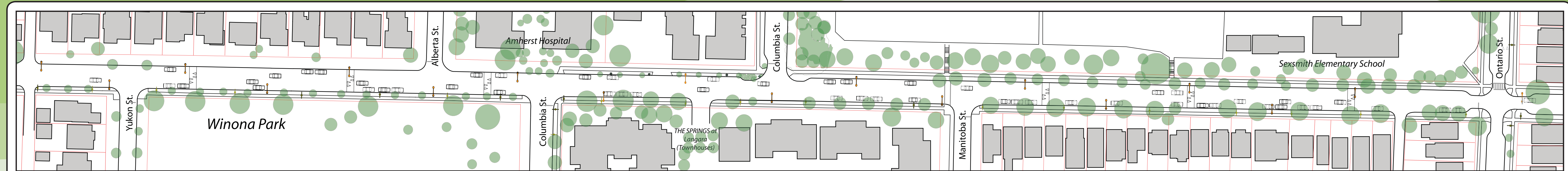

Existing condition.

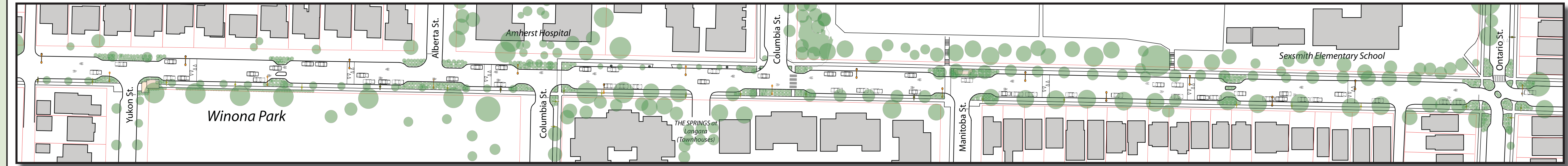

Proposals.

Bulges and improved pedestrian crossing at Yukon Street.
 Greenstreets garden at the corner of 59th Avenue and Yukon Street.
 Potential one-way priority located between Yukon Street and Alberta Street. Installation dependent upon impact of Ontario diverter.
 Space for public art, seating with views over Winona Park, and a drinking fountain at the corner of Yukon St. and 59th Ave.

One-way southbound on Alberta St. from the lane to 59th Ave.
 Bulges and improved pedestrian crossing at Alberta Street.
 Bulges and improved pedestrian crossing at Columbia Street (south).
 Bulges at Columbia Street (north).
 Landscaped traffic calming measures.

Bulges and improved pedestrian crossing at Manitoba Street.
 Seating area with view down Manitoba Street.
 Landscaped traffic calming measures.

Diagonal Diverter at Ontario Street.
 Landscaped traffic calming measures.
 Potential one-way priority located between Manitoba Street and Ontario Street.
 Installation dependent upon impact of Ontario diverter.

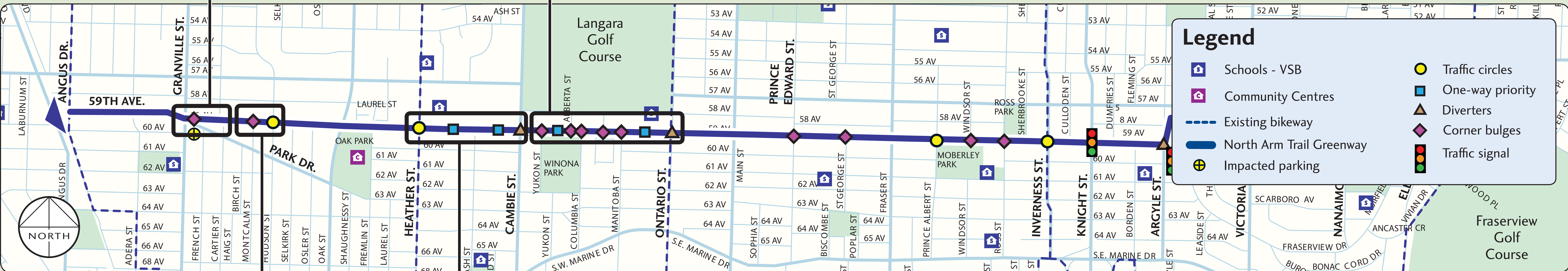

Existing condition.



Proposals.

Infiltration bulges and improved pedestrian crossing at Montcalm Street.
 Traffic circle at Hudson Street.
 Landscaped traffic calming measures.

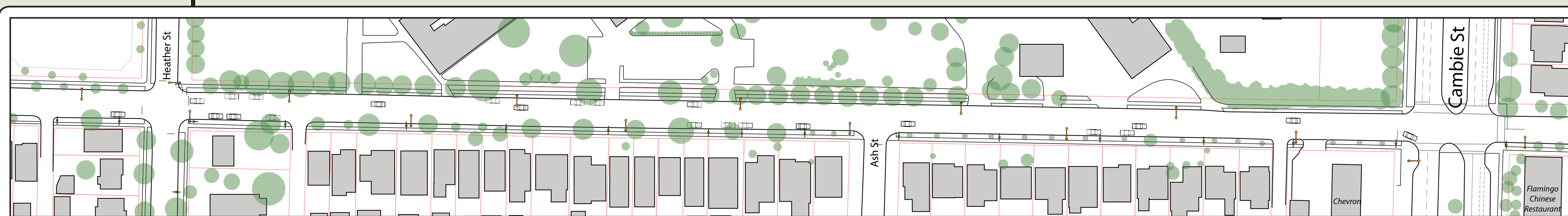

Existing condition.

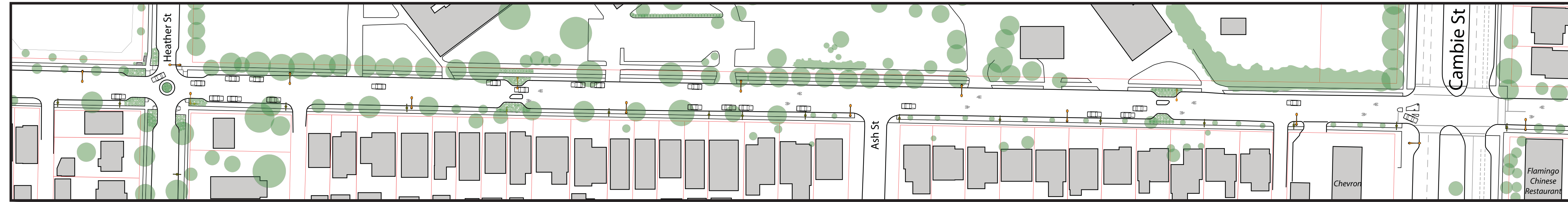

Proposals.

Traffic circle and improved pedestrian crossing at Heather Street.
 Landscaped traffic calming measures, including seating area.

One-way priority located between Heather Street and Ash Street. Installation dependent upon impact of Cambie St. diverter.
 Landscaped traffic calming measures.

One-way priority located between Ash Street and Cambie Street. Installation dependent upon impact of Cambie St. diverter.
 Traffic diverter at Cambie Street - no westbound turn or westbound through traffic at junction of Cambie St. and 59th Ave. Landscaped traffic calming measures.
 Wheelchair actuation at Cambie St. crossings.

ANGUS DRIVE TO ONTARIO STREET