

# WORKSHOP 3: public realm & open space

---

workshop summary  
january 10, 2018

# WORKSHOP OUTLINE

1. Welcome & introductions
2. Icebreaker: My favourite public space
3. Presentation: How did we get here and where are we going?
4. Breakout discussion - FCS today
5. Visual simulation + breakout discussion - FCS in the future
6. Report back and performances
7. Closing, next steps, thank you

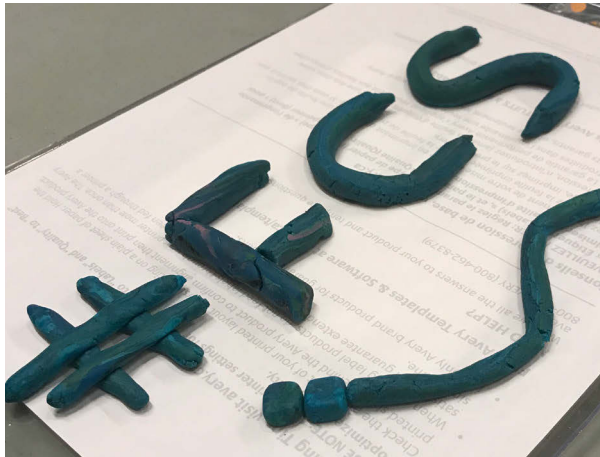

---

January 10, 2018  
5:00 pm - 8:00 pm

Creekside Community Centre  
1 Athletes Way  
Vancouver, BC

55 workshop participants



# EMERGING PRINCIPLES

After a presentation, workshop participants explored how existing public spaces in False Creek South are used today through discussion and mapping:

- **Place observation:** Where do people currently gather in FCS? What do they do there?
- **Place check:** What do you like about these places? What are their most important qualities? What do you dislike?
- **Place perspective:** Who are these spaces for? What ‘hats’ do you wear when you arrive in a public space? What barriers might there be to using these spaces – and how can they be improved?

The key ideas were collected and organized into major themes:

- **Design with nature**
- Cultivate **safe, comfortable gathering spaces** in the public realm
- Explore opportunities to **activate and revitalize underutilized public spaces**
- Enhance **accessibility and connectivity** within FCS and to adjacent areas
- Explore **waterfront enhancement** opportunities
- Ensure **equitable access** to water and open spaces
- Enhance **public realm, walkability, and convenience**
- Enable **access to green space** as both local and citywide amenities

# MY FAVOURITE PUBLIC SPACE

Participants were invited to draw their favourite public space, anywhere, and then share it with their table. Below are the themes that emerged, along with a sample of some of the drawings created during this icebreaker activity.

## THEMES

- Access to nature - trees, greenery, park
- Walking & cycling paths
- Views of water, mountains and city
- Water - activity, nature
- Plazas, squares, open space for gathering
- Picnic areas, benches
- Intertidal area/beach - accessible to public
- Market, local business
- Playgrounds
- Performance areas

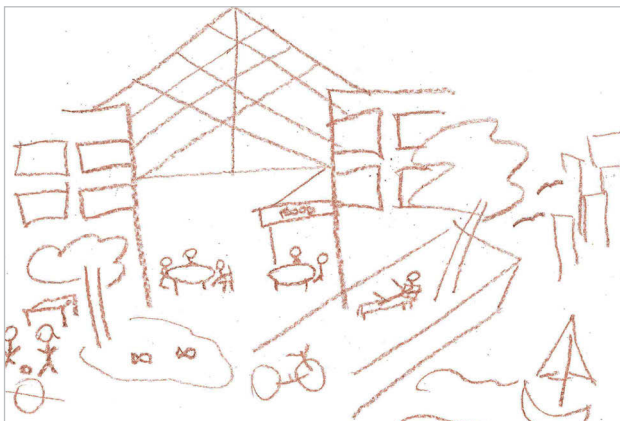
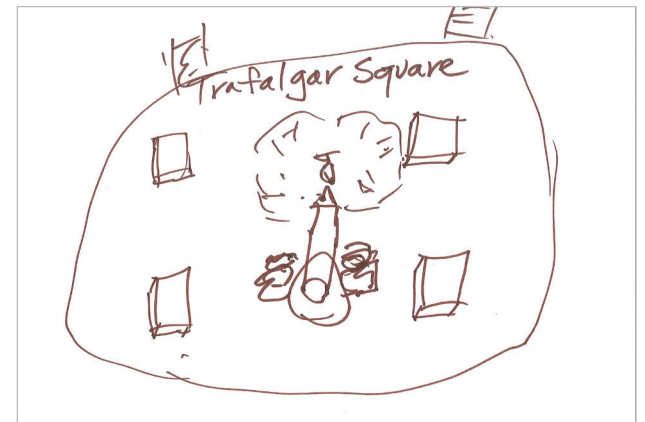
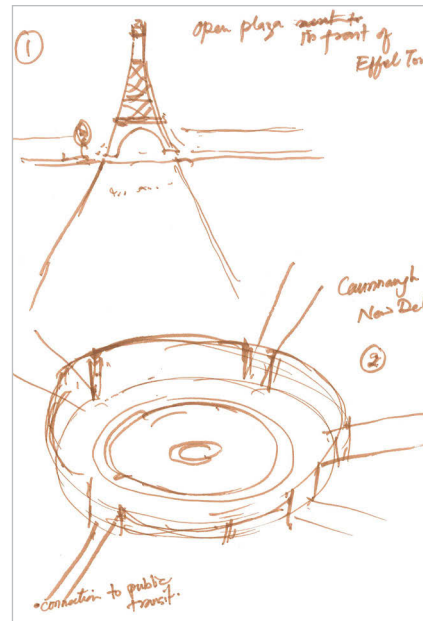

# MY FAVOURITE PUBLIC SPACE

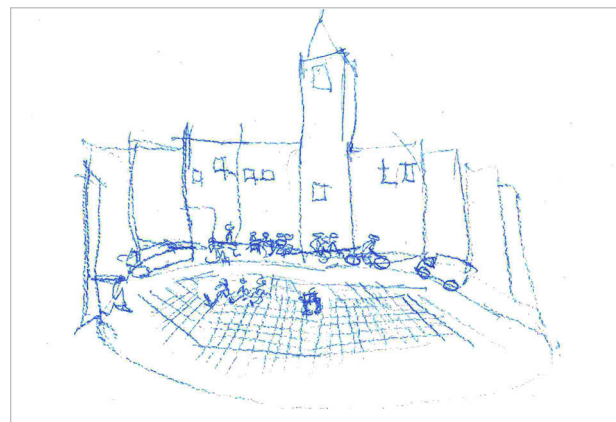
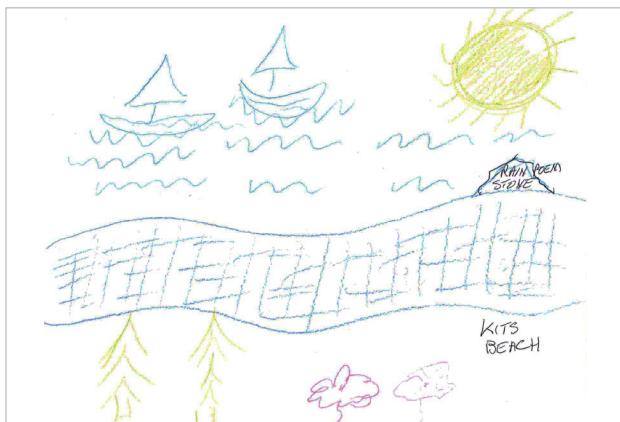
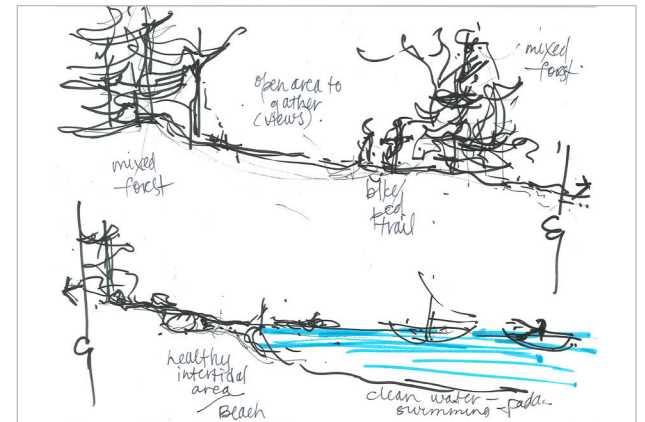
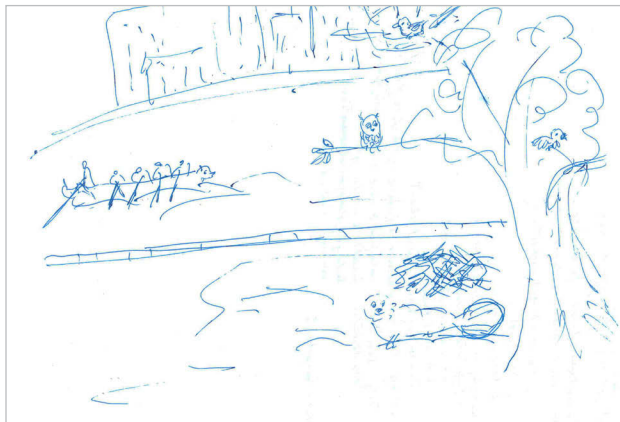
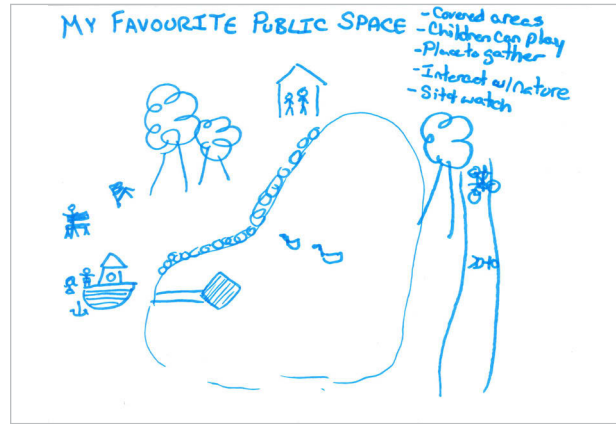
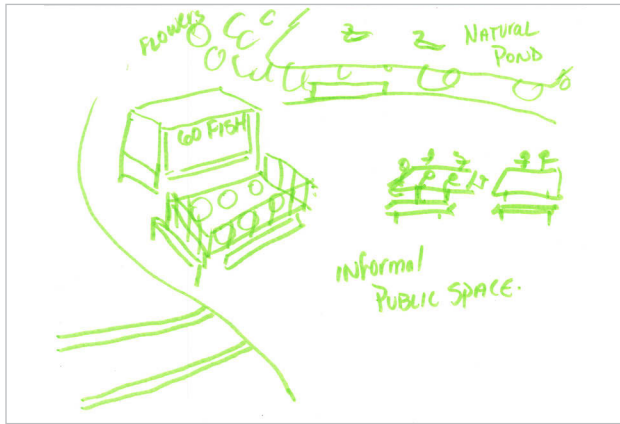

# WE LOVE...

THE SEAWALL	PARKS & GREEN SPACE	OTHER	THE WATERFRONT	COURTYARDS
<ul style="list-style-type: none"> <li>• It's a great place for both visitors and residents</li> <li>• It's a place where people feel safe and interact with one another</li> <li>• It functions as a "main street" for residents of the area</li> <li>• Seawall in general is iconic and makes FCS unique</li> <li>• The seawall is our town square.</li> <li>• Places to get off the seawall and people watch, rest, soak up sun, green water features</li> <li>• It's the neighbourhood's social space</li> <li>• Seawall and larger open spaces</li> </ul>	<ul style="list-style-type: none"> <li>• Treed and wooded areas</li> <li>• FCS's beauty is associated with its green spaces</li> <li>• Charleson Park (the "bowl") is well used. A community "hub."</li> <li>• We love the waterfall.</li> <li>• Running water – dogs love it! Kids can't swim there (big user of potable water).</li> <li>• The berm and Laurel Landbridge are highly successful and used</li> <li>• Flowers at Sutcliffe Park</li> <li>• Berm is unique – feels like you're in the forest</li> <li>• Berm: like real woods for kids, love walking there, very important to community</li> <li>• Green spaces everywhere, intimate, safe, and close</li> <li>• Like the simplicity!</li> <li>• Nine Tree Hill - great picnic spot</li> <li>• Picnics and events at "the mound": shady area, great people and city viewing</li> <li>• Community garden - we thought they were part of the school and their initiative</li> <li>• Trees along boulevard on 6th Ave</li> </ul>	<ul style="list-style-type: none"> <li>• Vehicles are discouraged from existing public spaces</li> <li>• Heather bus loop: it is functional but still is a gathering place</li> <li>• Access to Charleson Park for Fairview Slopes residents</li> <li>• "Bike bypass" – strong design to encourage bikes for safety, seawall – slow them down</li> <li>• Heightened landscaping – inviting!! (west side – Alder FCS west)</li> <li>• Community – little green spaces, enclave, pedestrian pathways throughout, where people gather</li> <li>• Crossing at bridge and Lamey's Mill or Alder Crossing</li> <li>• Intricacy in design</li> </ul>	<ul style="list-style-type: none"> <li>• FCS is deeply connected to nature and water</li> <li>• Like the wharf (by Go Fish); could be bigger with more areas for gathering/seating</li> <li>• FCS residents like the boat co-op (it's different), but keep waterfront public</li> <li>• Cohesive design of waterfront, well thought out</li> <li>• Able to be on the water, viewing the city from water perspective</li> </ul> <div data-bbox="1241 805 1623 862" style="background-color: #00a651; color: white; text-align: center; padding: 5px;"><b>SAFETY</b></div> <ul style="list-style-type: none"> <li>• Safe, community gatherings</li> <li>• Parents can see kids from homes</li> </ul>	<ul style="list-style-type: none"> <li>• The courtyards provide a unique sense of community and neighbourliness in FCS</li> <li>• The courtyards promote a sense of safety</li> </ul> <div data-bbox="1623 570 2003 626" style="background-color: #00a651; color: white; text-align: center; padding: 5px;"><b>VIEWS</b></div> <ul style="list-style-type: none"> <li>• Places to enjoy the views</li> <li>• E.g. to the Lions from Leg-in-Boot Square; boats; people</li> </ul> <div data-bbox="1623 834 2003 902" style="background-color: #00a651; color: white; text-align: center; padding: 5px;"><b>PEACEFUL &amp; PRIVATE</b></div> <ul style="list-style-type: none"> <li>• Peaceful quality of the neighbourhood, quiet</li> <li>• Secret lookouts, places</li> <li>• Quiet spaces, including private spaces</li> </ul>

# IMPROVEMENTS WE WOULD LIKE TO SEE...

PARKS	OTHER PUBLIC SPACES	SEAWALL & WATER'S EDGE	MOBILITY & ACCESSIBILITY	CONNECTIONS	OTHER
<ul style="list-style-type: none"> <li>• Improve/address drainage issues in Charleson Park</li> <li>• Offer more seating in parks and public spaces; should be more available and thoughtfully designed to promote interaction opposed to single disconnected benches</li> <li>• Improve sandy area under waterfall in Charleson Park</li> <li>• Better maintenance of Sutcliffe Park</li> <li>• Always soggy</li> <li>• Goose poop!</li> <li>• More tables</li> <li>• Bathroom</li> <li>• Culture Harmony Grove/ Park: "sad area with trees"; bridge views; totem</li> <li>• Delineation of dog park?</li> <li>• Berm: refuse shelter/ barrier</li> </ul>	<ul style="list-style-type: none"> <li>• Redevelop underutilized spaces, provide a variety of places for gathering or activity (eg pockets of spaces along the pathways)</li> <li>• Some inner courtyards (eg Creekview Co-op) are very successful spaces while others are not (depends on dimensions and demographics)</li> <li>• Laurel Landbridge needs more signage</li> <li>• There are a few gates that close off inner courtyards that create restrictions on the use of space, these should not be allowed</li> <li>• Better plan/utilize spaces under the bridges</li> <li>• Very few benches</li> <li>• Small Square beside Wicklow: waterside and interior parking area both opportunities for public space improvement</li> <li>• Restrict dogs from accessing public pathways (fences?)</li> </ul>	<ul style="list-style-type: none"> <li>• Prioritize pedestrian movement on seawall - too focused on bicycle traffic</li> <li>• Activate, develop places and opportunities along the water's edge (eg a 'shore café', floating wharfs; better water-based transportation; and opportunities for activities in the water)</li> <li>• Seawall could be more naturalized going forward</li> <li>• Cyclists move too fast - could get worse with the new pavement coming in</li> <li>• Too much signage can seem like a highway</li> <li>• Improve public access to water (eg a canoe/kayak access point; accessible sea-level walkway; dog swimming area, and steps down to the water)</li> <li>• Conflict with off leash dogs on seawall path</li> <li>• Disconnection east-west along the seawall from "Go Fish" to Vanier Park (eg through private property)</li> <li>• Repurpose of the boardwalk platform [at Island Park Walk and Alder Bay Walk] - good location for tables and chairs</li> <li>• Could there be a beach on Charleson Park?</li> <li>• Missing public boat access</li> </ul>	<ul style="list-style-type: none"> <li>• Access is important as community ages. How to climb the berm? How to access through stairs?</li> <li>• Bikes and peds interaction</li> <li>• Very poor sidewalks in most of FCS. Moberly is an unpleasant pedestrian experience</li> <li>• Integrated roll up curbs or bollards better</li> <li>• Inaccessible for those with mobility challenges</li> <li>• Lots of quality spaces for cyclists but cars are low priority</li> <li>• Emergency vehicle access retained</li> <li>• Improve pedestrian pathways throughout FCS (eg within developments)</li> </ul>	<ul style="list-style-type: none"> <li>• Provide better connections to adjacent areas (eg downtown and Fairview Slopes)</li> <li>• Better connections (aquabus or floating paths) to better connect to other parks and seawalls (inefficient route to go around False Creek from Burrard Bridge)</li> <li>• Better pedestrian connection needed</li> <li>• No connection directly to Granville Bridge</li> <li>• Concern about vehicle access disturbing the quality of the neighbourhood</li> <li>• Improve access at Alder Crossing</li> </ul>	<ul style="list-style-type: none"> <li>• Station area is a place making opportunity</li> <li>• Support increased housing density, but not at the expense of open space or waterfront access.</li> <li>• Potential loss of existing park and public realm features (seawall) is a major concern.</li> <li>• Spyglass drop off area is awkward; sidewalks poorly planned, not integrated.</li> <li>• Design built form to promote more gathering opportunities</li> <li>• Maintain and enhance the natural environment and its strong connection to the buildings both visually and physically. Of particular importance is the shoreline.</li> </ul>
			<p style="text-align: center;"><b>LEG-IN-BOOT SQUARE</b></p> <ul style="list-style-type: none"> <li>• Failed public space because residents and stratas complained about noise</li> <li>• Barren, needs chairs, greening, fountains would help with noise</li> <li>• Need more coffee shops, grocery store</li> </ul>	<p style="text-align: center;"><b>6TH AVENUE</b></p> <ul style="list-style-type: none"> <li>• 6th Ave is unsuccessful - not walkable/unpleasant to walk, spotty sidewalks, limited connections/ crossings</li> <li>• 6th Avenue a freeway, major traffic and noisy corridor, too fast</li> <li>• 6th Avenue should have some green/open space</li> </ul>	<p style="text-align: center;"><b>SAFETY</b></p> <ul style="list-style-type: none"> <li>• Improve sight lines, lighting, and safety</li> <li>• Upgrade and improve area under Granville bridge feels unsafe</li> </ul>

# OPPORTUNITIES, CHALLENGES, & IDEAS

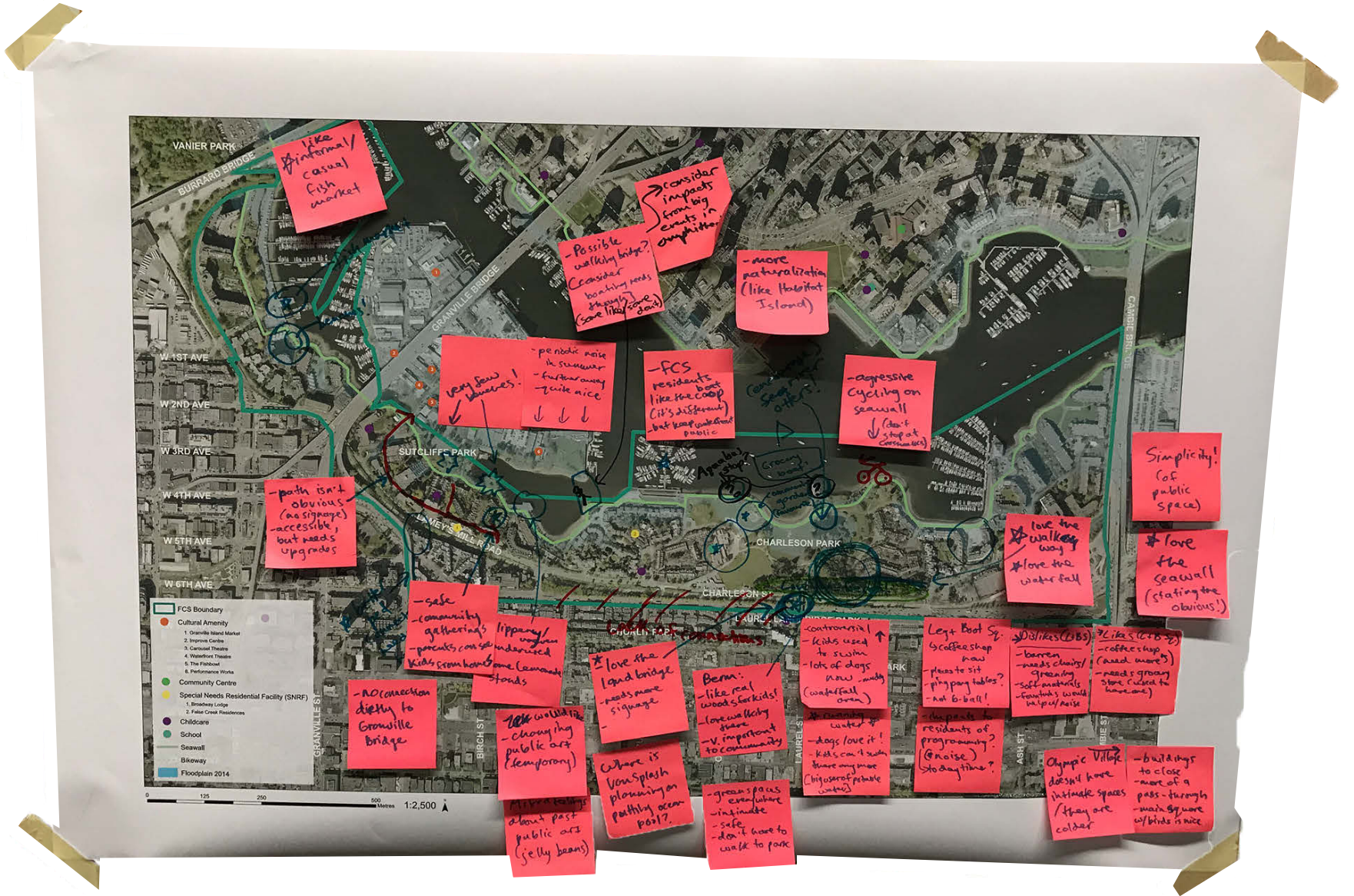



# OPPORTUNITIES, CHALLENGES, & IDEAS

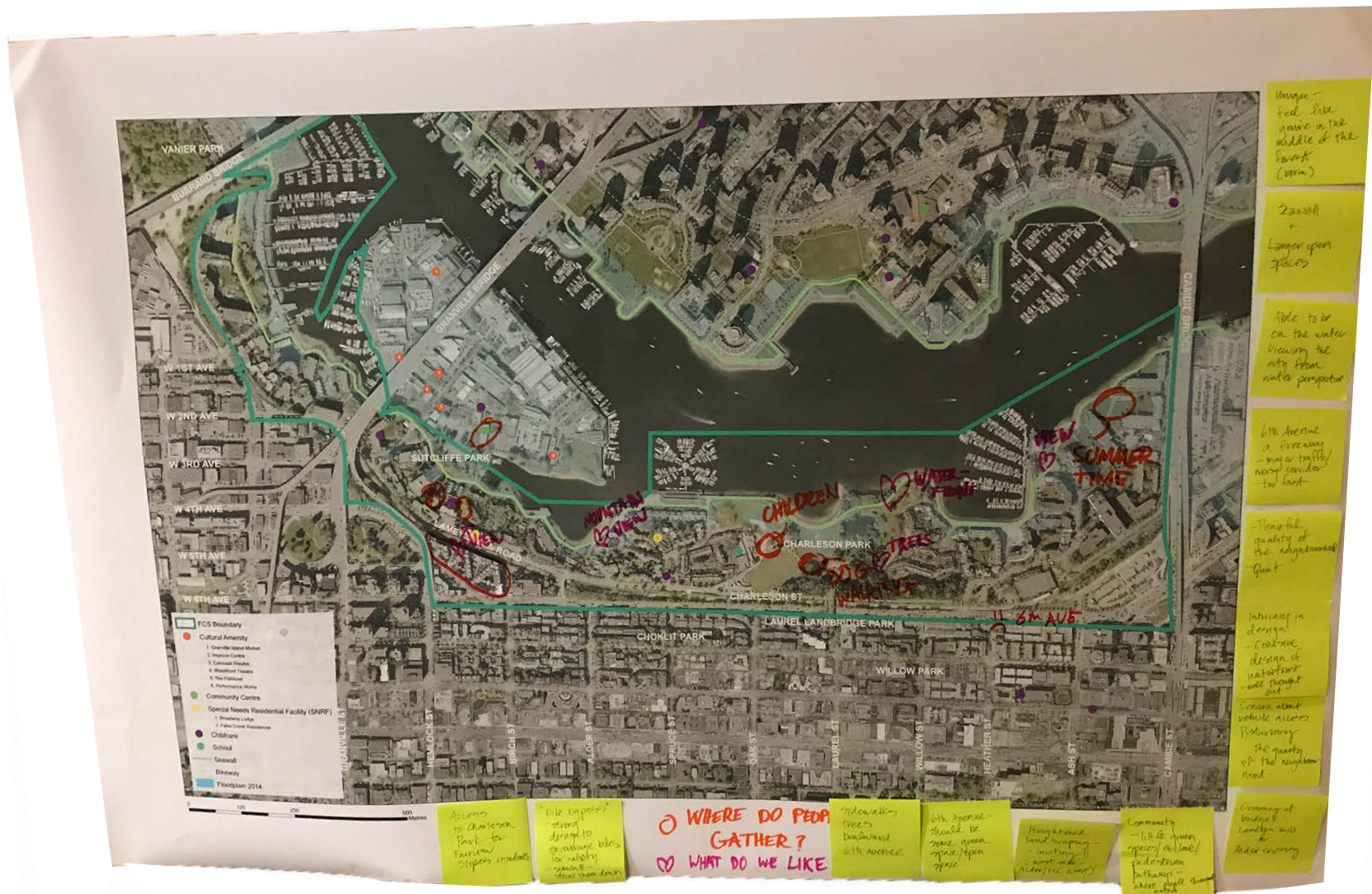





# OPPORTUNITIES, CHALLENGES, & IDEAS

**Character we like**

- tree wooded area
- plaza to view to places to stop + enjoy views
- Activities + elements that promote activity
- cultural connection
- covered space

**Don't like**

- lack of public water access.
- sitting on seawall is not done so much
- Movement through.

**Sticky Notes:**

- Shift from private to public space.
- Serve residents through spaces to maintain private. Delete local and non-essential public.
- off base area needs definition.
- Needs Boundary fence.
- Under the bridge event.
- Wooded area.
- Only loop Marina in Canada.
- See lane walkway area to park.
- wide alone steps into the water.
- Protection of biodiversity.
- water quality.
- Could a Monument?
- Minimize conflict under the bridge.
- Could access point?
- Can be an example as "green" city" more ppl puts more demand on surrounding area.
- Under Cambie Bridge could be better used.
- more activity in loop - in the way -> use a bridge launch / which way a RT.
- agender in FCS.
- Highly connected for food + transit.
- not clear where to walk etc.
- no KOB1 station.
- Small program in the area -> change to seasonal in rest area -> could be another sort back of paths.

# OPPORTUNITIES, CHALLENGES, & IDEAS

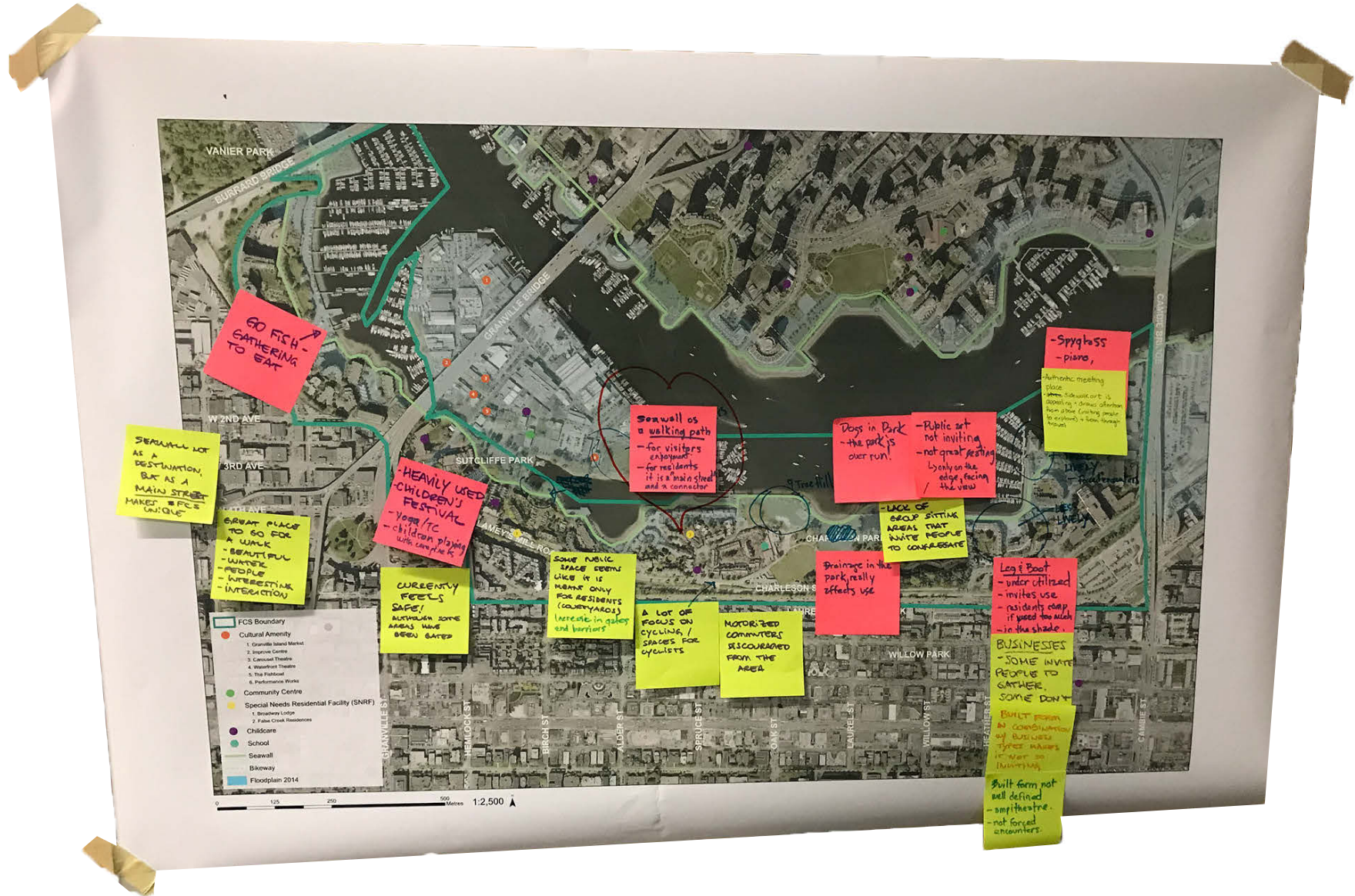





# OPPORTUNITIES, CHALLENGES, & IDEAS

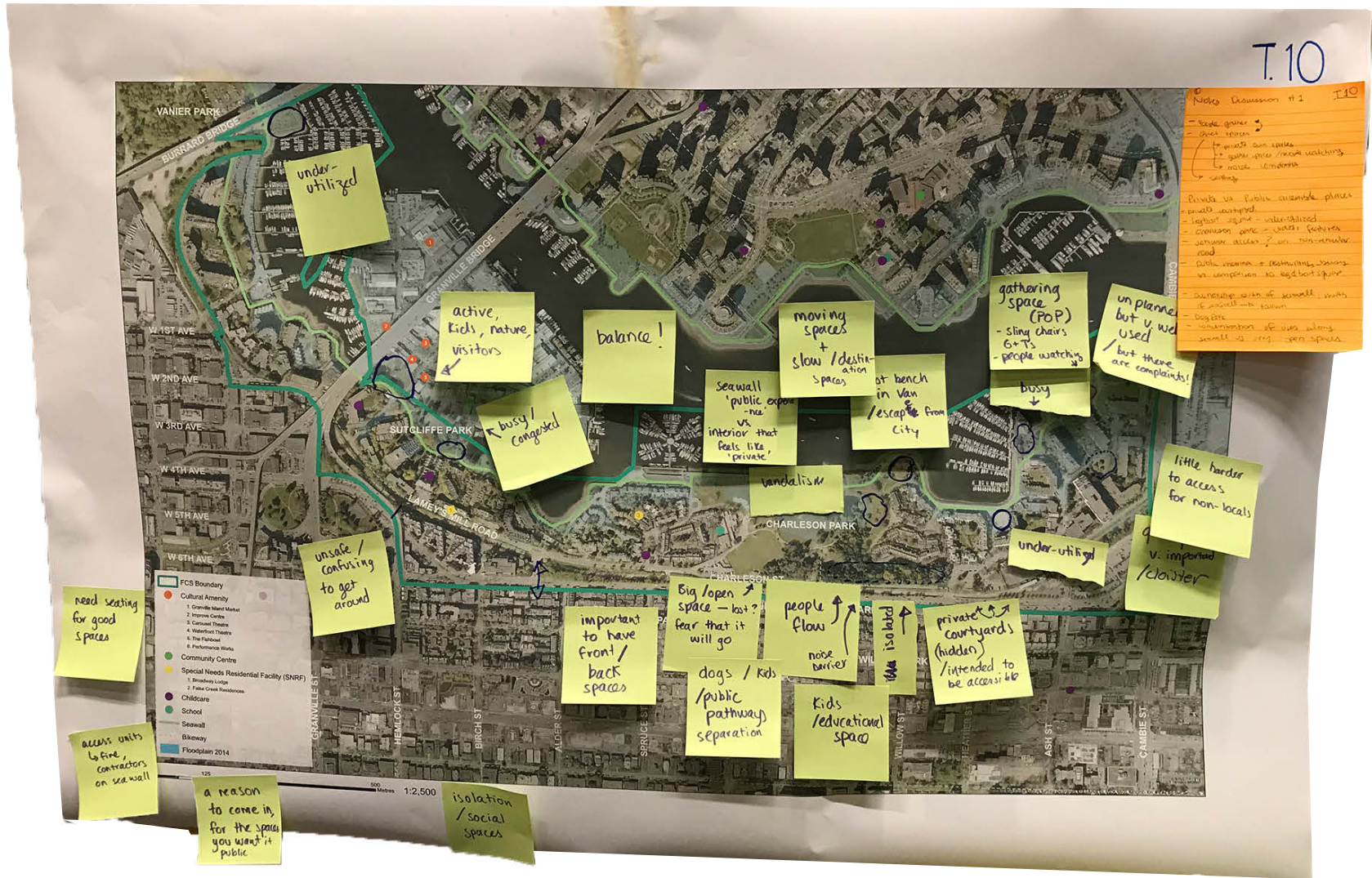





# FCS IN THE FUTURE

Through group discussions, participants were then asked to share a vision of False Creek South in an expression of their choice, Performance choices included poems, haiku, skits and a even a rap!

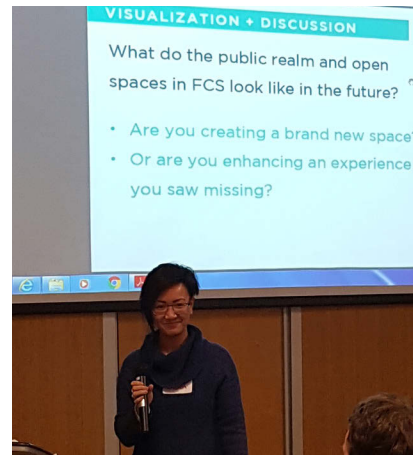

# FCS IN THE FUTURE

## No Cars

No cars on 6th Avenue  
Connected Utopia  
Quiet, nature, pure

*[fingers snap, snap, snap]*

Paradise for some  
Re-imagined by all, as  
Paradise for more

*[fingers snap, snap, snap]*

Diversity here  
People, history, culture  
Healthy place for all

*[fingers snap, snap, snap]*

District energy  
All storm water flowing down  
Mixed ecology

*[fingers snap, snap, snap]*

## Seawall

Seawall ebb and flow  
People also call this place home  
Fresh and salt water  
Seawall spine that binds  
Knows that history will unfold  
And our home will change

---

## Connections [a rap performance]

Connections to the sky,  
A water's edge lookin' fly.  
C'mon let's add more density,  
Because taller buildings resonate with me.  
A streetcar is our fate,  
Oh man, the drones are running late!  
We're meeting later in the park,  
Oh, check out this new piece of public art!  
Electric cars by Elon Musk,  
Romantic lights after dusk.  
False Creek South is in the news,  
Where Leg-in-Boot Square is actually used.

# FCS IN THE FUTURE

## **False Creek Haiku**

Clouds hover  
We all watch uncertainly  
Water, water, water

Dogs oblivious to everything  
Feet dry for once  
Watch the wall of the city growing

Nearby dystopia  
Answers back so stark so  
Different from here

Rising tide lifts some  
More than others  
Park benches for the rest

Connections by Bridges  
I see Yaletown and UBC  
By tram and 6th Ave

## *Strangers*

Many smiling faces  
Throng their way front of my house  
I smile back at them

## *Neighbours*

My footsteps mingle  
With those of many I know  
Often we stop and talk

## *Delight*

Light comes through my fence  
Even when I am not there  
My garden waves back

## *Closeness*

Everything I close  
I do not cross many streets  
Pose no problems for traffic

## *Completeness*

I leave home each day  
Go in different directions  
Come back still happy

# FCS IN THE FUTURE

## Changing

Changing use and tides  
Transform space and community  
More friendly and green

---

## Performance: Stream of visualization....

The forest berm - birds in the foliage and butterfly lit up by the shafts of sunshine. A cool quiet and contemplative mature forest canopy.

Kayaker pulling into the beach, clean water and lovely riparian zone to meet friends for tea close to the water.

A walkway over the road set below grade that has replaced W 6th Avenue towards Cambie St... an active Leg-in-Boot Square

Walking home from work to visit three generations of family. Tending the food growing on the rooftop. Was able to visit my granddaughter who could stay in the area because there was affordable housing.

## 2043

In False Creek South in 2043:  
I heard seals squawking; kids playing  
I saw green; ocean; more housing  
I felt wind on my cheeks  
I smelled the sea breeze and a fragrant flower garden  
I touched a prickly bush in the community garden  
Same feeling, different structures.

---

## Epitaph

On my epitaph, it will say:  
I took the ferry  
I saw the seals  
I had a Johnny Pop  
I sat on the bench with a neighbour and watched people go by  
I listened to the birds  
I saw the interesting art  
I reconnected with the water and  
I remembered at the Memorial Wall.

# YOUR FAVOURITE PUBLIC SPACES IN FCS

*Workshop participants were asked to submit photographs of their favourite public places in False Creek South. Here are some of the submissions.*

