

File No.: 04-1000-20-2020-326

July 23, 2020

s.22(1)

Dear s.22(1)

Re: **Request for Access to Records under the Freedom of Information and Protection of Privacy Act (the "Act")**

I am responding to your request of June 11, 2020 for:

Records specifying the road configuration at Blenheim Street and Point Grey Road as of August 7, 2016.

All responsive records are attached. Please note, the City's Transportation Division provided the following information in addition to the two images enclosed:

- The first image (page 1 of 2) shows the configuration of temporary barriers and traffic signs that replaced the barrier configuration shown through Google Street View from May 2015. The changes shown on this drawing created an interim cul-de-sac intended to emulate the permanent one that is there today.
- The second image (page 2 of 2) is an aerial photo from 2016. The photo shows the barriers arranged as indicated in the first image.
- The design for the street that followed and now exists was not completed until mid-August 2016 and construction began later that year. Based on this information, I conclude that on August 7, 2016, the intersection of Point Grey Road and Blenheim Street was most likely configured as shown in the attached street plan and aerial photo.

Under section 52 of the Act you may ask the Information & Privacy Commissioner to review any matter related to the City's response to your request. The Act allows you 30 business days from the date you receive this notice to request a review by writing to: Office of the Information & Privacy Commissioner, info@oipbc.ca or by phoning 250-387-5629.

If you request a review, please provide the Commissioner's office with: 1) the request number assigned to your request (#04-1000-20-2020-326); 2) a copy of this letter; 3) a copy of your original request for information sent to the City of Vancouver; and 4) detailed reasons or grounds on which you are seeking the review.

Please do not hesitate to contact the Freedom of Information Office at foi@vancouver.ca if you have any questions.

Yours truly,

[Signature on file]

Barbara J. Van Fraassen, BA
Director, Access to Information & Privacy

Barbara.vanfraassen@vancouver.ca
453 W. 12th Avenue Vancouver BC V5Y 1V4

*If you have any questions, please email us at foi@vancouver.ca and we will respond to you as soon as possible. Or you can call the FOI Case Manager at 604.871.6584.

Encl.

:kt

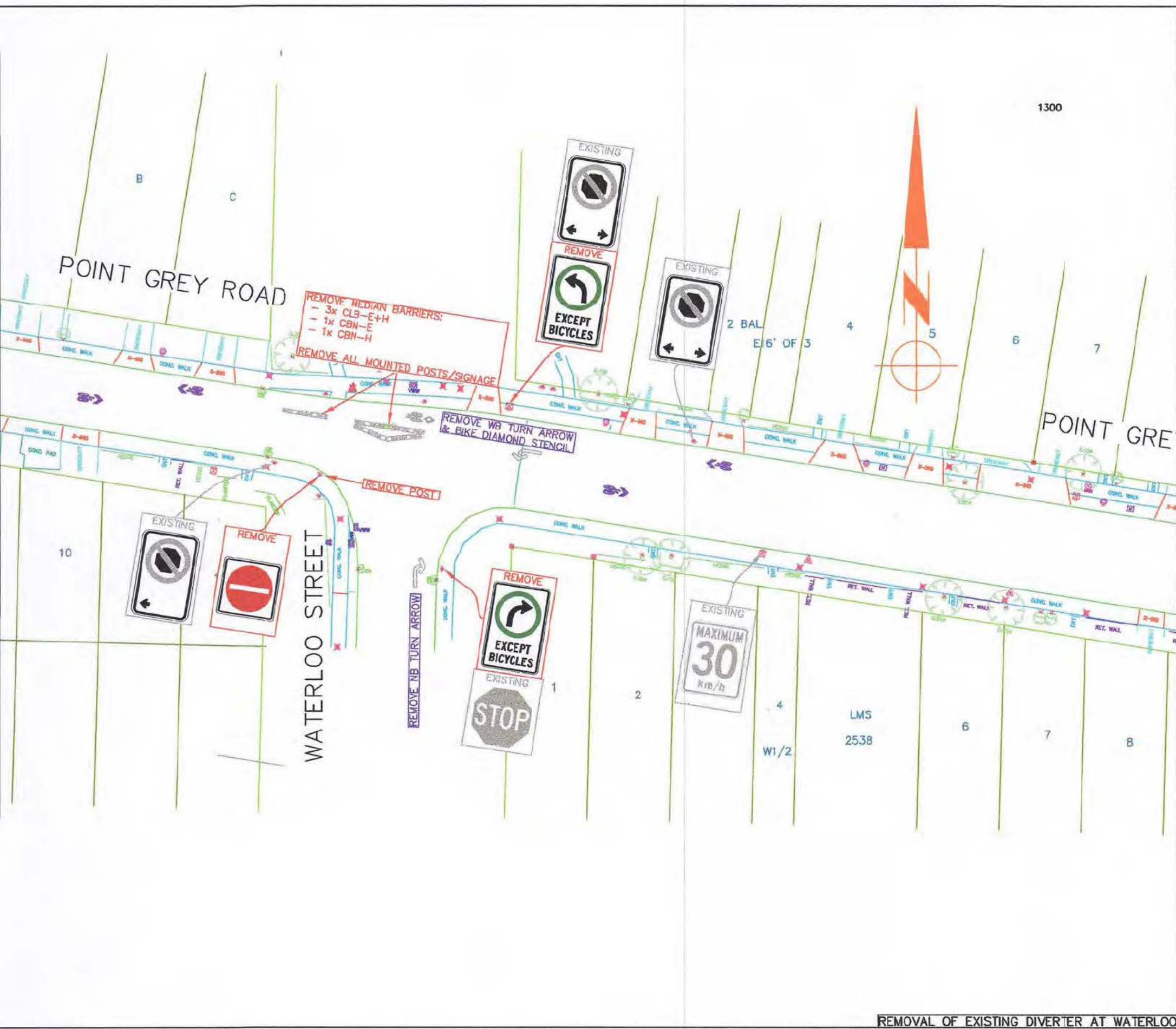

REMOVAL OF EXISTING DIVERTER AT WATERLOO

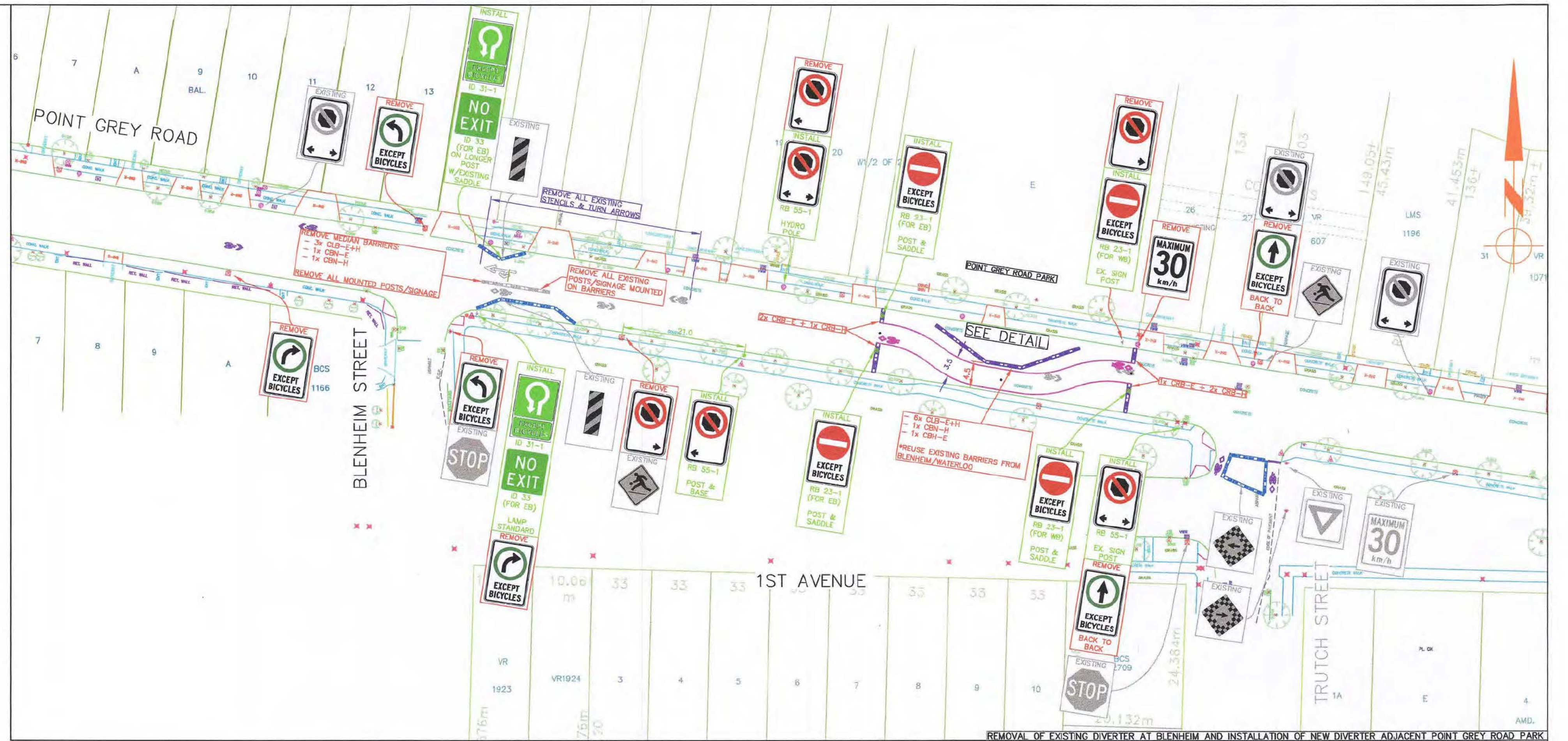

REMOVAL OF EXISTING DIVERTER AT BLENHEIM AND INSTALLATION OF NEW DIVERTER ADJACENT POINT GREY ROAD PARK

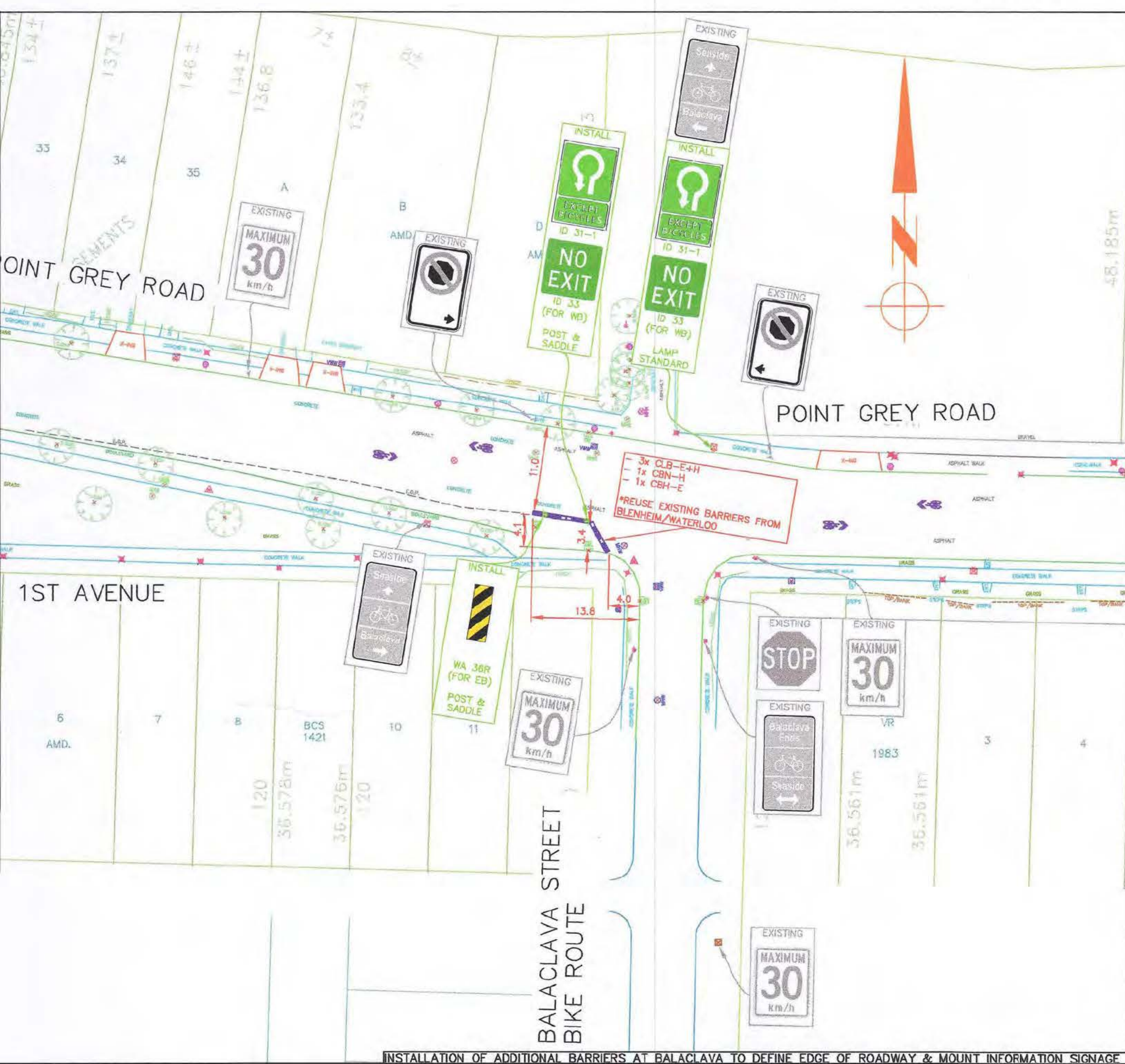

INSTALLATION OF ADDITIONAL BARRIERS AT BALACLAVA TO DEFINE EDGE OF ROADWAY & MOUNT INFORMATION SIGNAGE

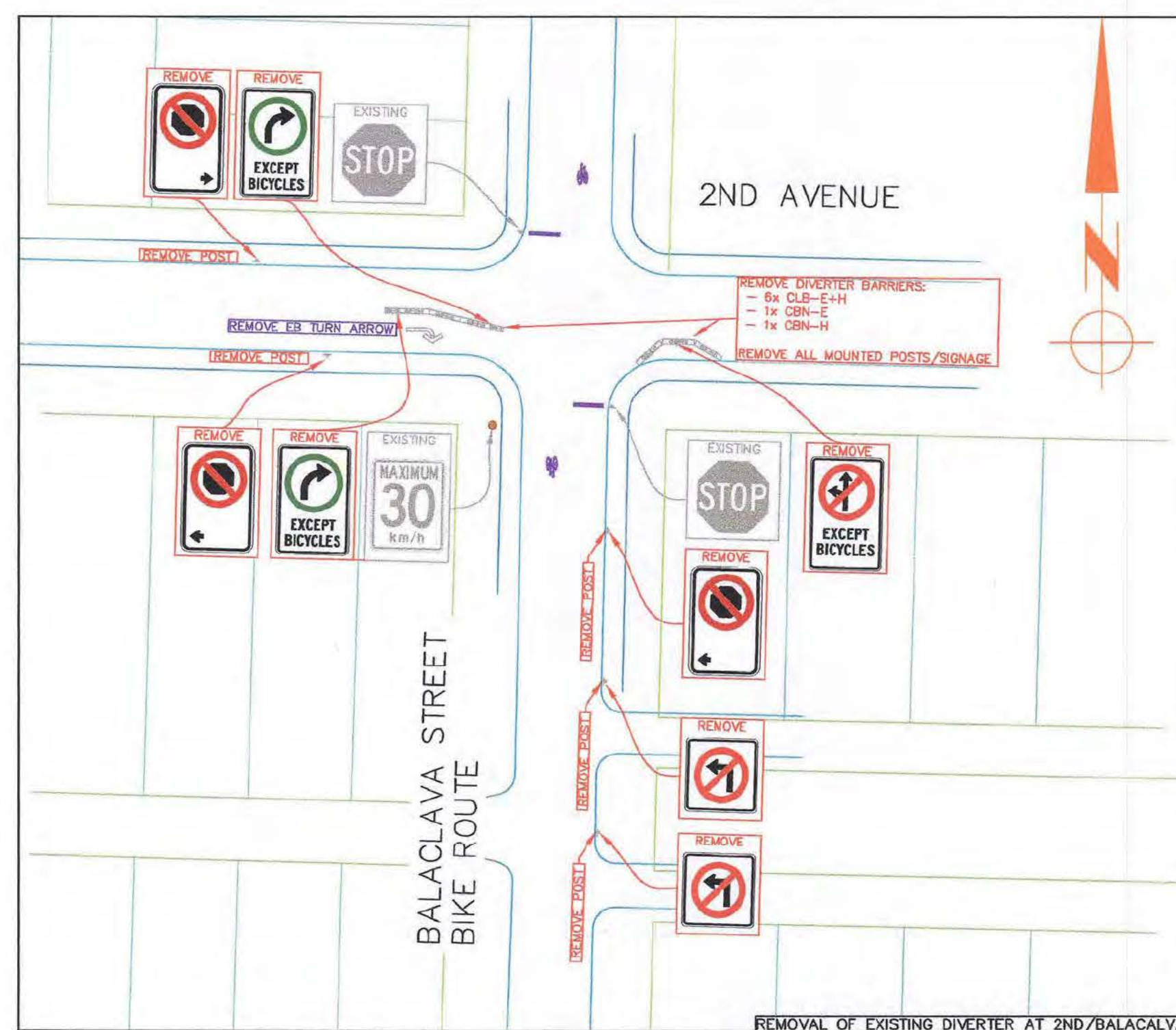

REMOVAL OF EXISTING DIVERTER AT 2ND/BALACLAVA

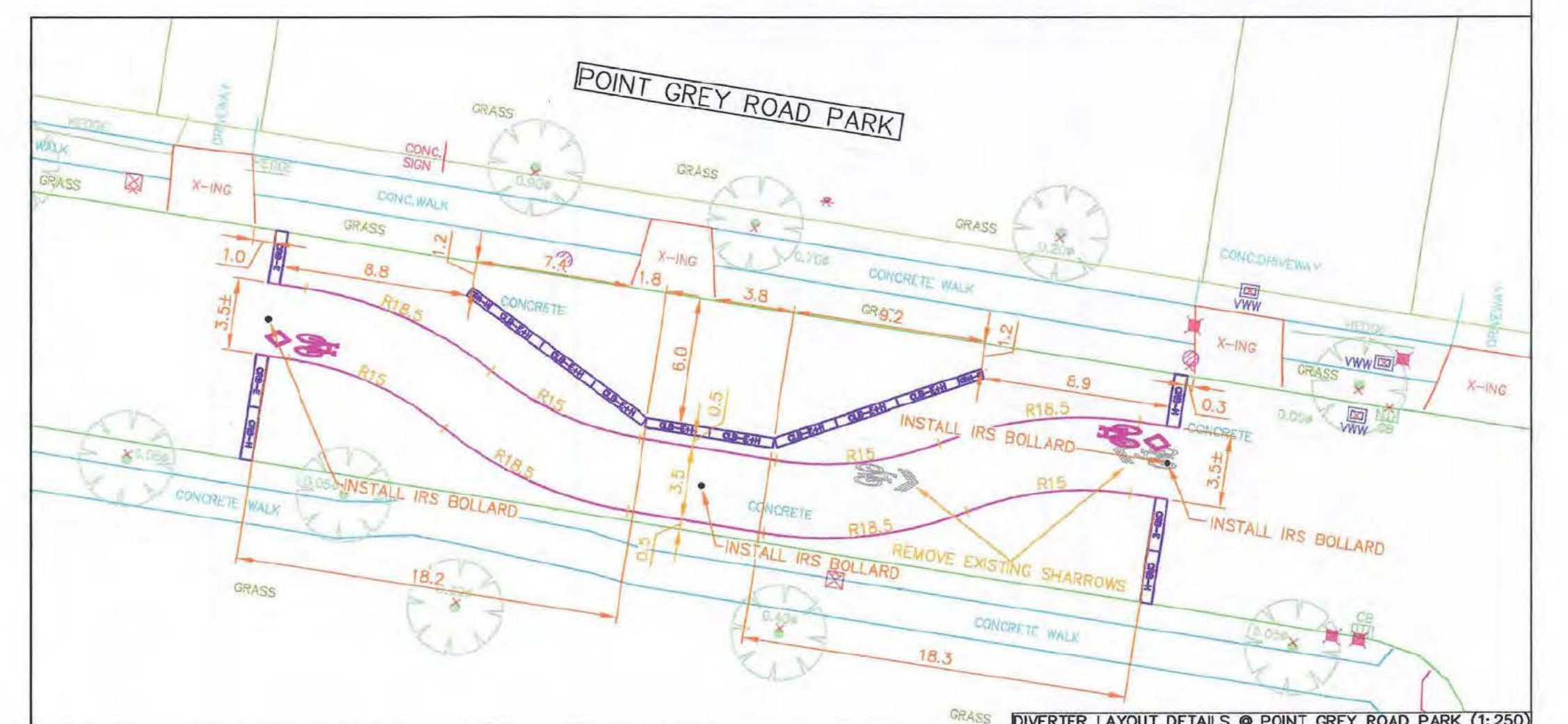

DIVERTER LAYOUT DETAILS @ POINT GREY ROAD PARK (1:250)

1x	1x	2x	4x	4x	1x	5x	1x
RB 23-1	RB 55-1 (< >)	RB 55-1 (< >)	ID 31-1	ID 33	WA 36R	POST & SADDLE	POST & SADDLE

EX. BARRIERS TO BE REMOVED:	EX. BARRIERS TO BE STORED/MADE AVAILABLE FOR OTHER PROJECTS:
- 17x CLB-E-H (3050L x 460W x 460H)	- 8x CLB-E-H
- 6x CBN-E (1200L x 460W x 460-150H)	- 4x CBN-E
- 6x CBN-H (1200L x 460W x 460-150H)	- 4x CBN-H

EX. BARRIERS TO BE REUSED ON POINT GREY AS PART OF THIS DESIGN:	NEW BARRIERS TO BE PURCHASED:
- 9x CLB-E-H	- 3x CRB-E (2500L x 562W x 690H)
- 2x CBN-E	- 3x CRB-H (2500L x 562W x 690H)
- 2x CBN-H	

SEAL	DIRECTOR OF TRANSPORTATION	STRATEGIC TRANSPORTATION PLANNING	DATE 2015-10-16	YES NO	REQD NOT REQD		engineering services transportation division	TRANSIT DWG # 2015-96-D-SP-00		
			DESIGN KK	BIKE FACILITIES <input checked="" type="checkbox"/>	PAINT PLAN <input checked="" type="checkbox"/>				STREETS PROJECT # 123097	
			DRAWING KK	BUS ROUTE <input checked="" type="checkbox"/>	SIGNAL PLAN <input checked="" type="checkbox"/>					REFERENCE 2013-103-E-SP-00
			CHECK	TRUCK ROUTE <input checked="" type="checkbox"/>	SIGN PLAN <input checked="" type="checkbox"/>					
NOV 2 2 2015	ACTIVE TRANSPORTATION	TRAFFIC AND DATA MANAGEMENT	DESIGN VEHICLE	LADDER TRUCK	AT <input checked="" type="checkbox"/>	SHEET SET 1 of 1				
			SUP	PC	NPT <input checked="" type="checkbox"/>					

Address Search

Civic Number:

Street Name:

e.g. "1234"

Go



What do you want to do?

Search

- ☒ Community Resources
- ☒ Licenses & Permits
- ☐ MMRU Dispensary Datacheck
- ☒ Parks and Golf Courses
- ☒ Property and Cadastral
- ☐ Analysis Area
- ☒ Crime Data
- ☒ Streets & Transportation
- ☒ Infrastructure
- ☒ Environment
- ☒ Land Use & Service Areas
- ☒ Aerial Imagery
 - ☒ 2016 Orthophotos
 - ☐ 2015 Orthophotos
 - ☐ 1912 Goad's Fire Insurance Map
 - ☒ Previous Orthophotos
 - ☐ 2013 Orthophotos
 - ☐ 2011 Orthophotos
 - ☐ 2009 mid-April Orthophotos
 - ☐ 2009 early-April Orthophotos
 - ☐ 2008 Orthophotos
 - ☐ 2006 Stanley Park Orthophotos
 - ☐ 2006 Orthophotos
 - ☐ 2005 VPA 051
 - ☐ 2005 VPA 052
 - ☐ 2005 Downtown Orthophotos
 - ☐ 2004 Foreshore
 - ☐ 2004 Orthophotos
 - ☐ 2002 Orthophotos
 - ☐ 1999 Orthophotos
 - ☐ 1994 Orthophotos
- ☒ Satellite Imagery
 - ☐ 2004 Infrared
 - ☐ 2004 Natural Colour
- ☒ Base Layers

