

File No.: 04-1000-20-2022-076

March 17, 2022

s.22(1)

Dear s.22(1)

**Re: Request for Access to Records under the Freedom of Information and Protection of Privacy Act (the "Act")**

I am responding to your request of February 15, 2022 under the ***Freedom of Information and Protection of Privacy Act, (the Act)***, for:

**City of Vancouver plumbing report regarding work at 5760 Marguerite Street on approximately January 13, 2022.**

All responsive records are attached. Some information in the records has been severed, (blacked out), under s.22(1) of the Act. You can read or download this section here: [http://www.bclaws.ca/EPLibraries/bclaws\\_new/document/ID/freeside/96165\\_00](http://www.bclaws.ca/EPLibraries/bclaws_new/document/ID/freeside/96165_00)

Under section 52 of the Act, and within 30 business days of receipt of this letter, you may ask the Information & Privacy Commissioner to review any matter related to the City's response to your FOI request by writing to: Office of the Information & Privacy Commissioner, [info@oipc.bc.ca](mailto:info@oipc.bc.ca) or by phoning 250-387-5629.

If you request a review, please provide the Commissioner's office with: 1) the request number (#04-1000-20-2022-076); 2) a copy of this letter; 3) a copy of your original request; and 4) detailed reasons why you are seeking the review.

Yours truly,

[Signed by Cobi Falconer]

**Cobi Falconer, MAS, MLIS, CIPP/C**  
**Director, Access to Information & Privacy**  
[cobi.falconer@vancouver.ca](mailto:cobi.falconer@vancouver.ca)  
453 W. 12th Avenue Vancouver BC V5Y 1V4

If you have any questions, please email us at [foi@vancouver.ca](mailto:foi@vancouver.ca) and we will respond to you as soon as possible. Or you can call the FOI Case Manager at 604-871-6584.

Encl. (Response Package)

:aa

# Work Slip

SAP Charge #		Address & Location:				Responsible	
EES 1368239		5760 Mosquitte ST					
Work Order #		Work Order Activity				Created Date	
1368239							
Group Project #		Problem		Sub Activity		Assigned To	Crew ID
				Un-Stop			01317
Work Order Comments:							
I/S C/O							
Reference #1						Billable?	
Reference #2							
Collection Agency			Collection Method			Zone	Beat
Service Request #							
Contact Name				Contact Phone		Contact Type	
Asset Type		Asset ID #	B.U.N	Status	Asset Area	Map # (Facet)	District
		215611					
Asset Details:							
Safety & Asset Notes:							
PM Sched.	Maint. Sched.	Due Date	Zone	Last Completed Work Order			
Crew Comments							
Job Complete							
Work Completed Date: 13 Jan 22			Print Name: s.22(1)			Crew ID: 01317	

CONTACT: \_\_\_\_\_ PHONE: \_\_\_\_\_ INVOICE #: 55097

BILLING ADDRESS: 5760 Marquette DATE: 13 Jan 22 SIGNATURE: \_\_\_\_\_ WITH  WITHOUT

TIME STARTED: <u>11:47 am</u>	TIME END: <u>1:22 pm</u>	Day <input checked="" type="checkbox"/> After <input type="checkbox"/> Call <input type="checkbox"/>	ACTIVITY	EQUIPMENT USED
WORKED FROM	ADDITIONAL ACCESS LOCATION DETAILS		SLM <input type="checkbox"/>	HAND RODS <input type="checkbox"/>
INSIDE <input checked="" type="checkbox"/>	Additional details:		SLB <input checked="" type="checkbox"/>	ROTO-ROOTER <input checked="" type="checkbox"/>
OUTSIDE <input type="checkbox"/>	_____		PLUGGED MAIN <input type="checkbox"/>	LARGE CUTTER <input checked="" type="checkbox"/>
TOILET <input type="checkbox"/>	_____		SPECIALS <input type="checkbox"/>	SMALL CUTTER <input checked="" type="checkbox"/>
STACK <input type="checkbox"/>	_____		CB <input type="checkbox"/>	HUMMINGBIRD <input type="checkbox"/>
C/O <input checked="" type="checkbox"/>	Distance from access location to main:		CCTV <input type="checkbox"/>	BRUSH <input checked="" type="checkbox"/>
SUMP <input type="checkbox"/>	<u>37.0</u> m		TV FOR REUSE <input type="checkbox"/>	FLUSHER <input type="checkbox"/>
D/U <input type="checkbox"/>			INVESTIGATION <input type="checkbox"/>	CCTV <input checked="" type="checkbox"/>
			INSTALL C/O <input type="checkbox"/>	OTHER: _____

DEFECT/BLOCKAGE	LOCATION OF DEFECT / BLOCKAGE	PRECONDITION WITH CCTV	REQUIRE TO CLEAN	ASSET TYPE	AFTER CLEANING	MAIN CLEANING REQ.
ROOTS <input checked="" type="checkbox"/>	FROM ACCESS POINT	GOOD <input type="checkbox"/>	YES <input checked="" type="checkbox"/>	SAN CONN <input type="checkbox"/>	GOOD <input checked="" type="checkbox"/>	BLOCKED: YES <input type="checkbox"/>
LIGHT <input type="checkbox"/>	INSIDE PL <input checked="" type="checkbox"/> <u>11.5</u> M to <u>4.0</u> M	FAIR <input type="checkbox"/>	NO <input type="checkbox"/>	SAN MAIN <input type="checkbox"/>	POOR <input type="checkbox"/>	NO <input type="checkbox"/>
MEDIUM <input type="checkbox"/>	AT PL <input type="checkbox"/> _____ M	POOR <input checked="" type="checkbox"/>		COMB CONN <input checked="" type="checkbox"/>	FAIR <input type="checkbox"/>	FLUSH <input type="checkbox"/>
HEAVY <input checked="" type="checkbox"/>	OUTSIDE PL <input type="checkbox"/> _____ M to _____ M			COMB MAIN <input type="checkbox"/>		ROOT CUT <input type="checkbox"/>
GREASE <input type="checkbox"/>	NO BLOCKAGE <input type="checkbox"/>			STORM CONN <input type="checkbox"/>		MH #: _____ TO _____
SOLIDS <input type="checkbox"/>	ADDITIONAL INFO: _____			STORM MAIN <input type="checkbox"/>		MH #: _____
DEBRIS <input type="checkbox"/>				METRO MAIN <input type="checkbox"/>		
STRUCTURAL <input type="checkbox"/>				COMPLETE <input checked="" type="checkbox"/>	INCOMPLETE <input type="checkbox"/>	ADDITIONAL WORK <input type="checkbox"/>
OTHER/ UNKNOWN: _____						

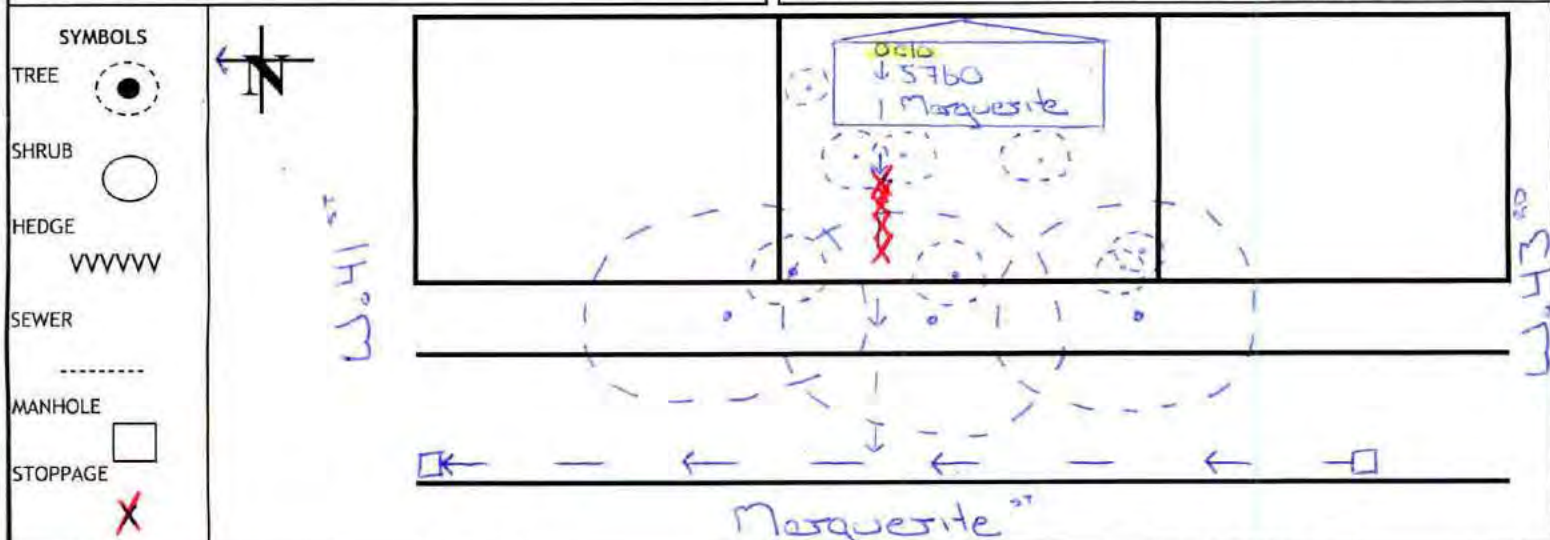

CONNECTION	DEPTH @ PL _____ M	PL IS <u>21.0</u> M FROM C/O	DEPTH @ MAIN _____ M
PRIVATE SIDE REPLACED <input type="checkbox"/>			
CITY SIDE REPLACED <input checked="" type="checkbox"/>	PL OFFSET _____ M	N S E W of N S E W	DEPTH @ HOUSE _____ M

WYE MEASUREMENTS: \_\_\_\_\_ M FROM DOWNSTREAM MH \_\_\_\_\_ M B/M

FOR OFFICE USE ONLY	MAINTAIN SCHED <input type="checkbox"/>	ADD TO SLM PROGRAM <input type="checkbox"/>	NO CHARGE <input type="checkbox"/>	DATE ADDED TO PROGRAM: _____
CIPP CANDIDATE <input type="checkbox"/>	FULL SURVEY REQ. <input type="checkbox"/>	INVITE TO SLM W/SIG <input type="checkbox"/>	SHARE <input type="checkbox"/>	
CCTV <input type="checkbox"/>	CHANGE FREQUENCY:	REMOVE FROM PROG <input checked="" type="checkbox"/>	CHARGE <input checked="" type="checkbox"/>	INVOICE CANCELLED BY: _____
SEND LETTER # <u>10</u>	6 MTH <input type="checkbox"/> 12 MTH <input type="checkbox"/>	CHANGE WITHOUT to WITH SIGNATURE <input type="checkbox"/>		DATE INVOICE CANCELLED: _____
	18 MTH <input type="checkbox"/> 24 MTH <input type="checkbox"/>	CHANGE WITH to WITHOUT SIGNATURE <input type="checkbox"/>		

COMMENTS: city side relaid, location of blockage found inside property line. INITIALS: MPR DATE: 11/28/22

SUPT COMMENTS: \_\_\_\_\_

Date: Jan. 13 20 22

Time Started 11:47 AM/PM  
Time Finished 1:22 AM/PM

Applicant's Initial \_\_\_\_\_

Applicant's Initial \_\_\_\_\_

(Owner's name and address if not the applicant)

Applicant \_\_\_\_\_ Owner \_\_\_\_\_

Property Address \_\_\_\_\_ Address 5760 Marquette

Postal Co. \_\_\_\_\_ Phone No. \_\_\_\_\_ Postal Co. \_\_\_\_\_ Phone No. \_\_\_\_\_

**For more information about Sewers & Drainage Systems, please visit us at:**  
[vancouver.ca/home-property-development/water-and-sewer.aspx](http://vancouver.ca/home-property-development/water-and-sewer.aspx)

**Terms & Conditions**

1. It is the responsibility of the applicant/owner to provide a safe, accessible clean out to the building's sanitary and storm drainage systems as per the Vancouver Building By-law & City of Vancouver OH&S Policy AE-010-02, & Workers Compensation Act .
2. City crews may work from a toilet stub if there is no other suitable or available access to the building's main sewer line, and the toilet must be removed prior to the crew's arrival.
3. If the applicant/owner is physically unable to remove the toilet, the crew may consider performing this service if the toilet is clean and in good condition, posing no foreseeable issue for reinstallation, and subject to the applicant/owner reading and signing the Toilet Removal Waiver to acknowledge his/her understanding of the waiver and that the City accepts no liability for damages when removing and/or reinstalling the toilet.
4. The applicant/owner agrees to pay all costs in accordance with the Sewer And Watercourse By-law 8093. A summary of findings will be included with the invoice.
5. City crews cannot advise if potential charges will or will not apply related to the cause of the blockage

The undersigned hereby releases and discharges the City of Vancouver and its respective officials, officers, employees, servants or agents (the "City") and covenants and agrees to indemnify and save harmless the City from and against all claims, losses, actions, builders' liens, indirect or consequential damages (and including loss of use and damages arising out of delays) which may arise or accrue to the undersigned or any person, firm or corporation against the City or which the City may pay, incur, sustain or be put to and that arise or would not have been incurred but for the conduct of the work, or any portion thereof, by City employees, which work in the opinion of the City Engineer is the responsibility of the undersigned or any third party other than the City. Without limiting the generality of the foregoing, the undersigned will be responsible for the cost of any work conducted by City employees at or in the vicinity of the property which is necessitated by an obstruction originating from the property or by any damage to the sewer lines caused by the undersigned or a third party other than the City regardless of whether the obstructed or damaged sewer lines are located on private property or on City of Vancouver property.

Eng 586(20)

I, the undersigned, agree to the above terms and conditions

Applicant \_\_\_\_\_ Date \_\_\_\_\_ 20 \_\_\_\_\_

City Engineer Per 



Date: Jan. 13 20 22

Time Started 11:47 AM/PM  
Time Finished 1:22 AM/PM

Applicant's Initial \_\_\_\_\_

Applicant's Initial \_\_\_\_\_

(Owner's name and address if not the applicant)

Applicant \_\_\_\_\_ Owner \_\_\_\_\_

Property Address \_\_\_\_\_ Address 5760 Marguerite

Postal Co. \_\_\_\_\_ Phone No. \_\_\_\_\_ Postal Co. \_\_\_\_\_ Phone No. \_\_\_\_\_

For more information about Sewers & Drainage Systems, please visit us at:  
[vancouver.ca/home-property-development/water-and-sewer.aspx](http://vancouver.ca/home-property-development/water-and-sewer.aspx)

**Terms & Conditions**

1. It is the responsibility of the applicant/owner to provide a safe, accessible clean out to the building's sanitary and storm drainage systems as per the Vancouver Building By-law & City of Vancouver OH&S Policy AE-010-02, & Workers Compensation Act .
2. City crews may work from a toilet stub if there is no other suitable or available access to the building's main sewer line, and the toilet must be removed prior to the crew's arrival.
3. If the applicant/owner is physically unable to remove the toilet, the crew may consider performing this service if the toilet is clean and in good condition, posing no foreseeable issue for reinstallation, and subject to the applicant/owner reading and signing the Toilet Removal Waiver to acknowledge his/her understanding of the waiver and that the City accepts no liability for damages when removing and/or reinstalling the toilet.
4. The applicant/owner agrees to pay all costs in accordance with the Sewer And Watercourse By-law 8093. A summary of findings will be included with the invoice.
5. City crews cannot advise if potential charges will or will not apply related to the cause of the blockage

The undersigned hereby releases and discharges the City of Vancouver and its respective officials, officers, employees, servants or agents (the "City") and covenants and agrees to indemnify and save harmless the City from and against all claims, losses, actions, builders' liens, indirect or consequential damages (and including loss of use and damages arising out of delays) which may arise or accrue to the undersigned or any person, firm or corporation against the City or which the City may pay, incur, sustain or be put to and that arise or would not have been incurred but for the conduct of the work, or any portion thereof, by City employees, which work in the opinion of the City Engineer is the responsibility of the undersigned or any third party other than the City. Without limiting the generality of the foregoing, the undersigned will be responsible for the cost of any work conducted by City employees at or in the vicinity of the property which is necessitated by an obstruction originating from the property or by any damage to the sewer lines caused by the undersigned or a third party other than the City regardless of whether the obstructed or damaged sewer lines are located on private property or on City of Vancouver property.

Eng 586(20)

I, the undersigned, agree to the above terms and conditions

Applicant \_\_\_\_\_ Date \_\_\_\_\_ 20 \_\_\_\_\_

City Engineer Per [Signature]

*Handwritten notes:* City of Vancouver - FOI 2022-076 - Page 4 of 4  
Blockage  
found inside property line