

File No.: 04-1000-20-2024-633

December 4, 2024

s.22(1)

Dear s.22(1)

Re: **Request for Access to Records under the Freedom of Information and Protection of Privacy Act (the "Act")**

I am responding to your request of October 22, 2024 under the *Freedom of Information and Protection of Privacy Act* for:

**Record of HOV lane at 1900 to 2000 Block of Hastings Street (Eastbound on Hastings between Victoria and Semlin) as of November 2017, specifically:**

- 1. What restricted lane existed at that time;**
- 2. What signage was erected at that time; and**
- 3. When was the signage installed.**

All responsive records are attached.

Please note, Traffic and Data Management (TDM) Branch staff have advised that the Form 1 record drawing (page 18 of 28) proposed the installation of two overhead "Reserve Bus / Bike Lane 3PM – 6PM (Mon – Fri)" regulatory signs, complemented by HOV diamond pavement markings on the 1900 blk of Hastings St in the Eastbound direction. The Form 1 was approved on July 31, 2009 by the Acting Assistant City Engineer; the Traffic Operations Branch confirmed the completed installation on November 27, 2009 (page 1 of 28).

Under Part 5 of the Act, you may ask the Information & Privacy Commissioner to review any matter related to the City's response to your FOI request by writing to: Office of the Information & Privacy Commissioner, [info@oipc.bc.ca](mailto:info@oipc.bc.ca) or by phoning 250-387-5629.

If you request a review, please provide the Commissioner's office with: 1) the request number (2024-633); 2) a copy of this letter; 3) a copy of your original request; and 4) detailed reasons why you are seeking the review.

Yours truly,

Kevin Tuerlings, FOI Case Manager, for

*[Signed by Kevin Tuerlings]*

**Cobi Falconer, MAS, MLIS, CIPP/C**  
**Director, Access to Information & Privacy**

If you have any questions, please email us at [foi@vancouver.ca](mailto:foi@vancouver.ca) and we will respond to you as soon as possible. You may also contact 3-1-1 (604-873-7000) if you require accommodation or do not have access to email.

Encl. (Response Package)

:pm

CITY OF VANCOUVER ENGINEERING SERVICES  
TRANSPORTATION DIVISION FORM 1

FILE # 590 130 W Hastings

APR

STREET(S) Hastings St. (Seymour St. to Boundary Rd.)

BLOCK(S) W 600 - E 3600

PROJECT Install Bus/Bicycle Reserved Lanes

SOURCE COV and Translink

DATE RECEIVED

ADDRESS

PHONE

INVESTIGATION

City Council has approved the installation of transit priority measures on Hasting St. which will be funded by Translink. Overhead bus/bicycle reserved lane signs and painted reserved lane diamonds will be installed in the eastbound direction from Seymour St. to Boundary Rd. and in the westbound direction from Boundary Rd. to Carrall St. The bus/bicycle reserved lanes will be in effect from (3pm-6pm, Mon-Fri) in the eastbound direction, and from (7am-9:30am, Mon-Fri) in the westbound direction. Note that there are existing (bus/HOV/bicycle) reserved lane overhead signs from Boundary Rd. to Renfrew St. in the westbound direction (6am-8:30am, Mon-Fri) and in the eastbound direction (3:30pm-6pm, Mon-Fri).

INSTRUCTIONS

Install reserved lane bus/bicycle signs and paint reserved lane diamonds as shown on the attached drawings.

INVENTORY

See attached inventory list.

RECEIVED  
AUG 05 2009

91708

|                           |          |               |     |                     |     |     |      |
|---------------------------|----------|---------------|-----|---------------------|-----|-----|------|
| ACCOUNT / WORK ORDER #    | 10035158 | DRWG ATTACHED | YES | X                   | NO  | TD# | 7799 |
| CO-ORDINATE WITH: STREETS | YES      | NO            | X   | ELECTRICAL          | YES | X   | NO   |
| ADVISE: POLICE            | YES      | NO            | X   | PARKING ENFORCEMENT | YES | NO  | X    |
|                           |          |               |     | FIRE                | YES | NO  | X    |

|              |               |       |         |      |         |    |    |
|--------------|---------------|-------|---------|------|---------|----|----|
| AUTHOR       | M. Markovic   | LOCAL | 7909    | DATE | June 18 | 20 | 09 |
| SECTION HEAD | Neal Peacocke | DATE  | June 18 | 20   | 09      |    |    |

|                 |                    |                   |  |             |  |
|-----------------|--------------------|-------------------|--|-------------|--|
| TRAFFIC MGT ENG | <i>[Signature]</i> | NEIGHBOURHOOD ENG |  | PARKING ENG |  |
| DATE            | July 30            | DATE              |  | DATE        |  |

|                     |  |               |  |              |                    |
|---------------------|--|---------------|--|--------------|--------------------|
| STRATEG. TRANS. ENG |  | CITY ENGINEER |  | A.C.E. TRANS | <i>[Signature]</i> |
| DATE                |  | DATE          |  | DATE         | July 31, 2009      |

|                         |                      |              |        |      |    |
|-------------------------|----------------------|--------------|--------|------|----|
| COMPLETED BY:           | ELECTRICAL - BK + JW | DATE         | Nov 27 | 20   | 09 |
| NOTIFIED:               | POLICE               | PARKING ENF. |        | DATE |    |
| CHECKED BY:             | BK                   | DATE         | Nov 27 | 20   | 09 |
| UPDATE INVENTORY FILES: | YES                  | NO           | BY:    | DATE |    |

|              |                |                |                |               |               |                |
|--------------|----------------|----------------|----------------|---------------|---------------|----------------|
| ROUTING:     | <del>MM</del>  | <del>NAP</del> | <del>EAB</del> | <del>MM</del> | <del>MM</del> | <del>CEB</del> |
| AUTHOR       | SEC. HEAD      | BR. HEAD       | FUNDS APPR.    | A.C.E.        | AUTHOR        | TD. SEC.       |
| TRAFFIC OPS. | <del>CEB</del> | <del>NAP</del> | <del>EAB</del> | <del>MM</del> | <del>MM</del> | RECORDS        |
|              | SEC. HEAD      | BR. HEAD       | AUTHOR         | FILING        | PARKING BR.   | MGMT           |



DOC/201 2 /

1/23



**CITY OF VANCOUVER ENGINEERING DEPT. TRAFFIC AND ELECTRICAL OPERATIONS TASK ASSIGNMENT**

|             |              |                      |             |                |        |
|-------------|--------------|----------------------|-------------|----------------|--------|
| Log Number: | Task Number: | Section:             | SAP Number: | Assigned To:   | Truck: |
| 192509      | 264029       | TRAFFIC SIGNAL-FIELD | 10025158    | Kennett, Brian |        |

|              |        |                       |                    |            |
|--------------|--------|-----------------------|--------------------|------------|
| Pole Number: | Block: | Main Street: (NS)     | Cross Street: (EW) | Direction: |
| 0 /          | 9999   | VANCOUVER & CITY WIDE |                    |            |

|              |           |            |       |              |            |       |            |            |                |
|--------------|-----------|------------|-------|--------------|------------|-------|------------|------------|----------------|
| Date:        | Dispatch: | Time: 24hr | Date: | Arrived:     | Time: 24hr | Date: | Completed: | Time: 24hr | Task Class:    |
| 09 / 14 / 09 | 09 # 33   |            |       | 11 / 27 / 09 |            |       |            |            | SIGN - INSTALL |

Assigned By: Kennett, Brian

**Original Call:**

INSTALL / REMOVE " HASTINGS ST." H.O.V. SIGNS AS PER PRINT.

**Action Required:**

INSTALL / REMOVE " HASTINGS ST." H.O.V. SIGNS AS PER PRINT.

**Condition on Arrival: Mark all applicable boxes with an "X" for Yes**

- In Flash  
  All Out  
  Lamp Out  
  MVA  
  Hydro Out  
  VPD On Scene  
 Checksum  
  Stuck Ped  
  Stuck Veh  
  Plant Damaged  
  Other  
  NFF  
 Stops Set:   
 Flash Set:   
 Temp Op:   
 Normal Op:

**Problem found:**

AS DESCRIBED

**Action Taken:**

COMPLETED AS REQUIRED

**Departure Checklist:**

- Equip Secure  
  Walkaround  
  Lamps  
  Loops  
  Audibles  
  Buttons  
  Cab Door  
 Flashplugs  
  Paperwork  
  Comm  
  AC Calib  
  Clock  
  Serial  
  Security  
 Clear Log

**Other Action Required:**

**Controller #**

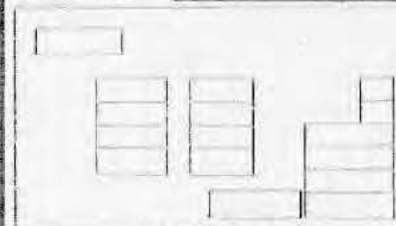

**Switch Packs**

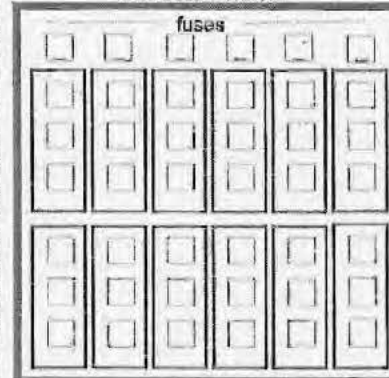

**Monitor #**

Monitor Type  
 2312 2311 210

**Damage**

- Controller  
 Main Frame  
 Veh. Detector  
 Ped. Detector  
 Monitor  
 Loadpack  
 Flasher  
 Fuse  
 Modem  
**On Arrival**  
 Display Lit  
 Stuck

W.D.(Pulse)  
 FAIL(power)  
 CONFLICT  
 8 1   
 9 2   
 10 3   
 11 4   
 12 5

**CITY OF VANCOUVER ENGINEERING DEPT. TRAFFIC AND ELECTRICAL OPERATIONS TASK ASSIGNMENT**

Log Number: 192509 Task Number: 264109 Section: TRAFFIC SIGNAL-FIELD SAP Number: 10035158 Assigned To: WEATHERBY, JODY Truck:

Pole Number: 0 / Block: 9999 Main Street: (N/S) VANCOUVER & CITY WIDE Cross Street: (EW) Direction:

Date: 09 / 15 / 09 Dispatch: 07 # 00 Time: 24hr Data: MM / DD / YY Arrived: # Time: 24hr Data: 11 / 13 / 09 Completed: # Time: 24hr Data: MM / DD / YY Task Class: SIGN - INSTALL

Assigned By: Kennett, Brian

Original Call: INSTALL / REMOVE " HASTINGS ST." H.O.V. SIGNS AS PER PRINT.

Action Required: INSTALL / REMOVE " HASTINGS ST." H.O.V. SIGNS AS PER PRINT. CLARK TO TEMPLETON E/B ONLY. BRACKET COLOR GREEN. SEE BRACKET COLOR CHART.

Condition on Arrival: Mark all applicable boxes with an "X" for Yes  
 In Flash  All Out  Lamp Out  MVA  Hydro Out  VPD On Scene  
 Checksum  Stuck Ped  Stuck Veh  Plant Damaged  Other  NFF  
 Stops Set: [ ] Flash Set: [ ] Temp Op: [ ] Normal Op: [ ]

Problem found: AS DESCRIBED

Action Taken: COMPLETED AS REQUIRED

Departure Checklist:  
 Equip Secure  Walkaround  Lamps  Loops  Audibles  Buttons  Cab Door  
 Flashplugs  Paperwork  Comm  AC Callb  Clock  Serial  Security  
 Clear Log  [ ]  [ ]  [ ]  [ ]  [ ]

Other Action Required:

Controller #

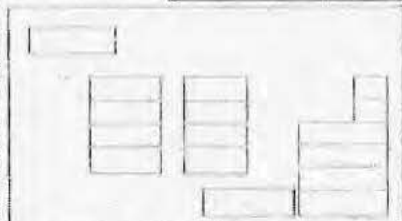

Switch Packs



Monitor #

Monitor Type: 2312 2311 210  
 Damage:  
 Controller  
 Main Frame  
 Veh. Detector  
 Ped. Detector  
 Monitor  
 Loadpack  
 Flasher  
 Fuse  
 Modem  
 On Arrival  
 Display Lit  
 Stuck  
 Sig. Bus Breaker  
 W.D.(Pulse)  
 FAIL(power)  
 CONFLICT  
 8 1 [ ]  
 9 2 [ ]  
 10 3 [ ]  
 11 4 [ ]  
 12 5 [ ]



**CITY OF VANCOUVER ENGINEERING DEPT. TRAFFIC AND ELECTRICAL OPERATIONS TASK ASSIGNMENT**

|             |              |                      |             |                 |        |
|-------------|--------------|----------------------|-------------|-----------------|--------|
| Log Number: | Task Number: | Section:             | SAP Number: | Assigned To:    | Truck: |
| 192509      | 266417       | TRAFFIC SIGNAL-FIELD | 10035158    | WEATHERBY, JODY |        |

|              |        |                       |                    |            |
|--------------|--------|-----------------------|--------------------|------------|
| Pole Number: | Block: | Main Street: (NS)     | Cross Street: (EW) | Direction: |
| 0 /          | 9999   | VANCOUVER & CITY WIDE |                    |            |

|              |           |            |       |          |            |              |            |            |                |
|--------------|-----------|------------|-------|----------|------------|--------------|------------|------------|----------------|
| Date:        | Dispatch: | Time: 24hr | Date: | Arrived: | Time: 24hr | Date:        | Completed: | Time: 24hr | Task Class:    |
| 10 / 19 / 09 | 07 # 00   |            |       |          |            | 11 / 27 / 09 |            |            | SIGN - INSTALL |

Assigned By: McNeill, Walter

Original Call:  
INSTALL / REMOVE " HASTINGS ST." H.O.V. SIGNS AS PER PRINT.

Action Required:  
INSTALL / REMOVE " HASTINGS ST." H.O.V. SIGNS W/B AS PER PRINT.

Condition on Arrival: Mark all applicable boxes with an "X" for Yes

|                                   |                                    |                                    |  |                                    |                                       |
|-----------------------------------|------------------------------------|------------------------------------|--|------------------------------------|---------------------------------------|
| <input type="checkbox"/> In Flash | <input type="checkbox"/> All Out   | <input type="checkbox"/> Lamp Out  | <input type="checkbox"/> MVA           | <input type="checkbox"/> Hydro Out | <input type="checkbox"/> VPD On Scene |
| <input type="checkbox"/> Checksum | <input type="checkbox"/> Stuck Ped | <input type="checkbox"/> Stuck Veh | <input type="checkbox"/> Plant Damaged | <input type="checkbox"/> Other     | <input type="checkbox"/> NFF          |

Stops Set:  Flash Set:  Temp Op:  Normal Op:

Problem found:  
AS DESCRIBED

Action Taken:  
COMPLETED AS REQUIRED

Departure Checklist:

|                                       |                                     |                                |                                   |                                   |                                  |                                   |
|---------------------------------------|-------------------------------------|--------------------------------|-----------------------------------|-----------------------------------|----------------------------------|-----------------------------------|
| <input type="checkbox"/> Equip Secure | <input type="checkbox"/> Walkaround | <input type="checkbox"/> Lamps | <input type="checkbox"/> Loops    | <input type="checkbox"/> Audibles | <input type="checkbox"/> Buttons | <input type="checkbox"/> Cab Door |
| <input type="checkbox"/> Flashplugs   | <input type="checkbox"/> Paperwork  | <input type="checkbox"/> Comm  | <input type="checkbox"/> AC Calib | <input type="checkbox"/> Clock    | <input type="checkbox"/> Serial  | <input type="checkbox"/> Security |
| <input type="checkbox"/> Clear Log    | <input type="checkbox"/>            | <input type="checkbox"/>       | <input type="checkbox"/>          | <input type="checkbox"/>          | <input type="checkbox"/>         | <input type="checkbox"/>          |

Other Action Required:

Controller #

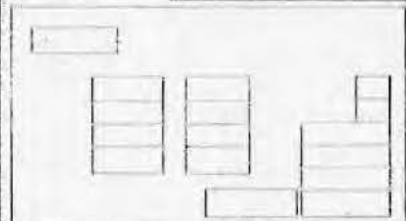

Switch Packs

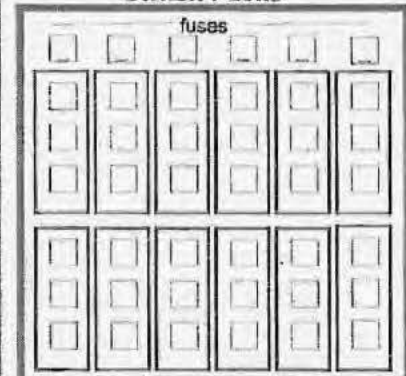

Monitor #

|  |  |
|--|--|
| Monitor Type   | Damage                                 |
| 2312 2311 210  | <input type="checkbox"/> Controller    |
| <input type="checkbox"/> <input type="checkbox"/> <input type="checkbox"/> | <input type="checkbox"/> Main Frame    |
| <input type="checkbox"/> W.D.(Pulse)                                       | <input type="checkbox"/> Veh. Detector |
| <input type="checkbox"/> FAIL(power)                                       | <input type="checkbox"/> Ped. Detector |
| <input type="checkbox"/> CONFLICT  | <input type="checkbox"/> Monitor       |
| <input type="checkbox"/> 8 1 <input type="checkbox"/>                      | <input type="checkbox"/> Loadpack      |
| <input type="checkbox"/> 9 2 <input type="checkbox"/>                      | <input type="checkbox"/> Flasher       |
| <input type="checkbox"/> 10 3 <input type="checkbox"/>                     | <input type="checkbox"/> Fuse          |
| <input type="checkbox"/> 11 4 <input type="checkbox"/>                     | <input type="checkbox"/> Modem         |
| <input type="checkbox"/> 12 5 <input type="checkbox"/>                     | <input type="checkbox"/> On Arrival    |
|  | <input type="checkbox"/> Display Lit   |
|  | <input type="checkbox"/> Stuck         |

**CITY OF VANCOUVER ENGINEERING DEPT. TRAFFIC AND ELECTRICAL OPERATIONS TASK ASSIGNMENT**

Log Number: 192509 Task Number: 264469 Section: TRAFFIC SIGNAL-FIELD SAP Number: 10035158 Assigned To: WEATHERBY, JODY Truck:

Pole Number: 0 / Block: 9999 Main Street: (N/S) VANCOUVER & CITY WIDE Cross Street: (E/W) Direction:

Date: 09 / 21 / 09 Dispatch: 07 # 00 Time: 24hr Date: Arrived: # Time: 24hr Date: Completed: 09 / 21 / 09 # Time: 24hr Task Class: SIGN - INSTALL

Assigned By: Kennett, Brian

Original Call: INSTALL / REMOVE "HASTINGS ST." H.O.V. SIGNS AS PER PRINT.

Action Required: INSTALL / REMOVE "HASTINGS ST." HOV SIGNS AS PER PRINT. MAIN TO CLARK. E/B ONLY. NOTE COLORS: BLUE AND GREEN. SEE COLOUR CHART.

Condition on Arrival: Mark all applicable boxes with an "X" for Yes

In Flash  All Out  Lamp Out  MVA  Hydro Out  VPD On Scene

Checksum  Stuck Ped  Stuck Veh  Plant Damaged  Other  NFF

Stops Set: Flash Set: Temp Op: Normal Op:

Problem found: AS DESCRIBED

Action Taken: COMPLETED AS REQUIRED

Departure Checklist:

Equip Secure  Walkaround  Lamps  Loops  Audibles  Buttons  Cab Door

Flashplugs  Paperwork  Comm  AC Calib  Clock  Serial  Security

Clear Log

Other Action Required:

Controller #

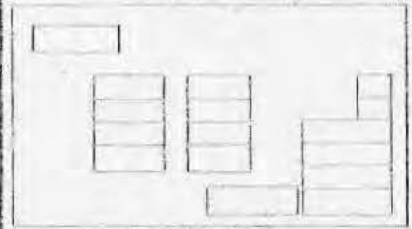

**Switch Packs**

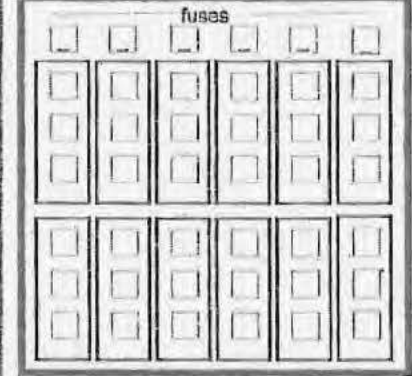

Monitor #

Monitor Type: 2312 2311 210

Damage:

Controller

Main Frame

Veh. Detector

Ped. Detector

Monitor

Loadpack

Flasher

Fuse

Modern

On Arrival

Display Lit

Stuck

Six Bus Breaker

W.D.(Pulse)

FAIL(power)

CONFLICT

8 1

9 2

10 3

11 4

12 5



# HASTINGS BUS/BIKE LANE SIGN INVENTORY

| <u>SIGN</u>   | <u>DESCRIPTION</u>                          | <u>AMOUNT</u> |
|---|---|---------------|
|    | Overhead<br>Mount<br>WA Misc 6<br>Oversized | 1             |
|    | Overhead<br>Mount<br>CUSTOM<br>36" x 48"    | 1             |
|  | Overhead<br>Mount<br>RB 80-3<br>36" x 48"   | 1             |
|  | Overhead<br>Mount<br>RB 80-2<br>36" x 48"   | 66            |



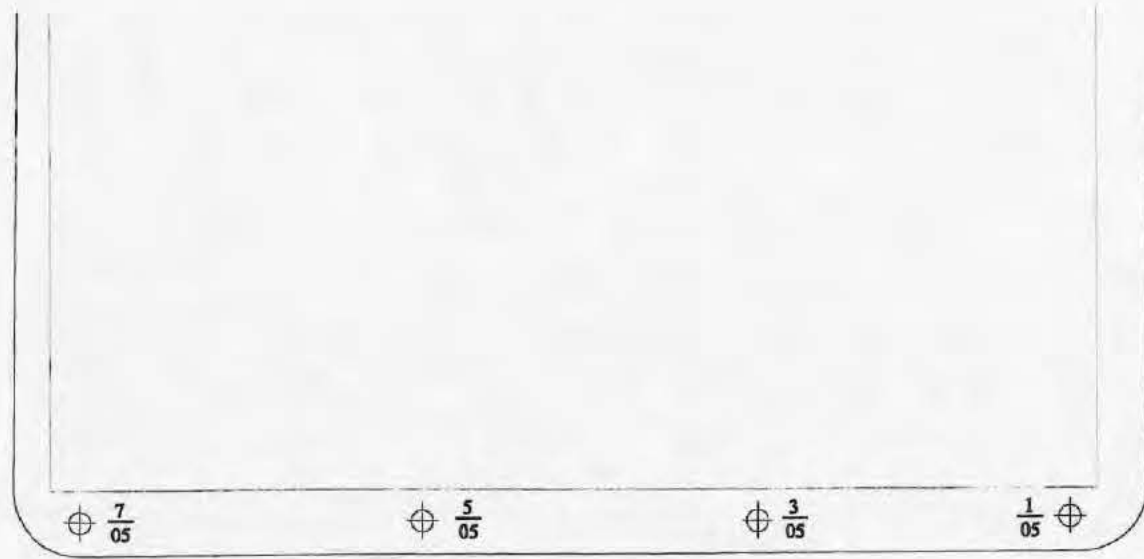
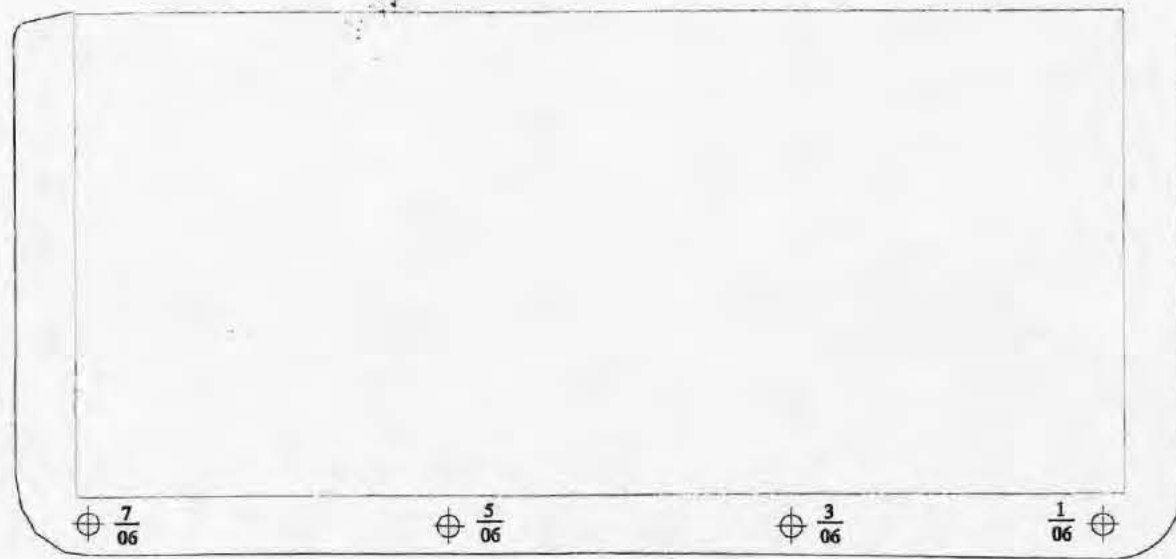

HASTINGS ST.



GRANVILLE ST.

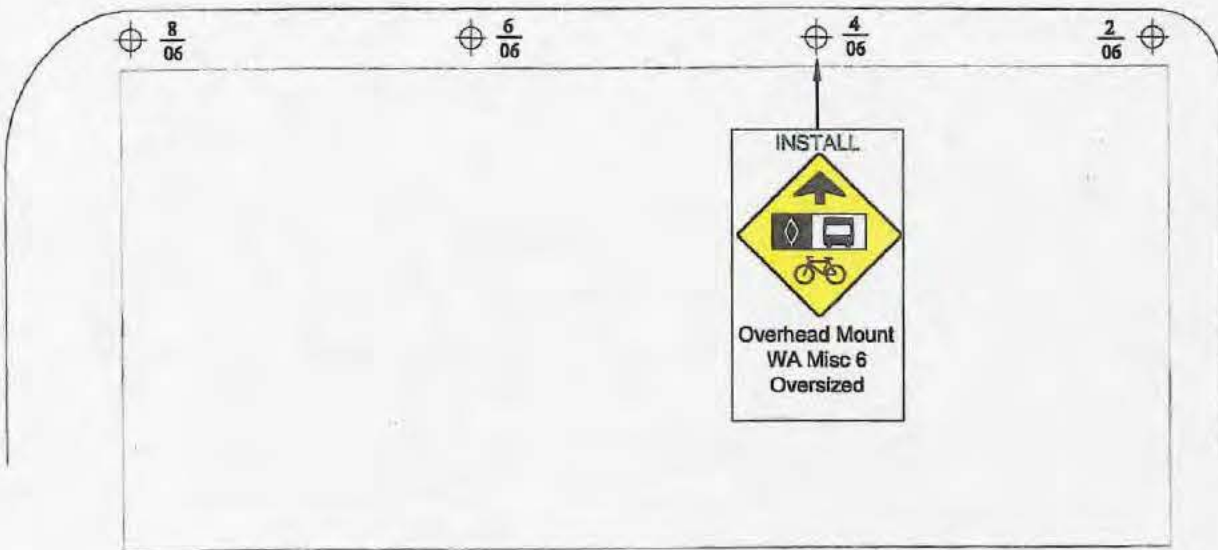

SEYMOUR ST.

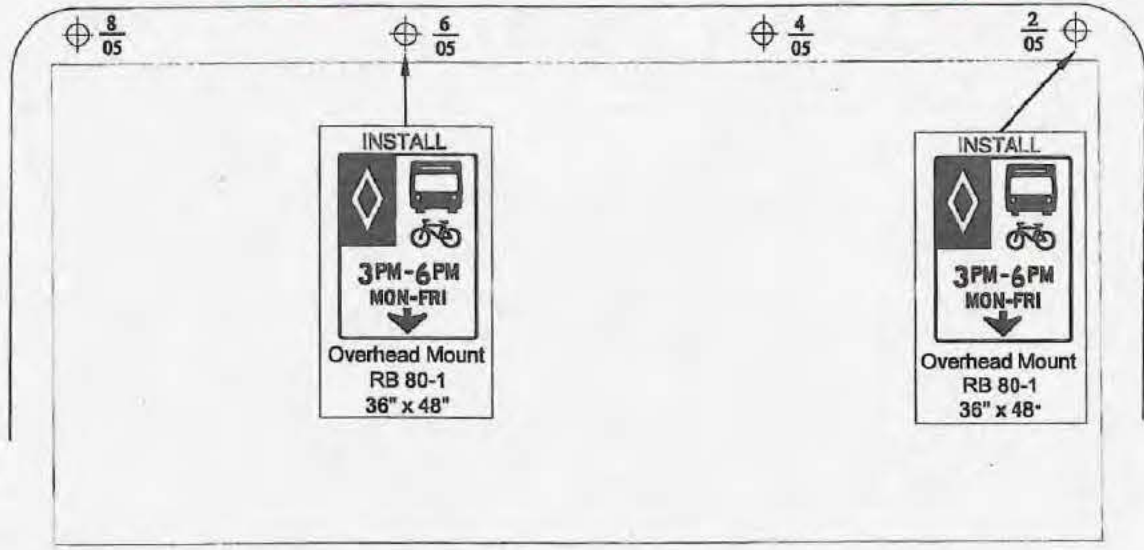

RICHARDS ST.



3172



| NO. | DATE | REVISION | BY | CHK |
|-----|------|----------|----|-----|
|     |      |          |    |     |
|     |      |          |    |     |
|     |      |          |    |     |
|     |      |          |    |     |
|     |      |          |    |     |

ATTENTION  
ELEVATIONS & COORDINATES  
SHOWN ON THIS PLAN  
ARE IN METRES BASED ON  
G.V.R.D. NAD83 DATUM



|                             |         |
|-----------------------------|---------|
| DIV./BR. TRAFFIC MANAGEMENT |         |
| DATE: 09-05-01              | DESIGN: |
| DWG: MM                     | CHK:    |
| REFS:                       |         |

ENGINEERING SERVICES

BUS/BIKE LANE INSTALLATION  
HASTINGS ST.  
GRANVILLE ST. TO RICHARDS ST.

|            |       |
|------------|-------|
| SCALE:     | NTS   |
| DIRECTORY: |       |
| DWG. NO.   |       |
| SHEET      | OF 21 |
| REVISION:  | 0     |

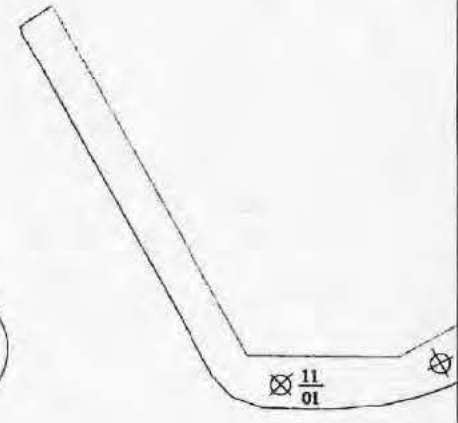
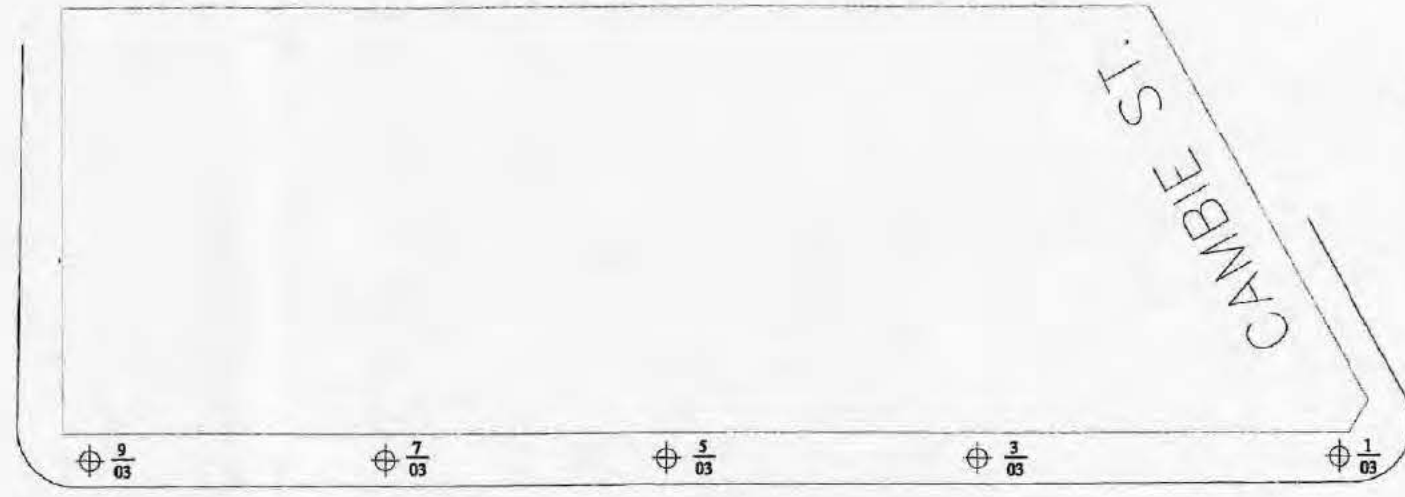
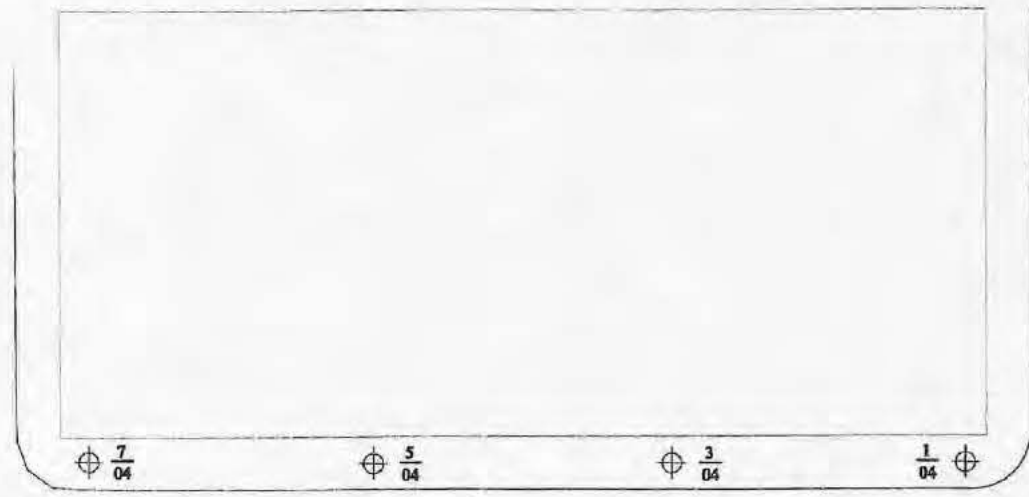

HASTINGS ST.

RICHARDS ST.

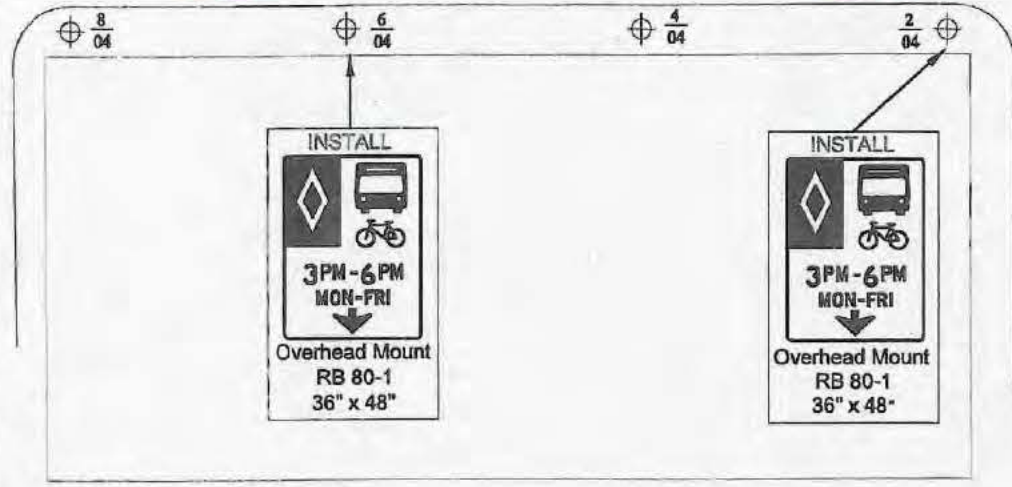

HOMER ST.

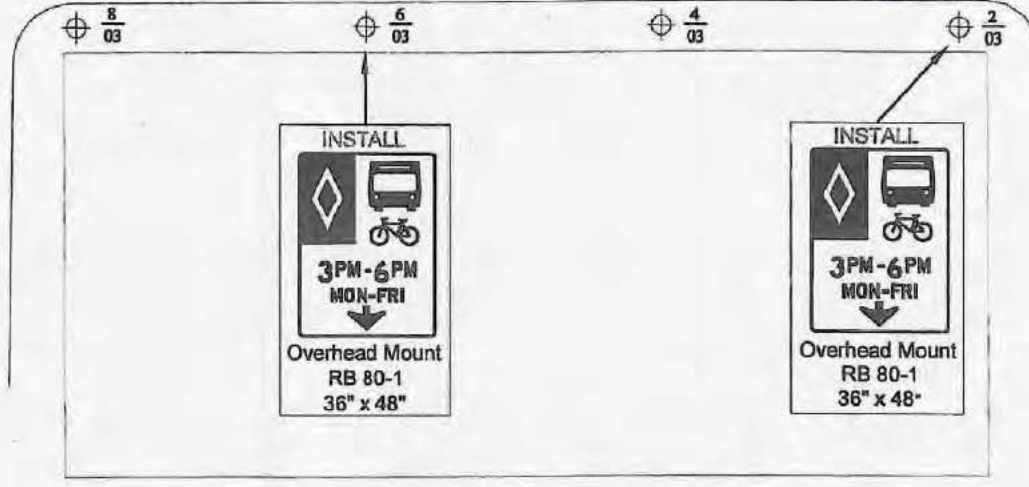

HAMILTON ST.

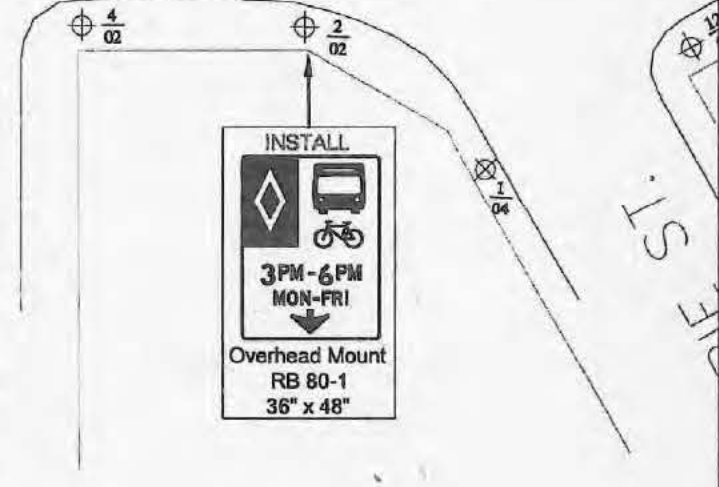

| NO. | DATE | REVISION | BY | CHK |
|-----|------|----------|----|-----|
|     |      |          |    |     |
|     |      |          |    |     |
|     |      |          |    |     |

**ATTENTION**  
 ELEVATIONS & COORDINATES  
 SHOWN ON THIS PLAN  
 ARE IN METRES BASED ON  
 G.V.R.D. NAD83 DATUM

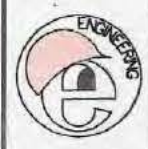

|                             |         |
|-----------------------------|---------|
| DIV./BR. TRAFFIC MANAGEMENT |         |
| DATE: 09-05-01              | DESIGN: |
| DWG: MM                     | CHK:    |
| REFS:                       |         |

**ENGINEERING SERVICES**

**BUS/BIKE LANE INSTALLATION**  
**HASTINGS ST.**  
**RICHARDS ST. TO CAMBIE ST.**

|               |                |
|---------------|----------------|
| SCALE:        | NTS            |
| DIRECTORY:    |                |
| DWG. NO.      |                |
| SHEET 2 OF 21 | REVISION: 0... |

4123



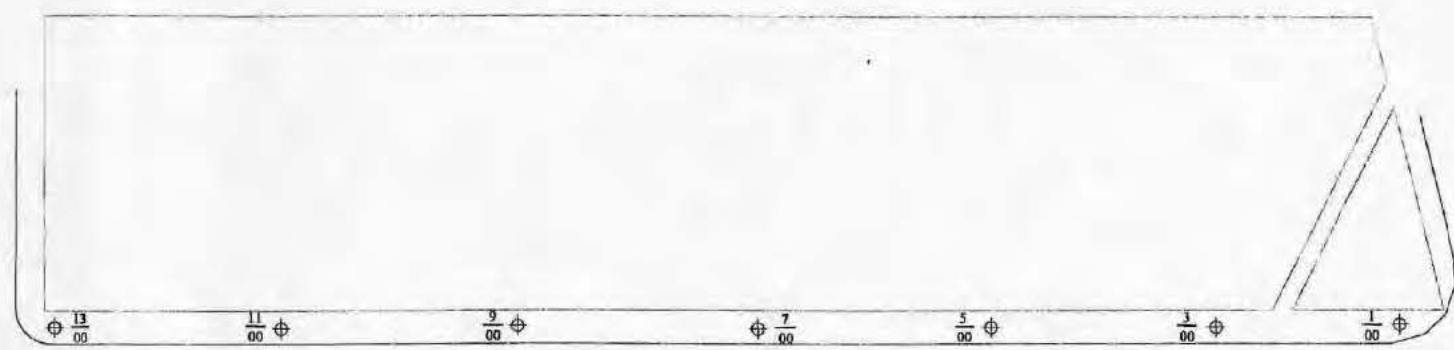
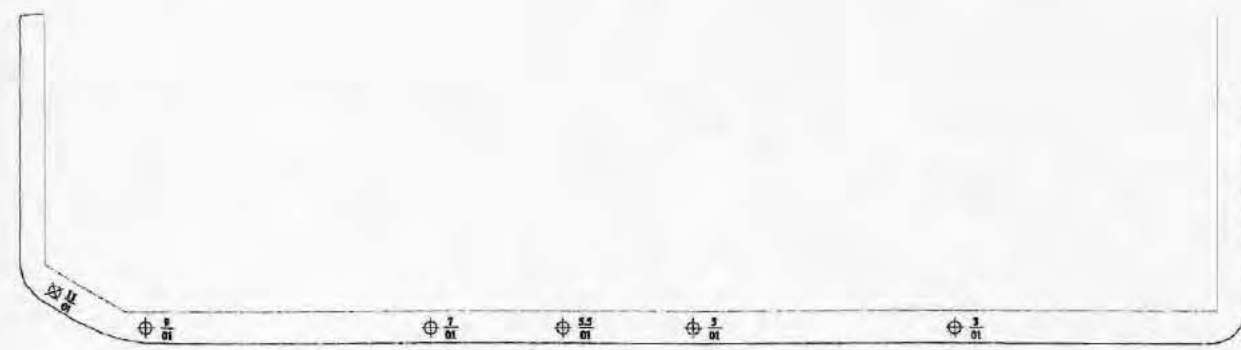

CAMBIE ST.

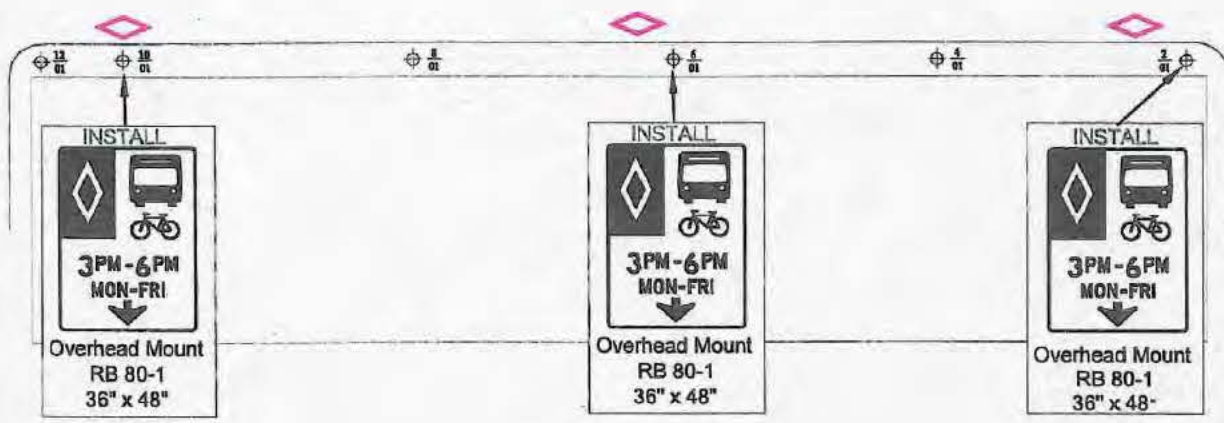

ABBOTT ST.

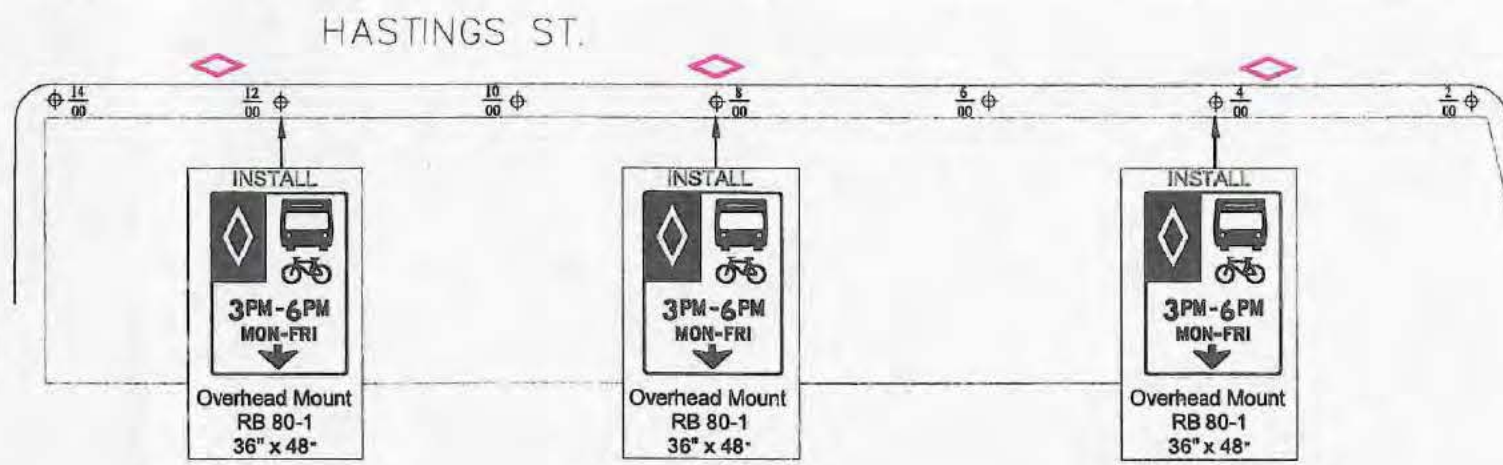

CARRALL ST.



| NO. | DATE | REVISION | BY | CHK |
|-----|------|----------|----|-----|
|     |      |          |    |     |
|     |      |          |    |     |
|     |      |          |    |     |
|     |      |          |    |     |

**ATTENTION**  
ELEVATIONS & COORDINATES  
SHOWN ON THIS PLAN  
ARE IN METRES BASED ON  
G.V.R.D. NAD83 DATUM

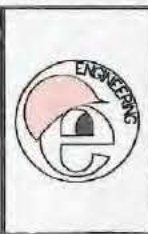

|                             |         |
|-----------------------------|---------|
| DIV./BR. TRAFFIC MANAGEMENT |         |
| DATE: 09-05-01              | DESIGN: |
| DWG: MM                     | CHK:    |
| REFS:                       |         |

**ENGINEERING SERVICES**  
**BUS/BIKE LANE INSTALLATION**  
**HASTINGS ST.**  
**CAMBIE ST. TO CARRALL ST.**

|                |             |
|----------------|-------------|
| SCALE:         | NTS         |
| DIRECTORY:     |             |
| DWG. NO.       |             |
| SHEET: 3 OF 21 | REVISION: 0 |

5173





CARRALL ST.

COLUMBIA ST.

MAIN ST.

HASTINGS ST.

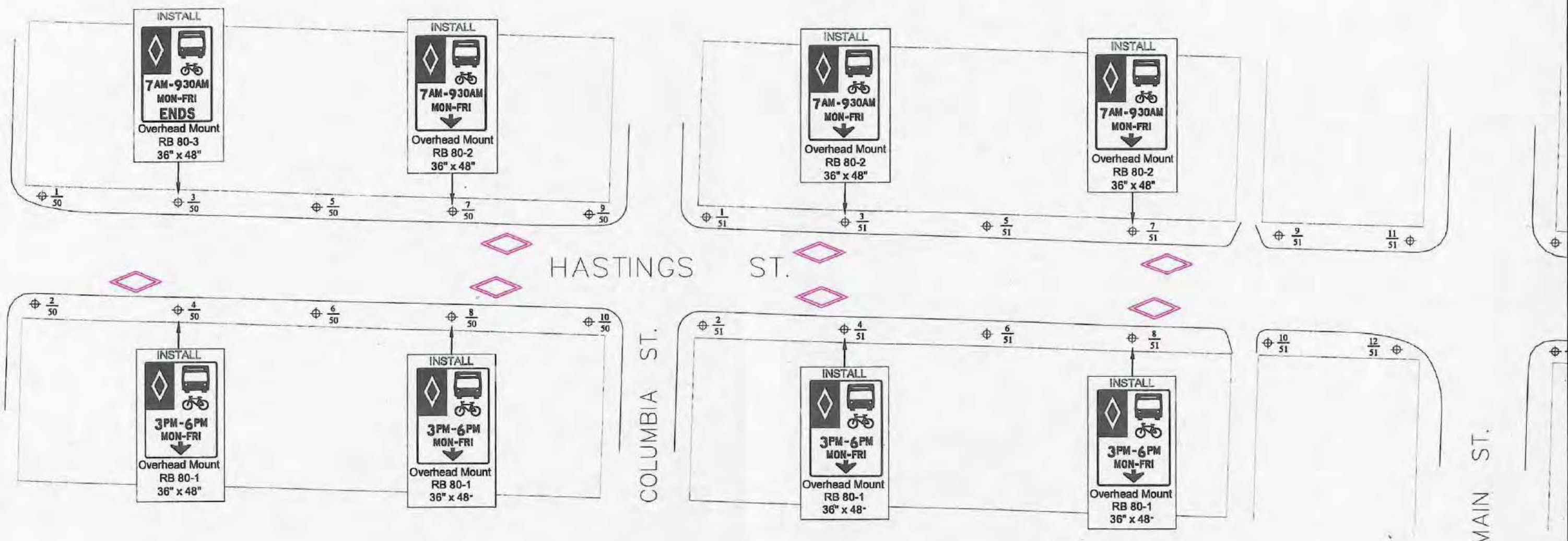

|  |     |      |          |    |  |       |  |                |  |             |
|--|-----|------|----------|----|--|-------|--|----------------|--|-------------|
|  |     |      |          |    | <b>ATTENTION</b><br>ELEVATIONS & COORDINATES<br>SHOWN ON THIS PLAN<br>ARE IN METRES BASED ON<br>G.V.R.D. NAD83 DATUM |       | <b>ENGINEERING SERVICES</b><br>DIV./BR. TRAFFIC MANAGEMENT |                | <b>BUS/BIKE LANE INSTALLATION</b><br>HASTINGS ST.<br>CARRALL ST. TO MAIN ST. | SCALE: NTS  |
|  | NO. | DATE | REVISION | BY |  |       | CHK  | DATE: 09-05-01 |  | DESIGN:     |
|  |     |      |          |    |  | REFS: |  | DWG. NO.       | DWG. NO.   | REVISION: 0 |

6123



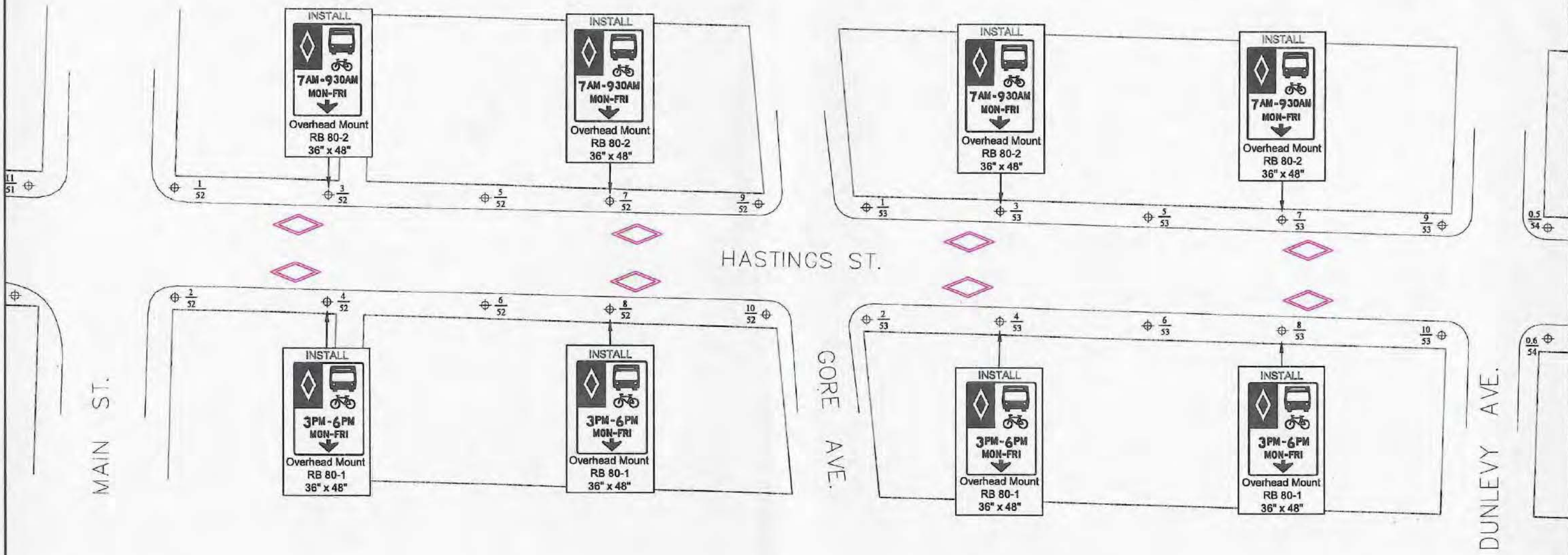

MAIN ST.

CORE AVE.

DUNLEVY AVE.

HASTINGS ST.

2/23



| NO. | DATE | REVISION | BY | CHK |
|-----|------|----------|----|-----|
|     |      |          |    |     |
|     |      |          |    |     |
|     |      |          |    |     |

**ATTENTION**  
 ELEVATIONS & COORDINATES  
 SHOWN ON THIS PLAN  
 ARE IN METRES BASED ON  
 G.V.R.D. NAD83 DATUM



|                             |         |
|-----------------------------|---------|
| DIV./BR. TRAFFIC MANAGEMENT |         |
| DATE: 09-05-01              | DESIGN: |
| DWG: MM                     | CHK:    |
| REFS:                       |         |

**ENGINEERING SERVICES**

**BUS/BIKE LANE INSTALLATION**  
**HASTINGS ST.**  
**MAIN ST. TO DUNLEVY AVE.**

|                |             |
|----------------|-------------|
| SCALE:         | NTS         |
| DIRECTORY:     |             |
| DWG. NO.       |             |
| SHEET: 5 OF 21 | REVISION: 0 |

THIS PRINT SUPERSEDES ALL PRINTS OF THIS DRAWING BEARING PREVIOUS REVISION NUMBERS



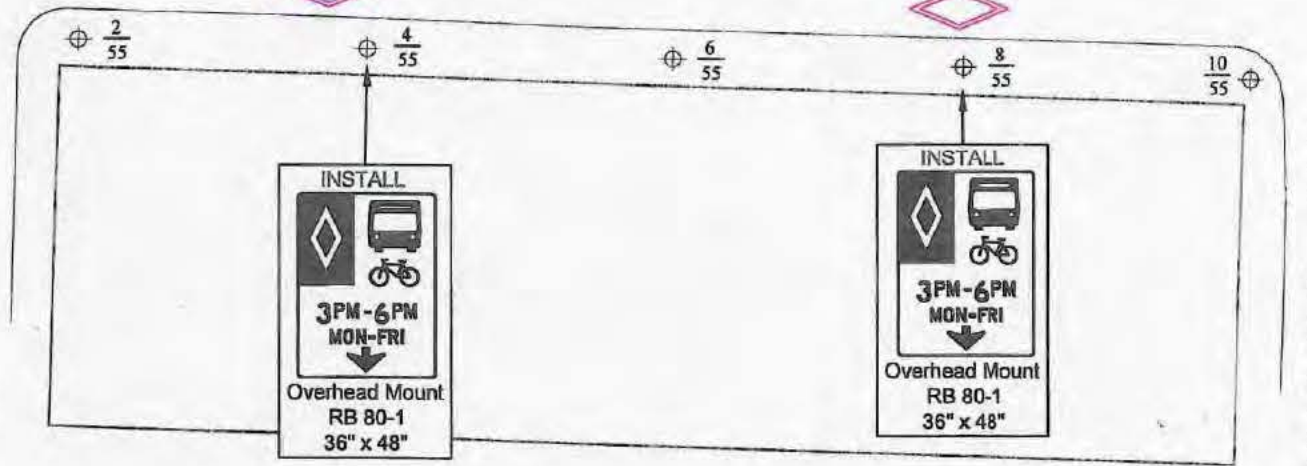
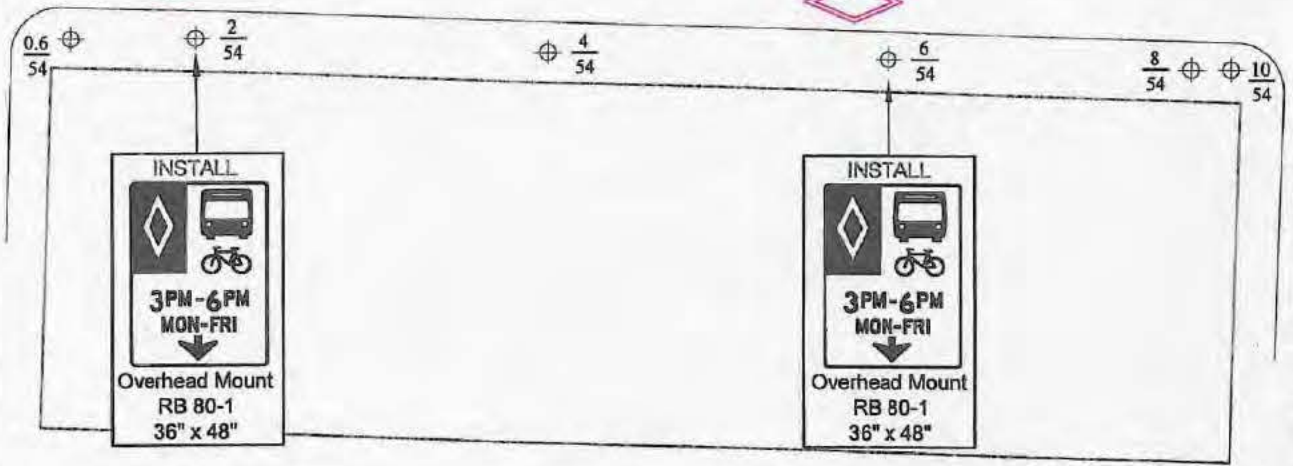
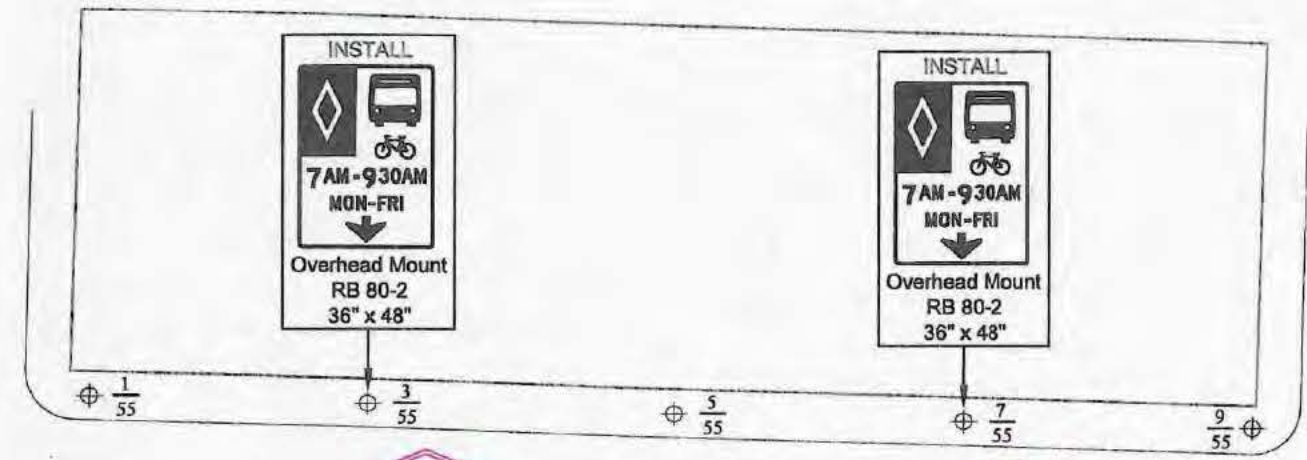
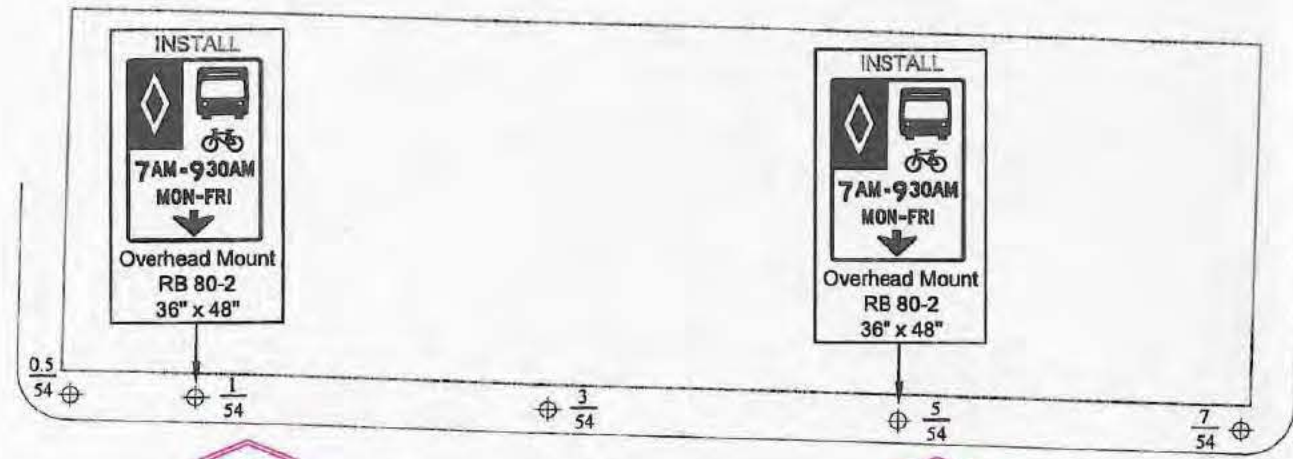

HASTINGS ST.

DUNLEVY AVE.

JACKSON AVE.

PRINCESS AVE.

218



| NO. | DATE | REVISION | BY | CHK |
|-----|------|----------|----|-----|
|     |      |          |    |     |
|     |      |          |    |     |
|     |      |          |    |     |

**ATTENTION**  
ELEVATIONS & COORDINATES  
SHOWN ON THIS PLAN  
ARE IN METRES BASED ON  
G.V.R.D. NAD83 DATUM



|  |             |
|--|-------------|
| DIV./BR. TRAFFIC MANAGEMENT<br>T.S. ELECTRICAL |             |
| DATE: 09-05-01                                 | DESIGN: CDM |
| DWG: RA  | CHK: CDM    |
| REFS:  |             |

**ENGINEERING SERVICES**

**BUS/BIKE LANE INSTALLATION  
HASTINGS ST.  
DUNLEVY AVE. TO PRINCESS AVE.**

|               |                |
|---------------|----------------|
| SCALE:        | NTS            |
| DIRECTORY:    |                |
| DWG. NO.      |                |
| SHEET 6 OF 21 | REVISION: 0... |



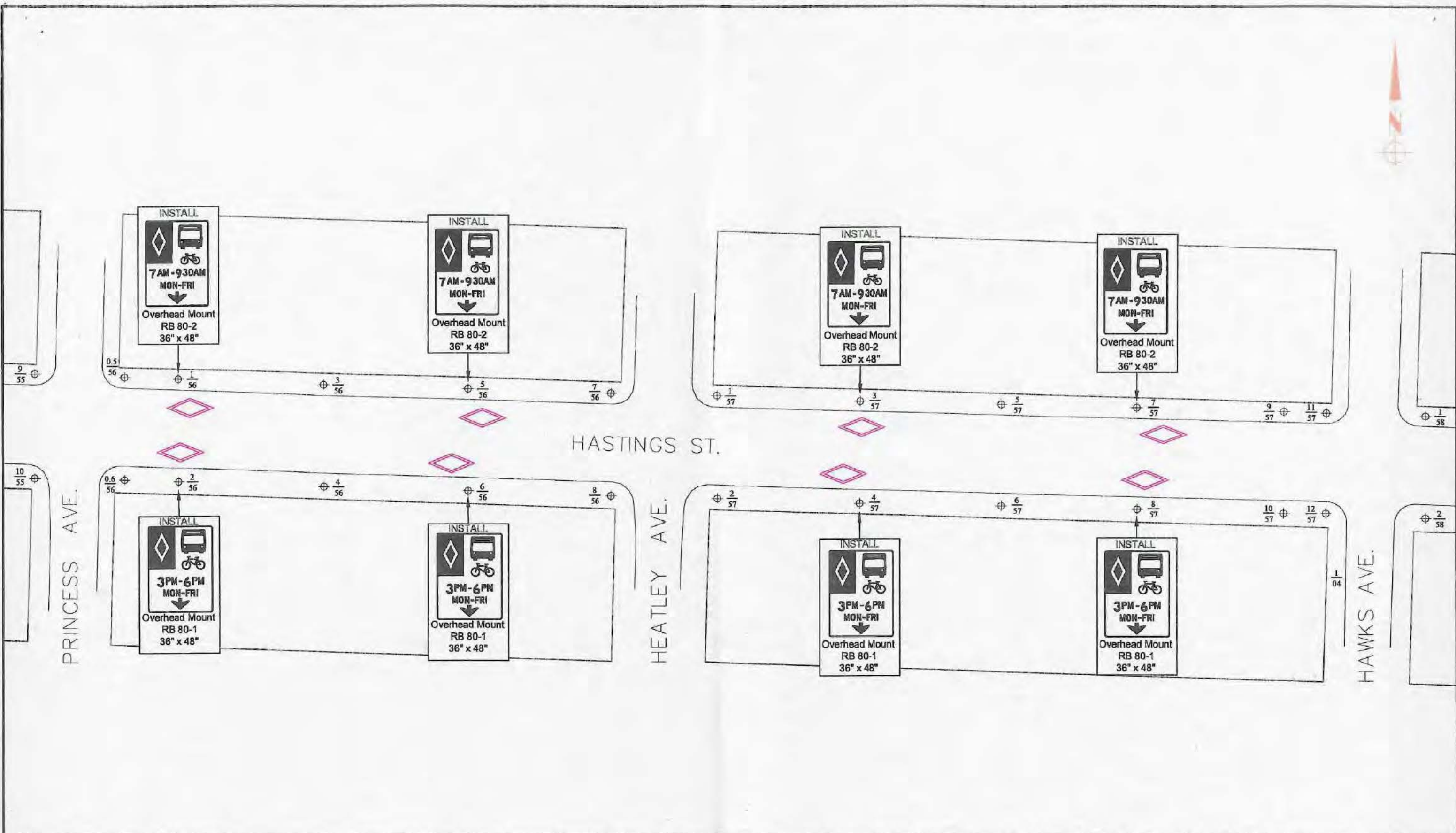

HASTINGS ST.

PRINCESS AVE.

HEATLEY AVE.

HAWKS AVE.

9173



| NO. | DATE | REVISION | BY | CHK |
|-----|------|----------|----|-----|
|     |      |          |    |     |
|     |      |          |    |     |
|     |      |          |    |     |

**ATTENTION**  
ELEVATIONS & COORDINATES  
SHOWN ON THIS PLAN  
ARE IN METRES BASED ON  
G.V.R.D. NAD83 DATUM



|  |             |
|--|-------------|
| DIV./BR. TRAFFIC MANAGEMENT<br>T.S. ELECTRICAL |             |
| DATE: 09-05-01                                 | DESIGN: CDM |
| DWG: RA  | CHK: CDM    |
| REFS:  |             |

**ENGINEERING SERVICES**

**BUS/BIKE LANE INSTALLATION  
HASTINGS ST.  
PRINCESS AVE. TO HAWKS AVE.**

|                  |                 |
|------------------|-----------------|
| SCALE:           | NTS             |
| DIRECTORY:       |                 |
| DWG. NO.         |                 |
| SHEET...OF...21. | REVISION...0... |

THIS PRINT SUPERSEDES ALL PRINTS OF THIS DRAWING BEARING PREVIOUS REVISION NUMBERS



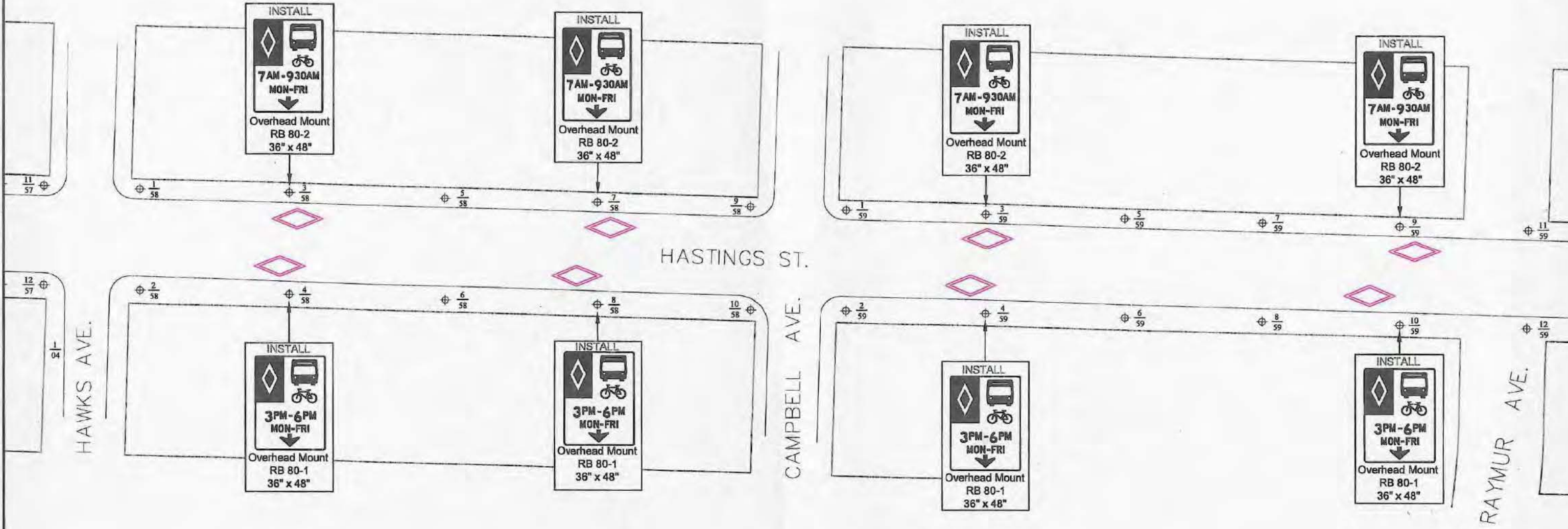

| NO. | DATE | REVISION | BY | CHK |
|-----|------|----------|----|-----|
|     |      |          |    |     |
|     |      |          |    |     |
|     |      |          |    |     |

**ATTENTION**  
 ELEVATIONS & COORDINATES  
 SHOWN ON THIS PLAN  
 ARE IN METRES BASED ON  
 G.V.R.D. NAD83 DATUM



DIV./BR. TRAFFIC MANAGEMENT  
 T.S. ELECTRICAL  
 DATE: 09-05-01 DESIGN: CDM  
 DWG: RA CHK: CDM  
 REFS:

**ENGINEERING SERVICES**  
**BUS/BIKE LANE INSTALLATION**  
**HASTINGS ST.**  
**HAWKS AVE. TO RAYMUR AVE.**

SCALE: NTS  
 DIRECTORY:  
 DWG. NO.  
 SHEET 8 OF 21 REVISION: 0

10/23



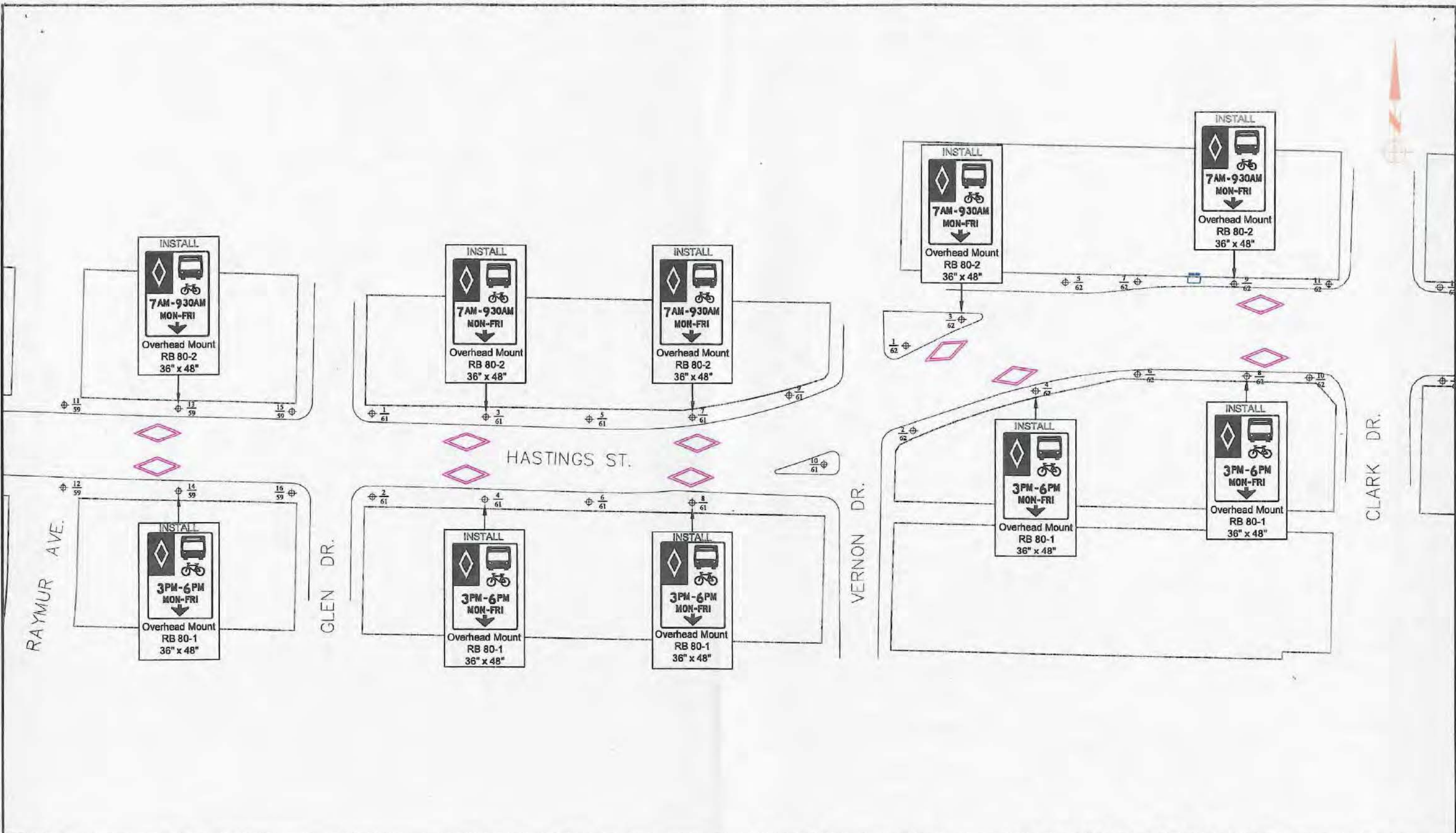

11/23



| NO. | DATE | REVISION | BY | CHK |
|-----|------|----------|----|-----|
|     |      |          |    |     |
|     |      |          |    |     |
|     |      |          |    |     |

**ATTENTION**  
 ELEVATIONS & COORDINATES  
 SHOWN ON THIS PLAN  
 ARE IN METRES BASED ON  
 G.V.R.D. NAD83 DATUM



|  |             |
|--|-------------|
| DIV./BR. TRAFFIC MANAGEMENT<br>T.S. ELECTRICAL |             |
| DATE: 09-01-19                                 | DESIGN: CDM |
| DWG: RA  | CHK: CDM    |
| REFS:  |             |

**ENGINEERING SERVICES**

**BUS/BIKE LANE INSTALLATION**  
 HASTINGS ST.  
 RAYMUIR AVE. TO CLARK DR.

|                |             |
|----------------|-------------|
| SCALE:         | NTS         |
| DIRECTORY:     |             |
| DWG. NO.       |             |
| SHEET: 9 OF 21 | REVISION: 0 |



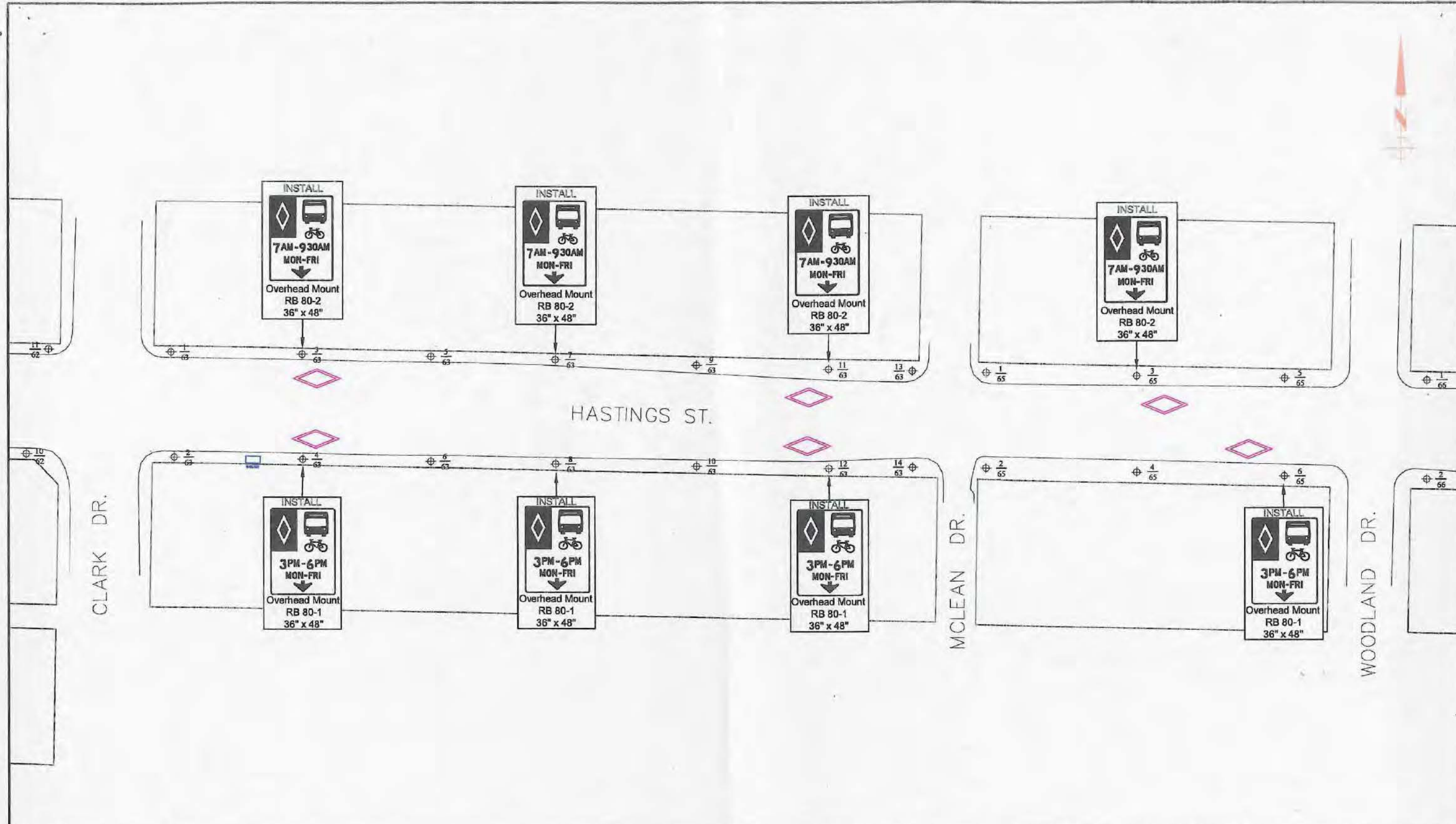

| NO. | DATE | REVISION | BY | CHK |
|-----|------|----------|----|-----|
|     |      |          |    |     |
|     |      |          |    |     |
|     |      |          |    |     |

**ATTENTION**  
ELEVATIONS & COORDINATES  
SHOWN ON THIS PLAN  
ARE IN METRES BASED ON  
G.V.R.D. NAD83 DATUM



DIV./BR. TRAFFIC MANAGEMENT  
T.S. ELECTRICAL

DATE: 09-05-01 DESIGN: CDM

DWG: RA CHK: CDM

REFS:

**ENGINEERING SERVICES**

**BUS/BIKE LANE INSTALLATION**  
HASTING ST.  
CLARK DR. TO WOODLAND DR.

SCALE: NTS

DIRECTORY:

DWG. NO.

SHEET 10 OF 21 REVISION: 0...

12/23



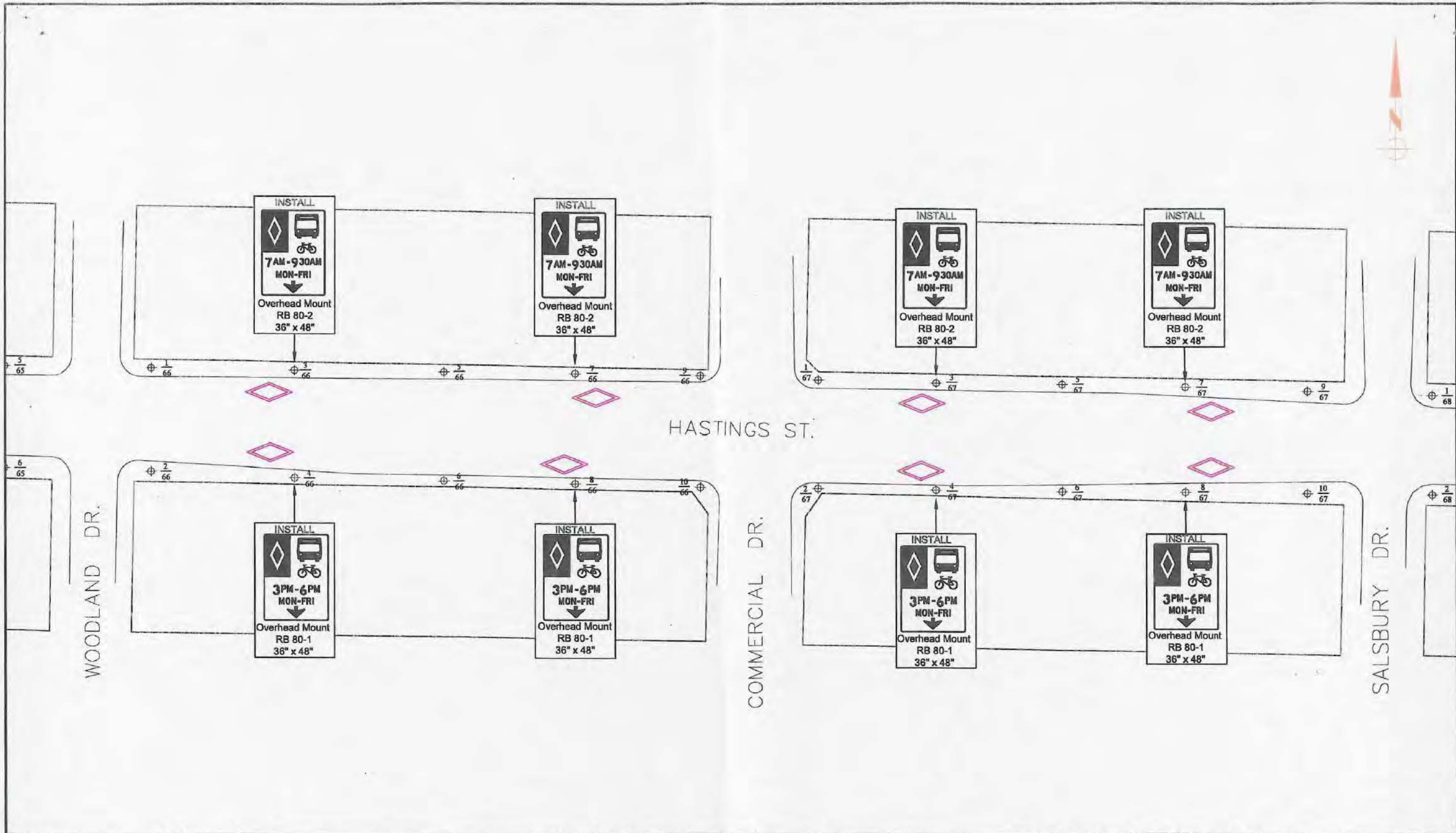

| NO. | DATE | REVISION | BY | CHK |
|-----|------|----------|----|-----|
|     |      |          |    |     |
|     |      |          |    |     |
|     |      |          |    |     |

**ATTENTION**  
 ELEVATIONS & COORDINATES  
 SHOWN ON THIS PLAN  
 ARE IN METRES BASED ON  
 G.V.R.D. NAD83 DATUM



|  |             |
|--|-------------|
| DIV./BR. TRAFFIC MANAGEMENT<br>T.S. ELECTRICAL |             |
| DATE: 09-05-01                                 | DESIGN: CDM |
| DWG: RA  | CHK: CDM    |
| REFS:  |             |

**ENGINEERING SERVICES**  
**BUS/BIKE LANE INSTALLATION**  
**HASTINGS ST.**  
**WOODLAND DR. TO SALISBURY DR.**

|                |             |
|----------------|-------------|
| SCALE:         | NTS         |
| DIRECTORY:     |             |
| DWG. NO.       |             |
| SHEET 11 OF 21 | REVISION: 0 |

THIS PRINT SUPERSEDES ALL PRINTS OF THIS DRAWING BEARING PREVIOUS REVISION NUMBERS

13123



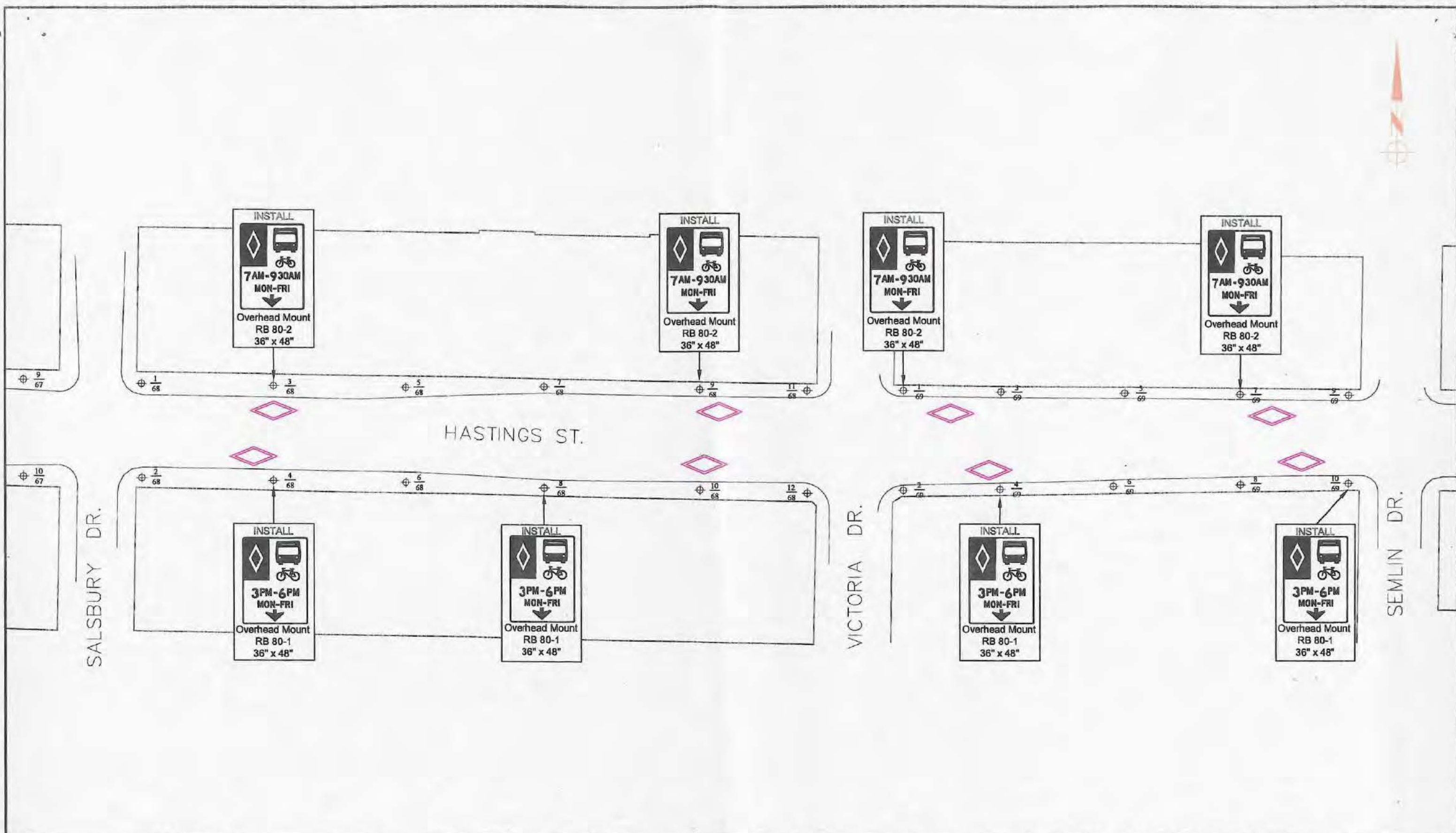

SALSBURY DR.

HASTINGS ST.

VICTORIA DR.

SEMLIN DR.

INSTALL  
  
 7AM-9:30AM  
 MON-FRI  
 ↓  
 Overhead Mount  
 RB 80-2  
 36" x 48"

INSTALL  
  
 7AM-9:30AM  
 MON-FRI  
 ↓  
 Overhead Mount  
 RB 80-2  
 36" x 48"

INSTALL  
  
 7AM-9:30AM  
 MON-FRI  
 ↓  
 Overhead Mount  
 RB 80-2  
 36" x 48"

INSTALL  
  
 7AM-9:30AM  
 MON-FRI  
 ↓  
 Overhead Mount  
 RB 80-2  
 36" x 48"

INSTALL  
  
 3PM-6PM  
 MON-FRI  
 ↓  
 Overhead Mount  
 RB 80-1  
 36" x 48"

INSTALL  
  
 3PM-6PM  
 MON-FRI  
 ↓  
 Overhead Mount  
 RB 80-1  
 36" x 48"

INSTALL  
  
 3PM-6PM  
 MON-FRI  
 ↓  
 Overhead Mount  
 RB 80-1  
 36" x 48"

INSTALL  
  
 3PM-6PM  
 MON-FRI  
 ↓  
 Overhead Mount  
 RB 80-1  
 36" x 48"

14123



| NO. | DATE | REVISION | BY | CHK |
|-----|------|----------|----|-----|
|     |      |          |    |     |
|     |      |          |    |     |
|     |      |          |    |     |

**ATTENTION**  
 ELEVATIONS & COORDINATES  
 SHOWN ON THIS PLAN  
 ARE IN METRES BASED ON  
 G.V.R.D. NAD83 DATUM



DIV./BR. TRAFFIC MANAGEMENT  
 T.S. ELECTRICAL  
 DATE: 09-05-01 DESIGN: CDM  
 DWG: RA CHK: CDM  
 REFS:

**ENGINEERING SERVICES**

**BUS/BIKE LANE INSTALLATION**  
 HASTINGS ST.  
 SALSBURY DR. TO SEMLIN DR.

SCALE: NTS  
 DIRECTORY:  
 DWG. NO.  
 SHEET 12 OF 21 REVISION: 0...



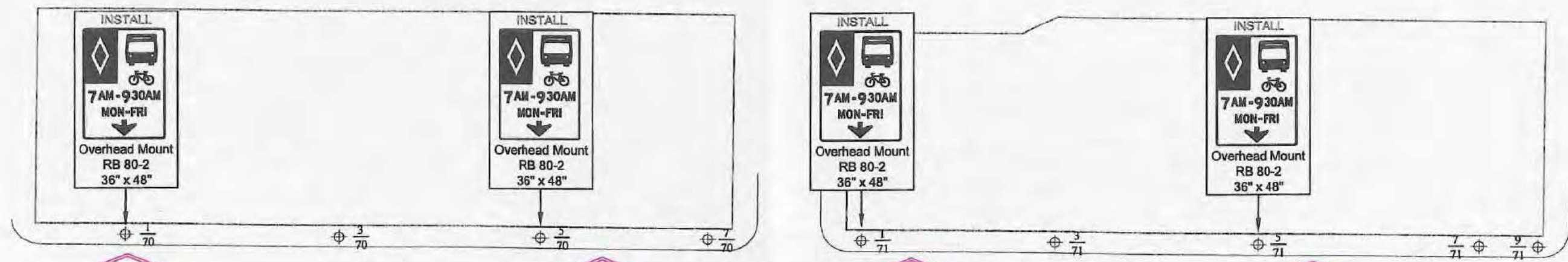

HASTINGS ST.

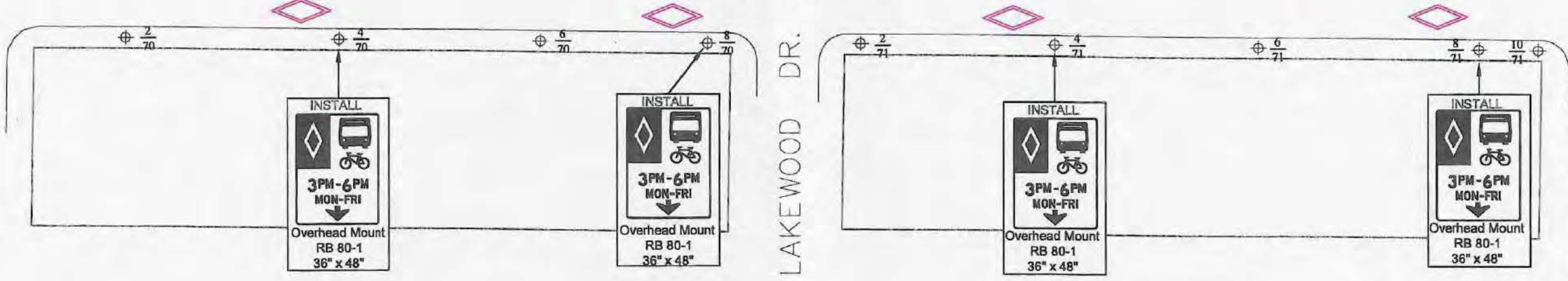

SEMLIN DR.

LAKWOOD DR.

TEMPLETON DR.

15123



| NO. | DATE | REVISION | BY | CHK |
|-----|------|----------|----|-----|
|     |      |          |    |     |
|     |      |          |    |     |
|     |      |          |    |     |

**ATTENTION**  
ELEVATIONS & COORDINATES  
SHOWN ON THIS PLAN  
ARE IN METRES BASED ON  
G.V.R.D. NAD83 DATUM

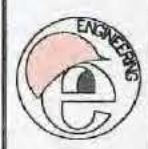

|  |             |
|--|-------------|
| DIV./BR. TRAFFIC MANAGEMENT<br>T.S. ELECTRICAL |             |
| DATE: 09-05-01                                 | DESIGN: CDM |
| DWG: RA  | CHK: CDM    |
| REFS:  |             |

**ENGINEERING SERVICES**

**BUS/BIKE LANE INSTALLATION  
HASTINGS ST.  
SEMLIN DR. TO TEMPLETON DR.**

|                |                |
|----------------|----------------|
| SCALE:         | NTS            |
| DIRECTORY:     |                |
| DWG. NO.       |                |
| SHEET 13 OF 21 | REVISION: 0... |

THIS PRINT SUPERSEDES ALL PRINTS OF THIS DRAWING BEARING PREVIOUS REVISION NUMBERS



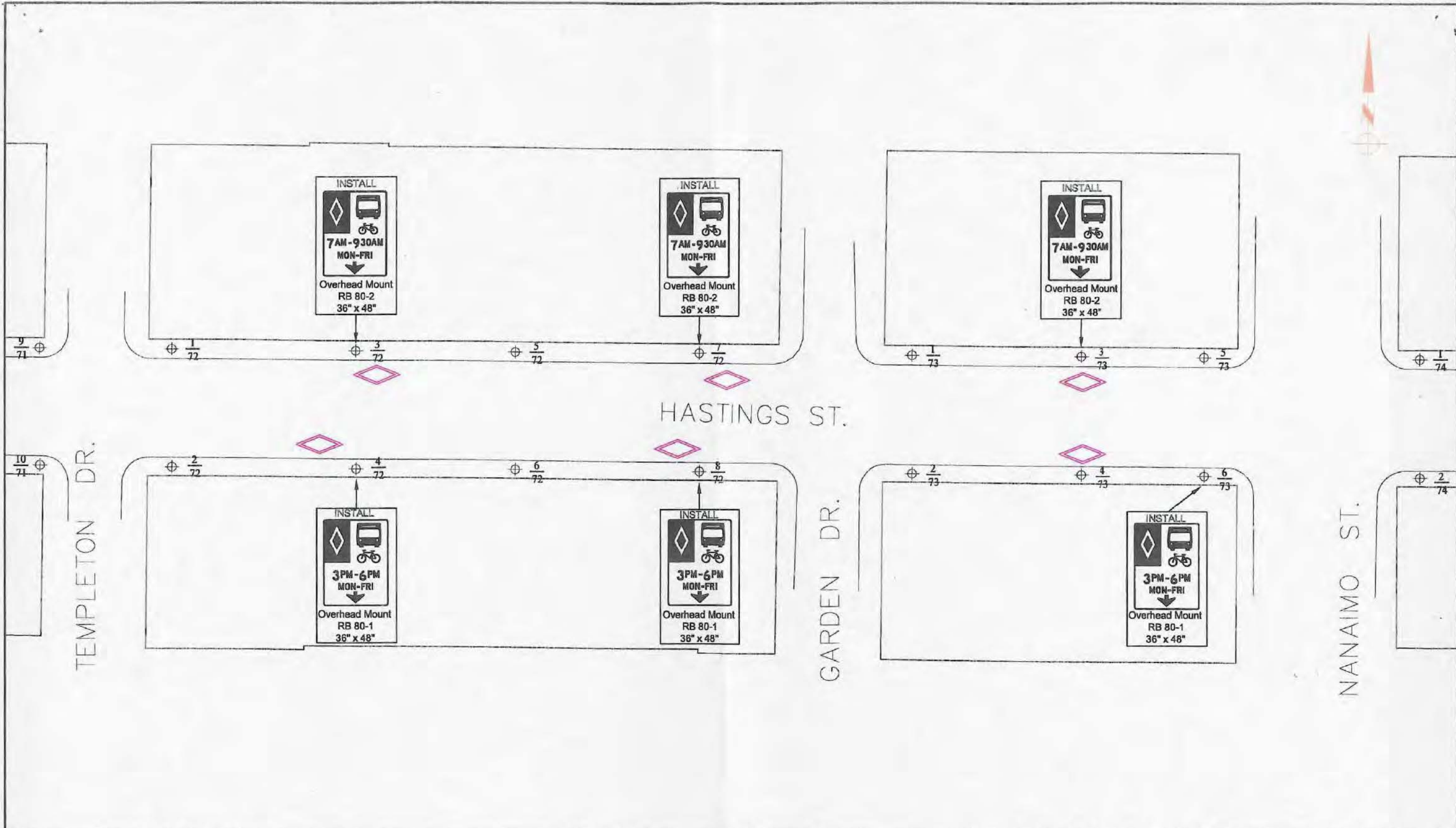

| NO. | DATE | REVISION | BY | CHK |
|-----|------|----------|----|-----|
| 1   |      |          |    |     |

**ATTENTION**  
 ELEVATIONS & COORDINATES  
 SHOWN ON THIS PLAN  
 ARE IN METRES BASED ON  
 G.V.R.D. NAD83 DATUM



|  |             |
|--|-------------|
| DIV./BR. TRAFFIC MANAGEMENT<br>T.S. ELECTRICAL |             |
| DATE: 09-05-01                                 | DESIGN: CDM |
| DWG: RA  | CHK: CDM    |
| REFS:  |             |

**ENGINEERING SERVICES**

**BUS/BIKE LANE INSTALLATION  
 HASTINGS ST.  
 TEMPLETON DR. TO NANAIMO ST.**

|                |             |
|----------------|-------------|
| SCALE:         | NTS         |
| DIRECTORY:     |             |
| DWG. NO.       |             |
| SHEET 14 OF 21 | REVISION: 0 |

16/23



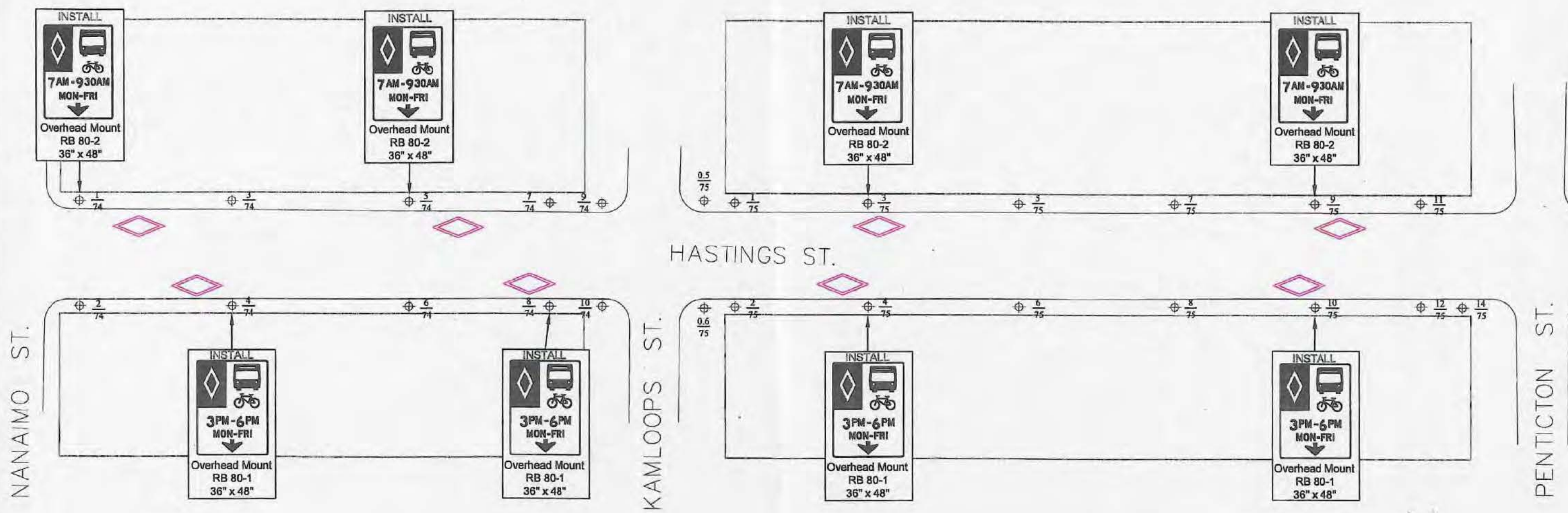

| NO. | DATE | REVISION | BY | CHK |
|-----|------|----------|----|-----|
|     |      |          |    |     |
|     |      |          |    |     |
|     |      |          |    |     |

**ATTENTION**  
ELEVATIONS & COORDINATES  
SHOWN ON THIS PLAN  
ARE IN METRES BASED ON  
G.V.R.D. NAD83 DATUM

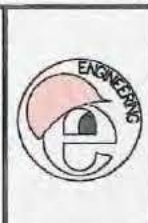

|  |             |
|--|-------------|
| DIV./BR. TRAFFIC MANAGEMENT<br>T.S. ELECTRICAL |             |
| DATE: 09-05-01                                 | DESIGN: CDM |
| DWG: RA  | CHK: CDM    |
| REFS:  |             |

**ENGINEERING SERVICES**  
**BUS/BIKE LANE INSTALLATION**  
**HASTINGS ST.**  
**NANAIMO ST. TO PENTICTON ST.**

|                |             |
|----------------|-------------|
| SCALE:         | NTS         |
| DIRECTORY:     |             |
| DWG. NO.       |             |
| SHEET 15 OF 21 | REVISION: 0 |

17/23



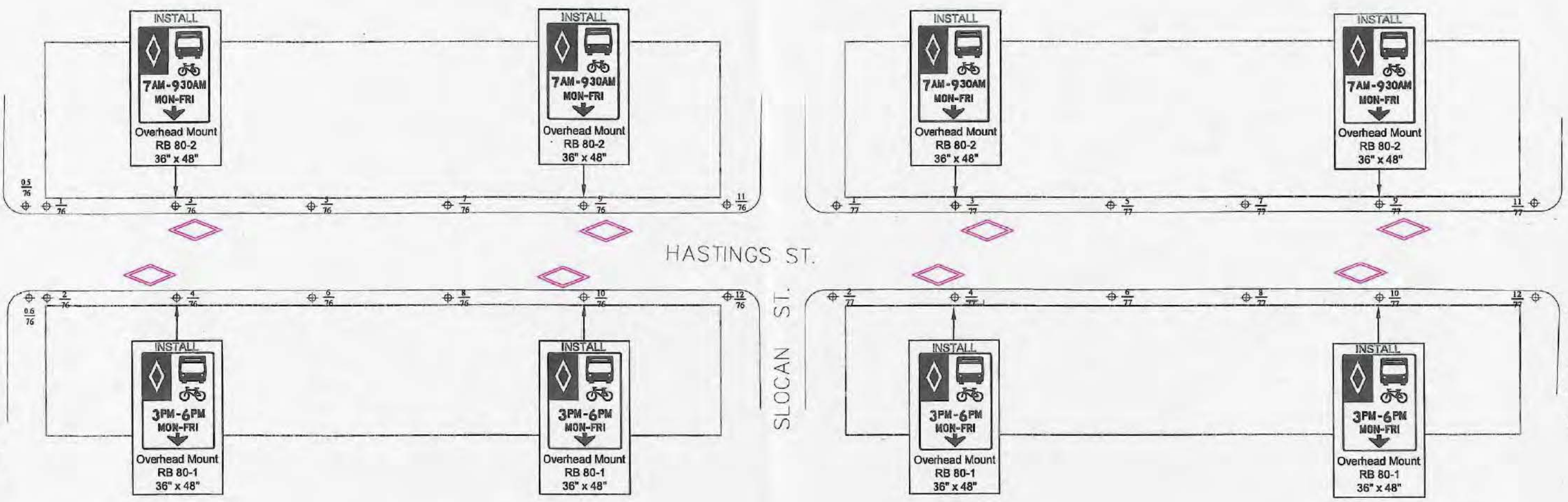

HASTINGS ST.

PENTICTON ST.

SLOCAN ST.

KASLO ST.



| NO. | DATE | REVISION | BY | CHK |
|-----|------|----------|----|-----|
|     |      |          |    |     |
|     |      |          |    |     |
|     |      |          |    |     |

**ATTENTION**  
ELEVATIONS & COORDINATES  
SHOWN ON THIS PLAN  
ARE IN METRES BASED ON  
G.V.R.D. NAD83 DATUM



|  |             |
|--|-------------|
| DIV./BR. TRAFFIC MANAGEMENT<br>T.S. ELECTRICAL |             |
| DATE: 09-05-01                                 | DESIGN: CDM |
| DWG: RA  | CHK: CDM    |
| REFS:  |             |

**ENGINEERING SERVICES**  
**BUS/BIKE LANE INSTALLATION**  
**HASTINGS ST.**  
**PENTICTON ST. TO KASLO ST.**

|                |             |
|----------------|-------------|
| SCALE:         | NTS         |
| DIRECTORY:     |             |
| DWG. NO.       |             |
| SHEET 15 OF 21 | REVISION: 0 |

18/23



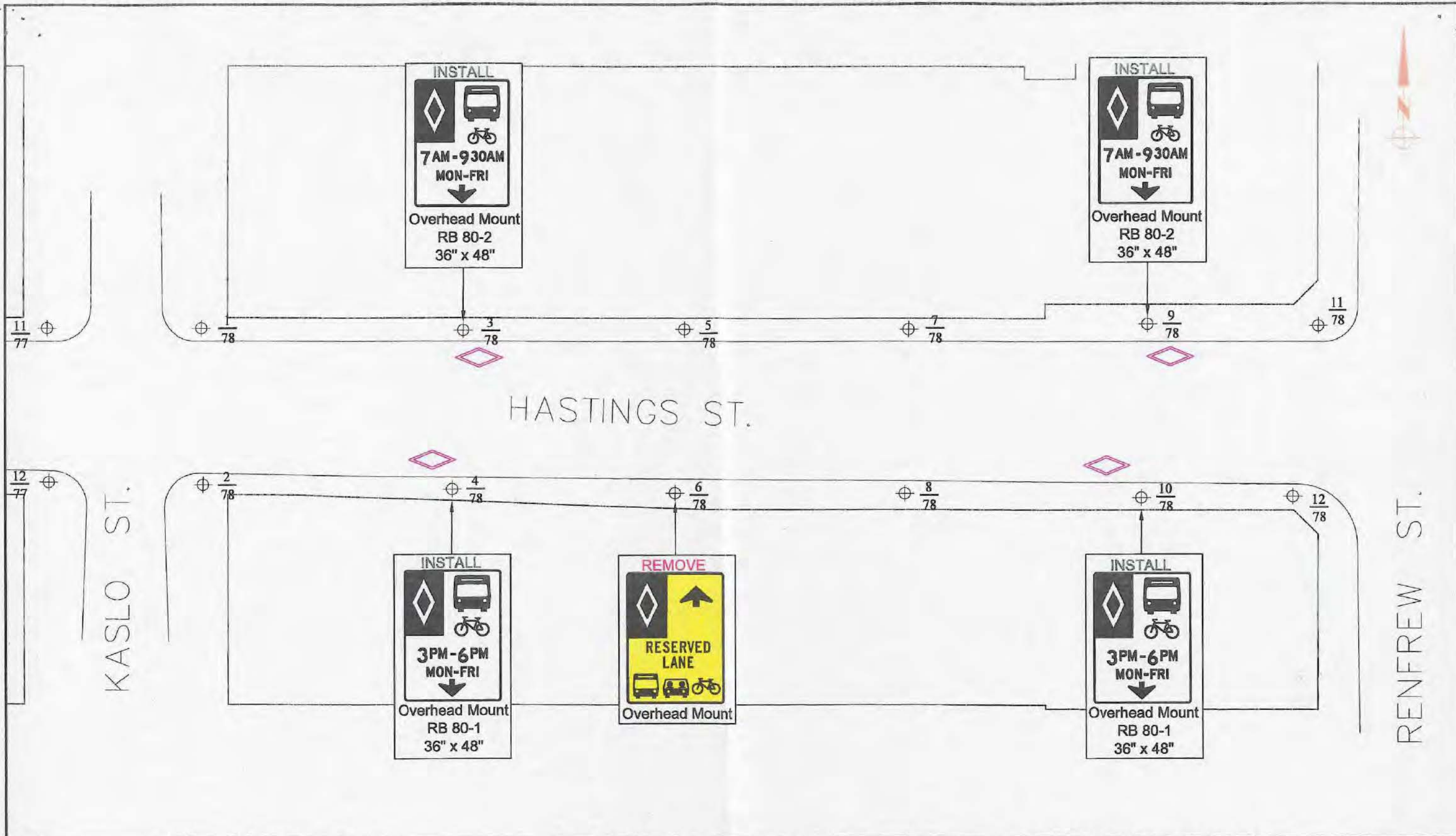

19/23



| NO. | DATE | REVISION | BY | CHK |
|-----|------|----------|----|-----|
| 21  |      |          |    |     |

**ATTENTION**  
 ELEVATIONS & COORDINATES  
 SHOWN ON THIS PLAN  
 ARE IN METRES BASED ON  
 G.V.R.D. NAD83 DATUM



|  |             |
|--|-------------|
| DIV./BR. TRAFFIC MANAGEMENT<br>T.S. ELECTRICAL |             |
| DATE: 09-05-01                                 | DESIGN: CDM |
| DWG: RA  | CHK: CDM    |
| REFS:  |             |

**ENGINEERING SERVICES**

**BUS/BIKE LANE INSTALLATION**  
**HASTINGS ST.**  
**KASLO ST. TO RENFREW ST.**

|                |             |
|----------------|-------------|
| SCALE:         | NTS         |
| DIRECTORY:     |             |
| DWG. NO.       |             |
| SHEET 17 OF 21 | REVISION: 0 |





RENFREW ST.

LILLOOET ST.

HASTINGS ST.

**INSTALL**



7 AM - 9:30 AM  
MON-FRI

Overhead Mount  
RB 80-2  
36" x 48"

**INSTALL**



7 AM - 9:30 AM  
MON-FRI

Overhead Mount  
RB 80-2  
36" x 48"

**REMOVE**



6 AM - 8:30 AM  
MON-FRI  
ENDS 100m

**INSTALL**



7 AM - 9:30 AM  
MON-FRI

Overhead Mount  
RB 80-2  
36" x 48"

**REMOVE**



6 AM - 8:30 AM  
MON-FRI

**INSTALL**



7 AM - 9:30 AM  
MON-FRI

Overhead Mount  
RB 80-2  
36" x 48"

**REMOVE**



6 AM - 8:30 AM  
MON-FRI

EXISTING

EXISTING

EXISTING

EXISTING

EXISTING

EXISTING

**INSTALL**



3 PM - 6 PM  
MON-FRI

Overhead Mount  
RB 80-1  
36" x 48"

**REMOVE**



3:30 PM - 6 PM  
MON-FRI

**REMOVE**



2 PERSONS  
MINIMUM

MOTORCYCLES OK

Side-Mount

**INSTALL**



3 PM - 6 PM  
MON-FRI

Overhead Mount  
RB 80-1  
36" x 48"

**REMOVE**



3:30 PM - 6 PM  
MON-FRI

**INSTALL**



3 PM - 6 PM  
MON-FRI

Overhead Mount  
RB 80-1  
36" x 48"

**REMOVE**



3:30 PM - 6 PM  
MON-FRI

**INSTALL**



3 PM - 6 PM  
MON-FRI

Overhead Mount  
RB 80-1  
36" x 48"

**REMOVE**



3:30 PM - 6 PM  
MON-FRI



| NO. | DATE | REVISION | BY | CHK |
|-----|------|----------|----|-----|
|     |      |          |    |     |
|     |      |          |    |     |
|     |      |          |    |     |
|     |      |          |    |     |

**ATTENTION**  
ELEVATIONS & COORDINATES  
SHOWN ON THIS PLAN  
ARE IN METRES BASED ON  
G.V.R.D. NAD83 DATUM



DIV./BR. TRAFFIC MANAGEMENT  
T.S. ELECTRICAL

DATE: 09-05-01 DESIGN:

DWG: MM CHK:

REFS:

**ENGINEERING SERVICES**

**BUS/BIKE LANE INSTALLATION**  
HASTINGS ST.  
RENFREW ST. TO LILLOOET ST.

SCALE: NTS

DIRECTORY:

DWG. NO.

SHEET 18 OF 21 REVISION: 0...

20/23



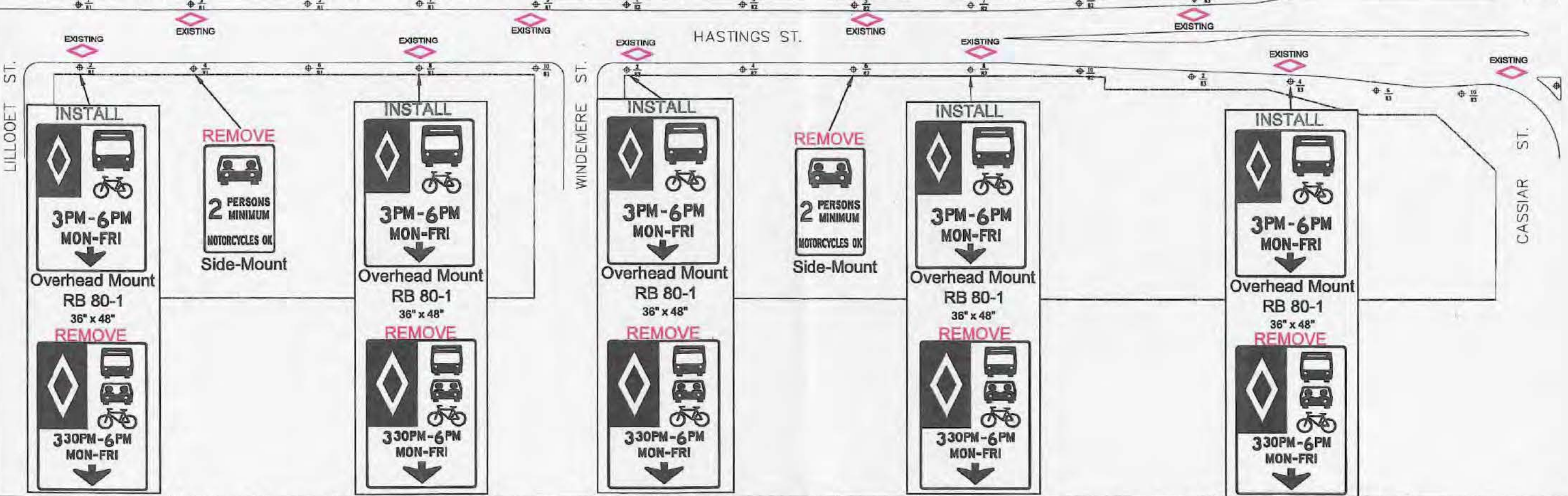
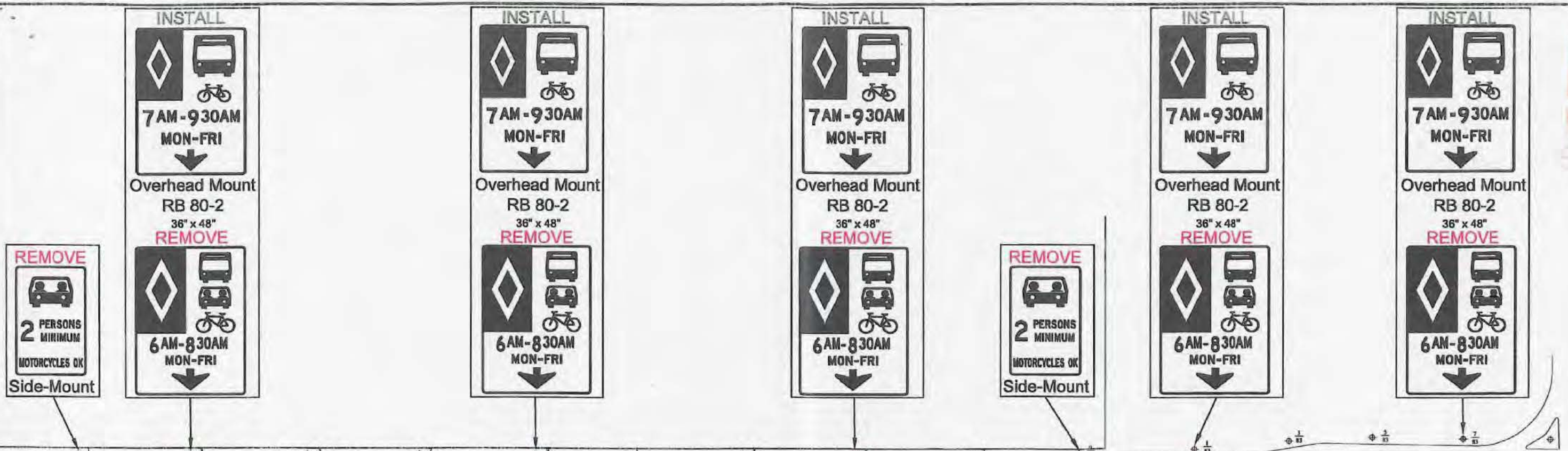

| NO. | DATE | REVISION | BY | CHK |
|-----|------|----------|----|-----|
| 21  |      |          |    |     |

**ATTENTION**  
ELEVATIONS & COORDINATES  
SHOWN ON THIS PLAN  
ARE IN METRES BASED ON  
G.V.R.D. NAD83 DATUM

|                             |         |
|-----------------------------|---------|
| DIV./BR. TRAFFIC MANAGEMENT |         |
| DATE: 09-05-01              | DESIGN: |
| DWG: MM                     | CHK:    |
| REFS:                       |         |

**ENGINEERING SERVICES**  
**BUS/BIKE LANE INSTALLATION**  
**HASTINGS ST.**  
**LILLOOET ST. TO CASSIAR ST.**

|                |                |
|----------------|----------------|
| SCALE:         | NTS            |
| DIRECTORY:     |                |
| DWG. NO.       |                |
| SHEET 19 OF 21 | REVISION: 0... |

21/23



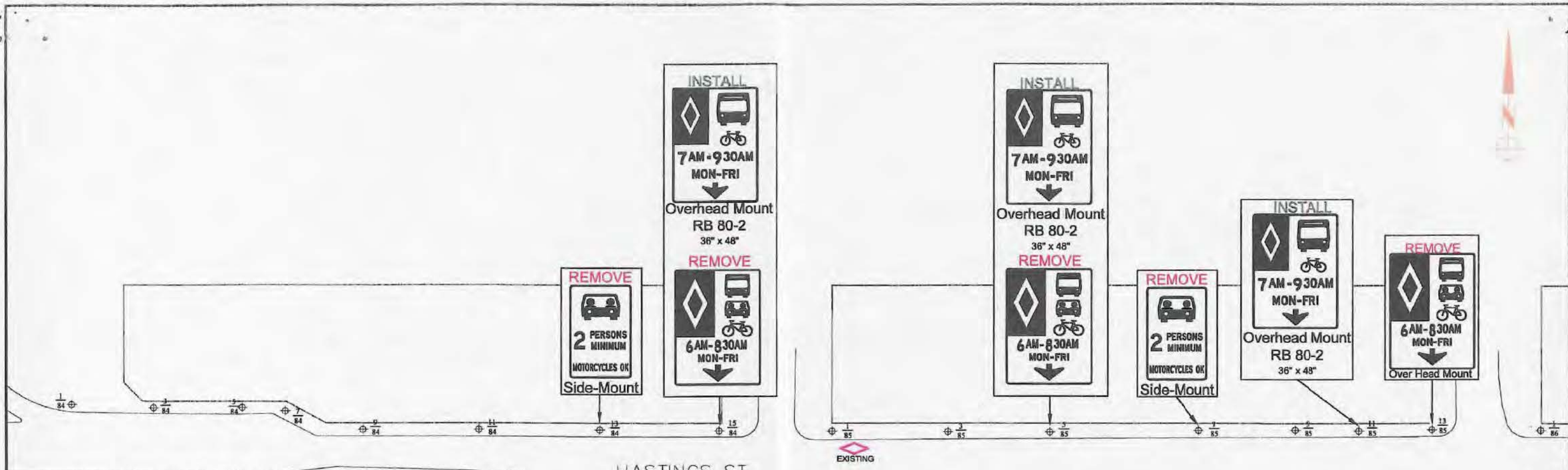

HASTINGS ST.

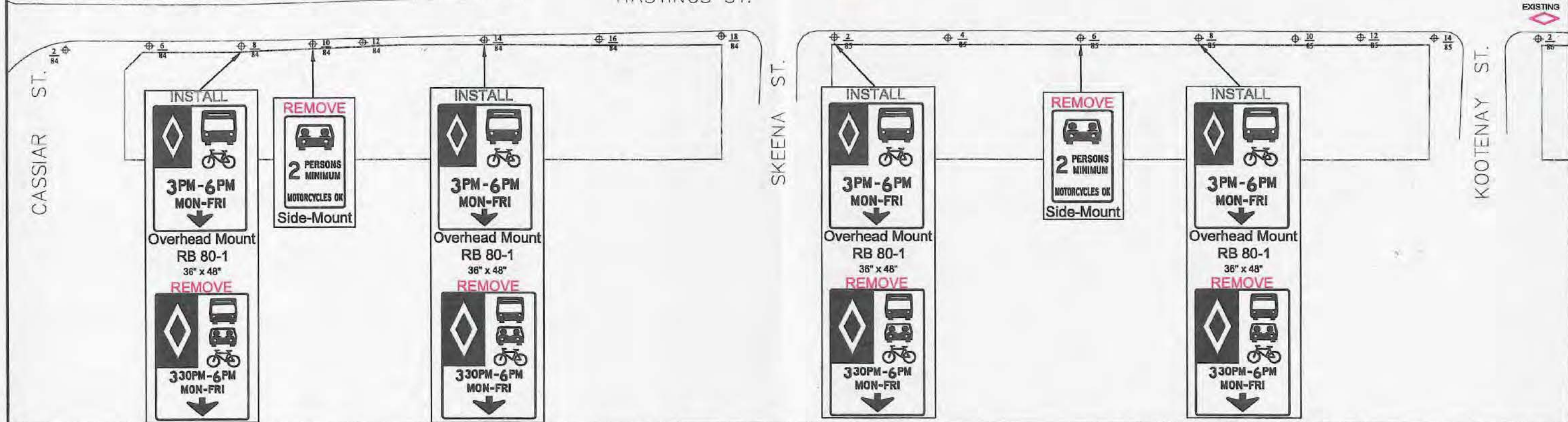

CASSIAR ST.

SKEENA ST.

KOOTENAY ST.

22/23



| NO. | DATE | REVISION | BY | CHK |
|-----|------|----------|----|-----|
| 21  |      |          |    |     |

**ATTENTION**  
ELEVATIONS & COORDINATES  
SHOWN ON THIS PLAN  
ARE IN METRES BASED ON  
G.V.R.D. NAD83 DATUM



|                             |         |
|-----------------------------|---------|
| DIV./BR. TRAFFIC MANAGEMENT |         |
| DATE: 09-05-01              | DESIGN: |
| DWG: MM                     | CHK:    |
| REFS:                       |         |

**ENGINEERING SERVICES**

**BUS/BIKE LANE INSTALLATION  
HASTINGS ST.  
CASSIAR ST. TO KOOTENAY**

|                |                |
|----------------|----------------|
| SCALE:         | NTS            |
| DIRECTORY:     |                |
| DWG. NO.       |                |
| SHEET 20 OF 21 | REVISION: 0... |

THIS PRINT SUPERSEDES ALL PRINTS OF THIS DRAWING BEARING PREVIOUS REVISION NUMBERS



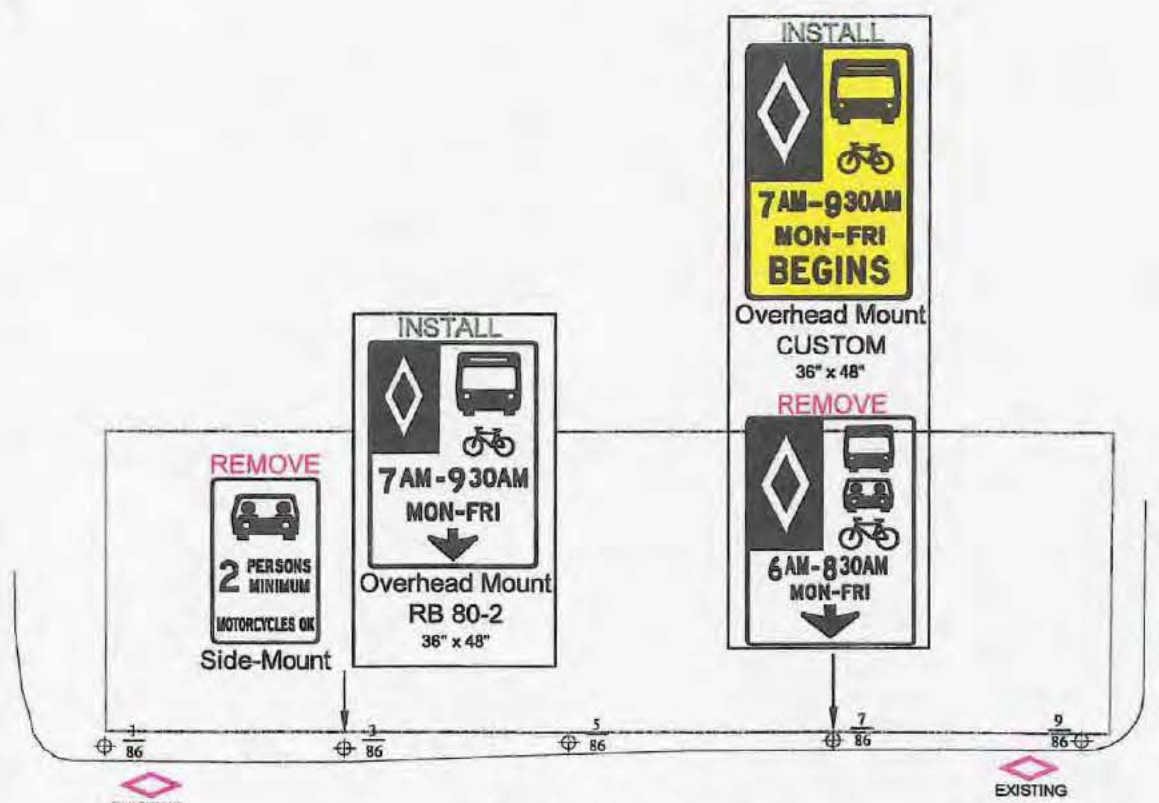

HASTINGS ST.

KOOTENAY ST.

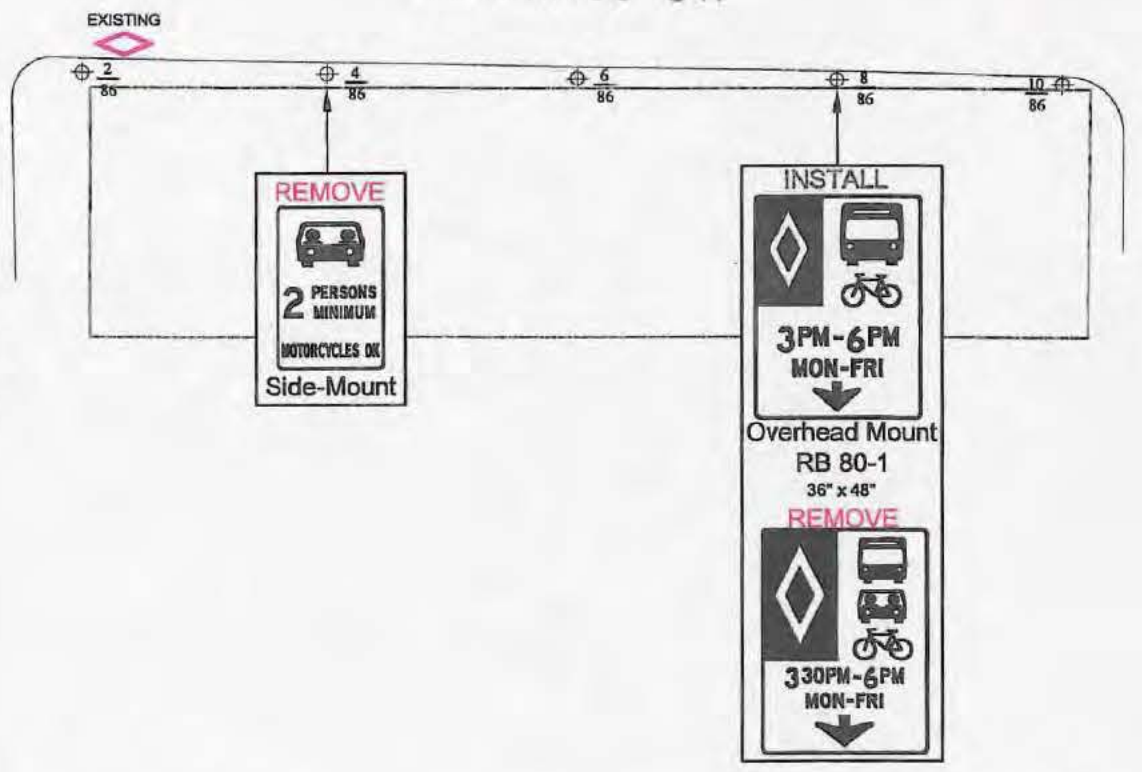

BOUNDARY RD.

23123



| NO. | DATE | REVISION | BY | CHK |
|-----|------|----------|----|-----|
|     |      |          |    |     |
|     |      |          |    |     |
|     |      |          |    |     |

**ATTENTION**  
ELEVATIONS & COORDINATES  
SHOWN ON THIS PLAN  
ARE IN METRES BASED ON  
G.V.R.D. NAD83 DATUM



|  |             |
|--|-------------|
| DIV./BR. TRAFFIC MANAGEMENT<br>T.S. ELECTRICAL |             |
| DATE: 09-01-19                                 | DESIGN: CDM |
| DWG: RA  | CHK: CDM    |
| REFS:  |             |

**ENGINEERING SERVICES**  
**BUS/BIKE LANE INSTALLATION**  
**HASTINGS ST.**  
**KOOTENAY ST. TO BOUNDARY RD.**

|                 |             |
|-----------------|-------------|
| SCALE:          | NTS         |
| DIRECTORY:      |             |
| DWG. NO.        |             |
| SHEET: 21 OF 21 | REVISION: 0 |

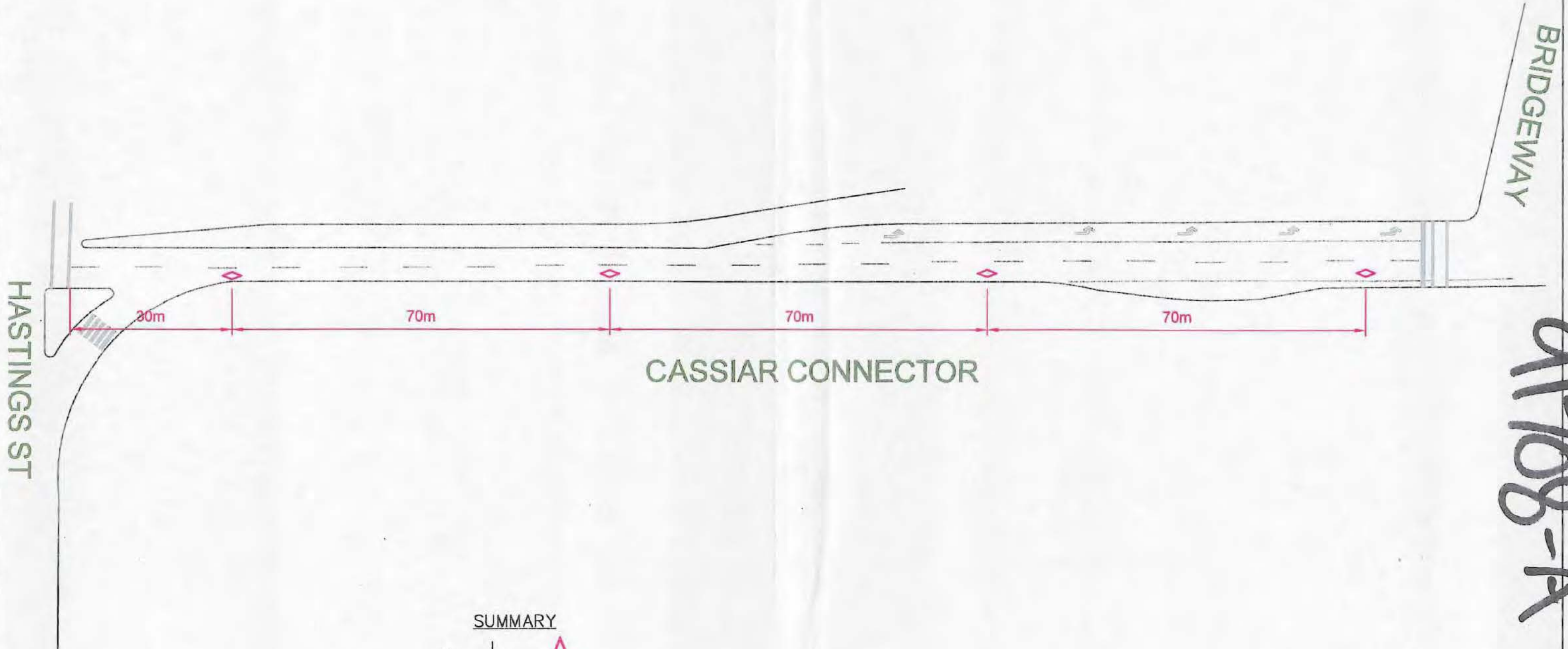

HASTINGS ST

BRIDGEWAY

CASSIAR CONNECTOR

01708-A

SUMMARY

|   |              |
|---|--------------|
| 4 | ◇            |
|   | HOV DIAMONDS |
|   |              |
|   |              |
|   |              |

10035158

|         |  |
|---------|--|
| SCALE:  | NOT TO SCALE   |
| DATE:   | SEPTEMBER 4, 2009                                    |
| DESIGN: | GGN  |
| DWG:    | GGN City of Vancouver - FOI 2024-633 - Page 28 of 28 |