

# FALL 2021 CP UPDATE SEMINAR

City of Vancouver  
Addressing Updates

---

**Gurv Brar**

**Manager, DBL Support Services**

[gurv.brar@vancouver.ca](mailto:gurv.brar@vancouver.ca)

NOVEMBER 4, 2021

VIA ZOOM



ARCHITECTURAL  
INSTITUTE OF  
BRITISH COLUMBIA



ENGINEERS &  
GEOSCIENTISTS  
BRITISH COLUMBIA

# Building & Address Assignment Bulletin

---

## > Goal:

- Help applicants successfully navigate through the address review process
- Communicate addressing policy and guidelines

## > How:

- We have provided detailed requirements for drawings
- Outlined general address assignment principals
- Provided guidance for different building types with accompanying illustrations

## > Purpose of today's presentation:

- Highlight key requirements and changes
- Provide an opportunity for questions and feedback

# Drawing Requirements

---

1. Clearly identify the primary building entrance, and each primary unit entrance, with direct street access (e.g. walkway); from the street to the primary entrance.
2. Highlight the location of the principal fire department response, including the annunciator panel where present.
3. Building numbers and suite numbers clearly indicated within the unit at the unit entrance on the floor plan.
  - Only numeric numbering is acceptable (e.g. Unit 101).
  - Alphabetical designations (e.g. Unit A) or a combination of Alpha Numeric numbering (e.g. Unit 1A) is not permitted.
4. For each additional entrance to “SHELL” space, clearly indicate all future Building numbers and suite numbers labelled “Future” within the future unit on the floor plan.
5. Provide a site plan with all streets and lanes adjacent to the building and the north cardinal direction clearly identified, as well as the underground parking levels, all Building levels and roof plan.
6. Building uses including amenity spaces in a mixed use building to be clearly labelled on the floor plans, and matching the “work descriptions” on the Development and Building Permits.

# Residential Tower

## Level 1

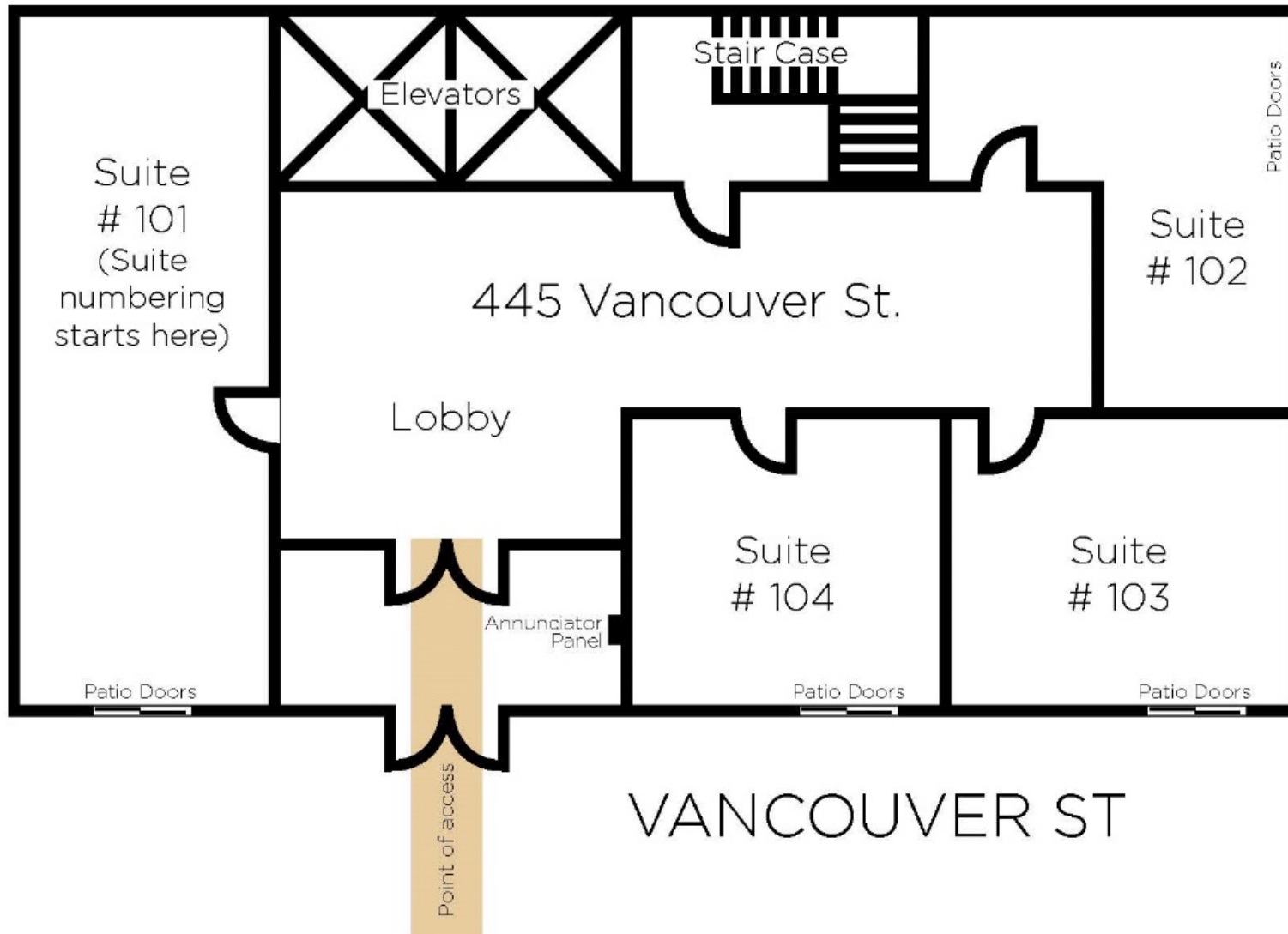

# Address Assignment Principles

---

- > Shifting away from assigning separate civic addresses for townhouse developments.
- > As we continue to see increasing densification and fewer address ranges being available, we are pivoting to a policy of assigning one civic address to a building, and suite numbers to each dwelling unit.

# Addressing Principles & Illustrations

*“Rowhouse type buildings shall be assigned one building number and each dwelling unit forming a part of the building shall be assigned a suite number.”*

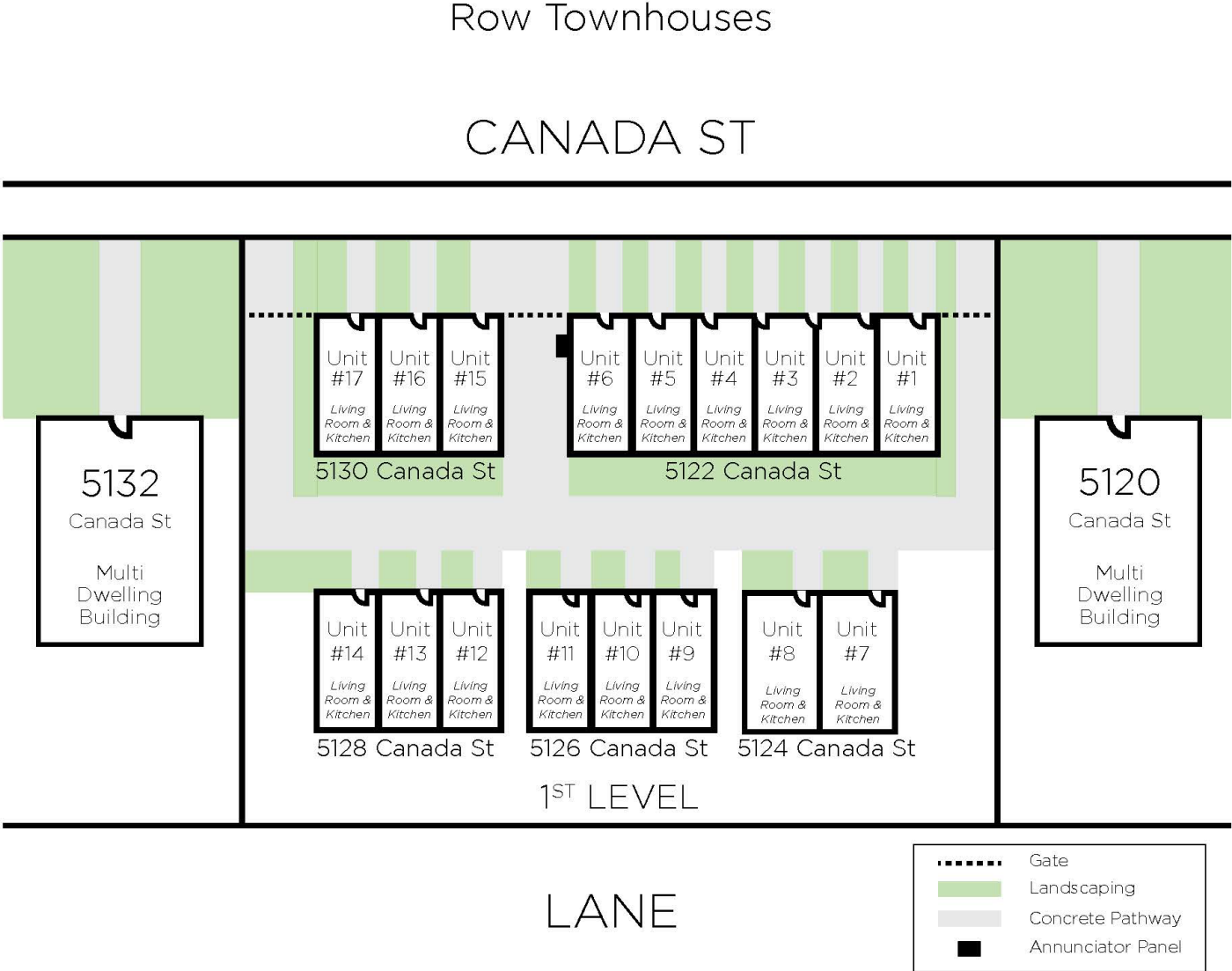

# Next Steps

---

- > Do you have any questions?
  - Please email them to: [gurv.brar@vancouver.ca](mailto:gurv.brar@vancouver.ca)
  - Deadline: November 12<sup>th</sup>