

Welcome

Project Goal

To improve the comfort and safety of the North False Creek Seaside Greenway between Burrard and Granville Bridges for people of all ages and abilities, through the development of an updated signage and pavement marking plan that can be implemented quickly.

Transportation 2040 Policy Directions

1. “...improve older segments of the Seawall to separate users, reduce conflicts and provide an even, comfortable walking and riding surface.”
2. Make majority of trips on foot, bike or transit.
3. Make walking and cycling safe, convenient and comfortable for people of all ages and abilities.

Other Policies Supported

- **Access to Nature** goal area of the Greenest City Action Plan.
- **Active Living and Getting Outside** goal area of the Healthy City Strategy.



View west from Hornby Street

Design Principles

- Maintain continuous walking space next to the water.
- Provide a continuous, low speed cycling experience as close to the water as possible.
- Separate walking and cycling where possible.
- Highlight key pedestrian crossings.
- Reduce vehicle conflicts with people walking and cycling along Seaside Greenway.

There are upwards of 10,000 walking and cycling trips along this section of the Seawall every day.



View south from the west side of marina, people cycling and walking share the seawall between the water and restaurant patios.



View west at Howe St. People walking, cycling and driving share a cul-de-sac.



View southwest from Hornby St, people walking and cycling share space across private property with a large signature tree.

Current Conditions



Planned Improvements

Solution

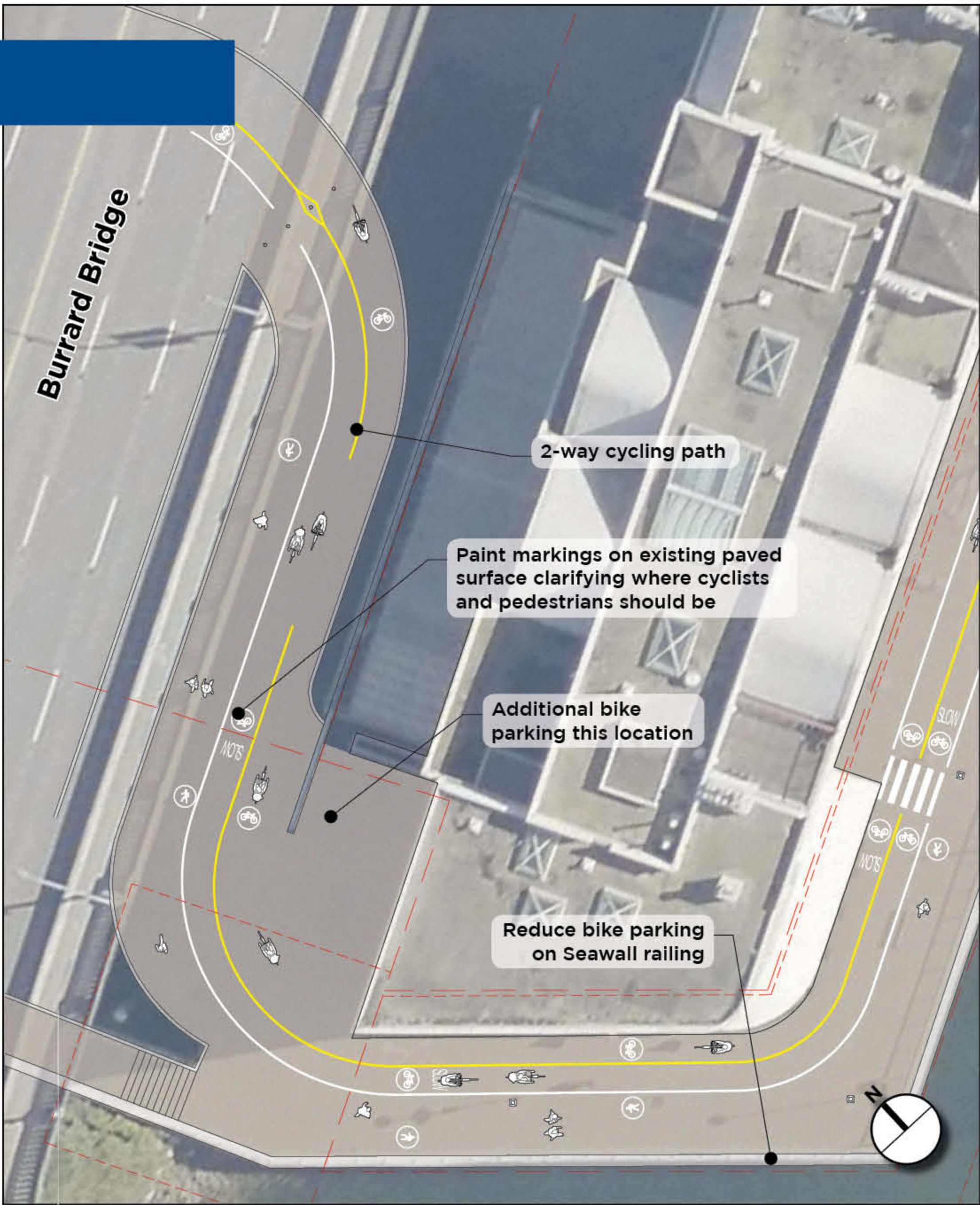

What are the improvements?

- Paint markings that clearly delineate where people walking and people cycling should be in relation to one another. Narrowing the area for people on bikes will also help reduce speed.
- Paint markings and signage to warn people cycling to slow in areas where conflicts with people walking may occur.

Solution

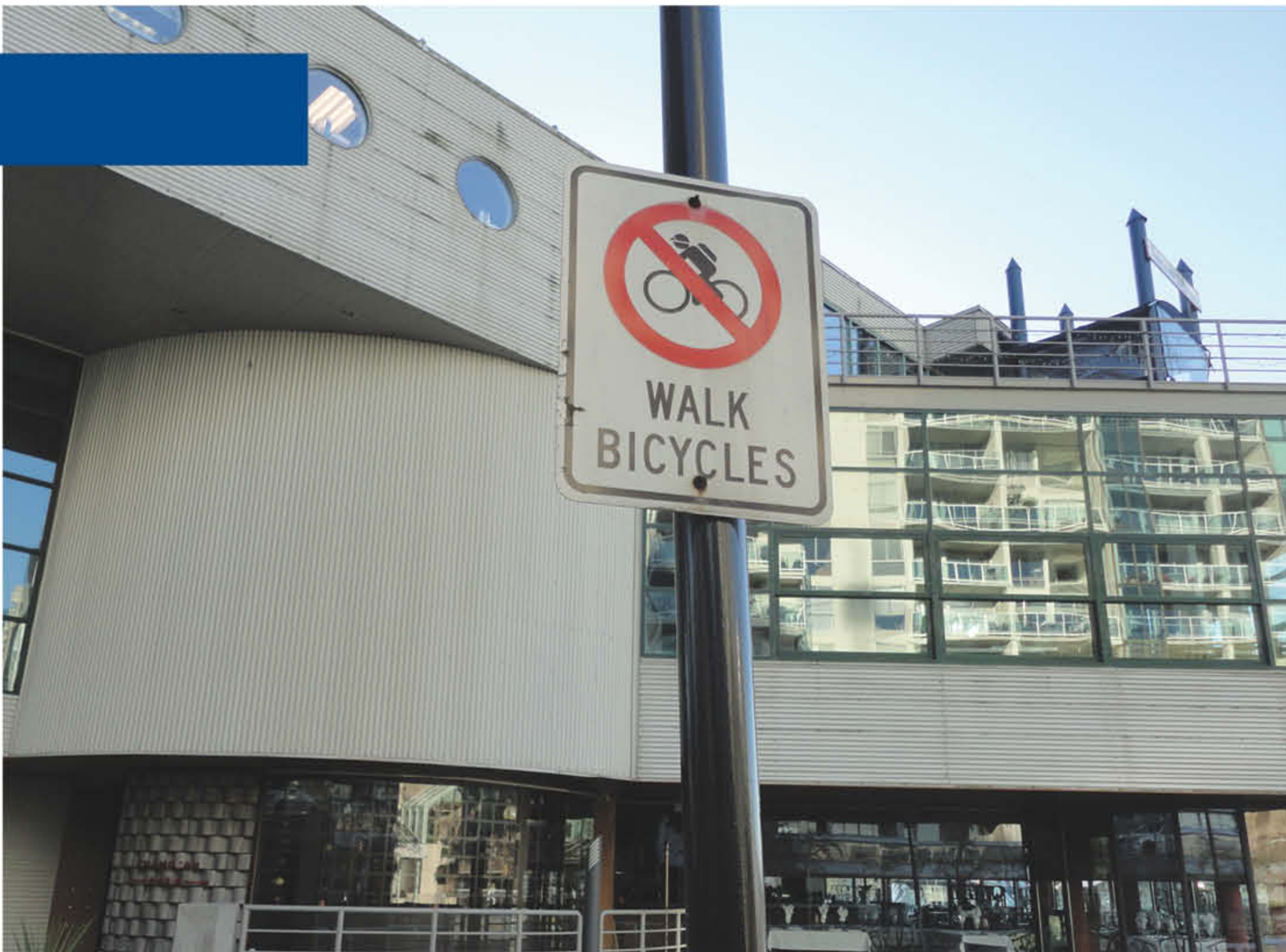

What are the improvements?

- Additional signage to reinforce this part of the Seawall as an area reserved for walking, or people walking with their bicycles.

Location 1

Current Conditions

- Downhill section enables people on bikes to pick up speed going into a tight corner.
- Bike parking on Seawall railings.



Location 2

Current Conditions

- Shared walking and cycling on Seawall path intended for walking only.

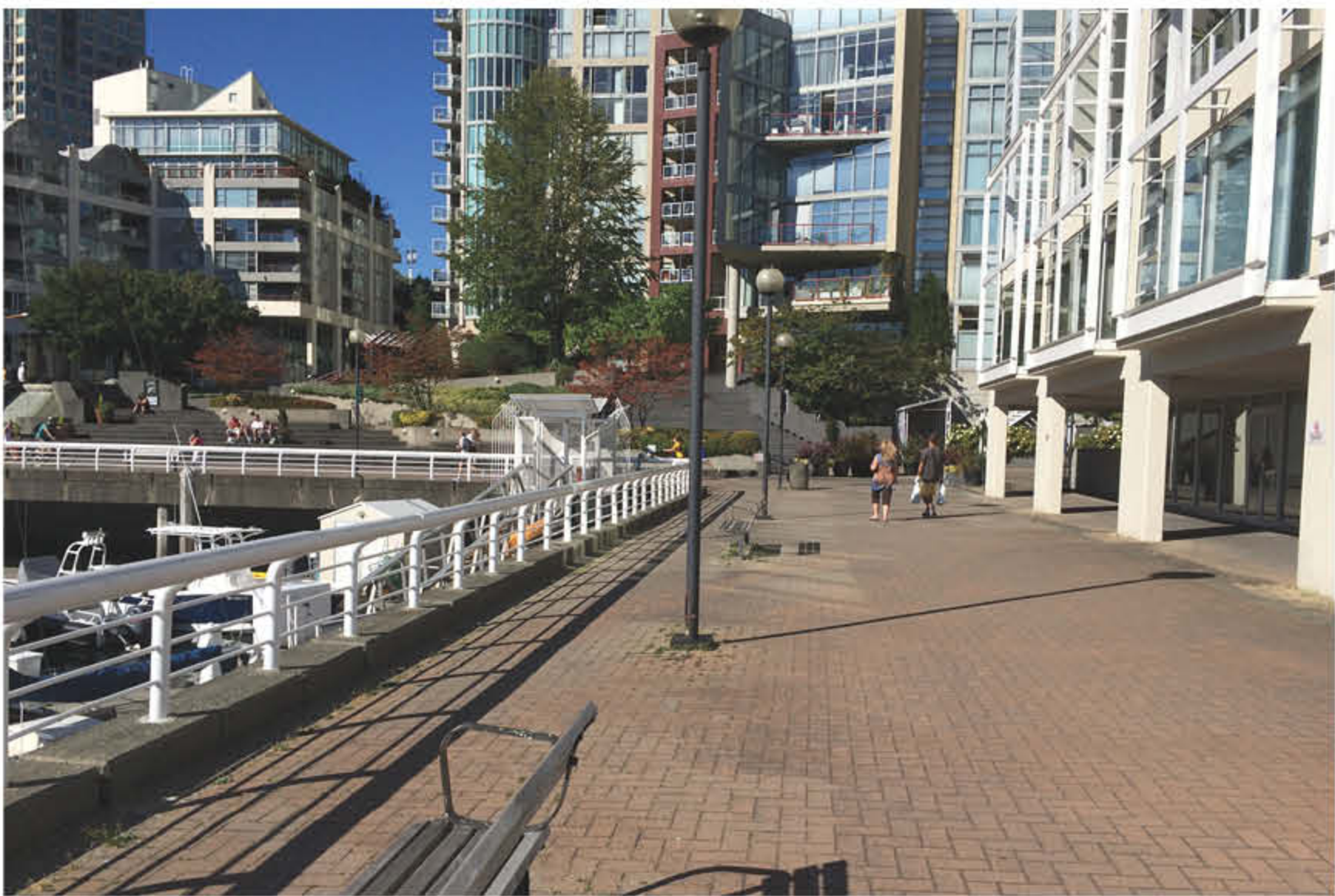

Planned Improvements

Solution



What are the improvements?

- Paint markings that clearly delineate where people walking and people cycling should be in relation to one another. Narrowing the area for people on bikes will also help reduce speed.
- Paint markings and signage to warn people cycling to slow in areas where conflict with people walking may occur.

Solution

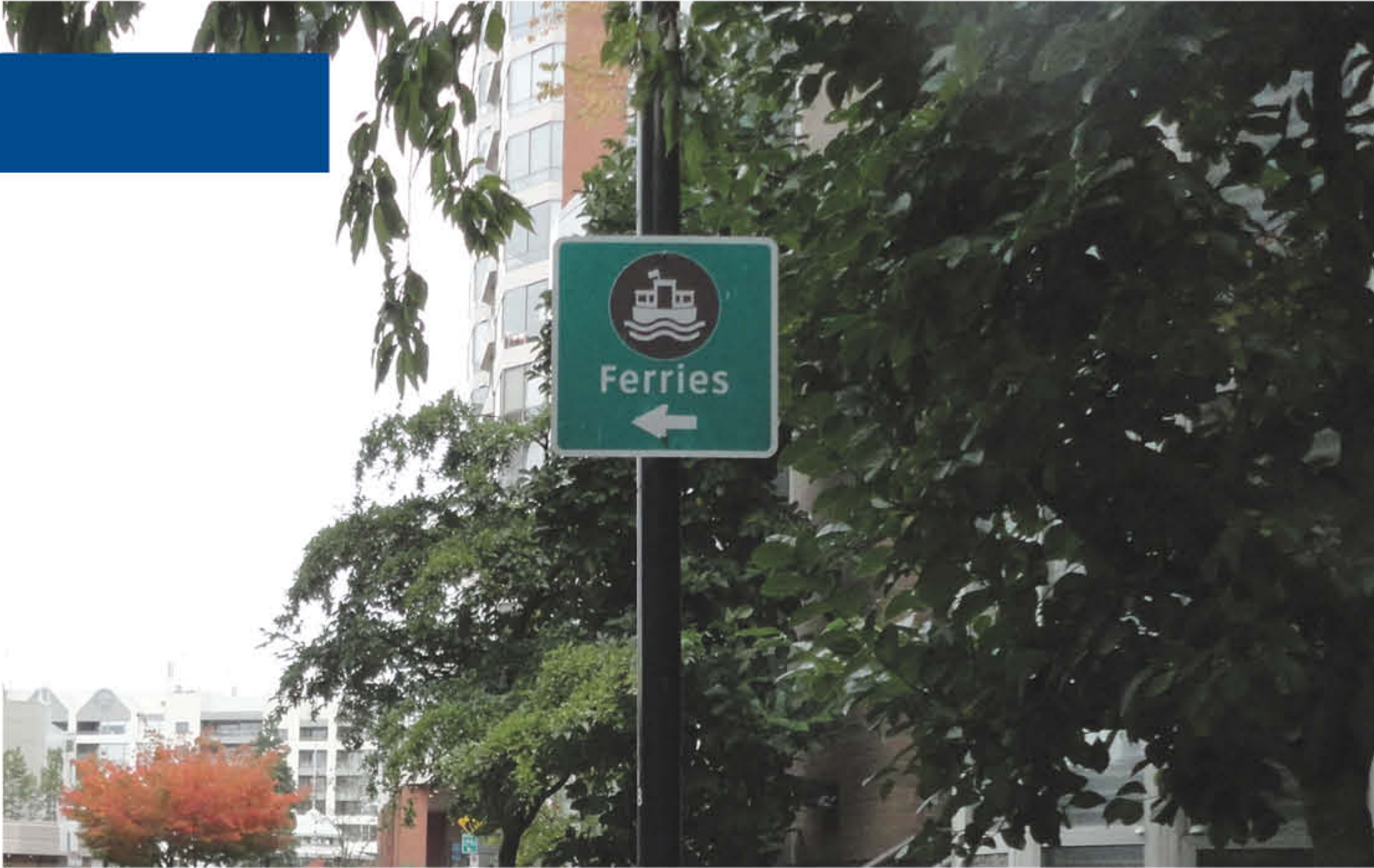

What are the improvements?

- Access to False Creek Ferry dock by people on bikes will be preserved.
- Additional markings and signs to reinforce this as a shared space

Location 3

Current Conditions

- Very tight space adjacent to patios and sharp corners.
- Heavy volumes of walking and cycling traffic.



Location 4

Current Conditions

- Walking and cycling access to False Creek ferry dock.



Planned Improvements

Location 5

Current Conditions

- Seawall route crosses private property within statutory right of way.
- Downhill section enables bikes to pick up speed entering shared spaces.



Solution

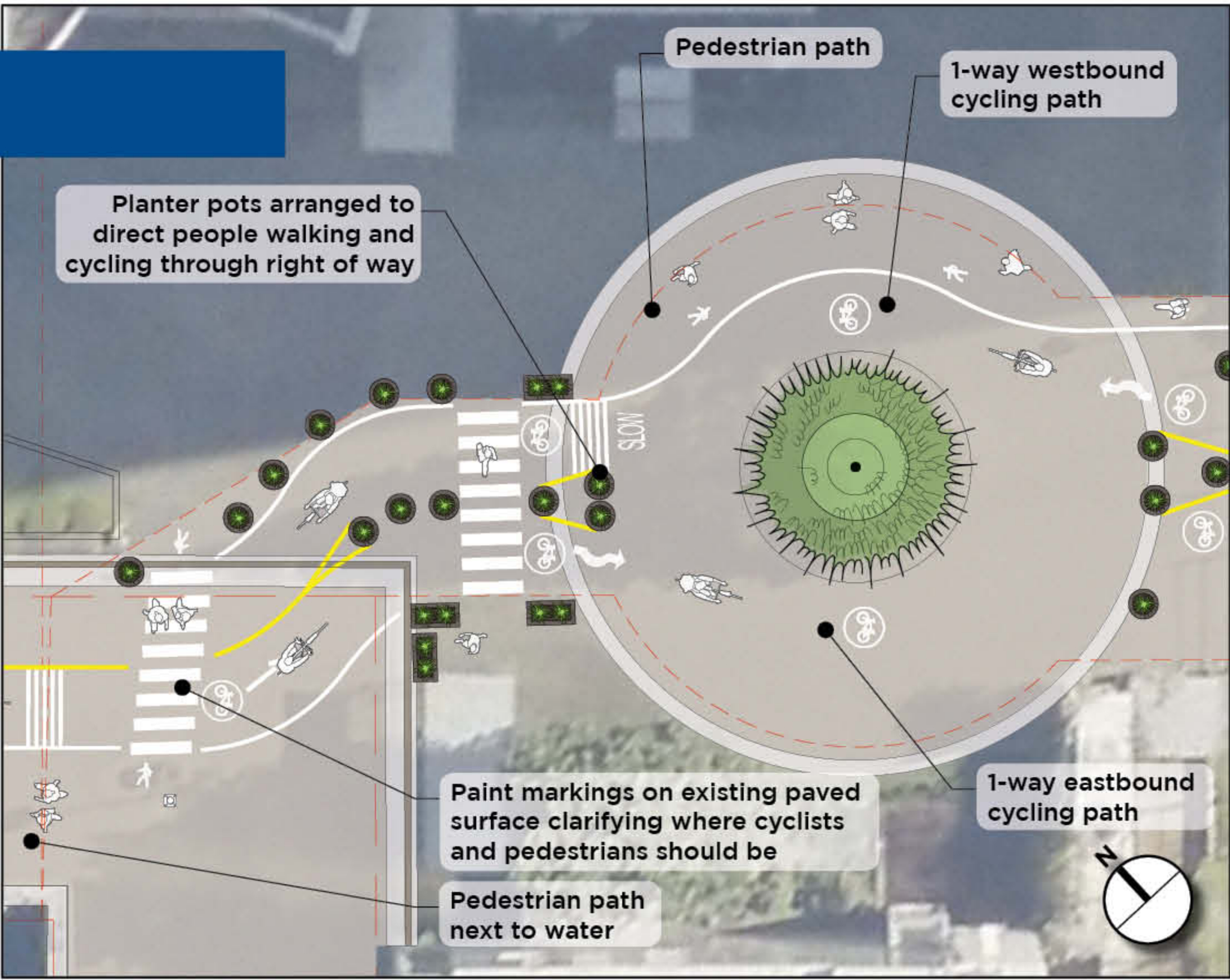

What are the improvements?

- Paint markings and portable planter pots to clearly delineate where people walking and people cycling should be in relation to one another.
- Adjustment of bollards to further clarify and delineate where different seawall users should be and to encourage people on bikes to ride counter-clockwise around tree.
- Paint markings and signage to warn cyclists to slow in areas where people on foot cross the bike path frequently

Location 6

Current Condition

- Large traffic circles with intersecting driveways, pickup and drop-off activity and many people walking and cycling cross.
- Few markings or signs to delineate space.



Solution

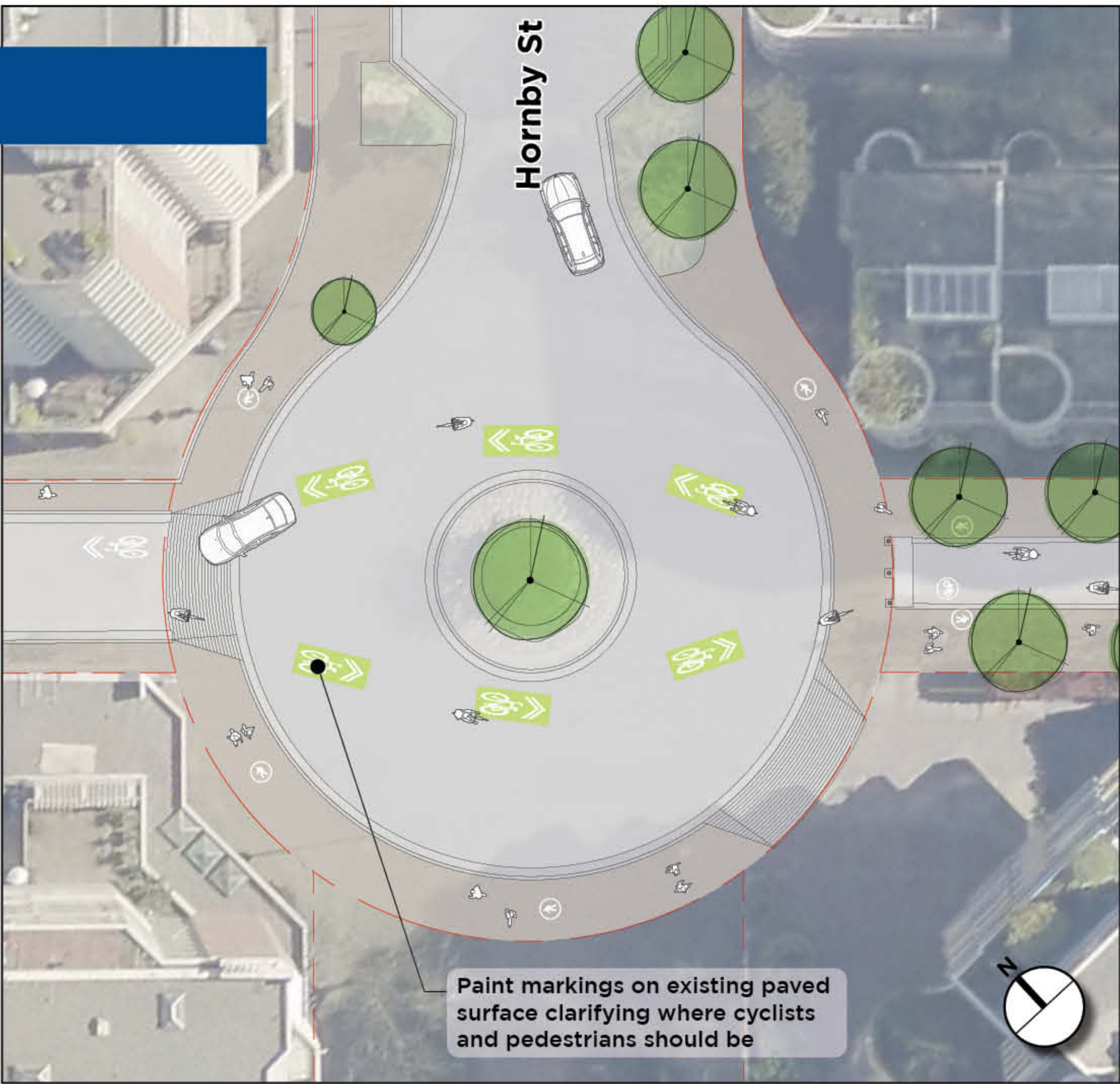

What are the improvements?

- Paint markings on the road surface of the culs-de-sac to indicate to people driving that the road surface is shared with people cycling along Seabreeze Walk.
- Yield signage for people driving and cycling to give way to those already in the circles.
- Markings and signs directing people to cycle counter-clockwise around circles.

