

# VANDUSEN GARDEN NOVEMBER BLOOM GUIDE

Use this bloom guide to help you find what is currently in bloom! **VanDusen Botanical Garden is home to 7,500 taxa (unique species and varieties) in 70 curated collections.** Discover intensely fragrant flowers, edible and medicinal plants, rare and endangered species, and many more botanical treasures. Some collections feature plants that are closely related, while others include plants from specific regions or habitats. Here we highlight just a few of the plants that are of interest today. Enjoy!

Use the bloom map to find these plants during your garden visit.

## Map Numbers:

- 1 Ginkgo
- 2 Hardy fuchsia
- 3 Bald cypress
- 4 Japanese maples
- 5 BC Habitat Garden
- 6 Heather Garden
- 7 Evergreen spindlebush
- 8 Fern Dell
- 9 Beautyberry
- 10 Japanese Collection



**1 Ginkgo (*Ginkgo biloba*):** Prized for its medicinal properties and ability to tolerate pollution, this Chinese tree dates back to the Jurassic. Its fan-shaped leaves turn golden yellow in fall.



**2 Hardy fuchsia (*Fuchsia magellanica*):** A magnet for hummingbirds, this species from South America and Australia has bright fuchsia pink and purple flowers.



**3 Bald cypress (*Taxodium distichum*):** From the wetlands of SE USA, these deciduous conifers grow along the shore with rows of odd woody "knees" (root projections) and rusty orange needles in fall.



**4 Japanese maples:** A stunning display of red, purple, orange and gold foliage reflect off the water of Heron Lake.



**5 BC Habitat Garden:** A forest of native trees, ferns, flowering perennials and shrubs that support wildlife with food, shelter and nesting habitat, while showcasing the beauty of our native plants.



**6 Heather Garden:** White, pink and purple heaths and heathers, with a grove of Scot's pine overlooking Heather Pond - a scene reminiscent of the Scottish Highlands and moors.



**7 Evergreen spindlebush (*Euonymus alatus*):** This woodland shrub from Western China is rare in gardens. It is grown for its fall colour and orange fruit which split open to reveal bright red seeds.



**8 Fern Dell:** A peaceful, shady grove of Douglas-fir trees, along with trees and shrubs from East Asia and an understory of delicate ferns from around the world.



**9 Beautyberry (*Callicarpa bodinieri* var. *giraldii* 'Profusion')**: Tall graceful shrubs that brighten up the woodland with their vibrant purple berries.



**10 Japanese Collection:** A selection of trees, shrubs and rare flowering perennials, like the wasabi plant, that are native to or grown in Japan.



- Planted Areas
- Lawn
- 🚲 Bike Racks
- ⚡ Electric Car Charge Station
- 🚰 Drinking Fountain
- ♿ Washroom
- 🍴 Restaurant
- ♿ Wheelchair
- Trails

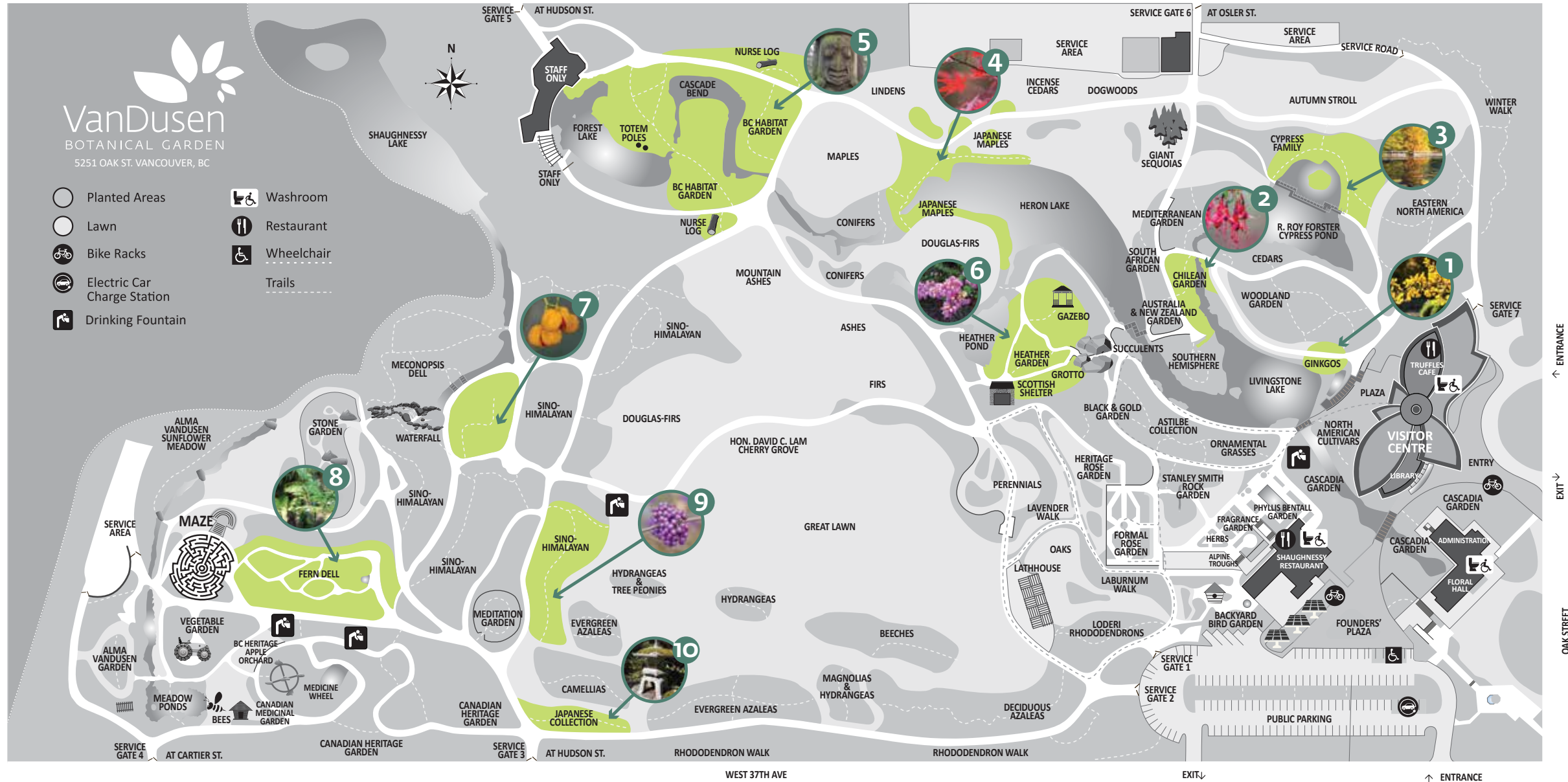

This guide is a reflection of blooms and garden highlights that typically occur during the month of November. Depending on seasonal weather patterns, some featured plants may not be in bloom during your visit today.