

A romantic scene of a bride and groom kissing in a lush botanical garden. The groom is wearing a dark blue suit, and the bride is in a white lace wedding dress. They are surrounded by dense green foliage and various flowers. A semi-transparent dark green banner is overlaid on the bottom half of the image, containing text.

VANDUSEN BOTANICAL GARDEN

2025 Weddings & Rentals

Office: (604) 257-6915

| VanDusenRentals@vancouver.ca

| vandusengarden.ca



Hennygraphy Photography

IT'S A SPECIAL PLACE

Thank you for considering VanDusen Botanical Garden for your upcoming event.

There are 3 beautiful outdoor rental areas for wedding ceremonies that can be booked between May 1st to October 5th, 2025 . The Garden also has a variety of indoor spaces which are perfect for ceremonies, receptions, meetings and other special gatherings that can be rented throughout the year.

The Garden itself is a 55-acre oasis in the heart of Vancouver with over 7,500 plant species and varieties from around the world; the perfect natural setting for a stunning event. The award-winning Visitor Centre features a green roof and a beautiful orchid-inspired design. This indoor event space looks directly onto the lake and garden.

2026 booking requests are also open, with the option to pay a deposit to secure a date.

GREAT LAWN



GREAT LAWN

The Great Lawn is a beautiful ceremony venue in the heart of the garden. There are various ceremony background location options at this lush and magnificent site and is sure to delight any nature lover.

Included capacity: 120 people

Maximum capacity: up to 200 people

Ceremony cost: \$2,350+GST

Includes:

- garden admission for up to 120 people (capacity includes vendors staying on-site)
- option to take wedding photos in the garden
- 4 hour lawn rental
- 4 hours of event liaison time (hours may be added)
- 4 hours of security time (hours may be added)

Additional costs:

- \$6.75+GST per person will apply for any additional guests above included 120 people
- Entandem fee if music is played (pricing to be determined dependent on rental group size, type of music, activity; with/without dancing)
- \$40+GST/hr for security if event is over 4 hours
- \$50+GST/hr for event liaison if event is over 4 hours

BOOKING COMBO

Please see pg. 15 for more details about discounted pricing when booking an indoor space for rain back up or reception

Details:

- it is the responsibility of the renter to arrange chairs, tenting and décor within the rental time frame
- no food or beverages permitted
- all tenting must be weighted (staking is not permitted)
- any tenting over 20'X30' (60m²) must have a building permit from the City of Vancouver Planning & Development Services
- multiple power outlets and water connection available at this site
- guest entry through Gate 2, (west end of parking lot), separate Gate 3 (37th Ave. & Hudson St.) entry for vendors + bridal party
- a wedding planner/day-of coordinator is recommended

Gallery

Please visit our online gallery for more images of the Great Lawn

HERON LAKE



HERON LAKE

Heron Lake offers a lovely mix of garden and lake views. Our large willow tree overlooking the Lake makes this the perfect backdrop for a stunning wedding ceremony.

Maximum capacity: up to 120 people

Ceremony cost: \$2,350+GST

Includes:

- garden admission for up to 120 people (capacity includes vendors staying on-site)
- option to take wedding photos in the garden
- 4 hour lawn rental
- 4 hours of event liaison time (hours may be added)
- 4 hours of security time (hours may be added)

Additional costs:

- Entandem fee if music is played (pricing to be determined dependent on rental group size, type of music, activity; with/without dancing)
- \$40+GST/hr for security if event is over 4 hours
- \$50+GST/hr for event liaison if event is over 4 hours

BOOKING COMBO

Please see pg. 15 for more details about discounted pricing when booking an indoor space for rain back up or reception

Details:

- it is the responsibility of the renter to arrange chairs, tenting and décor within the rental time frame
- no food or beverages permitted
- all tenting must be weighted (staking is not permitted)
- maximum tent size 20' x 30'
- any tenting over 20' x 30' (60m²) must have a building permit from the City of Vancouver Planning & Development Services
- one power outlet available at this site
- guest entry through Visitor Centre, separate Gate 6 (33rd Ave. & Osler st.) entry for vendors + bridal party
- a wedding planner/day-of coordinator is recommended

Gallery

Please visit our online gallery for more images of Heron Lake

MEADOW POND



MEADOW POND

Meadow Pond is a beautiful stand up wedding ceremony location and is the perfect spot for small intimate wedding ceremonies or elopements.

Maximum capacity: up to 30 people

Ceremony cost: \$825+GST

2 hour time slots to choose from:

11am-1pm, 1pm-3pm, or 3pm-5pm

Includes:

- garden admission for up to 30 people (capacity includes vendors staying on-site)
- option to take wedding photos in the garden
- 2 hour rental
- 2 hours of event liaison time

Additional costs:

- Entandem fee if music is played (pricing to be determined dependent on rental group size, type of music, activity; with/without dancing)

BOOKING COMBO

Please see pg. 15 for more details about discounted pricing when booking an indoor space for rain back up or reception

Details:

- maximum 2 hour booking
- this is a stand up ceremony area only; no tenting, chairs, or décor permitted
- no food or beverages permitted
- one small signing table and a few chairs for guests who require them are permitted
- no power outlets available
- private gate entry through Gate 4 (37th Avenue & Cartier St)

[Gallery](#)

Please visit our online gallery for more images of Meadow Pond

VISITOR CENTRE

VISITOR CENTRE

The Visitor Centre is comprised of 3 rental rooms; the BMO Great Hall and Peggy Gunn Woodland Hall A & B.

These rooms can be rented as one large space or separated into various combinations depending on the size of your event. Enjoy beautiful views of the lake and garden from the halls.

GENERAL INFO

- all set up and take down is the responsibility of the renter
- early access of 7 am or extended move out to 1am available for an additional fee of \$125+GST/hr.
- next day pick up not available
- discounted indoor/outdoor booking combo options available (see pg. 15)
- garden access is included for private functions from the Visitor Centre Halls (during garden hours)
- on weekends (Sat & Sun) only from April-October, if you would like to rent the Visitor Centre Halls you must book all 3 rooms combined (BMO Great Hall/Peggy Gunn Woodland Hall A & B)
- Entandem fee if music is played (pricing to be determined dependent on rental group size, type of music, activity; with/without dancing)

BMO Great Hall/Peggy Gunn Woodland Hall A + B		
Maximum capacity: 120 seated reception; 180 ceremony/lecture; 75 workshop		
Day (8am-4pm)	Evening (5pm-12am)	Full Day (8am-12am)
Standard: \$2,120 Non-Profit: \$1,485	Standard: \$2,365 Non-Profit: \$1,655	Standard: \$4,035 Non-Profit: \$2,825

BMO Great Hall/Peggy Gunn Woodland Hall A		
Maximum capacity: 90 seated reception; 120 ceremony/lecture; 60 workshop		
Day (8am-4pm)	Evening (5pm-12am)	Full Day (8am-12am)
Standard: \$1,590 Non-Profit: \$1,115	Standard: \$1,835 Non-Profit: \$1,285	Standard: \$3,085 Non-Profit: \$2,160

BMO Great Hall <u>OR</u> Peggy Gunn Woodland Hall A + B		
Maximum capacity: 60 seated reception; 80 ceremony/lecture; 40 workshop		
Day (8am-4pm)	Evening (5pm-12am)	Full Day (8am-12am)
Standard: \$1,060 Non-Profit: \$740	Standard: \$1,305 Non-Profit: \$915	Standard: \$2,130 Non-Profit: \$1,490

Peggy Gunn Woodland Hall B		
Maximum capacity: 30 seated reception; 40 ceremony/lecture; 20 workshop		
Day (8am-4pm)	Evening (5pm-12am)	Full Day (8am-12am)
Standard: \$530 Non-Profit: \$370	Standard: \$775 Non-Profit: \$545	Standard: \$1,175 Non-Profit: \$825

Gallery

Please visit our online gallery for more images of the Visitor Centre Halls

FLORAL HALL + CEDAR ROOM





FLORAL HALL

The Floral Hall is a charming post-modern style room and is located in one of the original buildings on site. This large and bright space can accommodate receptions for up to 120 guests and includes a small kitchenette area. Enjoy views of greenery through large windows on either side of the room.

Floral Hall		
Maximum capacity: 120 seated reception; 135 ceremony/lecture; 70 workshop		
Day (8am-4pm)	Evening (5pm-12am)	Full Day (8am-12am)
Standard: \$955 Non-Profit: \$670	Standard: \$1,205 Non-Profit: \$845	Standard: \$1,945 Non-Profit: \$1,360



CEDAR ROOM

The Cedar Room is a smaller classroom-sized space and is situated across the hall from the Floral Hall. The Cedar Room is great option as a bridal room, meeting room, or catering area when renting the Floral Hall. This room does not have speakers for A/V.

Cedar Room		
Maximum capacity: 50 ceremony/lecture; 20 workshop		
Day (8am-4pm)	Evening (5pm-12am)	Full Day (8am-12am)
Standard: \$310 Non-Profit: \$215	Standard: \$555 Non-Profit: \$390	Standard: \$780 Non-Profit: \$545

GENERAL INFO

- all set up and take down is the responsibility of the renter
- early access of 7am or extended move out to 1am available for an additional fee of \$125+GST/hr.
- next day pick up not available
- discounted indoor/outdoor booking combo options available (see pg. 15)
- for events with catering in the Floral Hall, it is highly recommended to rent the Cedar Room for your caterer
- Entandem fee if music is played
(pricing to be determined dependent on rental group size, type of music, activity; with/without dancing)

Gallery

Please visit our online gallery for more images of the Floral Hall & Cedar Room

VISITOR CENTRE HALLS (BMO GREAT HALL/PEGGY GUNN WOODLAND HALL A & B)

SAMPLE FLOOR PLANS

Reception Style

BMO Great Hall / Peggy Gunn Woodland Hall A & B
Maximum 120 people

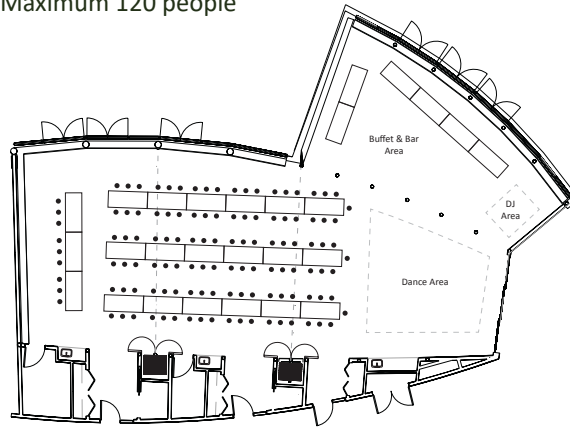

Pod Style

Peggy Gunn Woodland Hall A & B
Maximum 54 people

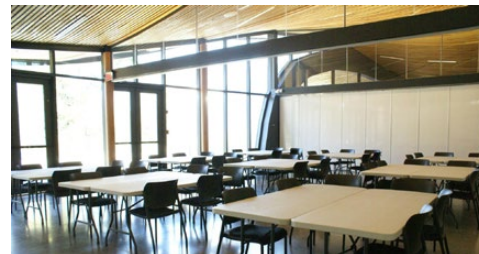
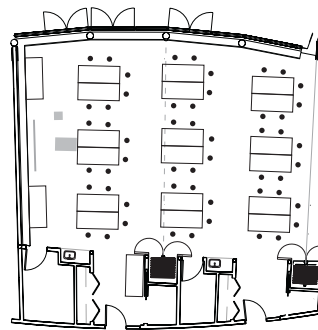

Ceremony Style

Woodland Hall B
Maximum 50 people

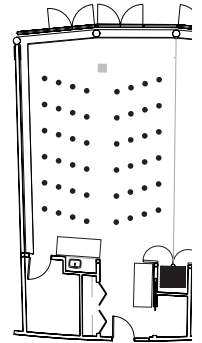

Lecture Style

Woodland Hall B
Maximum 40 people

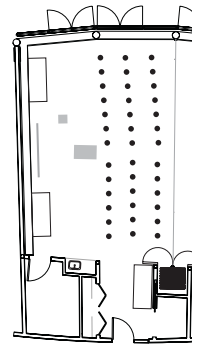

Boardroom Style

Woodland Hall B
Maximum 20 people

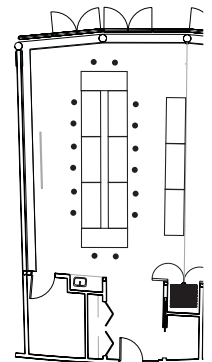

FLORAL HALL + CEDAR ROOM

SAMPLE FLOOR PLANS

Floral Hall Reception Style

Maximum 120 people

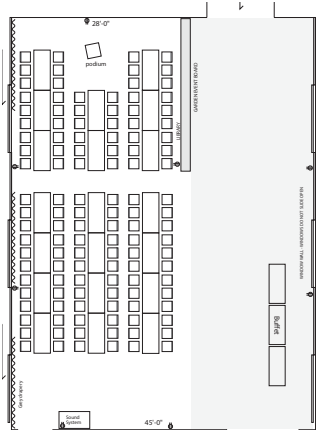

Sim Photography

Décor not included



IAMJOHNYOO Photography

Chair covers/Décor not included

Ceremony or Lecture Style

Floral Hall - Maximum 135 people

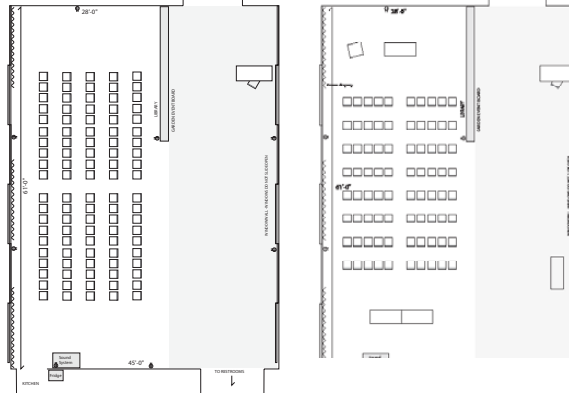

Meghan Elmstra Photography

Drapery/Chair Covers/Décor not included



Cedar Room



Boardroom Style

Cedar Room
Maximum 20 people

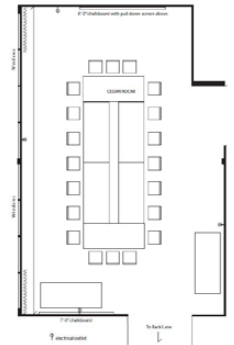

Lecture Style

Cedar Room
Maximum 50 people

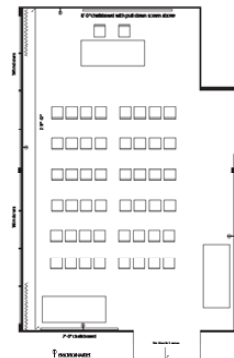



ADDITIONAL DETAILS

Booking Confirmation - A minimum of two months advance booking is required. A reservation fee of \$200+GST or \$500+GST (if outdoor booking or indoor serving alcohol) is required to confirm a booking. Please note that this amount is non-refundable in the event of a cancellation. Full payment is due 2 months in advance of the scheduled booking and no refunds are provided for events cancelled within 60 days of the scheduled booking.

Site Amenities - Our unique garden setting is wheelchair accessible and has ample free parking. We also have a lovely Garden Shop and The Garden Café by Truffles Fine Foods is located on site. Shaughnessy Restaurant is also a short walk away at the north west side of the parking lot.

Catering - When renting the Visitor Centre Halls only, a 12%+GST catering fee applies on food and beverage costs. If using Truffles Fine Foods who are located on site, the 12%+GST does not apply. There are no catering fees for Floral Hall or Cedar Room.

Liability Insurance - All events require liability insurance with the “City of Vancouver and its Board of Parks & Recreation” named as additional insured. If alcohol is being served at your event, \$5 million in liability coverage is required. If you will not be serving alcohol, \$2 million in liability coverage is required.

Liquor Service / Set Up & Take Down / Garbage - A special occasion license is required for any event serving alcohol. Renters are responsible for set up and take down within their booking time frame. Garbage/recycling should be properly sorted into 4-stream waste bins located on site. Any additional garbage should be bagged and left next to the bins at the end of the event.

Music / Entandem Fee - An Entandem fee is required if live or pre-recorded music is played. This is a music royalty tariff for all rentals with music; pricing to be determined dependent on rental group size, type of music, activity; with/without dancing.

WiFi - Our indoor halls have free WiFi accessibility, however it is not strong enough for video conferencing style events. It can be accessed on the VanWiFi or COV-Public networks and no password is required.

Indoor/Outdoor Booking Combo - For all outdoor ceremony events that wish to add an indoor hall option for their reception, we offer a discount. For Heron Lake and Great Lawn events, we offer 40% off the indoor rate when booking the full day. If the indoor hall is only required for a half day booking, we offer a 25% discount on the hall rental portion. For Meadow Pond events we offer a 10% discount on all hall rental options.

If booking an evening reception on site, a full day indoor rental is recommended. This will provide a rain back-up option for your ceremony, and proper set up time for vendors to prepare for the reception.

Included items upon request for Indoor Rentals:

- 2.5' x 6' tables
- Sound System (Visitor Centre and Floral Hall only)
- Black chairs
- Podium
- LCD projector (Visitor Centre or Floral Hall, &/or Large Portable HD TV (Visitor Centre only) - additional fee applies
- Coffee & Hot Water urns - (urns only - does not include any coffee or tea service - renter must bring all supplies needed, ie: coffee grounds, cups, tea, milk, sugar etc.)
- Microphone (Visitor Centre and Floral Hall only)
- Kitchenette area (Floral Hall only)

Drone / Smoking/ Animal Policy - Please note that drone photography/ videography is not permitted on site. Please ensure that photographers are aware prior to your event. No smoking or vaping permitted on premises. Pets are not permitted. Working guide and service dogs are welcome.

Garden Access - If booking a private indoor only event in Floral Hall or Cedar Room and wish to have garden access for you and your guests (during garden hours), discounted admission rates are available. Wedding photos may be taken in the garden with this garden access. Guest list required for all events.

Garden Admission Package Rates	
10% Discount for 20 people or less	\$250+GST for 20 - 50 people
\$450+GST for 50 - 100 people	\$650+GST for 100 - 150 people

Visitor Centre Halls (BMO Great Hall or Woodland Hall A and B)

- Entry available through rental hall doors

Floral Hall and Cedar Room

- All attendees will need to have their names checked off at the admission desk prior to entering the garden

LINKS + CONTACT



Thank you for taking the time to review our brochure.
Should you have additional questions, wish to check availability, or like to confirm a date, please send us an email.
We look forward to working with you!

For photos of our various venue options, please click the green button, or visit the website below.

[VanDusen Botanical Garden
Online Gallery](#)

bit.ly/VanDusenRentalPhotos

Facility Rentals

Office: (604) 257- 6915 / Fax: (604) 257-8679

VanDusenRentals@vancouver.ca

vandusengarden.ca

