

All drawings and related documents are the property of Acton Ostry Architects Inc. and may not be reproduced in whole or in part without the architect's permission. This drawing should not be used to calculate areas. Do not scale this drawing. All dimensions to be checked on site by the contractor and such dimensions to be their responsibility. All work must comply with the relevant Building Code By Law and related documents. Drawing errors and omissions must be immediately reported to the Architect.

issues
 08 May '09 issue for DP
 03 June '09 issue for UDP

revisions

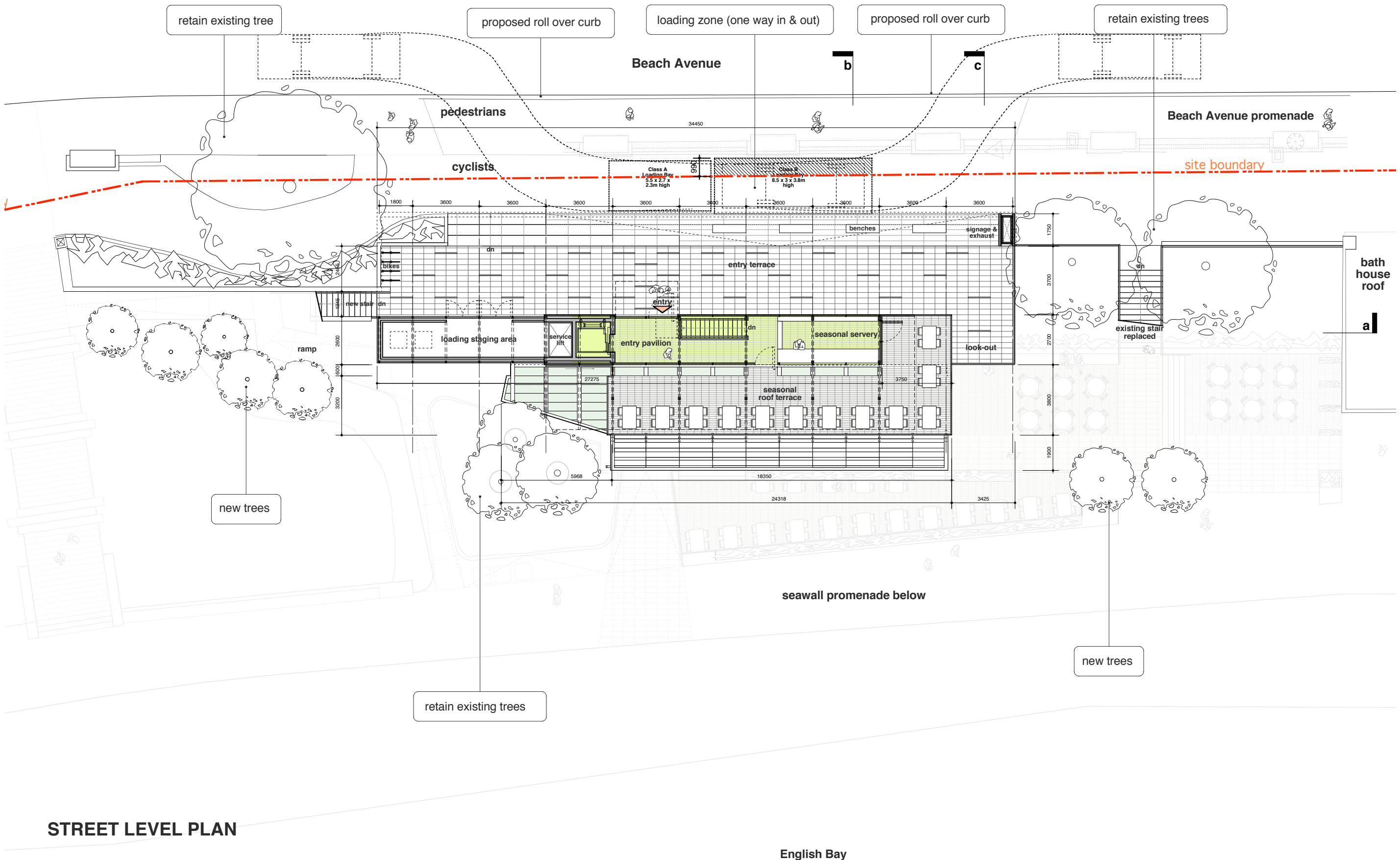

NOTES:

- Acoustic measures will be incorporated into the final design based on the Acoustic Consultant's recommendations in consultation with or amended by the Medical Health Officer (Senior Environmental Health Officer).
- Mechanical equipment (ventilators, generators, compactors and exhaust systems) will be designed and located to minimise noise and air quality impact on the building occupants and neighbourhood and to comply with noise by-law #6555.
- Sustainability strategies to achieve min. LEED Silver equivalency will be employed as itemized in the "LEED Canada and LEED Core and Shell Strategies" document submitted with the Final Development Permit submission. Items not specifically noted in the drawings will be confirmed at Building Permit stage.

ACTON OSTRY ARCHITECTS INC.

111 E 8 Avenue
 Vancouver BC
 Canada V5T 1R8
 t 604.739.3344
 f 604.739.3355
 info@actonostry.ca

English Bay Bistro, Restaurant

Vancouver Park Board
 1790 Beach Avenue, Vancouver

scale	date
1:100 @ 22 x 34"	8 May 2009
project code	status
EBR	DP
drawn	checked
BS	RA

STREET LEVEL PLAN

**Level 2 Plan@
 Beach Avenue
 Promenade**

drawing number
A1.02