



VANCOUVER BOARD OF PARKS & RECREATION 2007 ANNUAL REPORT



Lively and
DIVERSE
by NATURE.

VANCOUVER BOARD OF PARKS AND RECREATION (THE PARK BOARD)



Korina Houghton
Chair



Ian Robertson
Vice Chair



Allan De Genova
Commissioner



Spencer Herbert
Commissioner



Heather Holden
Commissioner

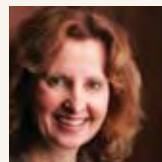

Loretta Woodcock
Commissioner

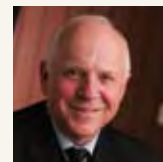

Marty Zlotnik
Commissioner

MESSAGE FROM CHAIR AND GENERAL MANAGER

Welcome to our Annual Report for 2007, and greetings on behalf of the Commissioners and staff of the Vancouver Park Board.

For us, the year 2007 was defined by two great challenges: the continuing aftermath of the worst windstorm to hit Vancouver in nearly half a century with the subsequent restoration of Stanley Park, and the three month labour disruption which shut down facilities and services from mid July to mid October.

Both situations had a significant effect on our operations. The tumultuous year necessitated quick crisis response, redirection of resources throughout the organization and an unwavering focus on continued delivery of quality parks and recreation programs to residents and visitors.

2007 was also the year we 'put the shovel in the ground' at all three 2010 Winter Games legacy facilities at Hillcrest Park and Trout Lake and Killarney Rinks. These long anticipated projects were kept on track throughout the year, as we worked closely with our partners to resolve funding issues and meet construction deadlines.

We are pleased to report that the Park Board persevered and moved forward through the wide impacts of the wind storm and the civic strike as well as the other challenges during the year, demonstrating the skill and flexibility of staff and the leadership and vision of the Board.

You are invited to read our report and learn about the wide range of parks and recreation services available to you and your family in this great City.

Susan Mundick
General Manager

Korina Houghton
Chair



PHOTO FROM LEFT TO RIGHT

Susan Mundick and Korina Houghton with a backdrop of one of Stanley Park's magnificent big trees.

OUR ROLE

The many and varied park and recreation programs, delivered directly and through partners, contribute to healthy communities and families and to a healthy environment and economy for the city. Many activities benefit people's lives no matter their age, ability, interest or economic means. The Park Board champions personal and community well being - connecting neighbours, improving the natural landscape and keeping lives in balance.

We are responsible for:

PEOPLE – leisure and sports, education, arts and culture, youth, children and seniors, ensuring accessibility

PLACES – community centres, rinks, pools, fitness centres, restaurants, concessions, marinas, clubhouses

PARKS – destination parks, neighbourhood parks, remnant woodlands, beaches, public gardens, sports fields, VanDusen Garden, Bloedel Conservatory, golf courses, street trees

MISSION

Provide, preserve and advocate for parks and recreation services to benefit people, communities and the environment.

Working for Residents

The work of the Park Board touches lives every day in many ways. Gardeners plant the tulips in public gardens that welcome visitors each spring. Construction crews install the playgrounds where your children play. Sanitation workers pick up litter from your neighbourhood park. Maintenance crews power wash tennis courts and Structures staff install park benches. Arborists plant and prune the trees that line your street. Lifeguards arrive early each day at your favourite pool to ensure you get your morning swim and then teach your children how to stay safe in the water. Equipment operators run the beach cleaning machine that sweeps up the debris and then artfully arrange logs for the enjoyment of summer's sunbathers.

PARK BOARD

BY THE NUMBERS

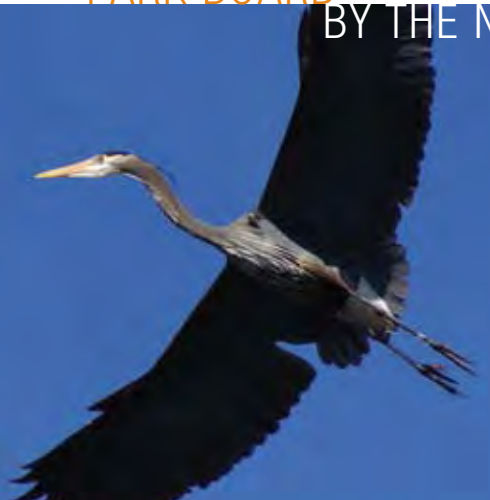

FUN FACTS FROM 2007

- 350 young herons left their nests at the Stanley Park heronry
- 32,280 pounds of French fries were served at concessions
- 1,500 gallons of paint were used by staff
- 128,000 rounds of golf were played on our courses
- 500,000 plants were grown at our Sunset Nursery

DID YOU KNOW?

The Park Board is the steward of...

- 223 parks comprising 1,296 hectares or 11% of the city's land area
- 23 community centres, 9 indoor and 6 outdoor pools, 8 ice rinks, and 24 fitness centres
- 3 full-length and 3 pitch and putt golf courses
- 129 playing fields, 180 tennis courts, 57 other sport courts, 6 skateboard parks
- 151 children's playgrounds, 133 ball diamonds, 7 cricket pitches
- 18 kilometres of beaches, 30 lifeboats and 2 marinas
- 133,141 street trees
- a web site with over 2,000 pages of information

REPORT 2007

Planning staff oversee the redevelopment of parks and coordinate the task of building new recreation facilities. Facility Clerks are there to greet you and answer your questions at your local community centre while Building Service Workers keep your centre clean. Mechanical Technicians operate the refrigeration plant that produces the ice at your local rink and Utility Maintenance Workers resurface the ice between sessions. Information Technology Specialists help to keep you informed by keeping our web site accessible and current and Arts and Culture Coordinators help connect communities through local art projects.

More than 700 full time and 1,300 auxiliary staff bring their unique skills and experience to a multitude of tasks in every corner of our city. Each person is a crucial, indispensable part of the Park Board team that helps to keep the city beautiful and our residents thriving.

Our ongoing commitment is to improve services as we adapt to our city's growing and changing needs.

The year was marked by the major impacts of the late 2006, early 2007 wind storms and the summer long labour disruption.

Despite these challenges, the Park Board made significant progress on delivering new and improved parks and recreation services to residents. During the year, we renewed and expanded green spaces and community facilities, launched new environmental programs, developed sports facilities, consulted with the public, promoted arts and culture, celebrated the diversity of our citizens and supported active living.

2007's many accomplishments would not have been possible without the contributions of numerous stakeholders and agencies, hard work and commitment of employees, and active involvement of the public. Our work was carried out with the continuing support of City Council and City staff, community groups and other partners.

This report highlights the key accomplishments of the Park Board in 2007. As well, it measures our success in meeting our priorities; however, it is important to note that a number of the year's performance indicators were affected by the 12 week work stoppage.

PHOTO FROM LEFT TO RIGHT AND CLOCKWISE

A close up of the renovated children's playground at Ceperley Meadow in Stanley Park; visitors enjoy the fountains and Henry Moore sculpture on the new plaza atop Queen Elizabeth Park; colourful lupins are part of the erosion control measures at New Brighton Park; kids join in the games at the Pandora Park opening event.



WELLNESS & COMMUNITY

The Park Board's priorities include increasing physical activities especially in sports, involving the public to help us in decision making, and making arts a part of everyday life.

GETTING ACTIVE FOR LIFE

The Active Communities Vancouver program was expanded with new initiatives and information to inspire and equip residents to become '20% more active by 2010'.

The "Go Play!" marketing campaign was expanded to promote attendance at rinks, pools and fitness centres and encourage active living.

Internet bookings became the most popular way to reserve golf at the three full length courses, with 60% more golfers choosing the advance booking option to reserve games.

New scanable Flexi Passes and 10 visit cards with photo ID were introduced for pools and fitness centres, providing faster service and quicker renewals.

STAYING INFORMED AND INVOLVED

The Annual Report was published in both English and Chinese for the second year and the semi-annual Leisure Guide was distributed to a broader audience.

Fifteen open houses and workshops were hosted to give residents an opportunity to review and provide input into concepts, designs and plans for park and facility projects.

Stanley Park's Ted and Mary Greig Rhododendron Garden database was finalized, with self-guided walking tours developed and posted on the website.

Four community board meetings were held to bring decision-making closer to residents and make it easier for them to attend.

New Naming Rights and Commemorative Naming Policies were approved, providing guidelines for naming Park Board facilities.

A new process around naming parks was finalized, to give greater consistency and more public input.

AWARDS



Project Evergreen Canada
VANDUSEN BOTANICAL GARDEN - STEWARDSHIP AWARD
Recognizing exemplary work and a passion for greenspaces



City of Vancouver
COAL HARBOUR BALUSTRADE - HERITAGE AWARD OF MERIT
For continued maintenance, conservation and restoration of the historic railing

TRACKING PROGRESS

REVENUES AT POOLS, RINKS & FITNESS CENTRES (Admissions, rentals, lessons)

Park Board neighbourhood facilities continue to offer fun, affordable and accessible recreation

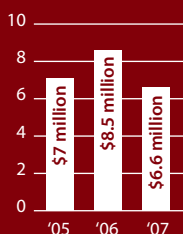

TOTAL WEB SITE VISITS (in millions of visitors)

Recreation related web site visits account for 30% of the top 60 visited pages

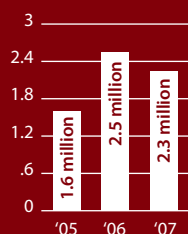

Increasing the number of parks and recreation facilities allows the Park Board to address the increasing demands of a growing city

NEW/RENEWED FACILITIES

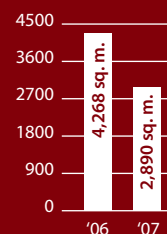

NEW/RENEWED PARKS



CONNECTING TO THE ARTS

More than a dozen community projects were funded under the Neighborhood Matching Fund.

Artists-in-Residence were selected for six month residencies at Mount Pleasant and Britannia Community Centres.

Three artist teams were selected to participate in Stanley Park's environmental art project.

International Sculpture Biennale's inaugural exhibition of public art in parks and on beaches was enjoyed by residents and visitors.

Go to activecommunitiesvancouver.ca and try one our 144 "Step Out" walks to discover the history, culture and nature of Canada's most walkable city.

PLANNING TODAY FOR TOMORROW: SUSTAINABILITY

The Park Board remained a strong advocate for more natural landscapes and urban ecology.

In partnership with community partners and thousands of volunteers, the Park Board marked the annual Earth Day events in Everett Crowley, Jericho and Hastings Parks by tree plantings, bird watching, guided walks, arts and crafts, and other celebrations.

Shoreline protection was completed at East Vancouver's New Brighton Park to control major erosion. Native plantings and rocks were featured in the project which beautifies the waterfront area, improves access and secures it against future damage.

A ParkPartners event was held with more than 25 stewardship groups to revitalize the program. New web-based tracking tools were piloted for their community-based projects aimed at park safety, education and cleanups, as well as community art and neighbourhood events.

PHOTO FROM LEFT TO RIGHT

There are lots of ways to get connected: stroll through a downtown waterfront park; find out how it's "fun, accessible and affordable" to get fit at your community centre; or join a community garden and cultivate some new friends.



RENEWING PARKS & RECREATION FACILITIES

The Park Board is committed to meet the needs of the community, keep pace with population growth and stay in tune with changing demographics. Our priority is to invest for the long term.

Ongoing use of the Downtown Skate Plaza was approved, following a 2 year trial for the popular street style skate board park

A 25-year lease was approved for the Stadium in Nat Bailey Park, including a \$5 million restoration of the historic baseball facility.

STUNNING NEW FACILITIES

A new Sunset Community Centre was opened to the public at year end, replacing one of the oldest centres in the city. The dramatic “green” building with its many sustainable features and unique landscaping was relocated to Main Street.

Extensive plaza renovations were officially opened at the top of Queen Elizabeth Park including the Celebration Pavilion, fountains, and Tai Chi arbours.

The new Air India Memorial was unveiled near the waterfront in Stanley Park. The project, funded by the Federal Government, included a major refurbishment of the historic children’s playground at Ceperley Meadow.

Site preparations began on the Trillium lands for installation of two artificial turf playing fields.

MORE AND BETTER PARKS

East Vancouver’s redeveloped Pandora Park was officially opened with new walkways, seating, play areas and drainage.

Two small green spaces were added to the Vancouver park inventory: in Yaletown at Mainland and Nelson, and in Marpole at 72nd & Osler.

Neighborhood park upgrades significantly improved Nelson and Victoria Parks, and the Oak & 37th park site.

The Lost Lagoon bicycle path was reconstructed to improve pedestrian and cyclist safety in Stanley Park.

Playgrounds were renovated or replaced in George, Bobolink, Victoria, and Rupert Parks to better serve families; new playgrounds were added at Coopers’ Park Extension, Nelson, Stanley and 72nd & Osler Parks.

AWARDS



Lieutenant Governor of British Columbia
KILLARNEY LEISURE POOL - AWARD OF MERIT
Recognizing unique design features such as sweeping walls of windows



Leisure Business Magazine
KILLARNEY LEISURE POOL - FACILITIES OF MERIT AWARD
Honouring the building for function, design, integration and value for money

TRACKING PROGRESS

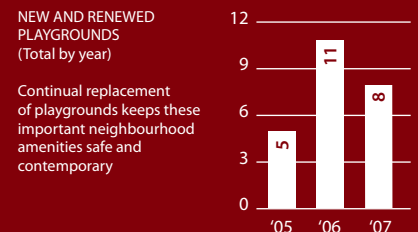
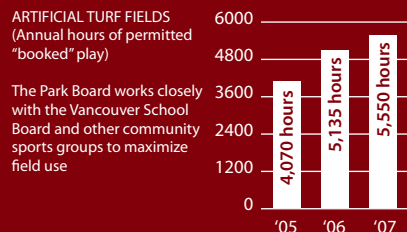
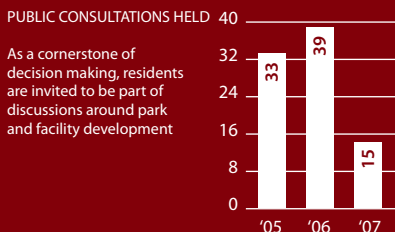

PLANNING TODAY FOR TOMORROW: THINKING GREEN

The Park Board's environmental leadership continued through a variety of water and energy conservation measures and alternative technologies.

In 2007, ongoing and new initiatives further reduced harmful greenhouse gas (GHG) emissions at facilities. The Park Board also started a challenging retrofit program, as part of the City's Corporate Climate Change Action Plan, to lower annual GHG emissions by over 2,200 tonnes. The program contains 120 projects in 30 locations and will be completed early in 2010.

- Gym lighting at the Roundhouse was changed to more efficient fluorescent, lowering annual emissions by 3 tonnes of GHG.
- A heat recovery system was installed in Templeton Pool, taking heat from the hot air being exhausted from the building and using it to warm up fresh air – resulting in 40% fewer GHG emissions.
- UV water treatment was installed in Kensington Community Centre's hot tub/whirlpool, significantly improving water and air quality and reducing maintenance.
- Eleven playing field irrigation systems were converted to more efficient radio control, saving 30% of the water.
- LED lights were installed at Lost Lagoon fountain's popular seasonal display, providing longer life, and significantly reducing GHG emissions.
- To conserve water, low flow plumbing fixtures such as metering basin faucets, metering showers and dual flush flushometers were installed at a number of facilities.

Following a pilot program, park concession stands started using biodegradable, compostable food containers to reduce waste.

Other ethical and sustainable initiatives at Park Board offices and facilities helped to collectively reduce impacts on the environment

- Green certified cleaning products and biodegradable garbage bags
- Recycled multi-purpose copying machines
- Energy efficiency requirements of courier service contractor
- Ethically sourced clothing for recreation staff
- Certified fair trade coffee, sugar packets and chocolate bars
- Network stations certified by Enviro-Choice, made from 100% recycled or renewable materials.

Try something new. Change your perspective and discover one of our great neighbourhood or feature parks around the city - they are our shared backyards.

PHOTOS

The spectacular new Sunset Community Centre offers a comfortable, welcoming environment for all ages and interests through every season of the year. The light-filled interior offers more and larger programmable spaces.



SPECIAL PROJECT: STANLEY PARK RESTORATION

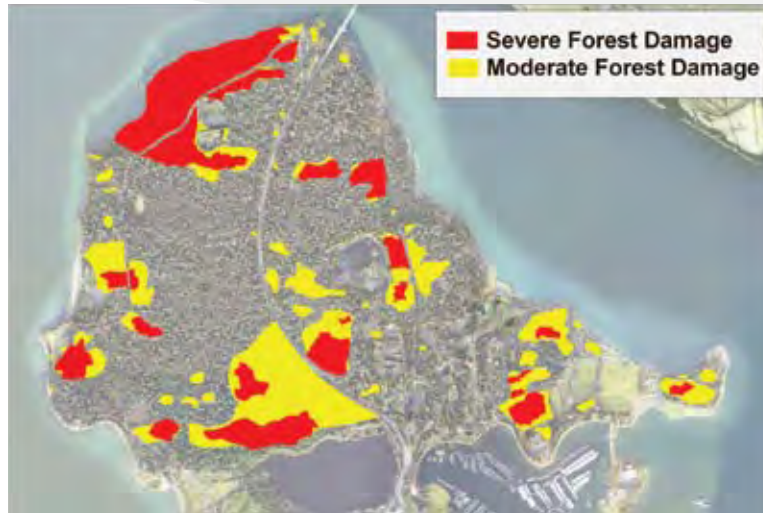

significant damage to the seawall, especially in the area between Prospect Point and Third Beach. Much of the park was closed for two weeks for the first time in over 40 years.

RESPONSE AND CHALLENGES

The Park Board responded quickly with a redirection of resources, focusing immediate efforts on restoring access to roads, park facilities and services. The initial clean up required that staff work from dawn to dusk for two weeks to clear the roads. The project

required a continuous balancing of park access and business operations with public safety and environmental concerns.

The restoration of Vancouver's beloved Stanley Park was 2007's signature renewal project.

THE STORM

The gale-force wind storms of late 2006 and early 2007 toppled more than 10,000 trees in Vancouver's first and largest park, a National Historic Site. The storms left a level of devastation that had not been seen since Hurricane Frieda in 1962. Severe damage was caused to nearly 40 hectares (100 acres) of forest and light to moderate damage to another 40 hectares, blocking trails and closing roads. Trees were uprooted, snapped in half or knocked down by other trees, leaving broad swaths of tangled debris, splintered trunks and upturned rootballs. The storm destabilized the slopes on the west side of the park and pounding waves and falling trees caused

During the early stages, it became apparent that the storm damage was so severe that the organization would not be able to restore the park with current staff and financial resources. The crisis would require a level of knowledge and experience that was beyond those found within the organization and the estimated cost of recovery was far beyond existing budgets.

The Park Board began enlisting the help of a diverse range of experts and forged creative partnerships to assess the challenge and address the multifaceted work to plan, and then carry out, the complex recovery process. Leaders in the fields of forestry, ecology,

COMPLETED WORK

Significant progress was made in 2007 with the park well on its way to being assessed, cleaned up and renewed by year end. With the help of biologists, archaeologists, engineers, environmentalists and forest specialists, coupled with support from governments, corporations, individuals and the media, the following restoration work was completed:

- Clearing 80 hectares of blowdown areas
- Removal of 25,000 cubic metres of fine woody debris from roads, trails and blowdown areas
- Preparation of a new protection strategy
- Distribution of 12,000 sections of fallen trees
- Protecting environmentally sensitive areas



biology, geotechnical engineering, fire suppression and watershed management were drawn from industry, academia and professional and nonprofit organizations to join the restoration team.

RESTORATION PLAN

Although the general perception is that Stanley Park is a natural, healthy forest, this is far from the truth. Logging in the 1800s and other human intervention over the past hundred years as well as an increase in diseased trees has left a less diverse, weakened forest which significantly contributed to the extensive damage caused by the recent storms.

The devastation however, provided opportunities to address these longstanding forest maintenance

issues. A \$9.5 million Restoration Plan was prepared by a team of Park Board staff, consultants and volunteers with a wide range of knowledge and experience and with extensive consultation involving the public. Drawn from the latest expertise in forestry and ecology, this comprehensive plan was approved in April with the goal of restoring the park and achieving a balanced, stronger and more diverse forest. In addition, it allowed for the reassessment and protection of sensitive wildlife habitats and species at risk.

The plan's vision: that Stanley Park's forest be a resilient coastal forest with a diversity of native trees and other species and habitats, that allows visitors to experience nature in the city.

PLANNING TODAY FOR TOMORROW: LEGACIES FOR STANLEY PARK

DONATIONS

The ambitious Restoration Plan would not have been possible without significant financial and in-kind contributions. A total of \$9.5 million was pledged from the three levels of government (City of Vancouver, Province of B.C. and the Government of Canada) and more than 7,000 corporate and private donors. This unprecedented level of support allowed the recovery of the park to proceed quickly and effectively. To learn more about support received by the Park Board, please turn to page 12.

FUTURE PROJECTS

One of the goals of the restoration was to create supporting legacies that will sustain and support Stanley Park for future generations. These include setting aside one small blowdown as a demonstration site; the development of historical, cultural and interpretive signage; creating a new long term forest management plan in consultation with partners and professionals and establishing an ongoing forest maintenance fund for continued restoration work through revenues from the sale of a portion of the fallen trees.



- Reopening roads and reopening and upgrading trails
- Removal of 1,500 hazardous trees
- Assessing and mapping the park
- Modifying exposed trees on new forest edges to protect them from future storms
- Stabilizing damaged cliffs and slopes
- Reopening the seawall
- Identification of environmental and cultural features that need protection, including 117 culturally modified trees and 6 kilometres of streams
- Replanting of 16,000 trees



DONOR SUPPORT

CREATING COMMUNITY THROUGH PARKS & RECREATION

Public green space, gardens, urban forests, swimming pools and sports fields are just some of the places where we play, rejuvenate and come together. Coming together to support the conservation and preservation of public places does help to make a difference.

Last year, the Park Board received a wide range of support from financial and in-kind to volunteers. We are pleased to report back and showcase how community contributions have helped to develop new recreation programs, enhance recreation facilities, and preserve parks and valuable green space.

Did you know that financial contributions to Canadian Municipalities are tax deductible? For more information, please visit our website at vancouverparks.ca and click on Donations.

SOURCES OF DONATED FUNDS

Special Events

Last year, many groups held events to raise funds for Park Board projects. Several organizations raised money in support of the Stanley Park Restoration. Funds were also raised to refurbish the Kits Beach basketball courts. Many other projects have received support from school groups, employee groups and community service groups.



Endowments

The Park Board's Endowment provides sustainable funding for park conservation and recreation programming. You can help grow the Endowment and support the future of our parks through a planned gift made as part of your overall financial plan such as an outright gift of cash, transfer of securities or a bequest made through your Will. Endowments allow you and

your family to create a legacy for your community. Your legacy continues to provide a meaningful and long-term impact for future generations. The Park Board gratefully acknowledges the following for their vision and their support:

- Keith and Betty Beedie Conservation Endowment for Stanley Park
- Barb Brown Heron Habitat Preservation Endowment for Stanley Park*
- Endowment In Memory of Patrick and Louise Foran*
- Stan and Norine Johnson Endowment for Recreation
- Mower Family Endowment*
- Aynsley Phelps Conservation Endowment for Stanley Park

*Refers to Endowments established in 2007.

The Barb Brown Heron Habitat Preservation Endowment for Stanley Park was established by Mike Dumler and Dave and Lois Brown, the husband and parents of Barb Brown, in loving memory of a wife and daughter who lived close to Stanley Park, its seawall and the Blue Heron Habitat. Barb took such pleasure in the herons and the seawall that her husband, family and friends have honoured her with an Endowment that will be used to maintain a safe and nurturing environment for the herons, as well as providing for a memorial bench on the seawall.



"We hope that, like our Barb, all who rest here on this bench will experience a feeling of renewal." Mr. Mike Dumler

Estate Gifts

A gift in a Will is an expression of what is most dear to you. The Park Board is fortunate to be the beneficiary of estates from people who are passionate about parks and recreation. We are honoured to recognize gifts received from the following individuals in 2007:

- Frank and Myrtle Bain
- Margaret Cox
- Caroline Cunningham
- Paul Andrew Farina
- Judy Hinkson
- Maureen Nicol
- Charles Franklin Moore
- Shirley Ogelski
- Beatrice Parton
- Thelma Pearl Plant
- Philip J. Thomas

Park Amenities

Commemorative gifts such as trees, bicycle racks and park benches provide lasting and meaningful tributes and help to enhance and beautify parks.

Mr. Frank Sanie, a long-time resident of Vancouver dedicated a park bench to celebrate and promote the sport of croquet. Over 40 years ago, Mr. Sanie was responsible for bringing this social sport to the forefront, and today continues to inspire people of all ages and abilities to learn the sport. He also volunteers at community centres, schools and plays an active role with Park Board Community Associations.



"It's only through giving back and volunteering that one truly enjoys life. If you help people stay active, you make them happy and healthy." Mr. Frank Sanie

DONOR SUPPORT

Tribute Gifts

A tribute gift honours friends, family, mentors and loved ones. These gifts can be designated to a park or recreation program or can be designated to the ongoing need for planting new and replacement trees. The following individuals have had gifts made in their honour:

Gwen (Maya) Anderson
Manon Charette
Louise & Patrick Foran
Suzanne Hogan
Jeannie Kuyper
France Queyras
Ann Richmond
Rebecca Robbins
Graeme A.G. Stamp

United Way & Grants

Each year the Park Board receives support from individuals who have designated a gift through the United Way. Granting agencies have also provided funds to programs offered through Park Board Community Centres. Gifts have been designated to tree planting, park conservation projects and the development of new recreation programs.



Through the generosity of communities, much needed playground upgrades are taking place. Last year, friends and family donated a Spider Net playground element for MacLean Park in honour of a loved one whose passion was caring for special needs children. This year, additional enhancements are planned for MacLean Park, including more amenities such as seating areas and landscaping.

RECOGNIZING YOUR SUPPORT



The Park Board wishes to thank everyone for their support! For a complete list, please visit our web site at vancouverparks.ca and click on Donations.

\$10,000 & Above

The Beamish Family
David & Eleanor L. Brown
The Cox Family
Michael Dumler
Hillsboro Investments Ltd.
Kathryn Hurwitz
Dan Karr
M.J. Korenberg
Dr. Michael & Diana Livingstone
The Mower Family
Marie Steiner
Katherine Tse
Union of BC Municipalities
Erich Vogt
Warnham Estates
Westbank Projects Corporation
Colette Wickstrom
Charlie Yang

\$1,000 - \$9,999

Kay Allan
Colette Anderson
Jack Anderson
Bank of Montreal
Monty Bruce
Canadian Medical Association
Ian Coffin
Terry Coffin
CPAWS
Robb Dunfield
Janice Elliott
Fairmont Hotels
Nick & Bessy Ferris
Lucy Fisher
Lee Houghton
John & Liz Irving
Bruce & Neil Jensen
Hugh D. Jones
Barbara Kelly
Frank P. Kelly
Howard Kelsey
Sarah Kim
Terry Kornutiak
David Kornutiak
Jennifer McRae & Kara Lam
Anthony Longcake
Beth Macdonald
Emily and Sarah Jane Mah
The McQueen Family
David Monaghan
Richard Moore
Kenneth G. Nelson
Olena Nogayeva
Michael Overholt
Peterson Investments
The Preston Family & Friends
Ron Putzi
Betty Ratcliffe
Friends of Dana Stephenson
Georgina (Geordie) Stowell
Ian Scottie Thomson
Gerald R. Tincher
Chikako Vanden Heede
William Wall
Betty Wong
Lai Ping (Carmen) Woo
James & Claire Wright
Mikiko Yamamoto

DONOR SUPPORT

CREATING COMMUNITY THROUGH THE RESTORATION OF STANLEY PARK

The Park Board continues to receive financial support for Stanley Park. Throughout the past year, the Park Board held several events to recognize and thank its supporters.

Tree Planting Ceremony

To mark the one year anniversary of the windstorm and to recognize the Federal Government, Provincial Government, City of Vancouver and Jim Pattison, a tree planting ceremony was held on December 15, 2007. Four trees were planted that represent the trees found in a mature West Coast Rain Forest — a Western Red Cedar, a Douglas Fir, a Grand Fir and a Sitka Spruce.



"Stanley Park is a special place for me and a lot of other folks - family picnics, fish & chips, swimming, church picnics - it's like part of the family!" Mr. Jim Pattison

Cheque Presentations

Throughout the year, individuals, corporations and community groups presented cheques to the Park Board.



"Stanley Park is important to British Columbians as a place of recreation and respite, a cherished downtown green space. Creating the Stanley Park special issue was our way of celebrating this incredible place by raising awareness and raising money for the park." Anita Willis, Editor, British Columbia Magazine

Tours

The Park Board hosted tours that focused on the clean-up work in the major blowdown area near Prospect Point and the work undertaken to protect wildlife habitat and forest ecology.

RECOGNIZING YOUR SUPPORT

The Park Board gratefully acknowledges the following for their support of Stanley Park. For a complete list of restoration donors, please visit our web site at vancouverparks.ca and click on Donations.

\$1,000,000 & Above

Government of Canada
Province of British Columbia
City of Vancouver
Jim Pattison

\$250,000 - \$999,999

Community Care and Advancement Association (Johnny Kwan Hok Fong, Shun So, Shek Kwong Leung, Cheng Jia Huang, Kwok Chun Yu, Zhan Wei Hao, Hua Chen)
HSBC Bank Canada

\$100,000 - \$249,999

Best Buy Canada Ltd.
Future Shop
Super Save Group
Teck Cominco Limited
Telus

In-Kind Donations

Association of BC Forest Professionals
Brinkman & Associates
Reforestation Ltd.
Cyril Seme
Daniel Hospitality Group
Finning International Inc.
Global BC
Greater Vancouver Regional District - Watershed Division
Interfor
Kerr Wood Leidal Associates Ltd.
N.A.T.S. Nursery Ltd.
PRT Group
Simon Fraser University
Thurber Engineering Ltd.
Timberline Natural Resources Group
UBC - Faculty of Forestry

\$50,000 - \$99,999

Fasken Martineau DuMoulin LLP
Goldcorp Inc.
Granville Island Brewing
Timothy C. Kerr Family Foundation

\$10,000 - \$49,999

Bank of Montreal
British Columbia Ferry Services Inc.
British Columbia Magazine
Burlington Northern Santa Fe Foundation
Coast Capital Savings Credit Union
David & Dorothy Lam Foundation
David Oppenheimer Family & The Oppenheimer Group
Diageo Canada Inc.
Enbridge Inc.
First Quantum Minerals Ltd.
General Motors of Canada Limited
Golder Associates Ltd.
Great Canadian Casinos Inc.
Hbc Foundation
Honda Canada Inc.
Liberty Investments Limited
Phillips, Hager & North Investment Management Ltd.
RBC Foundations
Spectra Energy Transmission
Spirit Wrestler Gallery
Taiga Building Products
TD Bank Financial Group
The Christopher Foundation
The Globe and Mail
Vancouver Aquarium Visitors, Staff, Volunteers & Board
Vancouver City Savings Credit Union
Winners Merchants International L.P.

\$2,000 - \$9,999

A.J. Pottinger and Associates
Alma Running Room Run Club
Suzanne Anton
Eveline Burman
Canyon Dental Centre
Delta Land Development Ltd.
Jerry Dres & Maria Gikas Dres
Focus Real Estate Marketing Systems
Timothy Edward Fraser
Gowling Lafleur Henderson LLP
Great Canadian Railtour Company Ltd.
Janet & Ernie Hammond
Hemlock Printers Ltd.
Holborn Group
Ian Tan Gallery
Imperial Parking Canada Corporation
Intergulf Investment Corporation
IRIS the Visual Group
J.A. Woollam Foundation
John & Diane Norton
JTB International (Canada) Ltd.
Milton & Judith Krieger
Leede Financial Markets Inc.
London Drugs Limited
John & Rosemary MacDougall
Millennium Group
Marti Oppenheimer
Pacific Palisades Kimpton Hotels
Pan Pacific Vancouver
Pedersen Rentals Ltd.

DONOR SUPPORT

PricewaterhouseCoopers
Florence Rampton
Shato Holdings Ltd.
Sequoia Company of Restaurants Inc.
Total Marine Logistics Inc.
Townline Homes Inc.
Vancouver Canadians Baseball Club
Vancouver Hotel Association
Vancouver Port Authority
Wesgroup Properties LP
W Redevelopment Group Inc.
Dr. Edward & Mrs. Eugenie Yeung

\$2,000 Tree Dedications

Megan Abbott
Arrow Transportation Systems Inc.
Brian Barr
Sandra Barry
Heather Betel
British Columbia Investment
Management Corporation
Canadian Union of Postal Workers
(CUPW) Local 846, Vancouver
Certified General Accountants
Association of Canada
Christopher Cottier
Yvonne V. Couling
County of Wellington -
Green Legacy Programme
J. Crofton
Martin & Debra Davis & Family
Ken F. Downie
Eminence Organic Skin Care Inc.
Executive Strategies
Feathercraft Products Ltd.
Gini Fitzgerald
Faye & Klaus Gronemeyer
GWL Realty Advisors
Highbury Foundation
Shirley Kasper
Kellogg's Dieticians of Canada
M.J. Korenberg
KPMG LLP Canada
Yuki Kurozumi
George Laycraft
Emily & Sarah Jane Mah
Robert McGlashan
Norman & Kory McLeod
Peter O'Sullivan
Scott Pearl
Jane Pritchard
Janet Lynn Ray
Christine Regehr
Standard Life

A.D.P. Stanley
The Sunny Sundays Picnic-ers
Mary Margery Taylor
Dr. Margaret Tran
Harden Tumber
Vancouver Magazine
Praveen & Anuja Varshney & Family
Donald Warren
West End Co-ed Slowpitch League
John & Susan Wilson
William Robert "Bob" Woerner
Chan Park-Sing, Fung Wan
& Ng Yuk-Chun
Molly & Daniel Yochlowitz
Wei Min Zeng

\$2,000 Tree Dedications In-Memory or In-Honour of

Gwen (Maya) Anderson
Audrey
Angela M. Dobinson
Herbert Escher
Richard & Hazel Gales
Sherri (McInnis) Hobden
Evelyn Huberman
Fred & Ella Kurrein
Merton & Bette Lechtzier
Gertrude Lord (nee Bickell)
Bob "the Jogger" McCallum
Drs. Simon & Margaerat Sutcliffe
& Family
Tenants at Westview Shopping Centre,
North Vancouver
Tenants at 171 West Esplanade,
North Vancouver
Alma Hampton Ward
Elizabeth Williams
Otto & Wilhelmina Wittenberg

\$1,000 - \$1,999

Ameresco Canada Inc.
Leopold Amighetti
Sheila Bannister
Clive Boness
Peter M. Brown
Don J. Chadderton
Phil Chernoff
Leila Chorley
Coastal Victory Church
Lori Cohen
Commonwealth Insurance Company
Credit Union Central of BC
Joseph Cvetkovich
Delco Fireplaces Ltd

Delta Cedar Products Ltd.
Dexter Associates Realty
Elise F. Drake
Caroline Duncan
Durante Kreuk Ltd.
E.I. Wintemute Holdings Corp.
Norma & John Gallop
Dr. William Gibson
Ronald & Ethel Govier
Graminae Holdings Ltd.
Trevor Hammond
Harry Rosen Inc.
Helen Hatch
Herbert Spencer Elementary School
Intrawest ULC
Iron Mountain Canada Corporation
Vicki Jermyn
Sherron Kane
Kara Resources Ltd
Kronier & Sparrow
Lawson Lundell LLP
Natalie Leung
Shui Chun Leung
Live Earth Network
Living Earth Eco Tours
Keith Lowell
Stephen MacAdams
Mainland Sand & Gravel
Gwynneth Marsh
Master Gardeners Association of BC
Shelagh McClenahan
Denise McIntosh
Mel C. Marshal
Industrial Consultants Inc.
Brenda Newby
Jeanne Padmore
PCL Constructors Westcoast Inc
Please Mum
Red Square Fashions Ltd.
A. Rehkatsch
Graham & Candice Robins
Norma & Jack Ross
Bob Russell
Glenn Schultz
Beverly Shaw
John & Constance Southcott
Bill & Diane St. John
Sutton Group - Seafair Realty
Tourism Vancouver
Norma Van Der Merwe
Richard Whittall
Sheryl Williamson-Harms
Paul & Nancy Wilson

MANAGING RESOURCES

OPERATING BUDGET FOR THE YEAR ENDING DECEMBER 31, 2007

Keeping budgets under control and facilities operating efficiently are priorities. The Park Board continually looks to develop new, creative and responsible ways to add revenue and augment core business, while providing better service and meeting future needs.

The Park Board's operating budget, \$77.8 million in 2007, pays for day-to-day park and recreation programs, as well as care and maintenance of more than 3,000 acres of open space and over 40 acres of enclosed space. In 2007, tax support from the City of Vancouver contributed 63.6% of the Park Board's operating budget, while user fees and charges generated the remaining 36.4%.

In 2007, fees and charges generated \$28.2 million. \$8.7 million of this was raised through admission fees paid at rinks, pools and Park Board run fitness centres. These fees partially offset the cost to

provide recreation services in the community at local community centres, rinks, pools and fitness centres. Local Community Associations also contribute to the delivery of recreation services through our partnership agreement to jointly deliver programs at recreation centres.

The Board's parks also generate funds toward their upkeep, with \$2.3 million generated in 2007 from activities in the three "destination parks": Stanley Park, Queen Elizabeth Park and VanDusen Botanical Garden.

Other revenues are raised through the Board's income oriented services, such as golf, parking, concessions, marinas and lease agreements with restaurants and other service providers. These services generate surplus funds which pay for the services

Think of all the amazing parks and recreation facilities, services and programs in our City. On average, each resident of Vancouver contributed \$81 last year towards Park Board programs and maintenance of parks and recreation facilities.

FINANCIALS

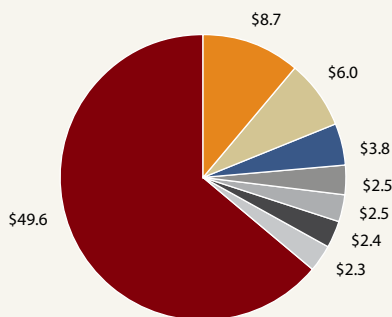

WHERE OUR MONEY CAME FROM (in millions)

Community Centres, Pools, Rinks, Fitness	\$8.7
Golf Courses (including Pitch & Putt)	6.0
Parking	3.8
Concessions	2.5
Leases & Other	2.5
Marinas	2.4
Stanley Park, VanDusen, Bloedel	2.3
Subtotal	\$28.2
City of Vancouver	\$49.6
Total Revenues	\$77.8

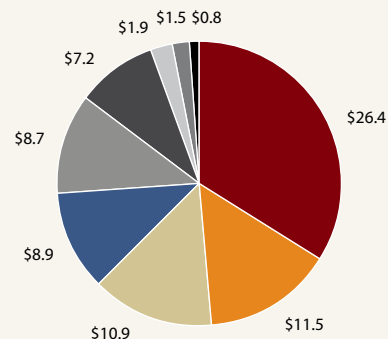

WHERE OUR MONEY WAS SPENT (in millions)

Community Centres, Pools, Rinks, Fitness	\$26.4
Neighbourhood Parks & Arboriculture	11.5
Maintenance	10.9
Administration, Planning, Leases	8.9
Golf Courses (including Pitch & Putt)	8.7
Stanley Park, VanDusen, Bloedel	7.2
Concessions	1.9
Marinas	1.5
Parking	0.8
Total Expenditures	\$77.8

themselves and provide support for other parks and recreation programs and maintenance. In 2007 these income oriented services generated \$17.2 million in revenues.

Of the \$77.8 million spent by the Park Board in 2007 on day-to-day operations, \$26.4 million went toward the cost of running recreation programs and maintaining our community centres, rinks, indoor and outdoor pools and fitness centres. A further \$18.7 million was spent on maintaining neighbourhood parks, street trees and the three destination parks. Spending on income oriented services totalled \$12.9 million, with most of those funds spent on the upkeep of the golf courses and pitch and putts. The remaining \$18.9 million was spent on building and facility maintenance, administration, planning and lease expenses.

In 2007, the costs for providing these services and the revenues generated were significantly impacted by the twelve week work stoppage. Services to the public were reduced and the 2007 financial results are not typical.

Revenues were below budget in all areas except marinas, leases and cost recovery operations in arboriculture, facility and park maintenance. Expenses were below budget in all service areas due to savings from the work stoppage. At year end, the Park Board had financial savings of \$3.4 million attributable to the labour disruption.

Thanks to our restaurants, parking operations and community partners for their financial contribution and valued services. Thanks are also due to our customers, partners and Vancouver residents for their patience with the disruption to services resulting from the civic strike.

TRACKING PROGRESS

REVENUES

The Park Board works to reduce its reliance on taxes and increase revenues from user fees and business operations

2007 performance indicators are affected by the 12 week work stoppage

Share of total operating budget not funded by taxes

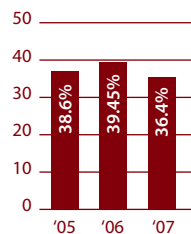

PHOTO

The Park Board promotes, protects and manages our diverse urban forest to ensure a more beautiful and liveable city. The arboriculture staff care for thousands of trees on streets and in parks each year. The most common street tree is the Japanese flowering cherry with its spectacular Spring display.



MANAGING RESOURCES

CAPITAL BUDGET FOR THE YEAR ENDING DECEMBER 31, 2007

Capital funds are used to acquire, construct, maintain and renew the Park Board's large, diverse system of buildings and open spaces and the city's street trees.

The Park Board's Capital Plan serves three basic purposes:

- To maintain the existing Park Board parks and buildings (the Board is responsible for more than 200 of each). Examples would include repairing or replacing worn out features;
- To improve services to meet the changing leisure needs of the population, such as providing areas for Tai Chi and for skateboarding; and
- To expand services to meet the needs of a growing population, including the addition of new park space in park-deficient areas of the city and the construction of larger community centres.

Every three years a Capital Plan is voted on by the electorate as part of the civic election process.

Development of the Park Board Capital Plan is a challenging task involving the evaluation of many proposals against a total funding envelope determined by City Council. City Council sets the size of the entire civic capital plan, including the total funds allocated for the Park Board Capital Plan, and the Board is responsible to decide which projects to undertake within that envelope. Both the Board and Council receive technical advice and resident input on the decisions that need to be made.

The current Capital Plan covers the period from 2006 to 2008, and the Park Board portion totals \$115 million. Usually the Board's Capital Plan is divided into three main categories:

- Parks
- Land acquisition and development for new parks
- Facilities (community centres, rinks, pools, etc.)

FINANCIALS

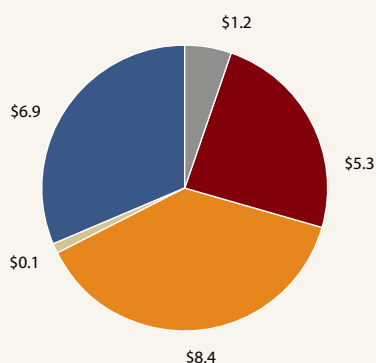

2007 CAPITAL EXPENDITURES (in millions)

Facility Development	\$5.3
Land Acquisition & Planning	0.1
Park Development	6.9
Legacy	8.4
Overhead (Project Management & Admin)	1.2
Total Program Expenditures	\$21.9

ANNUAL CAPITAL EXPENDITURES (in millions)
Five Year History

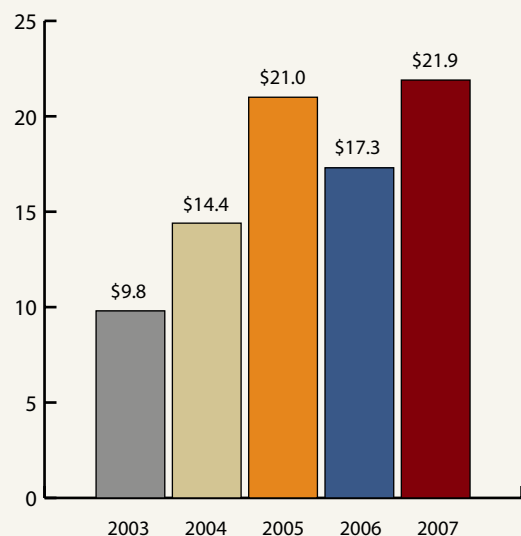

For the 2006 to 2008 plan, there is also a fourth category for the major construction related to the 2010 Winter Games which will leave a legacy of new community facilities.

In 2007, the expenditures totalled \$21.9 million for a number of significant parks and recreation projects. Capital projects usually span several years, so the spending in any one year does not necessarily reflect the total cost of a project. 2007 highlights were:

- Sunset Community Centre \$3.8 million
- Air India Memorial \$857,000
- Artificial Turf Fields \$3.1 million
- Neighbourhood parks \$2.2 million
- Hillcrest Park Legacy Facility \$2.0 million
- Trout Lake Rink \$952,000
- Killarney Rink \$1.7 million
- Percy Norman Aquatic Centre \$3.8 million

Vancouver residents care about parks and recreation! When the Park Board asked for submissions from the public during the development of the upcoming 2009-2011 Capital Plan, we received 52 different proposals for projects at more than 40 locations across the city.

TRACKING PROGRESS

CONTRIBUTIONS
Financial contributions from community groups and governments allow the Park Board to do more with less dependence on municipal taxes.

2007 performance indicators are affected by the 12 week work stoppage

Capital Donations

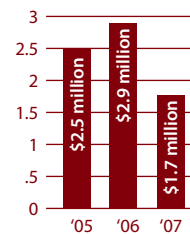

PHOTO

The Park Board's main administration office, located at the entrance to Stanley Park, is a Class A Heritage building. Known for its unique Atlantic Cedar tree growing flat on the outside granite wall, 2099 Beach Avenue is home to regular public meetings at which the elected Board discusses reports, reviews policies and projects, and plans for the future of parks and recreation.



MANAGING RESOURCES

DONATION FUND FOR THE YEAR ENDING DECEMBER 31, 2007

2007 marked another successful year for the Park Board's Donation Program, thanks to our generous donors and supporters.

In 2004 the Park Board's Donation Program was reviewed and expansion of the program was made a priority. Changes were implemented to increase public awareness, streamline and expand the existing program, improve customer service levels, and explore and implement new fundraising opportunities for the Park Board and its community partners. Since that time, the donation program has grown and our 2007 donations reflect the continuing generosity of our donors and supporters.

In addition to the donations received for the Stanley Park Restoration Fund, which are reported separately in this Report, the Park Board had the pleasure of working with many individuals and organizations to support other park and recreation activities. Including both donations and interest, almost \$900,000 was contributed in 2007 to the three donation

priorities: Park Amenities, Special Projects and Endowments.

PARK AMENITIES

The Commemorative Gifts program received over \$450,000 in 2007 and continues to be a designation of choice for residents and visitors who wish to donate as a tribute to a loved one. This program funds new and replacement benches and picnic tables in neighbourhood and destination parks and along the Seawall.

SPECIAL PROJECTS

Over \$300,000 was designated during 2007 in support of special projects ranging from sport court and playground upgrades to the creation of new programs at Park Board community centres.

ENDOWMENTS

Two years ago, the Park Board established an endowment program to provide ongoing and sustainable funding for park conservation and recreation programs. In 2007, three new endowments totaling almost \$130,000 were established, with funds designated for support of park conservation projects.

FINANCIALS

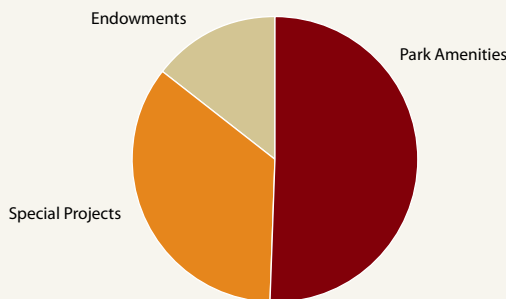

2007 CONTRIBUTIONS BY PROGRAM (in thousands)

Park Amenities	\$453
Special Projects	312
Endowments	129
Total Contributions	\$894

ANNUAL GROSS CONTRIBUTIONS (in millions)
Five Year History

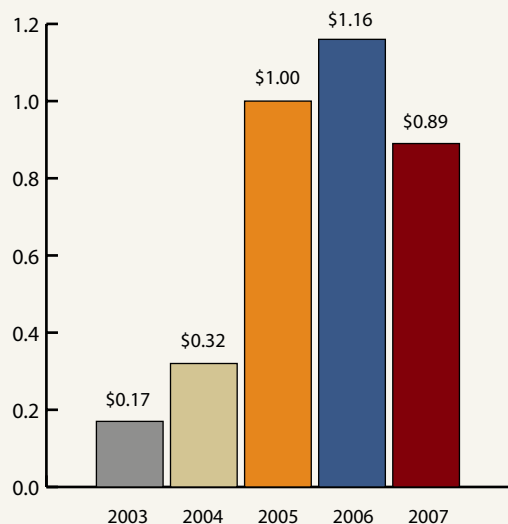

**STANLEY PARK RESTORATION FUND
FOR THE YEAR ENDING DECEMBER 31, 2007**

The Stanley Park Restoration Fund received almost \$8.5 million in contributions by the end of December 2007. This included \$5.0 million from three levels of government and over \$3.1 million from individuals and corporations.

As of December 31, 2007 a total of \$3.0 million has been spent on the restoration project, including \$567,000 for public consultation and plan development to guide the overall vision of the restoration of the park.

Over \$2.1 million has been spent on forestry work, with \$361,000 used in the immediate aftermath of the storm for emergency clean-up work. Since that time \$310,000 has been spent consulting with forestry experts and determining a work plan, while

a further \$1.4 million was used to carry out the required site clearing, site preparation and related forestry work.

A further \$351,000 has been spent on Seawall repairs, escarpment stabilization and park roads and pathways. By the end of December 2007, the legacy program work had just begun with expenditures of slightly less than \$3,000.

At the end of 2007 a balance of over \$5.4 million remains in the fund for future restoration work. Spring 2008 expenditures for Prospect Point redevelopment are expected to cost approximately \$2 million and the long-term Seawall repairs are expected to cost approximately \$1 million. Further forestry work and planting completion for the park will cost approximately \$750,000. The estimate for the legacy program remains at \$750,000. The overall project costs will remain within the currently approved budget and, barring future unseen delays, will be completed approximately two months beyond the initial schedule estimations.

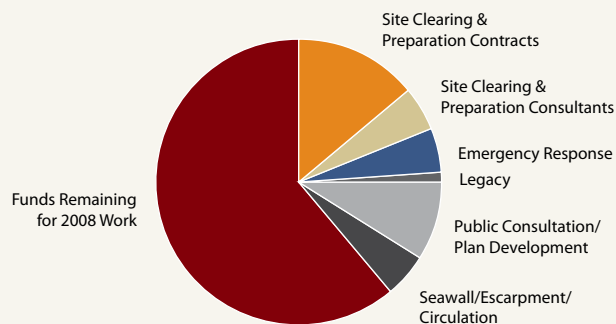
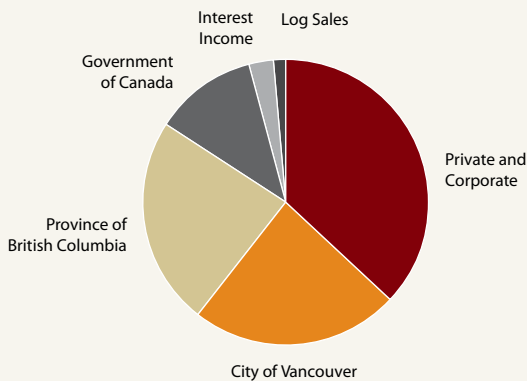

CONTRIBUTIONS TO DEC 31, 2007 (in thousands)

Donations: Private and Corporate	\$3,135
City of Vancouver	2,000
Province of British Columbia	2,000
Government of Canada	1,000
Interest Income	227
Log Sales	107
Total Contributions	\$8,469

EXPENDITURES TO DEC 31, 2007 (in thousands)

Forestry:	
Site Clearing & Preparation Contractors	\$1,430
Site Clearing & Preparation Consultants	310
Emergency Response Legacy	361
Legacy	3
Public Consultation/Plan Development	567
Seawall/Escarpment/Circulation	351
Total Expenditures	3,022
Funds Remaining for 2008 Work	\$5,447

COUNTDOWN: FROM 2010 TO COMMUNITY LEGACIES

The Park Board is working to maximize the unique opportunities and benefits from the Vancouver 2010 Olympic and Paralympic Winter Games.

A PROUD AND ACTIVE PARTNER

Partnering with the City and VANOC to plan and host the 2010 Winter Games, the Park Board is developing venues, engaging residents and working on projects to 'welcome the world'. We are creating a lasting legacy of new and improved facilities while supporting recreation, fitness and the arts.

VENUES TAKE SHAPE

Following extensive consultation, planning and design work, construction began on three Park Board facilities to be used for the 2010 Winter Games, after which they will become more than \$100 million of new recreation legacies for residents. The buildings were designed to high environmental standards, with many sustainable features inside and out.

In 2007, building started on the competition venue for both curling and wheelchair curling at Hillcrest Park. After the 2010 Winter Games, it will be converted to a new recreation complex with a community centre (replacing Riley Park), ice rink, branch library, curling club and offices. Being built at the same time is a new aquatic centre with indoor and outdoor pools (replacing Percy Norman) connecting to the new centre. Completion for 2010 Winter Games use will be by December 2008 in time for test events. The new multi-purpose complex will open to the public in 2011.

Construction also began at Trout Lake Ice Rink, which is being rebuilt as the figure skating practice arena for the 2010 Winter Games (after the Games, the ice sheet will be reconfigured from international to NHL size for recreational skating and hockey; completion will be in Fall 2009) and at Killarney Ice Rink, which is being reconstructed to be used as the short track speed skating practice arena (it will also be changed to NHL mode and a new lobby will connect the rink to the community centre and pool; completion will be in Spring 2009). Some community use for both ice rinks is planned before the Olympics.

BUILDING EXCITEMENT AND PRIDE

The Park Board participated in the second year of Olympic countdown celebrations, with colourful groundbreaking ceremonies at the Hillcrest venue taking place in March.

Use of Yaletown's David Lam Park was approved as one of the two Olympic Live Sites, offering free public access to 2010 events, ceremonies and entertainment.

Consultation and idea workshops began with key stakeholders and partners, starting with Community Associations, on ways to involve neighborhoods in local events leading up to and during the 2010 Winter Games.

The Park Board also participated in the City's "Measuring Up" project, assessing how to make communities more accessible and inclusive by 2010.

PHOTOS

The construction of the Vancouver Olympic Centre/Vancouver Paralympic Centre, the competition curling and wheelchair curling venue for the 2010 Winter Games, will leave a lasting sports legacy for the city.

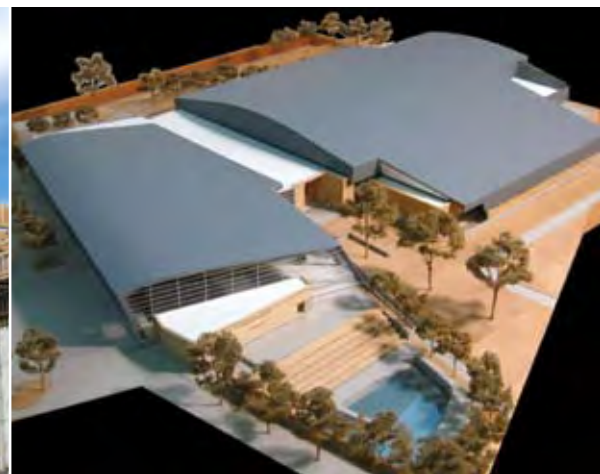

WRITTEN AND DESIGNED BY
Park Board Communications

COVER
New life in storm-battered Stanley Park is a symbol of the
restoration and renewal of Vancouver's evergreen heart.

PHOTOGRAPHERS
(Cover) Tilo Driessen
Tim Chow
Michel Desrochers
Scott Groves
Kent Kallberg
Rene Lemckert
John Maxey
Grant Oberg
Josie Riebe
Christina Lazar-Schuler
Stanley Park Ecology Society
Virgil Soh

Printed on recycled paper 

COPYRIGHT
Vancouver Board of Parks & Recreation, 2008

This publication is also available in Chinese at your local community centre.

您當地的社區中心有提供這刊物的中文版本。

This book contains information about the Vancouver Park Board's services and achievements in parks and recreation during the past year. Please translate it for family members who cannot read English or Chinese.

Ce livre contient des renseignements concernant les services et les réalisations du Vancouver Park Board en matière de parcs et de loisirs durant l'année écoulée. Veuillez le faire traduire pour les membres de votre famille qui ne lisent pas l'anglais.

ਇਸ ਕਿਤਾਬ ਵਿਚ ਵੈਨਕੂਵਰ ਪਾਰਕ ਬੋਰਡ ਦੀਆਂ ਸੇਵਾਵਾਂ ਅਤੇ ਪਿਛਲੇ ਸਾਲ ਵਿਚ ਪਾਰਕਾਂ ਅਤੇ ਮਨਬਹਿਲਾਵੇ ਸੰਬੰਧੀ ਹੋਈਆਂ ਪ੍ਰਾਪਤੀਆਂ ਬਾਰੇ ਜਾਣਕਾਰੀ ਹੈ। ਮਿਹਰਬਾਨੀ ਨਾਲ ਇਸਦਾ ਅਨੁਵਾਦ ਕਰਕੇ ਆਪਣੇ ਪਰਿਵਾਰ ਦੇ ਉਹਨਾਂ ਮੈਂਬਰਾਂ ਨੂੰ ਦੱਸੋ ਜੋ ਅੰਗਰੇਜ਼ੀ ਨਹੀਂ ਪੜ੍ਹ ਸਕਦੇ।

Este libro contiene información acerca de la Comisión de Parques de Vancouver y sus servicios y logros en el área de parques y recreación durante el año pasado. Se le ruega traducirlo para aquellos miembros de su familia que no leen inglés.

Tập sách này có chi tiết về các dịch vụ và thành quả về công viên và giải trí trong năm qua của Hội Đồng Công Viên Vancouver. Xin dịch cho những người trong gia đình không đọc được Anh ngữ.

PEOPLE, PLACES AND PARKS



Vancouver Board of Parks & Recreation
2099 Beach Avenue, Vancouver, British Columbia, Canada V6G 1Z4

Tel: 604.257.8400 | Fax: 604.257.8427

vancouverparks.ca