

LEGEND

- HC - HOUSE CURTAIN (NO SALLONES)
- EL - FIRST ELECTRIC (FLYING HEIGHT 28' MAX)
- ET - GREY TRAVELLER
- BL - BLACK BOARD
- BL - BLACK LEGS (RETURN ARMS MOVABLE)
- BL - BLACK BICOINER
- CT - CHAIRS
- EA TO EA - NON-HARD WIRED ELECTRIC
- PC - PINE CURTAIN
- PI - PINE PL. 1" TO 24" LONG (4" DIA) 2"
- AM - AMPHIB CAPACITY - 300 LAB.
- FL - FLYING HEIGHT - 45' MAX

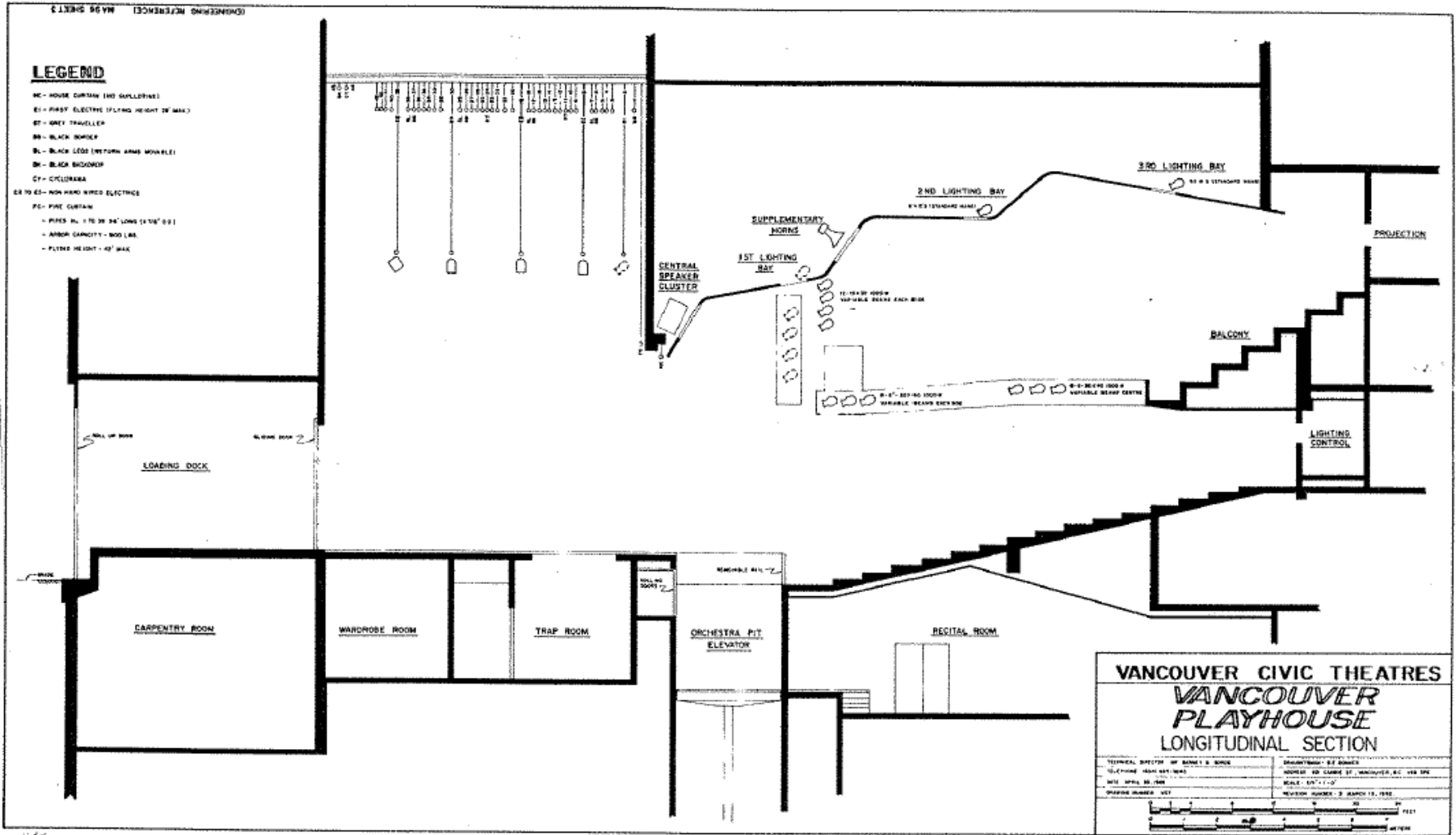

**VANCOUVER CIVIC THEATRES
VANCOUVER
PLAYHOUSE
LONGITUDINAL SECTION**

TECHNICAL DIRECTOR: HENRY B. BOWEN	ARCHITECT: H. B. BOWEN
TELEPHONE: 484-1111	ADDRESS: 600 CLARKE ST., VANCOUVER, B.C. V6B 5K6
DATE: APRIL 20, 1956	SCALE: 1/4" = 1'-0"
DRAWING NUMBER: 101	REVISION NUMBER: 2 MARCH 15, 1956

