

1:2000
SEASON NOTES
MATTHEWS GROUP

PROVISION OF SHOPS AND SERVICES:

- MISSING SERVICES (URINARY/PARKING)

TRANSPORTATION FACILITIES AND NETWORKS:

- NO CONNECTOR
- IMPACT OF SKYTRAIN EXTENSION
- STRUCTURAL IMPACT: SOUND, REDUNDANCY OF SERVICE, CROSSING UP MAIN STREET

TRAFFIC SAFETY AND PARKING:

- MORE PEDESTRIAN CROSSINGS NEEDED
- CHANGING STREETS W/ CARAVEN MEANS PEOPLE USE LANES AS TRAVEL
- RESTRICTION HOW STREETS AND LANES WORK TOGETHER
- CALM THE STREETS
- CONTRAST CAN MOVEMENT AT MAIN + BRUSHING
- LONGER CROSSING TIMES
- CREATE LIMITED PARKING FOR VISITORS IN ICPS

HERITAGE, CULTURE AND CHARACTER:

- LINE HERITAGE + INDUSTRIAL RESTRICTIONS
- CONSIDER CONTEXT, HEIGHT APPROPRIATELY
- CREATE SMALL, INTER-CONNECTED SPACES (i.e. PARK RESTAURANT)
- NEW BUILDINGS SHOULD CONSIDER RESTRICTION OF EXISTING BUILDINGS
- HERITAGE 'LOOK' - WHAT IS THIS IN THIS AREA (WHAT DOES IT MEAN?)
- VIEWS NORTH ARE IMPORTANT
- CONSIDER LIGHT + VIEWS + SHADOW FOR NEW BUILDINGS
- USE COURTYARDS - LOOKS + CREATIVITY

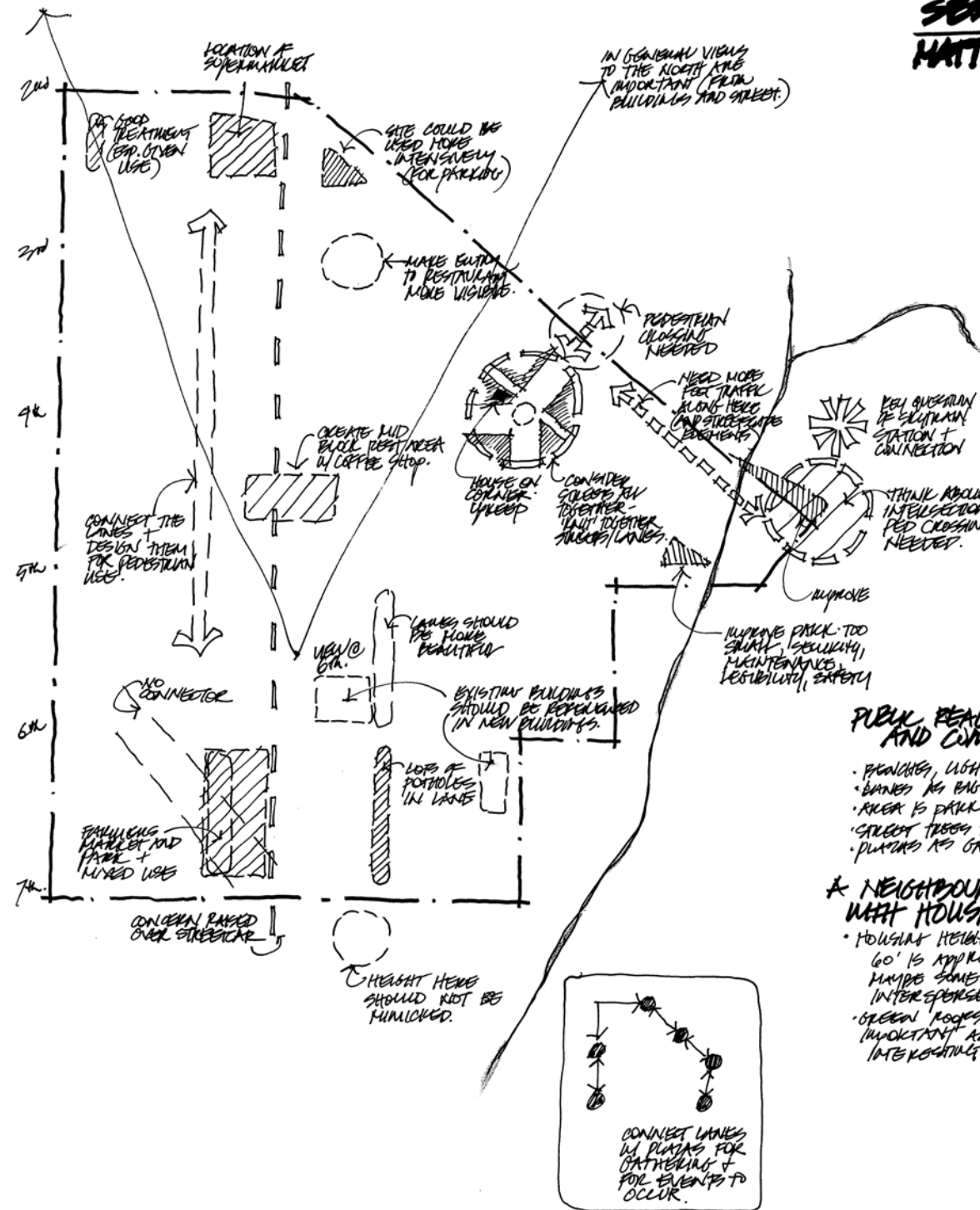

PUBLIC REALITY: AMENITIES AND COMFORT:

- PLANTING, LIGHTING
- BANKS AS BUS OPPORTUNITY
- RIVER IS PARK DEFICIENT
- STREET TREES TO PROVIDE UNITS
- PLAZAS AS GATHERING SPACE

NEIGHBOURHOOD CENTRES WITH HOUSING:

- HOUSING HEIGHT ON MAIN ST: 60' IS APPROPRIATE LIKE IN ICPS, MAYBE SOME 10 STOREY INTERSPERSED
- GREEN ROOFS + ROOF GARDENS ARE IMPORTANT AND SHOULD BE INTEGRATED