

ELEVATION AT POINT A1:

$$\left[\left(\frac{28.64' - 28.35'}{49.21'} \right) \times 23.76' \right] + 28.35' = 28.49'$$

ELEVATION AT POINT A2

$$\left[\left(\frac{43.96' - 41.08'}{65.62'} \right) \times 13.42' \right] + 41.08' = 41.67'$$

ELEVATION AT POINT A

$$\left[\left(\frac{41.67' - 28.49'}{132.25'} \right) \times 7.75' \right] + 28.49' = 29.26'$$

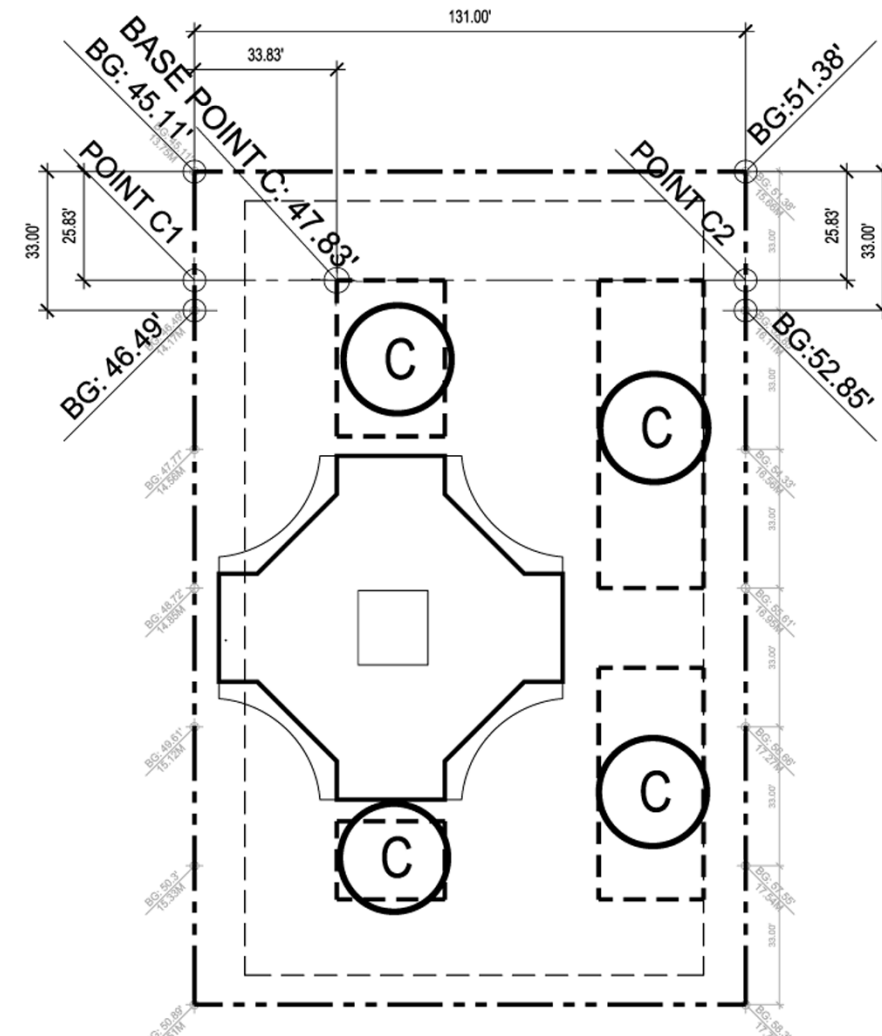
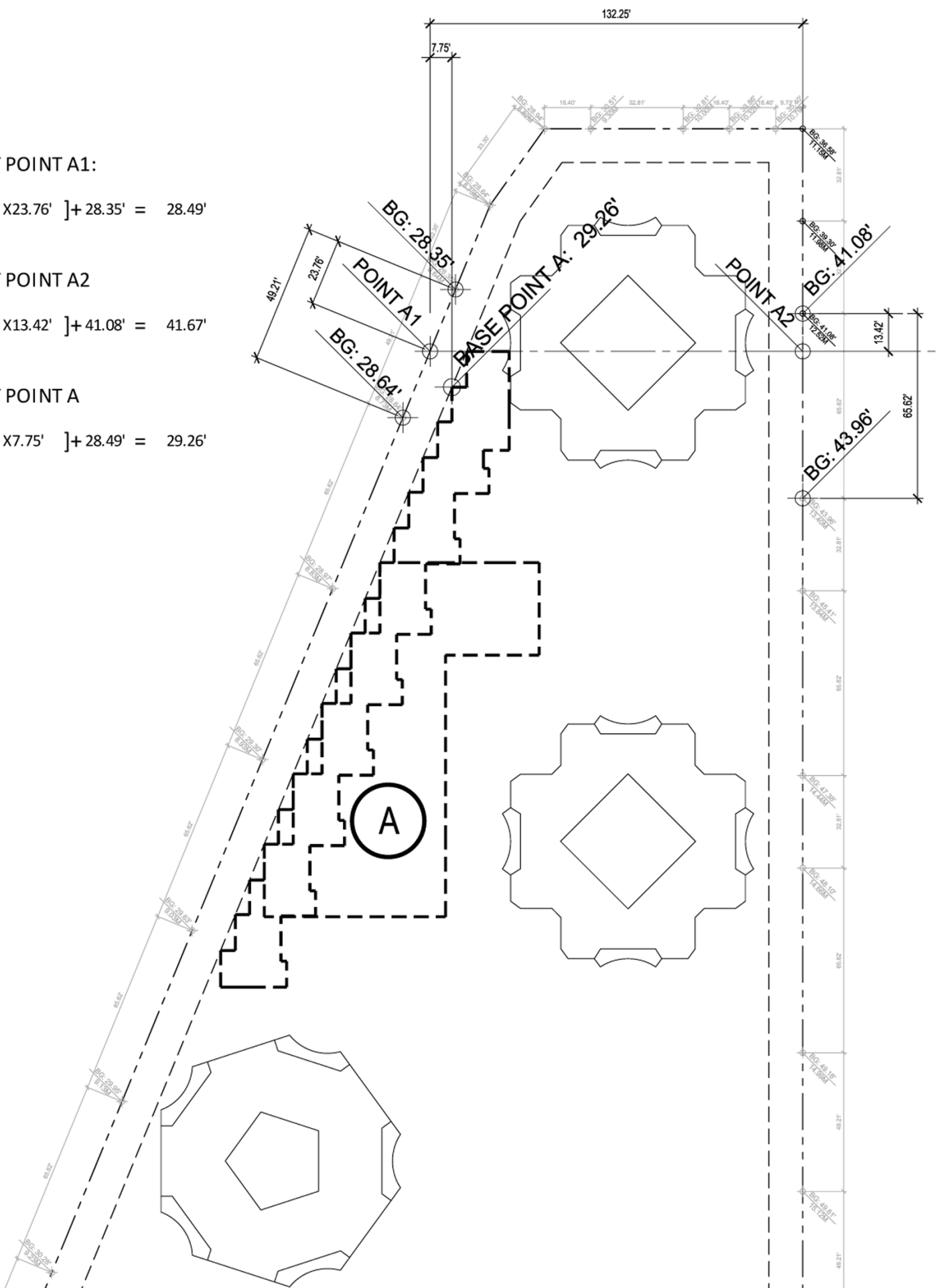

ELEVATION AT POINT C1:

$$\left[\left(\frac{46.49' - 45.11'}{33'} \right) \times 25.83' \right] + 45.11' = 46.19'$$

ELEVATION AT POINT C2

$$\left[\left(\frac{52.85' - 51.38'}{33'} \right) \times 25.83' \right] + 51.38' = 52.53'$$

ELEVATION AT POINT C

$$\left[\left(\frac{52.53' - 46.19'}{131'} \right) \times 33.83' \right] + 46.19' = 47.83'$$

	BASE POINT
BUILDING A	29.26'
BUILDING C	47.83'

SEAL:

- This drawing, as an instrument of service, is the property of the architect and may not be reproduced without their permission and unless the reproduction carries their name. All designs and other information shown on this drawing are for use on the specified project only and shall not be used otherwise without written permission of the architect. If these dimensions shall have precedence over scaled dimensions. Contractors shall verify and be responsible for all dimensions and conditions on the job and the architect shall be informed of any variations from the dimensions and conditions shown on the drawing. Shop drawings shall be submitted to the architect for approval before proceeding with fabrication.
- The general contractor shall verify all dimensions, details, and levels prior to commencement of the work and is held responsible for reporting discrepancies and/or corrections to the architect immediately.
- The drawing must not be scaled.

DATE REVISIONS BY



IBI GROUP
 IBI/HB Architects
 700-1285 West Pender Street
 Vancouver BC V6E 4B1 Canada
 tel 604 683 4376
 fax 604 681 2770
 Architecture □ Urban Land □ Transportation

PROJECT TITLE:
BEACH TOWERS

1600 BEACH AVE. & 1651 HARWOOD ST.
 VANCOUVER, BC

SHEET TITLE:
**BUILDING A & C
 BASE PLANE DIAGRAM**

JOB NO.: 26999
 DATE: November 4, 2011
 SCALE: NTS
 DRAWN BY: FX
 CHECKED BY: GV
 REV. NO.: —

NOTE: THIS DRAWING SUPERCEDES ALL ISSUES BEARING PREVIOUS REVISION NUMBER.

SHEET NO.: **RZ 2.06**

FILE ADDRESS: RZ 2.06 BUILDING A & C BASE PLANE DIAGRAM.dwg
 DATE LAST REVISED: November 4, 2011

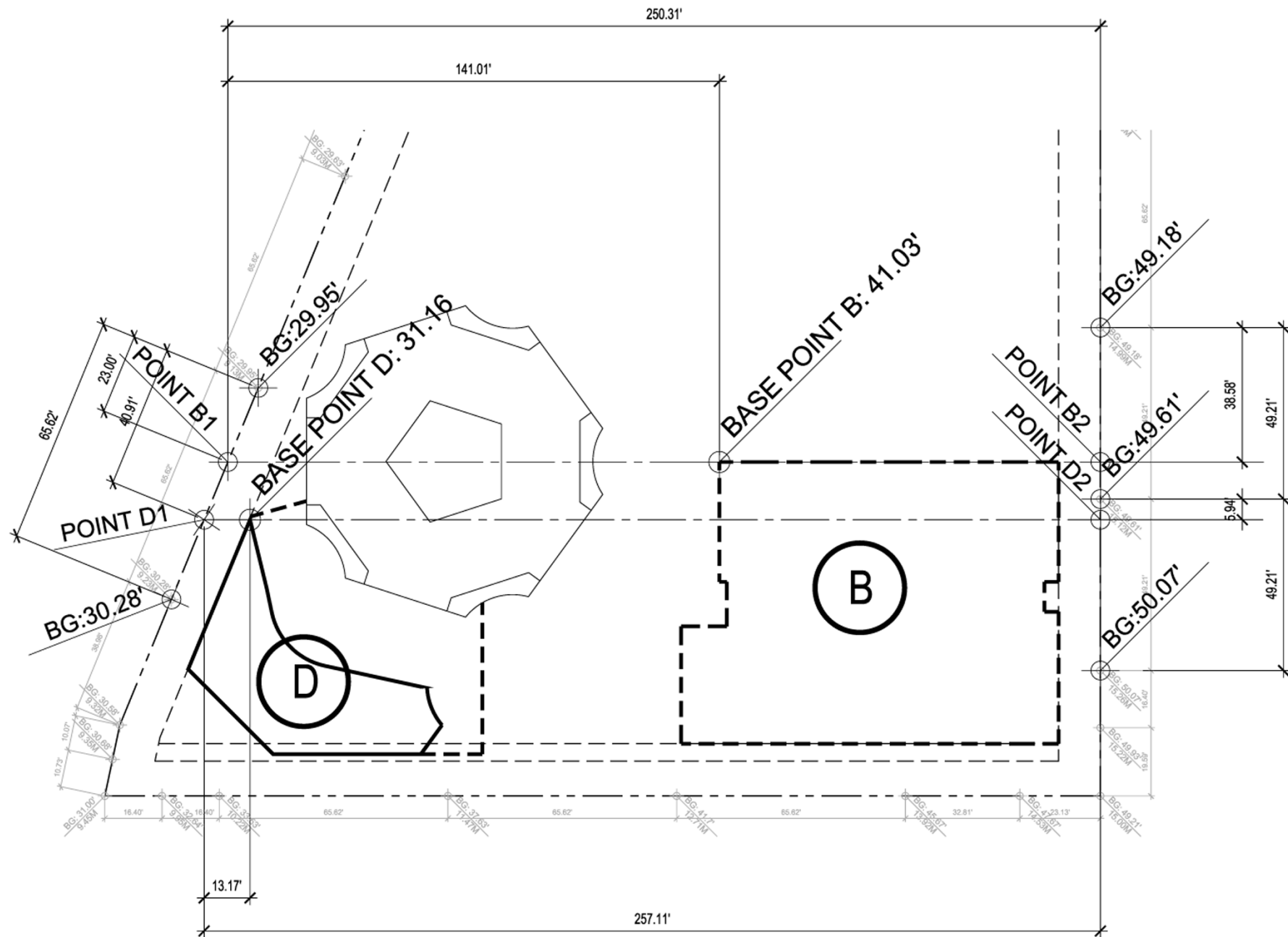

ELEVATION AT POINT D1:

$$\left[\left(\frac{30.28' - 29.95'}{65.62'} \right) \times 40.91' \right] + 29.95' = 30.16'$$

ELEVATION AT POINT D2

$$\left[\left(\frac{50.07' - 49.61'}{49.21'} \right) \times 5.94' \right] + 49.61' = 49.67'$$

ELEVATION AT POINT D

$$\left[\left(\frac{49.67' - 30.16'}{257.11'} \right) \times 13.17' \right] + 30.16' = 31.16'$$

ELEVATION AT POINT B1:

$$\left[\left(\frac{30.28' - 29.95'}{65.62'} \right) \times 23.00' \right] + 29.95' = 30.07'$$

ELEVATION AT POINT B2

$$\left[\left(\frac{49.61' - 49.18'}{49.21'} \right) \times 38.58' \right] + 49.18' = 49.52'$$

ELEVATION AT POINT B

$$\left[\left(\frac{49.52' - 30.07'}{250.31'} \right) \times 141.01' \right] + 30.07' = 41.03'$$

	BASE POINT
BUILDING B	41.03'
BUILDING D	31.16'

SEAL:

- This drawing, as an instrument of service, is the property of the architects and may not be reproduced without their permission and unless the reproduction carries their name. All designs and other information shown on this drawing are for use on the specified project only and shall not be used otherwise without written permission of the architects. These dimensions shall have precedence over scaled dimensions. Contractors shall verify and be responsible for all dimensions and conditions on the job and the architects shall be informed of any variations from the dimensions and conditions shown on the drawing. Shop drawings shall be submitted to the architects for approval before proceeding with fabrication.
- The general contractor shall verify all dimensions, details, and levels prior to commencement of the work and is held responsible for reporting discrepancies and/or omissions to the architects immediately.
- The drawing must not be scaled.

DATE REVISIONS BY



IBI GROUP
 IBI/HB Architects
 700-1285 West Pender Street
 Vancouver BC V6E 4B1 Canada
 tel 604 683 4376
 fax 604 681 2770
 Architecture □ Urban Land □ Transportation

PROJECT TITLE:

BEACH TOWERS

1600 BEACH AVE. & 1651 HARWOOD ST.
 VANCOUVER, BC

SHEET TITLE:

BUILDING B & D
 BASE PLANE DIAGRAM

JOB NO.: 26999
 DATE: November 4, 2011
 SCALE: NTS
 DRAWN BY: FX
 CHECKED BY: GV
 REV. NO.: --

NOTE: THIS DRAWING SUPERCEDES ALL ISSUES BEARING PREVIOUS REVISION NUMBER.

SHEET NO.: **RZ 2.07**

FILE ADDRESS: RZ 2.07 BUILDING B & D BASE PLANE DIAGRAM.dwg
 DATE LAST REVISED: October 28, 2011