

Issues

9 Jun 10 Issued for UDP Workshop
26 Jul 10 Issued for Rezoning

revisions

2 Jun 11 Revised Rezoning Submission
6 Oct 11 Revised Rezoning Submission

GENERAL NOTES:

- 20% of parking stalls to accommodate electric vehicles.
- Parking for Cultural and Recreation Uses (artist's production space), Service Uses (restaurant), and Retail Uses collectively labelled 'commercial'.

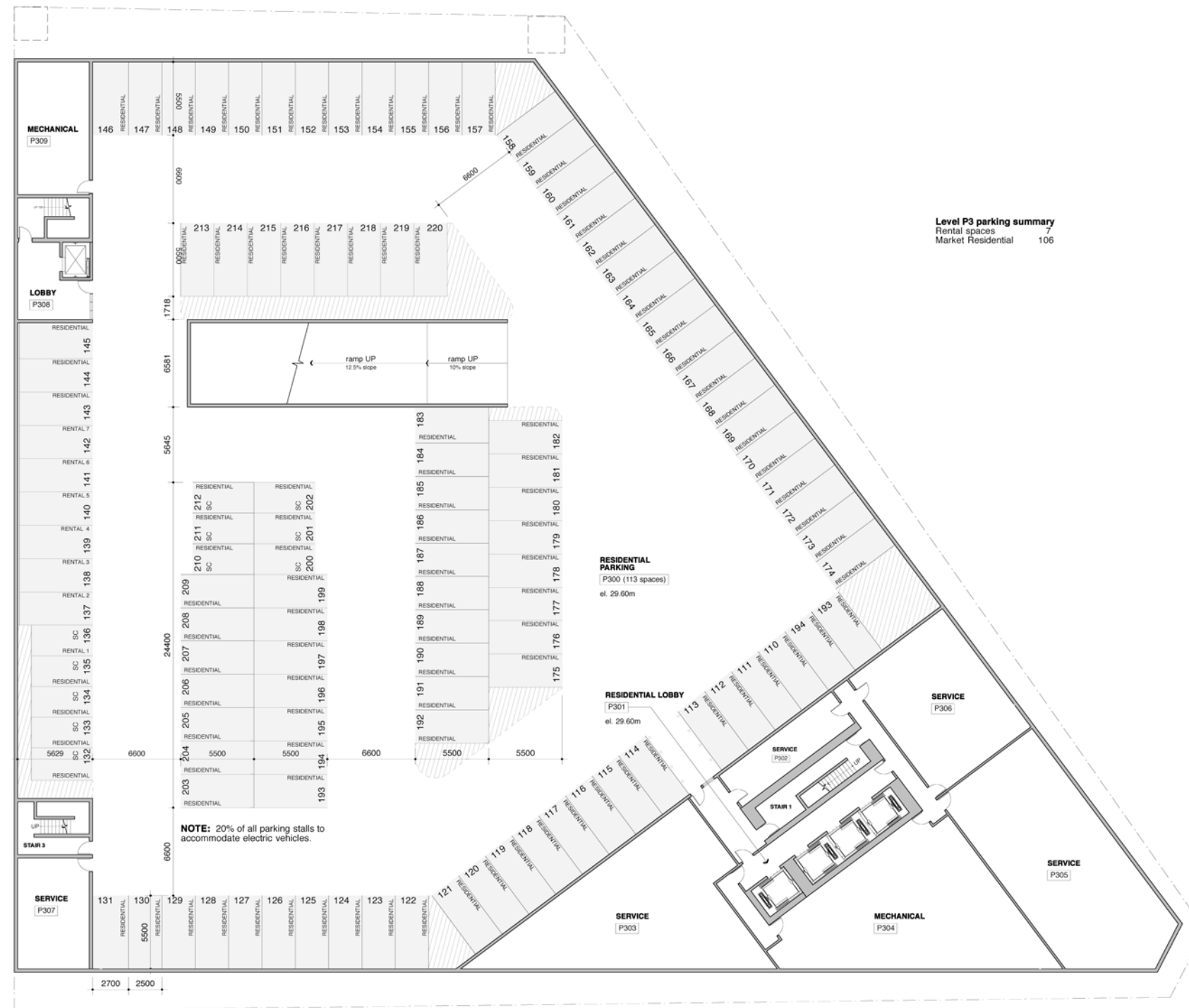

Level P3 parking summary
Rental spaces 7
Market Residential 106

ACTON OSTRY ARCHITECTS INC

111 E 8 Avenue
Vancouver BC
Canada V5T 1R8
t 604.739.3344
f 604.739.3355
info@actonostroy.ca

Kingsway + Broadway

Rize Alliance
Kingsway + Broadway

scale	date
1 : 200	6 Oct 11
project code	status
KWY	Rezoning
drawn	checked
WS	RA



Parking Level 3

drawing number
A1.01

Issues

9 Jun 10 Issued for UDP Workshop
26 Jul 10 Issued for Rezoning

revisions

△ 2 Jun 11 Revised Rezoning Submission
△ 3 6 Oct 11 Revised Rezoning Submission

GENERAL NOTES:

- 20% of parking stalls to accommodate electric vehicles.
- Parking for Cultural and Recreation Uses (artist's production space), Service Uses (restaurant), and Retail Uses collectively labelled 'commercial'.

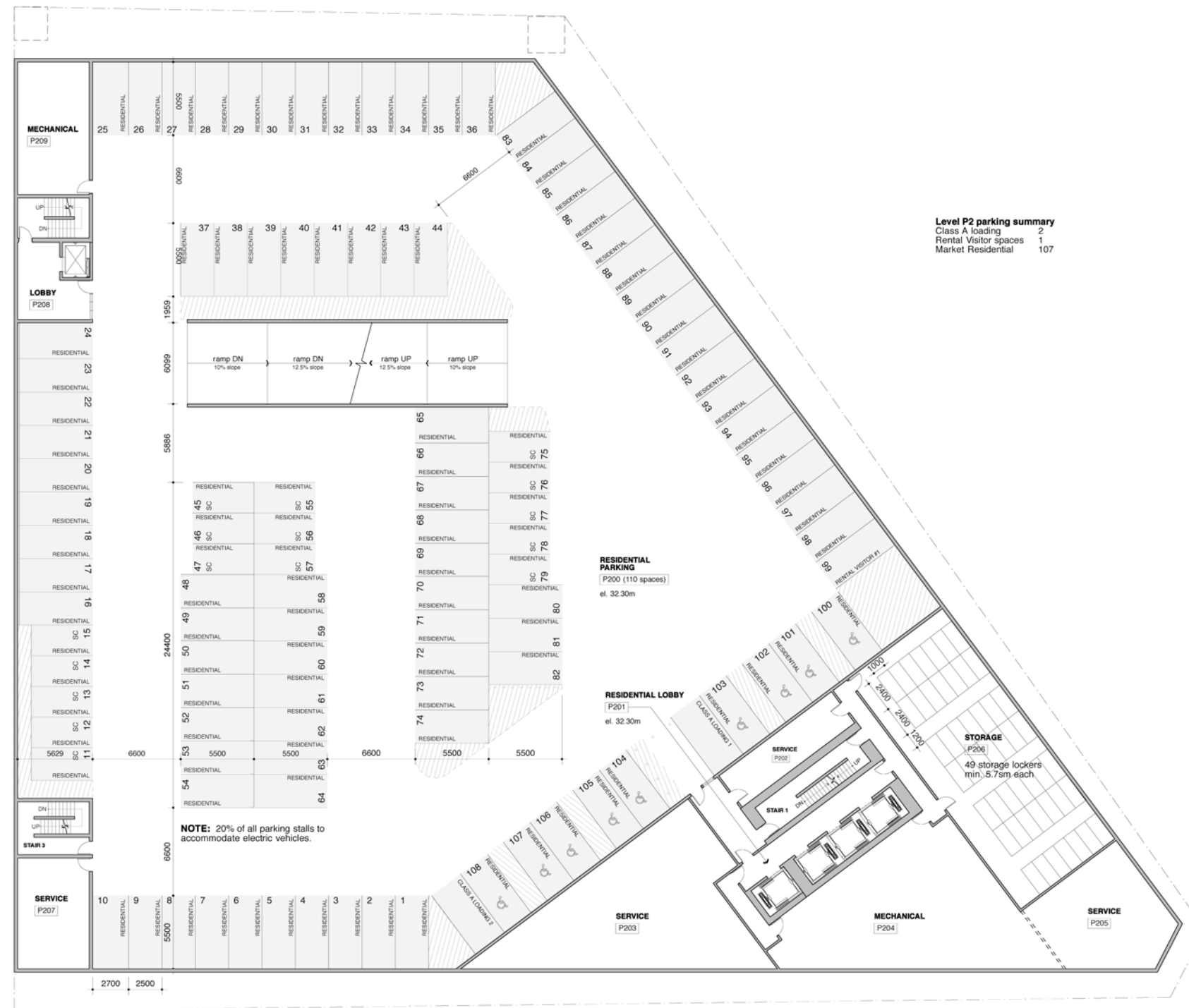

Level P2 parking summary
Class A loading 2
Rental Visitor spaces 1
Market Residential 107

NOTE: 20% of all parking stalls to accommodate electric vehicles.

ACTON OSTRY ARCHITECTS INC

111 E 8 Avenue
Vancouver BC
Canada V5T 1R8
t 604.739.3344
f 604.739.3355
info@actonostry.ca

Kingsway + Broadway

Rize Alliance
Kingsway + Broadway

scale	date
1 : 200	6 Oct 11
project code	status
KWY	Rezoning
drawn	checked
WS	RA



Parking Level 2

drawing number
A1.02

Issues

9 Jun 10 Issued for UDP Workshop
26 Jul 10 Issued for Rezoning

revisions

2 Jun 11 Revised Rezoning Submission
6 Oct 11 Revised Rezoning Submission

GENERAL NOTES:

- 20% of parking stalls to accommodate electric vehicles.
- Parking for Cultural and Recreation Uses (artist's production space), Service Uses (restaurant), and Retail Uses collectively labelled 'commercial'.



Level P1 parking summary
Car Share spaces 2
Commercial spaces 97

ACTON OSTRY ARCHITECTS INC

111 E 8 Avenue
Vancouver BC
Canada V5T 1R8
t 604.739.3344
f 604.739.3355
info@actonostroy.ca

Kingsway + Broadway

Rize Alliance
Kingsway + Broadway

scale	date
1 : 200	6 Oct 11
project code	status
KWY	Rezoning
drawn	checked
WS	RA



Parking Level 1

drawing number
A1.03